

PROJECT NO. 573-15-601
FINAL SUBMITTAL

[illegible]

**OFFICE OF
CONSTRUCTION
AND FACILITIES
MANAGEMENT**

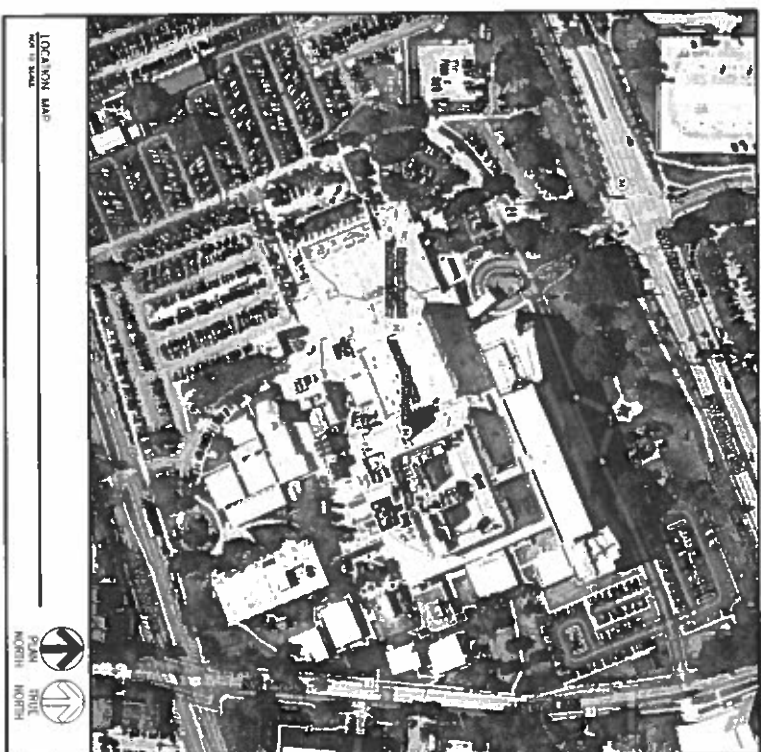
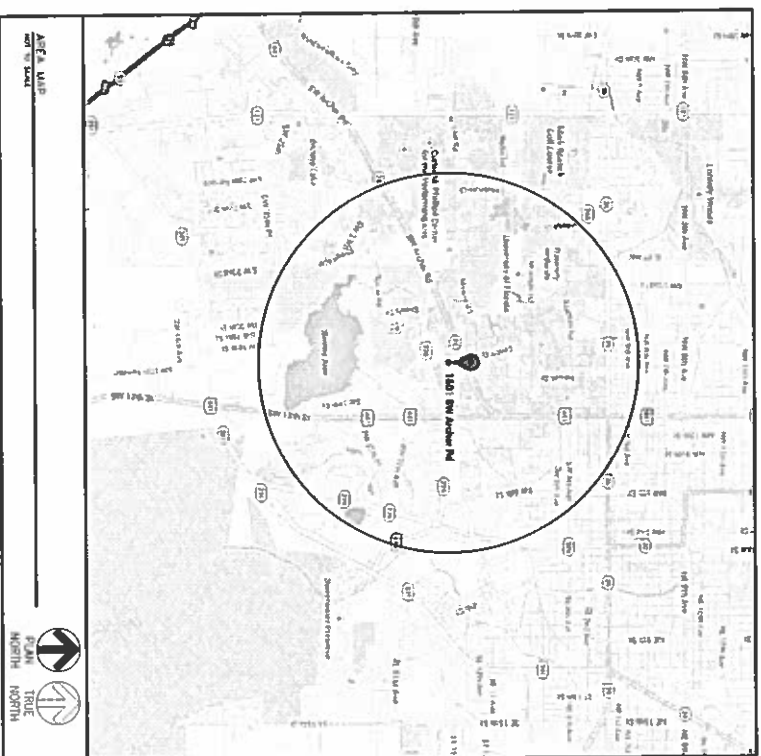
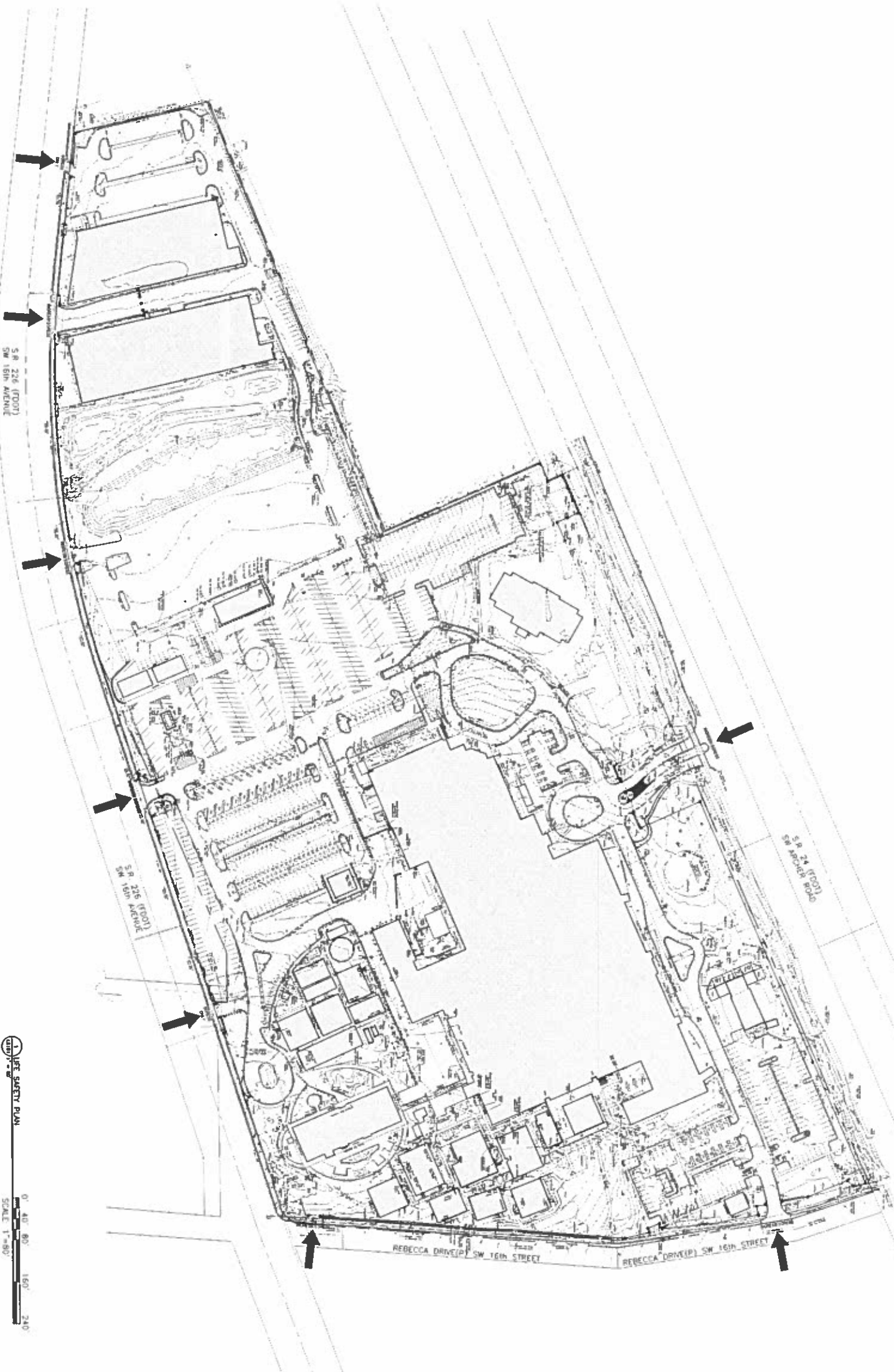

LIFE SAFETY PLAN GENERAL NOTES

- A SEE SHEET LS01 FOR PER DETAILS
- B DIMENSIONS AT EXISTING CONSTRUCTION ARE TO FACE/EDGE OF EXISTING FINISH
- C DIMENSIONS AT NEW CONSTRUCTION ARE TO FACE OF CONSTRUCTION
- D WORK SHALL BE IN ACCORDANCE WITH ALL EXISTING CONSTRUCTION SO NEW WORK IS CONGRUOUS

LIFE SAFETY PLAN KEY NOTES
(ALL NOTES NOT USED ON ALL SHEETS)

① NOT USED

LIFE SAFETY LEGEND

↓ VEHICLE SITE ACCESS

FINAL SUBMITTAL



OFFICE OF
CONSTRUCTION
AND FACILITIES
MANAGEMENT

Department of
Veterans Affairs

LIFE SAFETY PLAN

INSTALL PERIMETER FENCE

Approved Project Engineer

VAMC GAINESVILLE, FL

LS101
Dwg. 4 of 17

ARCHITECT/ENGINEERS:
**TOLAND
WIZELL
MOLNAR**
690 MEANS STREET NW, STE. 200, ATLANTA, GA 30318



CONSULTANTS:

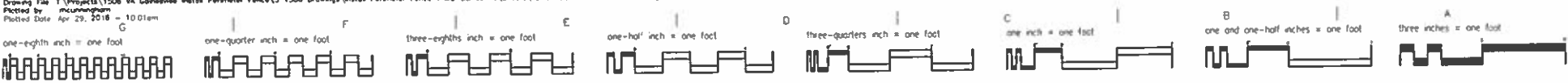

DEMOLITION SITE PLAN
SCALE: 1"=60'
0' 40' 80' 160' 240'

- DEMOLITION SITE PLAN KEY NOTES**
(ALL NOTES NOT USED ON ALL SHEETS)
- 1 REMOVE EXISTING FENCE AS NOTED AND NEEDED TO
 - 2 DEMOLISH AND REMOVE EXISTING CONCRETE
 - 3 DEMOLISH AND REMOVE EXISTING CONCRETE CURB & GUTTER AS NEEDED TO INSTALL NEW WORK
 - 4 DEMOLISH AND REMOVE EXISTING PAVING AS NEEDED TO INSTALL NEW WORK
 - 5 DEMOLISH AND REMOVE EXISTING FENCE AND /OR GATE AS NEEDED TO INSTALL NEW WORK
 - 6 EXISTING FENCE AND/OR GATE TO REMAIN
 - 7 REMOVE EXISTING SIGN AS NEEDED TO INSTALL NEW WORK. SALVAGE FOR RECYCLATION
 - 8 DEMOLISH AND REMOVE EXISTING BUILDING AS NEEDED TO INSTALL NEW WORK
- DEMOLITION SITE PLAN LEGEND**
- EXISTING CONSTRUCTION TO REMAIN
 - EXISTING CONSTRUCTION TO BE DEMOLISHED
- DEMOLITION SITE PLAN GENERAL NOTES**
- A CONSTRUCTION SHALL VERIFY EXISTING CONDITIONS WHERE WORK IS OCCURRING AND/OR NEW WORK IS BEING INSTALLED. CONSTRUCTION SHALL NOTIFY ARCHITECT OF ANY DISCREPANCIES OR CHANGES PRIOR TO PROCEEDING WITH ANY WORK.
 - B ALL EXISTING CHAIN LINK AND WOOD FENCING TO BE REMOVED AND REMOVED WHERE NEW FENCE IS BEING INSTALLED.

CONSULTANTS:	
ARCHITECT/ENGINEERS:	
TOLAND WIZELL MOLNAR	
690 MEANS STREET NW, STE. 200, ATLANTA, GA 30318	
DEMOLITION SITE PLAN	
INSTALL PERIMETER FENCE	
VAMC GAINESVILLE, FL	
AD101	
DWG. 5 OF 17	
OFFICE OF CONSTRUCTION AND FACILITIES MANAGEMENT	

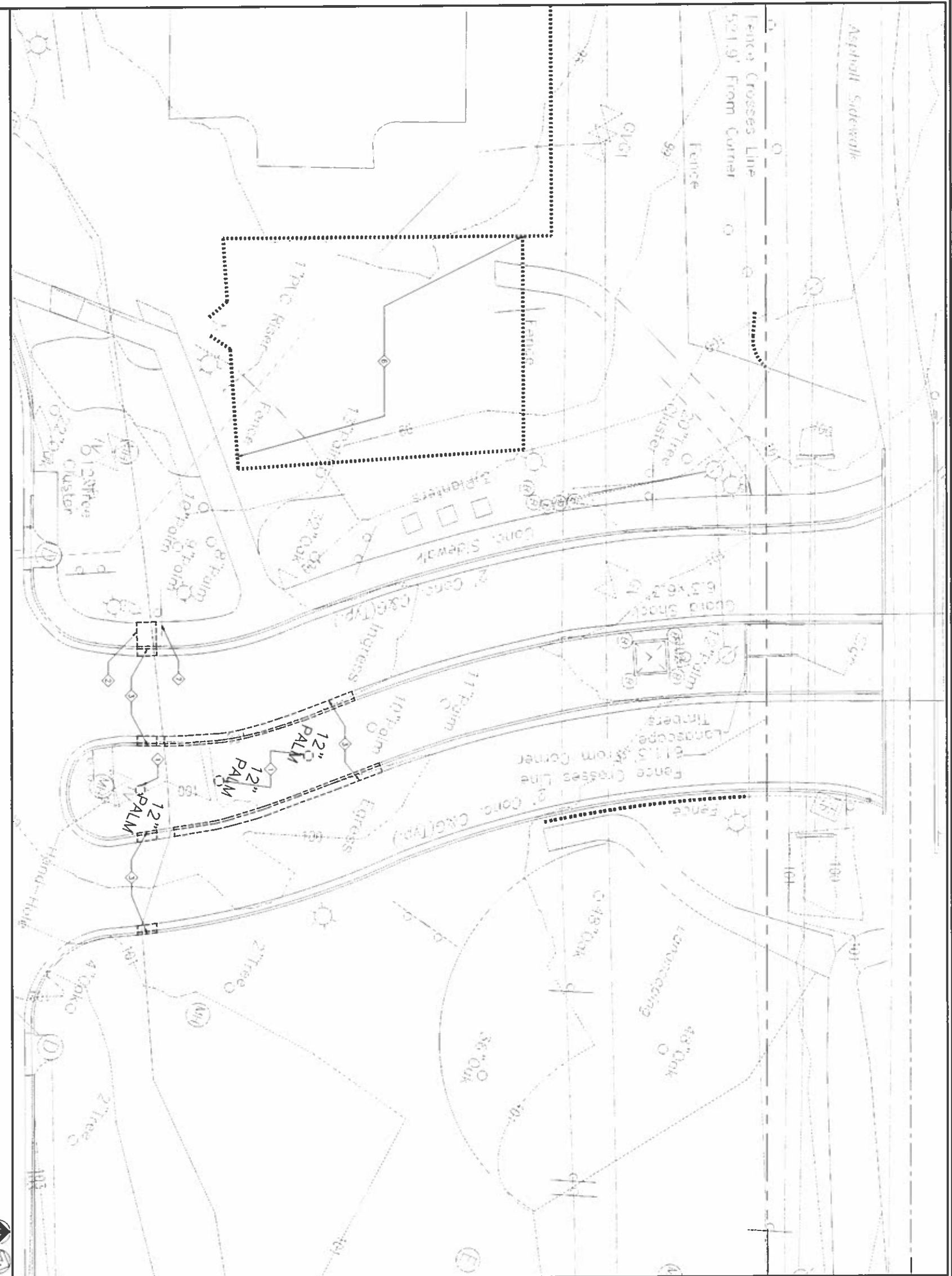

DEMOLITION SITE PLAN GENERAL NOTES

A. CONTRACTOR SHALL VERIFY EXISTING CONDITIONS WHERE WORK IS OCCURRING AND/OR NEW WORK IS BEING INSTALLED. CONTRACTOR SHALL NOTIFY ARCHITECT OF ANY DISCREPANCIES OR CHANGES PRIOR TO PROCEEDING WITH ANY WORK.

B. ALL FERTILIZER CHAIN LINK AND WOOD FENCING TO BE DEMOLISHED AND REINSTALLED WITHIN NEW FENCE IS BEING INSTALLED.

DEMOLITION SITE PLAN KEY NOTES 
(ALL NOTES NOT USED ON ALL SHEETS)

1. INITIAL EXISTING BUILD AS NOTED AND NOTED TO INITIAL NEW WORK
2. DEMOLISH AND REMOVE EXISTING CONCRETE
3. REINFORCE AND REMOVE EXISTING CONCRETE CURB
4. CURBING AS NOTED TO INITIAL NEW WORK
5. REINFORCE AND REMOVE EXISTING PAVING AS NOTED TO INITIAL NEW WORK
6. DEMOLISH AND REMOVE EXISTING STREET AND/OR SIDEWALK AS NOTED TO INITIAL NEW WORK
7. EXISTING STREET AND/OR SIDEWALK TO REMAIN
8. REMOVE EXISTING SIGN AS NOTED TO INITIAL NEW WORK
9. SIGN, SANDED FOR REINTEGRATION
10. DEMOLISH AND REMOVE EXISTING BELLOWS AS NOTED TO INITIAL NEW WORK

DEMOLITION SITE PLAN LEGEND

EXISTING CONSTRUCTION TO
REMATCH



FINAL SUBMITTAL

Project Number
573-15-601

Library Number

**AND FACILITIES
MANAGEMENT**

AD102
Dwg. 6 of 7

 Department of
Veterans Affairs

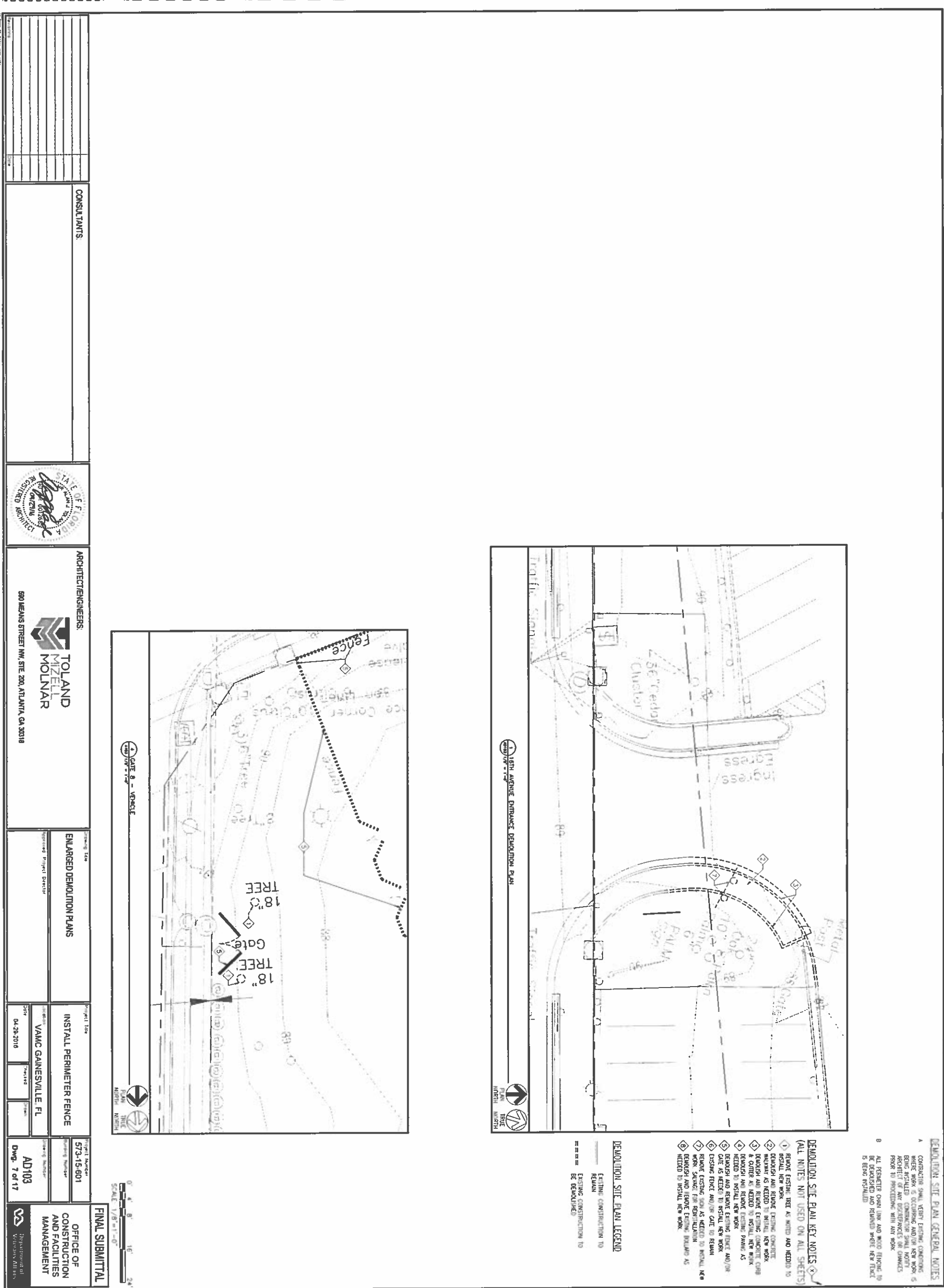

DEMOLITION SITE PLAN KEY NOTES 

(ALL NOTES NOT USED ON ALL SHEETS)

1. REPAIR EXISTING, BUT AS NOTED AND NEEDED TO INSTALL NEW WORK.
2. DEMOLISH AND REBUILD EXISTING CONCRETE WALKWAY AS NEEDED TO INSTALL NEW WORK.
3. DEMOLISH AND REBUILD EXISTING CONCRETE CURB & GUTTER AS NEEDED TO INSTALL NEW WORK.
4. DEMOLISH AND REBUILD EXISTING PAVING AS NEEDED TO INSTALL NEW WORK.
5. DEMOLISH AND REBUILD EXISTING TRUCK AND/OR CAR AS NEEDED TO INSTALL NEW WORK.
6. EXISTING TRUCK AND/OR CAR TO REMAIN.
7. REPAIR EXISTING SIGN AS NEEDED TO INSTALL NEW WORK. SIGNAGE FOR REDEMPTION.
8. DEMOLISH AND REBUILD EXISTING DELIVERY AS NEEDED TO INSTALL NEW WORK.

EXISTING CONSTRUCTION TO
REMAIN



Life Stage	Childhood	Young adulthood	Adulthood	Middle age	Old age
Childhood	100%	0%	0%	0%	0%
Young adulthood	0%	100%	0%	0%	0%
Adulthood	0%	0%	100%	0%	0%
Middle age	0%	0%	0%	100%	0%
Old age	0%	0%	0%	0%	100%

SITE PLAN GENERAL NOTES

- A SEE SHEET A-01 FOR PER DETAILS
- B DETERMINE EXISTING CONSTRUCTION ARE TO FACILITATE OF EXISTING HIGH
- C DRAINAGE, A NEW CONSTRUCTION ARE TO FAC
- D MATCH WITH OF ALL EXISTING CONSTRUCTION
- E SO NEW MORE IS CONDUITS
- F PROVIDE 12" DIA. DRAINAGE SLOPE FOR DRAINAGE
- G DRAINAGE TO HOLD GRADE IN THE OPEN POSITION
- H VERT. LOCATION WITH COR. INFLUENCE FOR ALL
- I GATE

ARCHITECTURAL SITE PLAN KEY NOTES

(ALL NOTES NOT USED ON ALL SHEETS)

ARCHITECTURAL SITE PLAN KEY NOTES
(ALL NOTES NOT USED ON ALL SHEETS)

① INSTALL CONK CURB AND GUTTER

② INSTALL CORC SIDE WALL

④ INSTANT PROFIT 2 ECTS

5) INSTALL NEW STEEL FENC:

⑥ METAL ASPHALT PAVING TO MATCH EXISTING

7 REINSTALL SALVAGED SIGN SITE COR FOR LOCATION

⑧ INITIAL STUDING RESULTS GALT

⑩ INSTALL CONCRETE LANDSCAPE WALL TO MATCH

SITE PLAN LEGEND

NEW CONSTRUCTION

NEW STEEL FENCE CONSTRUCTION

LINKAGE

ASPHALT PAVING

FINAL SUBMITTAL

OFFICE OF

CONSTRUCTION

MANAGEMENT

1	2	3	4	5	6	7	8	9	10	11	12	13	14	15	16	17	18	19	20	21	22	23	24	25	26	27	28	29	30	31	32	33	34	35	36	37	38	39	40	41	42	43	44	45	46	47	48	49	50	51	52	53	54	55	56	57	58	59	60	61	62	63	64	65	66	67	68	69	70	71	72	73	74	75	76	77	78	79	80	81	82	83	84	85	86	87	88	89	90	91	92	93	94	95	96	97	98	99	100	101	102	103	104	105	106	107	108	109	110	111	112	113	114	115	116	117	118	119	120	121	122	123	124	125	126	127	128	129	130	131	132	133	134	135	136	137	138	139	140	141	142	143	144	145	146	147	148	149	150	151	152	153	154	155	156	157	158	159	160	161	162	163	164	165	166	167	168	169	170	171	172	173	174	175	176	177	178	179	180	181	182	183	184	185	186	187	188	189	190	191	192	193	194	195	196	197	198	199	200	201	202	203	204	205	206	207	208	209	210	211	212	213	214	215	216	217	218	219	220	221	222	223	224	225	226	227	228	229	230	231	232	233	234	235	236	237	238	239	240	241	242	243	244	245	246	247	248	249	250	251	252	253	254	255	256	257	258	259	260	261	262	263	264	265	266	267	268	269	270	271	272	273	274	275	276	277	278	279	280	281	282	283	284	285	286	287	288	289	290	291	292	293	294	295	296	297	298	299	300	301	302	303	304	305	306	307	308	309	310	311	312	313	314	315	316	317	318	319	320	321	322	323	324	325	326	327	328	329	330	331	332	333	334	335	336	337	338	339	340	341	342	343	344	345	346	347	348	349	350	351	352	353	354	355	356	357	358	359	360	361	362	363	364	365	366	367	368	369	370	371	372	373	374	375	376	377	378	379	380	381	382	383	384	385	386	387	388	389	390	391	392	393	394	395	396	397	398	399	400	401	402	403	404	405	406	407	408	409	410	411	412	413	414	415	416	417	418	419	420	421	422	423	424	425	426	427	428	429	430	431	432	433	434	435	436	437	438	439	440	441	442	443	444	445	446	447	448	449	450	451	452	453	454	455	456	457	458	459	460	461	462	463	464	465	466
---	---	---	---	---	---	---	---	---	----	----	----	----	----	----	----	----	----	----	----	----	----	----	----	----	----	----	----	----	----	----	----	----	----	----	----	----	----	----	----	----	----	----	----	----	----	----	----	----	----	----	----	----	----	----	----	----	----	----	----	----	----	----	----	----	----	----	----	----	----	----	----	----	----	----	----	----	----	----	----	----	----	----	----	----	----	----	----	----	----	----	----	----	----	----	----	----	----	----	-----	-----	-----	-----	-----	-----	-----	-----	-----	-----	-----	-----	-----	-----	-----	-----	-----	-----	-----	-----	-----	-----	-----	-----	-----	-----	-----	-----	-----	-----	-----	-----	-----	-----	-----	-----	-----	-----	-----	-----	-----	-----	-----	-----	-----	-----	-----	-----	-----	-----	-----	-----	-----	-----	-----	-----	-----	-----	-----	-----	-----	-----	-----	-----	-----	-----	-----	-----	-----	-----	-----	-----	-----	-----	-----	-----	-----	-----	-----	-----	-----	-----	-----	-----	-----	-----	-----	-----	-----	-----	-----	-----	-----	-----	-----	-----	-----	-----	-----	-----	-----	-----	-----	-----	-----	-----	-----	-----	-----	-----	-----	-----	-----	-----	-----	-----	-----	-----	-----	-----	-----	-----	-----	-----	-----	-----	-----	-----	-----	-----	-----	-----	-----	-----	-----	-----	-----	-----	-----	-----	-----	-----	-----	-----	-----	-----	-----	-----	-----	-----	-----	-----	-----	-----	-----	-----	-----	-----	-----	-----	-----	-----	-----	-----	-----	-----	-----	-----	-----	-----	-----	-----	-----	-----	-----	-----	-----	-----	-----	-----	-----	-----	-----	-----	-----	-----	-----	-----	-----	-----	-----	-----	-----	-----	-----	-----	-----	-----	-----	-----	-----	-----	-----	-----	-----	-----	-----	-----	-----	-----	-----	-----	-----	-----	-----	-----	-----	-----	-----	-----	-----	-----	-----	-----	-----	-----	-----	-----	-----	-----	-----	-----	-----	-----	-----	-----	-----	-----	-----	-----	-----	-----	-----	-----	-----	-----	-----	-----	-----	-----	-----	-----	-----	-----	-----	-----	-----	-----	-----	-----	-----	-----	-----	-----	-----	-----	-----	-----	-----	-----	-----	-----	-----	-----	-----	-----	-----	-----	-----	-----	-----	-----	-----	-----	-----	-----	-----	-----	-----	-----	-----	-----	-----	-----	-----	-----	-----	-----	-----	-----	-----	-----	-----	-----	-----	-----	-----	-----	-----	-----	-----	-----	-----	-----	-----	-----	-----	-----	-----	-----	-----	-----	-----	-----	-----	-----	-----	-----	-----	-----	-----	-----	-----	-----	-----	-----	-----	-----	-----	-----	-----	-----	-----	-----	-----	-----	-----	-----	-----	-----	-----	-----	-----	-----	-----	-----	-----	-----	-----	-----	-----	-----	-----	-----	-----	-----	-----

Veterans Affairs

one-eighth inch = one foot

one-quarter inch = one foot

three-eighths inch = one foot

one-half inch = one foot

three-quarters inch = one foot

one inch = one foot

one and one-half inches = one foot

three inches = one foot

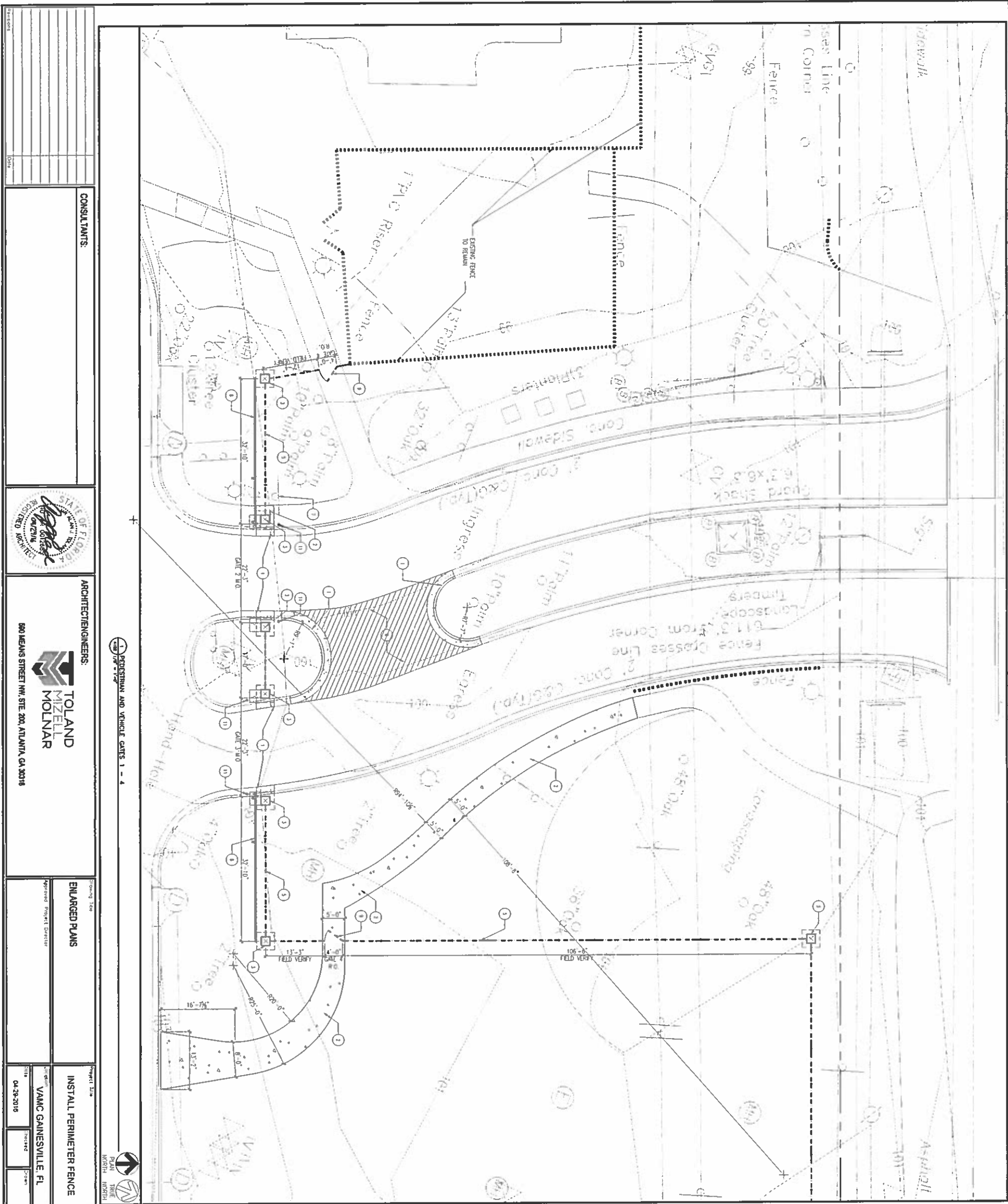

PEDESTRIAN AND VEHICLE GATES 1 - 4



SCALE 1/8"=1'-0"

ENLARGED SITE PLAN LEGEND
EXISTING CONSTRUCTION TO REMAIN
NEW CONSTRUCTION
NEW STEEL FENCE CONSTRUCTION
CONCRETE
ASPHALT PAVING

ENLARGED SITE PLAN KEY NOTES
(ALL NOTES NOT USED ON ALL SHEETS)
1. METAL CONE CORNER AND GATE
2. METAL CONE CORNER
3. METAL TYPE 1 FENCE
4. METAL TYPE 2 FENCE
5. METAL NEW STEEL FENCE
6. METAL ASPHALT PAVING TO MATCH EXISTING
7. REPAIR/REPLACE SAWCUT SIGN SEE COR FOR LOCATION
8. METAL SLIDING VEHICLE GATE
9. METAL PEDESTRIAN GATE
10. METAL CONCRETE LANDSCAPE WALL TO MATCH EXISTING
11. STEEL BOLDED SEE DETAIL 14/A501

SITE PLAN GENERAL NOTES
A. SEE SHEET A501 FOR PERMITS
B. DIMENSIONS AT EXISTING CONSTRUCTION ARE TO FACE/EDGE OF EXISTING FINISH
C. DIMENSIONS AT NEW CONSTRUCTION ARE TO FACE OF NEW CONSTRUCTION
D. ALL EXISTING CONSTRUCTION TO REMAIN UNLESS NOTED OTHERWISE
E. PROVIDE METAL GROUND SLEEVE FOR LOCKABLE PREPARED TO HOLD GATE IN THE OPEN POSITION WITH LOCATION WITH COR. TYPICAL FOR ALL GATES

CONSULTANTS:

ARCHITECT/ENGINEERS:

TOLAND MIZELL MOLNAR

600 MEANS STREET NW, STE. 200, ATLANTA, GA 30318

ENLARGED PLANS

INSTALL PERIMETER FENCE

Project Number

573-15-801

Office of Construction and Facilities Management

FINAL SUBMITTAL

Office of Construction and Facilities Management

Office of Construction and Facilities Management

Office of Construction and Facilities Management

Office of Construction and Facilities Management

Office of Construction and Facilities Management

Office of Construction and Facilities Management

Office of Construction and Facilities Management

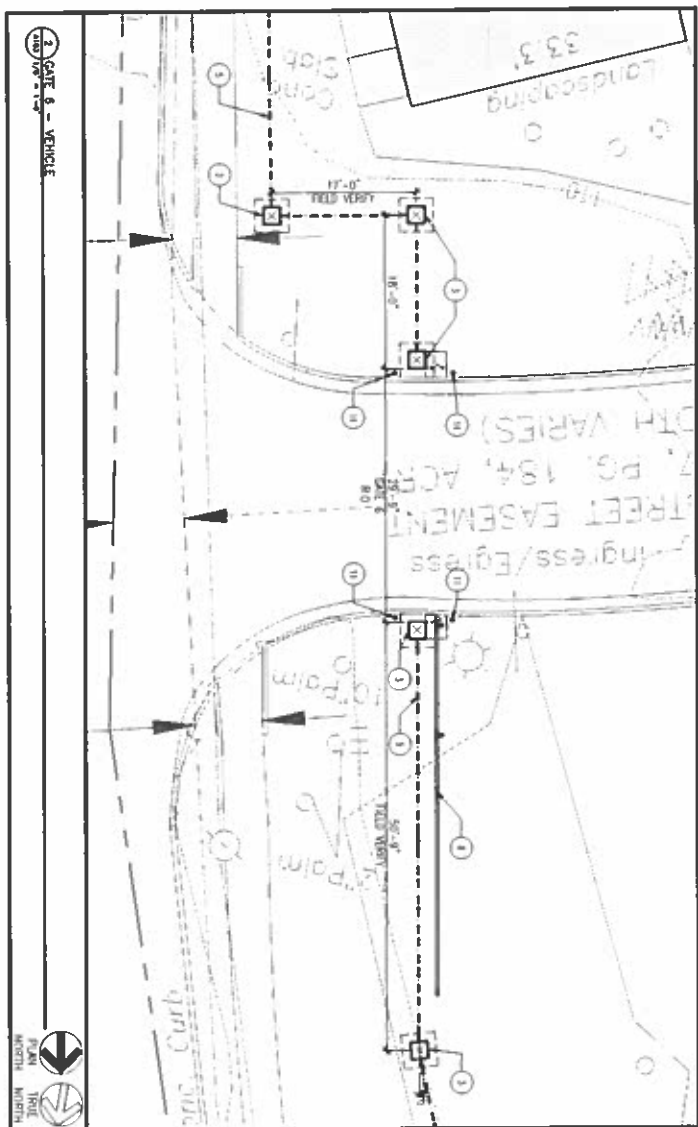

- ⑪ STILTA. ITALIANO. SET. DICEMBRE 1995/2001

CONCRETE

ASPHALT PAVING



OFFICE OF

Department of
Vascular Biology, Inc.

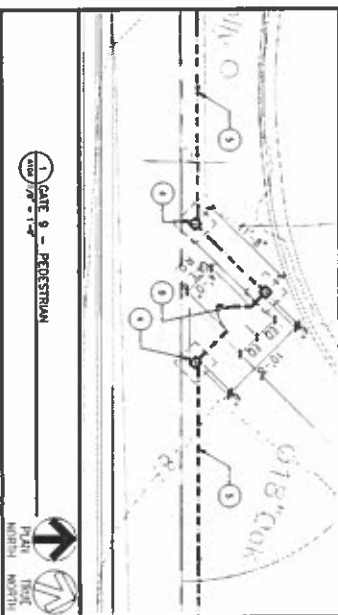
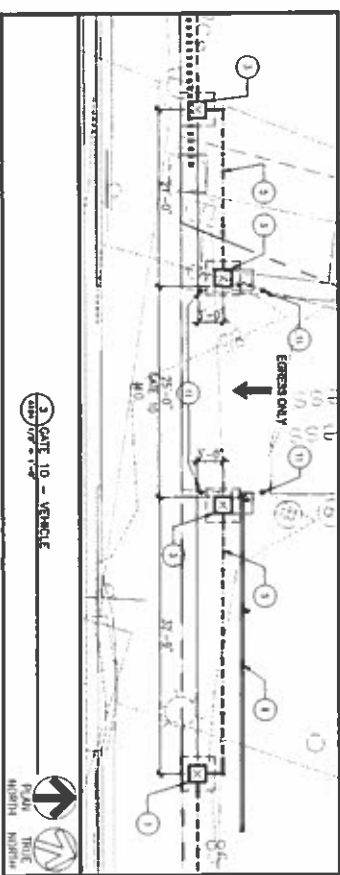
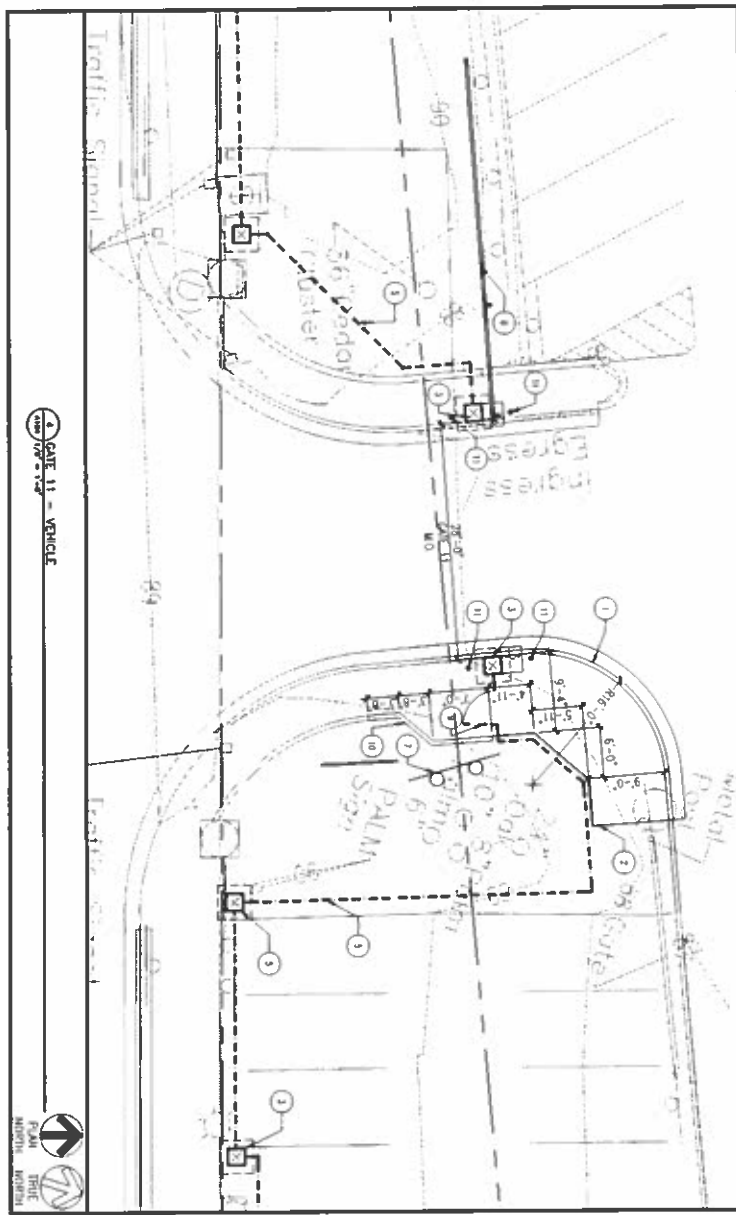
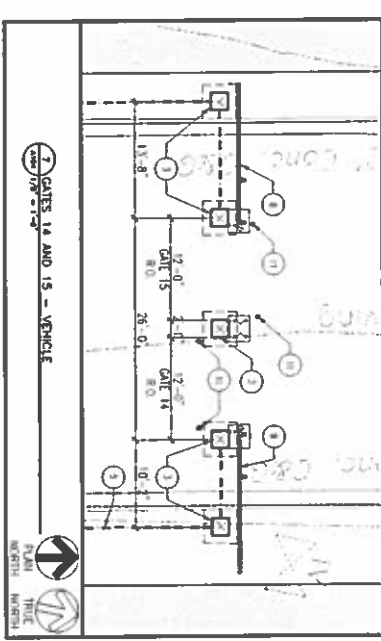

**CONSTRUCTION
AND FACILITIES
MANAGEMENT**

- A. SELF-HEALING AGG. FOR CORR. DETAILS;
- B. REINFORCEMENTS AT EXISTING CONSTRUCTION ARE TO FACE/DOCK OF EXISTING THRU;
- C. DIMENSIONS AT NEW CONSTRUCTION ARE TO FACE OF SLOOTER GIRD.
- D. MATCH WITHIN OF ALL EXISTING CONSTRUCTION.
- E. SO NEW WORK IS COMPATIBLE.
- F. PROTECT WITH GROUND SLURRY FOR EXISTING OVERPOUR TO HOLD CURE IN THE GUTTA POSITION. VERIFY LOCATION WITH COR. TYPICAL FOR ALL CASES.

(ALL NOTES NOT USED ON ALL SHEETS)

- 1) INITIAL CONK, CARP AND GATER.
- 2) INITIAL CONK, SOFTWARE.
- 3) INITIAL TIME, 1 HOUR.
- 4) INITIAL TIME, 2 HOUR.
- 5) INITIAL, NEW STEEL EFFECT.
- 6) INITIAL, INITIAL PLANKING TO MATCH EXISTING.
- 7) INITIAL, SANDWICH SASH SEE CAR FOR LOCATION.
- 8) INITIAL, SLIDING WINDOW DATE.
- 9) INITIAL, PEDESTAL DATE.
- 10) INITIAL, CONCRETE ANGLE/PLATE WALL TO MATCH EXISTING, REMOVED CONSTRUCTION.
- 11) STEEL BRACING SEE DETAIL 14/0001

THE ABOVE WILL BE FORN TRAFFIC

--- NEW STEEL FRAME CONSTRUCTION

CONCRETE

Actual Parts

0' 4' 8' 16' 24'

SCALE 1/8"=1'-0"

FINAL SUBMITTAL



CONSULTANTS:



INSTALL PERIMETER FENCE	Project Title
VAMC GAINESVILLE, FL	Location
04-10-2016	Date
	Prepared By
	Drawn By

**OFFICE OF
CONSTRUCTION
AND FACILITIES
MANAGEMENT**

 Department of
Veterans Affairs

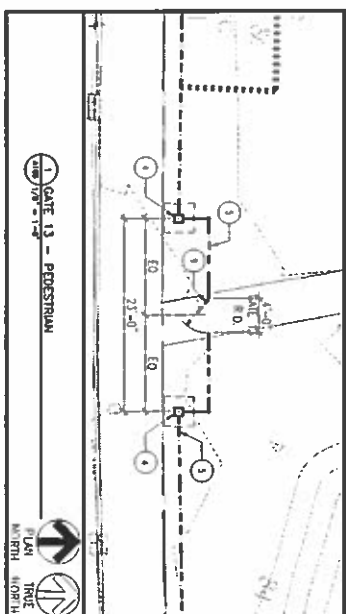
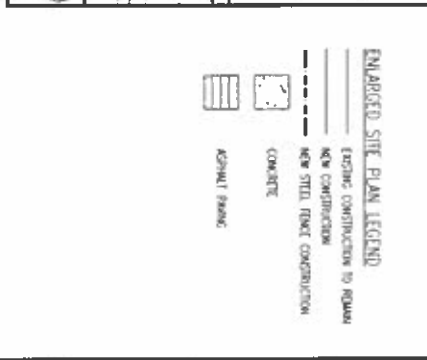
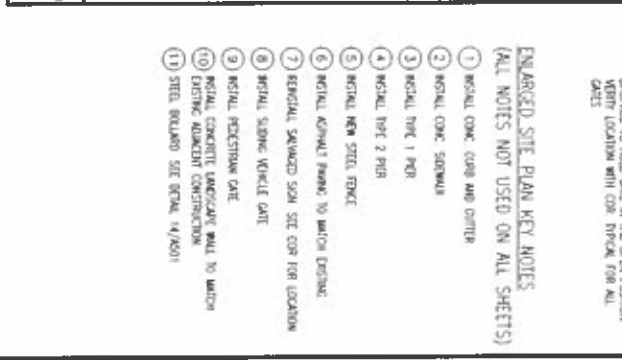

- A SEE SHEET A001 FOR PIER DETAILS.
- B DIMENSIONS AT EXISTING CONSTRUCTION ARE TO FACE (FACE OF EXISTING PIER).
- C DIMENSIONS AT NEW CONSTRUCTION ARE TO FACE OF EXISTING WALL.
- D MATCH WITHIN OF ALL EXISTING CONSTRUCTION.
- E SO NEW PIER IS CONSTRUCTED.
- F PROVIDE REIN. DRIVING PILE IN 100MM REINFORCED TO HOLD CASE IN THE OPEN POSITION. VERIFY LOCATION WITH COR. TYPICAL FOR ALL CASE.

- 100

2

- 15

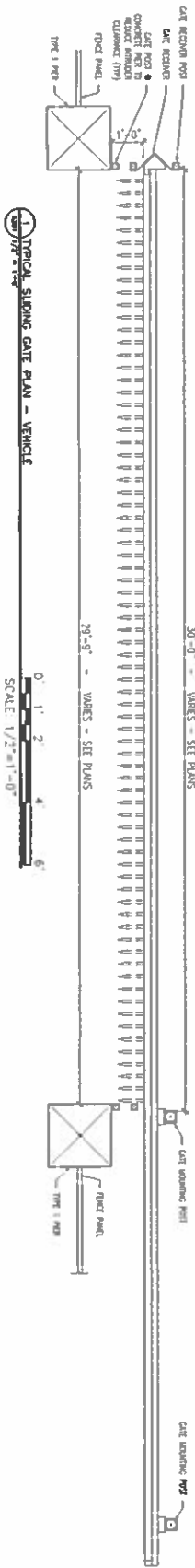
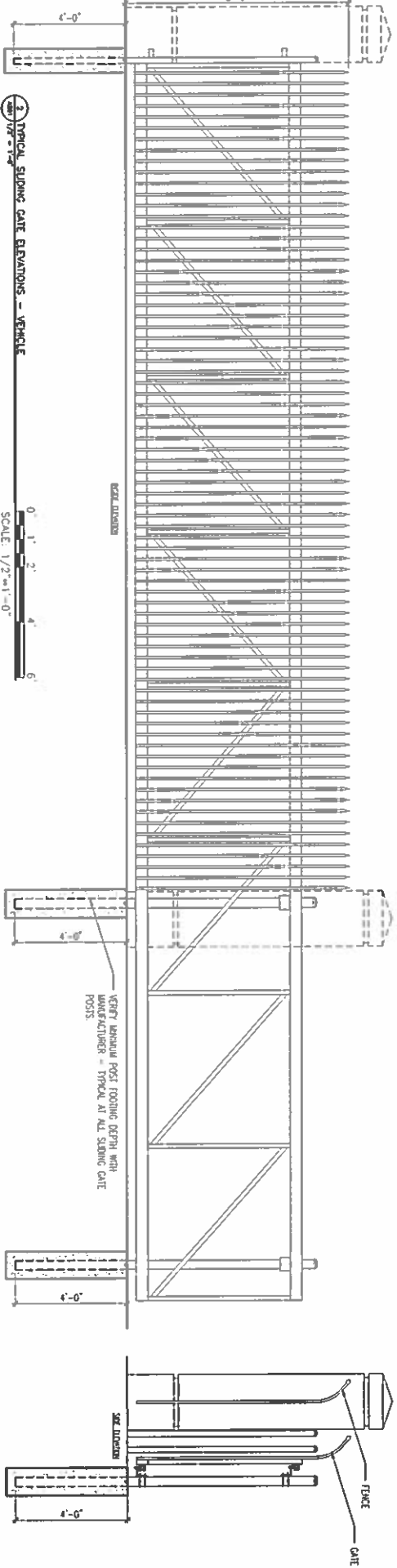
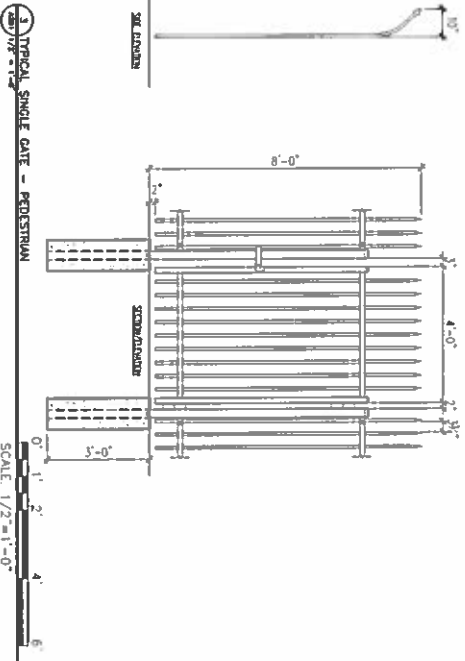
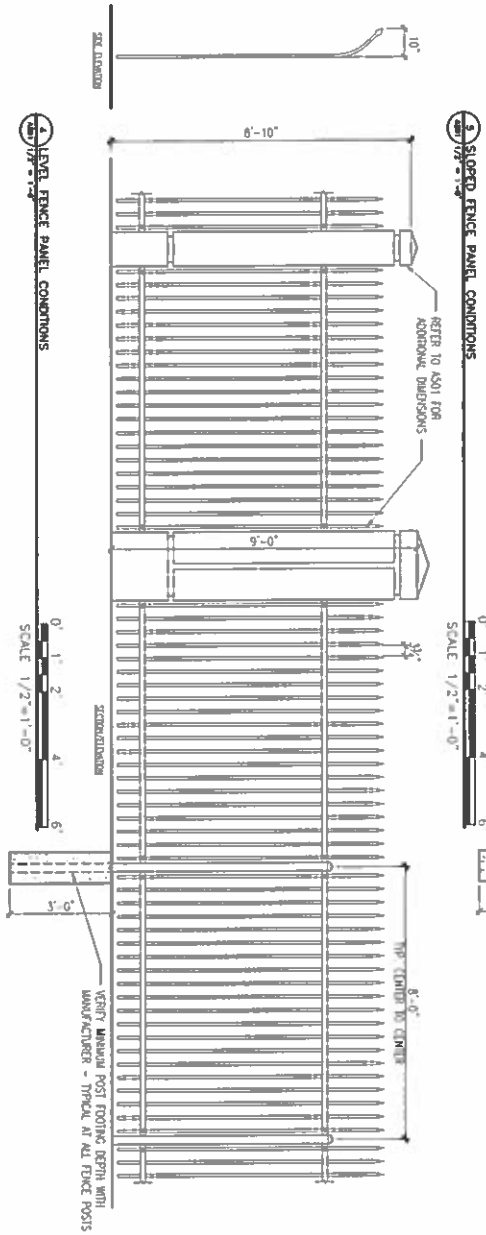
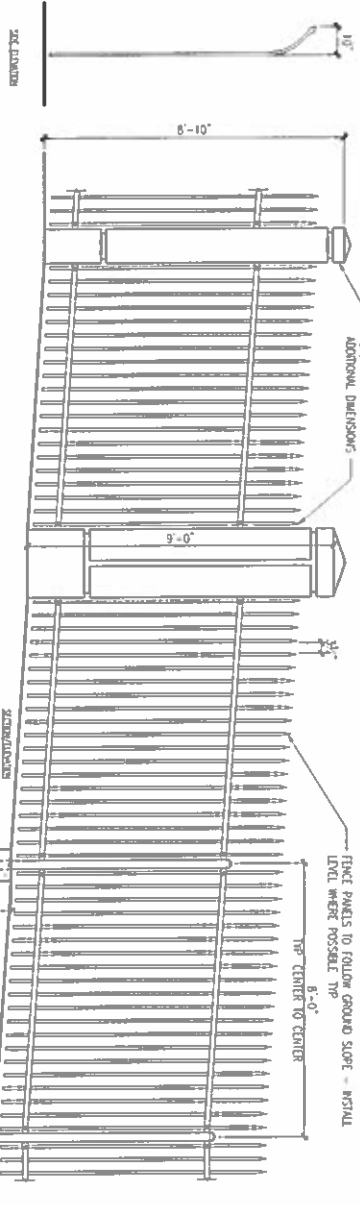

CONSULTANTS:



ARCHITECT/ENGINEERS:



800 MEANS STREET NW, STE. 200, ATLANTA, GA 30318

DATE: 04/29/16

PROJECT: 1506 VA Gainesville Install Perimeter Fence

DESIGNER: mcmurroughs

CHECKED: mcmurroughs

APPROVED: Project Director

DATE: 04/29/16

PROJECT: 1506 VA Gainesville Install Perimeter Fence

DESIGNER: mcmurroughs

CHECKED: mcmurroughs

APPROVED: Project Director

DATE: 04/29/16

PROJECT: 1506 VA Gainesville Install Perimeter Fence

DESIGNER: mcmurroughs

CHECKED: mcmurroughs

APPROVED: Project Director

FINAL SUBMITTAL

OFFICE OF
CONSTRUCTION
AND FACILITIES
MANAGEMENT

Department of
Veterans Affairs

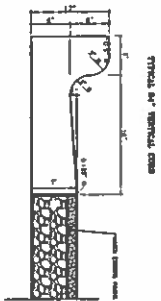
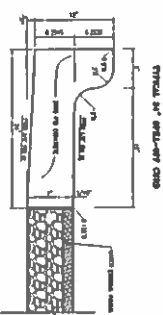
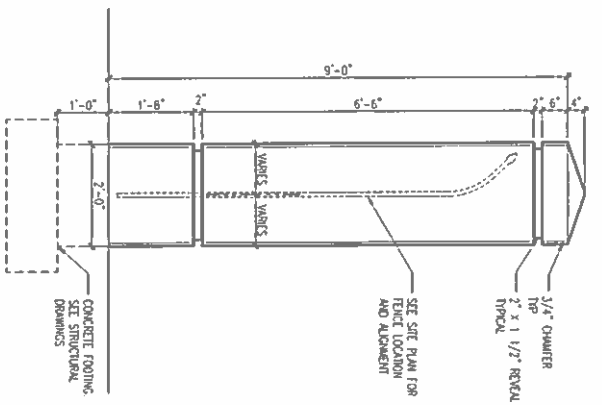
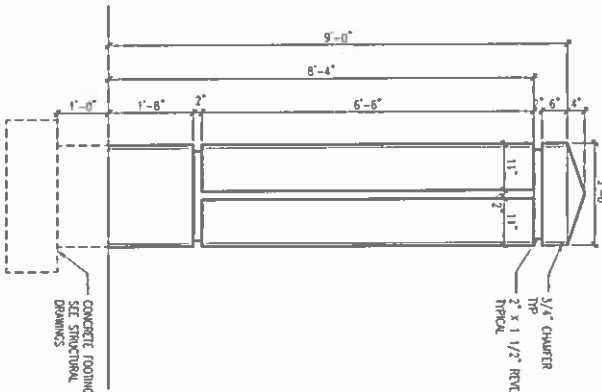
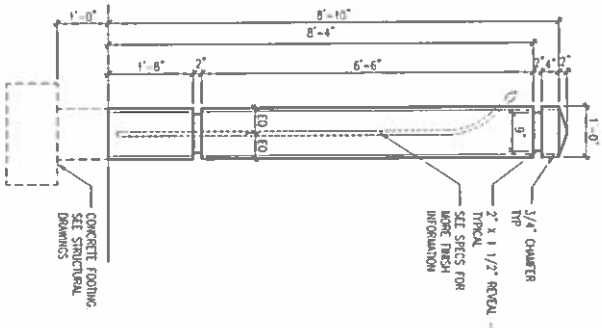
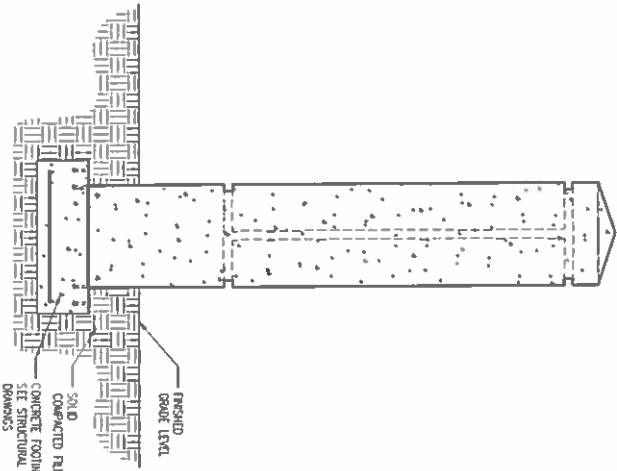
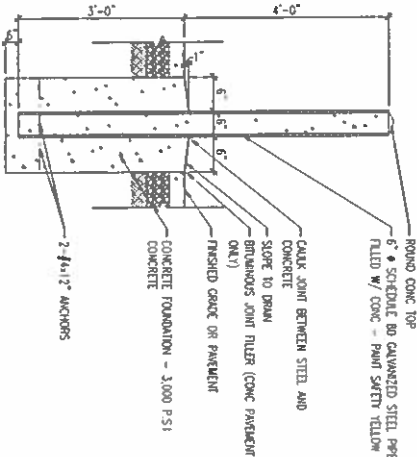

TYPICAL CURB AND GUTTER DETAILS
NOT TO SCALE

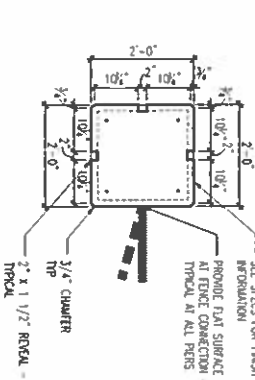
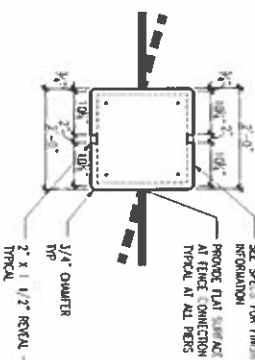
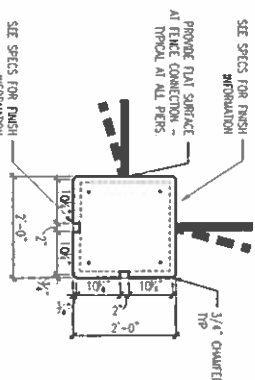
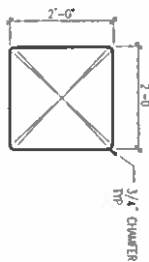
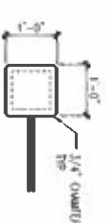
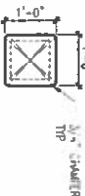

CONSULTANTS:

ARCHITECT/ENGINEERS



800 MEANS STREET NW, STE. 200, ATLANTA, GA 30316

PRECAST CONCRETE PIER DETAILS

INSTALL PERIMETER FENCE

573-15-801



FINAL SUBMITTAL

OFFICE OF
CONSTRUCTION
AND FACILITIES
MANAGEMENT



A. AWS/ASCE 7-10, MINIMUM DESIGN LOADS FOR BUILDINGS AND OTHER STRUCTURES
1.01 2015 INTERNATIONAL BUILDING CODE (IBC) AS MODIFIED BY:

- A. ANS1/AISC 360-10, SPECIFICATION FOR STRUCTURAL STEEL BUILDINGS

1.01 DESIGN LOADS ARE AS FOLLOWS

- E. MAXIMUM TRIBUTARY FENCE WIDTH.**

5 SEISMIC DESIGN CATEGORY = A
6 SINCE THIS BUILDING IS IN SDC A, SEISMIC FORCES ON THE FENCE ARE NOT REQUIRED BY
CHAPTER 13 OF ASCE7-10.

- THE ATTENTION OF THE STRUCTURAL ENGINEER IMMEDIATELY

1.01 STRUCTURAL DRAWINGS INDICATE TYPICAL AND CERTAIN SPECIFIC CONDITIONS ONLY. SPECIFIC CONDITIONS SHALL BE INDICATED BY NOTES. ALL CONDITIONS IN ACCORDANCE WITH SPECIFIED STANDARDS SHALL BE INDICATED BY NOTES. ALL CONDITIONS IN ACCORDANCE WITH SPECIFIED STANDARDS SHALL BE INDICATED BY NOTES. ALL CONDITIONS IN ACCORDANCE WITH SPECIFIED STANDARDS SHALL BE INDICATED BY NOTES.

- AND PROCESSING TIME IN ADDITION TO SUCH REVIEWS

EXISTING CONDITIONS

- FOAM TO PREVENT THE ENTRY OF SILT INTO THE ANNULAR SPACE

101 ALL FOUNDATIONS SHALL BE INSTALLED UNDER THE GUIDANCE OF A REGISTERED PROFESSIONAL

- 1.04 FOOTINGS SHALL BE CENTERED UNDER CONCRETE PIERS UNLESS NOTED OTHERWISE

1.01 CONCRETE REASON IS IN ACCORDANCE WITH THE BUILDING CODE REQUIREMENTS FOR STRUCTURAL CONCRETE. ACI 318

1.02 CONCRETE WORK SHALL BE FURNISHED AND INSTALLED IN ACCORDANCE WITH THE FIELD REFERENCE MANUAL: STANDARD SPECIFICATIONS FOR STRUCTURAL CONCRETE ACI 301 WITH SELECTED ACI AND ASTM REFERENCES (SP-15)

1.03 ALL CONCRETE SHALL BE NORMAL WEIGHT (145PCF) AND HAVE A MINIMUM 28-DAY COMPRESSIVE STRENGTH AS FOLLOWS: UNLESS NOTED OTHERWISE:

1. WILD EXPOSURE BASED ON THE MAXIMUM NOMINAL AGGREGATE

- A FORMED CONCRETE EXPOSED TO WEATHER OR EARTH

- EDITION, TYPE I, CLASS B. (W.R. MEADOWS CS-309)

1.01 PRECAST CONCRETE DESIGN, MANUFACTURE AND ERECTION SHALL CONFORM TO ACI 318 AND PC

- ### 1.03 CONNECTIONS:

- C. APPLY CONCRETE SEALER IN ACCORDANCE WITH MANUFACTURER'S RECOMMENDATIONS

101 PART 1 GENERAL

- ### 1.03 PART 3 EXECUTION

- ALL WELDS SHALL BE VISUALLY EXAMINED

2. **PROJECT** **INSTALLED** **ITEMS** **FROM** **DAMAGE** **CAUSED** **BY** **SUBSEQUENT** **CONSTRUCTION**

BOT BOTTOM

- WELDED WIRE REINFORCEMENT

		CONSULTANTS:		 <p>INNOVATIVE ENGINEERING INCORPORATED</p> <p>3360 TRICKUM ROAD Bldg. 500 Ste 100 Woodstock, GA 30188 770.517.5507</p>	
ARCHITECT/ENGINEERS:		 <p>TOLAND MIZELL MOLNAR</p> <p>990 MEANS STREET NW, STE 200, ATLANTA, GA 30316</p>		Structural Title	
STRUCTURAL NOTES		Project Title		Project Number	
Registered Project Engineer		INSTALL PERIMETER FENCE		573-15-601	
VAMC GAINESVILLE, FL		SLW		EAM	
S001		Dwg. 16 of 17		Office of Construction and Facilities Management	
		FINAL SUBMITTAL			

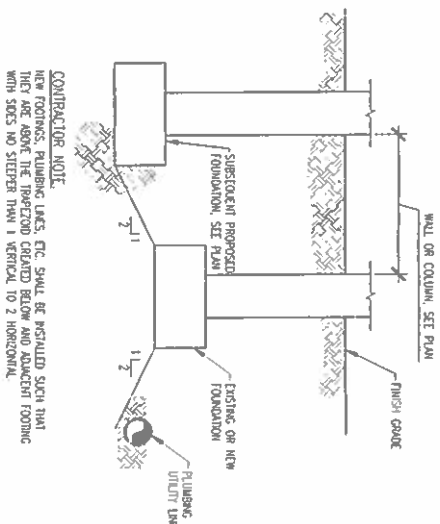

1 TYP. FOOTING INSTALLATION DETAIL
N.T.S.

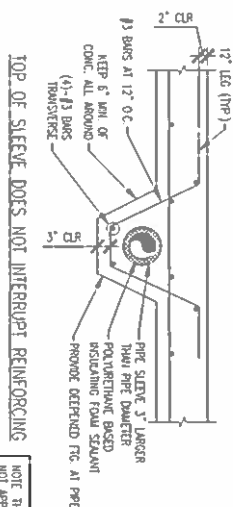

2 PIPE SLEEVE THRU FOOTING DETAILS
N.T.S.

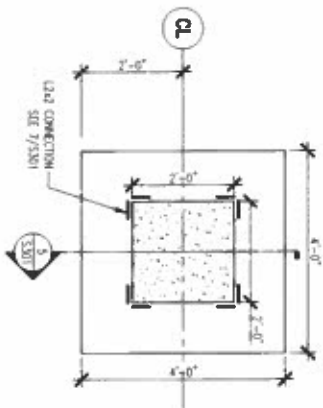

3 PIER FOOTING PLAN DETAIL (TYPE 1)
SCALE: 3/4\"/>

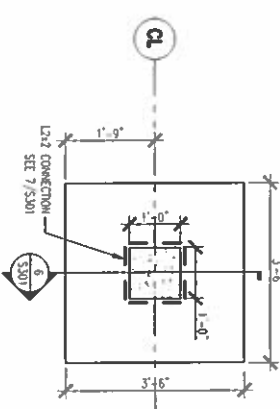

4 PIER FOOTING PLAN DETAIL (TYPE 2)
SCALE: 3/4\"/>

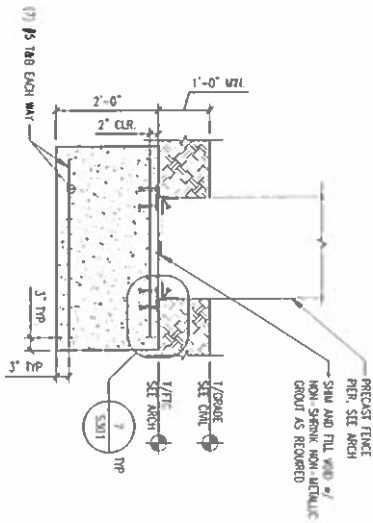

5 PIER FOOTING SECTION (TYPE 1)
SCALE: 3/4\"/>

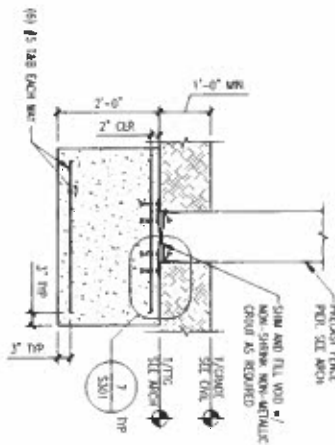

6 PIER FOOTING SECTION (TYPE 2)
SCALE: 3/4\"/>

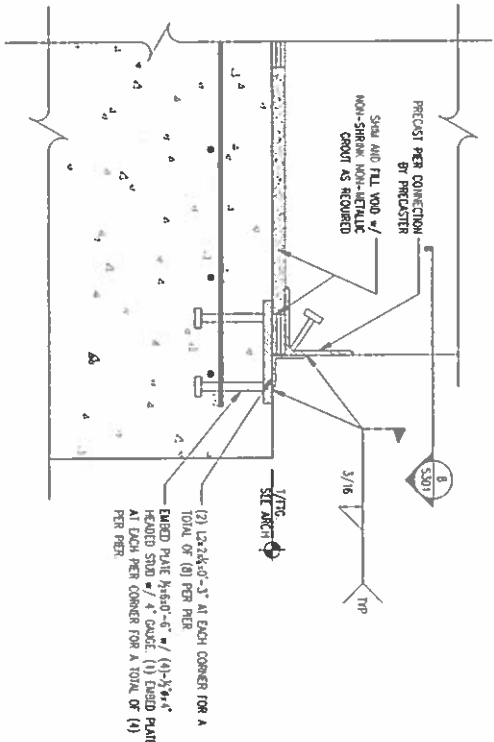

7 PIER CONNECTION DETAIL
SCALE: 3\"/>

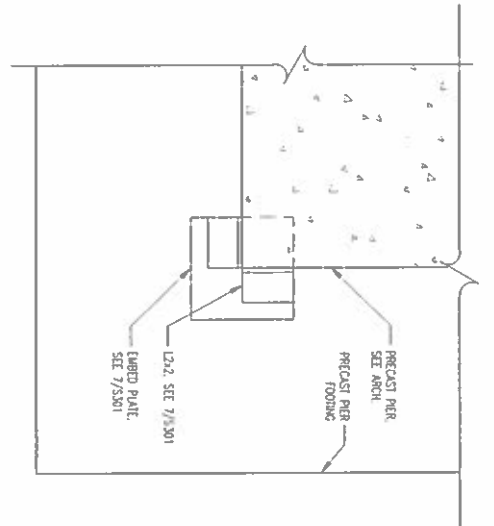

8 PIER CONNECTION DETAIL
SCALE: 3\"/>

9 NOT USED
N.T.S.

FINAL SUBMITTAL

CONSULTANTS:

**INNOVATIVE
ENGINEERING
INCORPORATED**
3380 TRICKUM ROAD
Bldg. 500 Stp. 100
Woodstock, GA 30188
770.517.5507

ARCHITECT/ENGINEERS:

**TOLAND
MIZELL
MOLNAR**
680 MEANS STREET NW, STE. 200, ATLANTA, GA 30318

CONCRETE DETAILS

INSTALL PERIMETER FENCE

5/23-15-801

OFFICE OF
CONSTRUCTION
AND FACILITIES
MANAGEMENT

VAAC GAINESVILLE, FL

04-29-2016

SLW

EAM

S301
Dwg. 16 of 17

Department of
Veterans Affairs

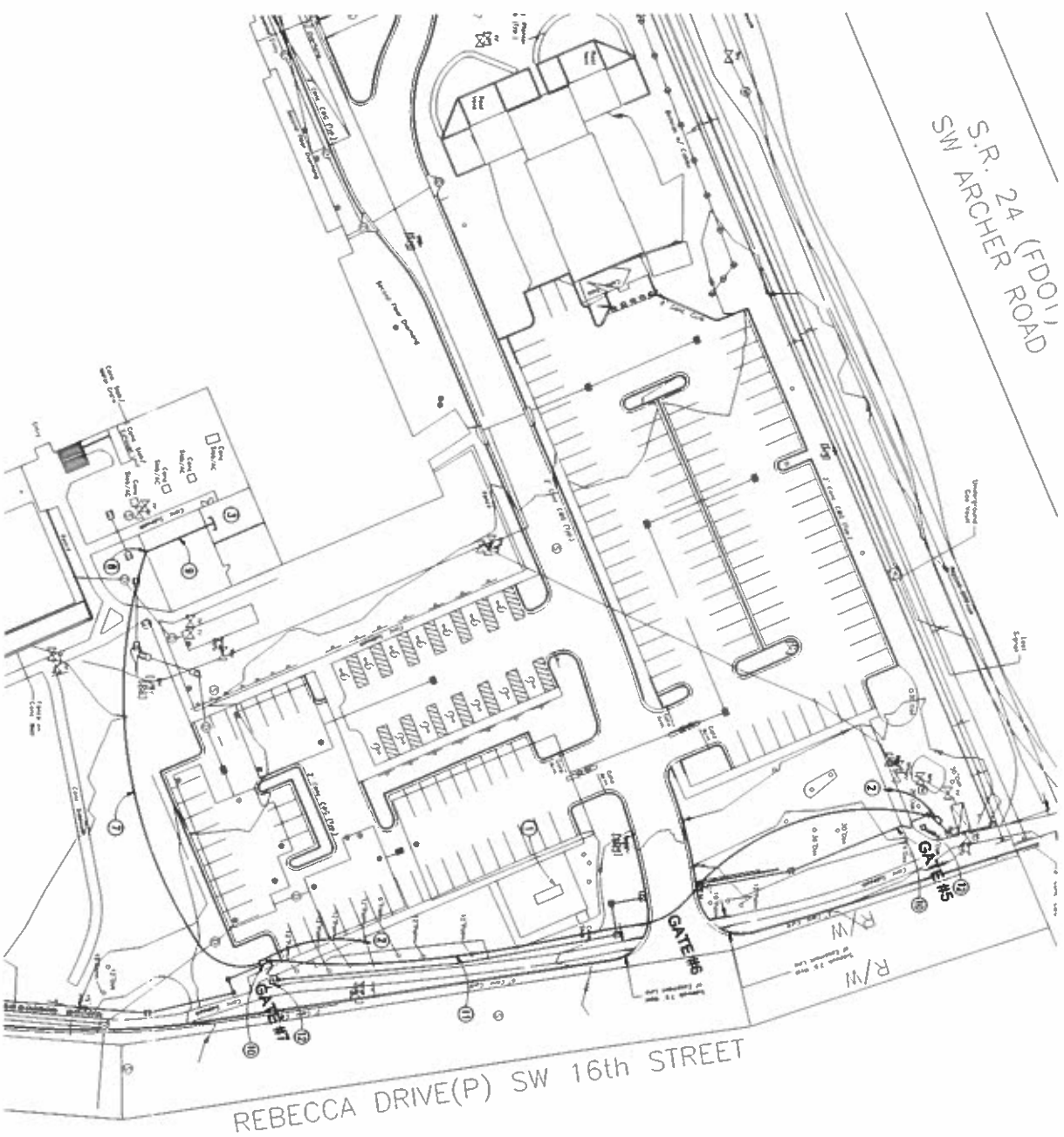

ELECTRICAL SITE PLAN

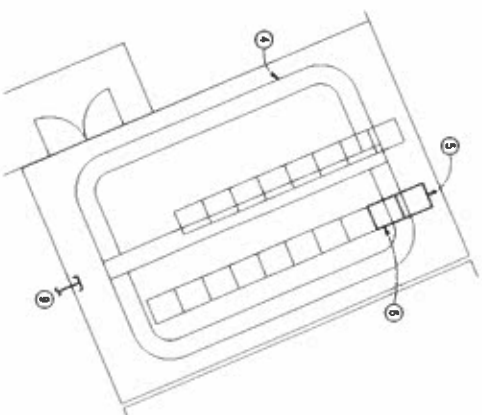

LARGE SCALE DATA ROOM
SCALE: 3/16" = 1'-0"

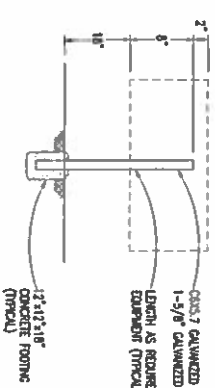
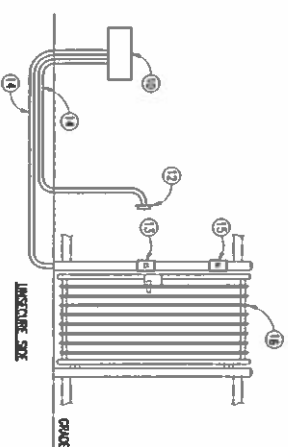
EQUIPMENT MOUNTING DETAIL
SCALE: NONE

ACCESS CONTROL DETAIL
SCALE: NONE

- GENERAL NOTES:**
- A. CONTRIBUTE SMALL JACK AND BORE AT CONCRETE SERVICES. DO NOT CUT
 - B. EXISTING ACCESS OPEN PAVEMENT IS A LIDED SYSTEM. ONLY A LIDED, CEMENTED TECHNICIAN IS AUTHORIZED TO WORK THE SYSTEM. PROVIDE ALL ACCESS ORDNANCE COMMENTS FOR A COORDINATED, INTEGRATED AND ORDNANCE ACCESS CONTROL SYSTEM.
 - C. NO WORK IS SCHEDULED FOR PAVEMENT Joints 1, 4, 8, 12, 14, AND 17. NO WORK IS REQUIRED FOR ANY OF THE REMAIND CURES.
 - D. LOCATE ALL AVAILABLE STREETS WITHIN 500' RADIUS. PARTICIPATING BUREAU FOR VEHICLE AND UTILITIES IN CLOSURE. REPAIR PAVEMENT TO MEET UTILITIES AT NO ADDITIONAL COST.

- NOTES:**
(THIS SHEET ONLY)

- ① DRESSING ROOM: 204/120 VAL. SINGLE PLYST. LAMINATED 1-11-55 MOORE & GARDNER DISCLOSED. PROVIDE A NEW 20/16 PLYST. MOORE & GARDNER IN EXISTING SPACE FOR CONNECTION TO NEW GATE. LABEL BROKEN.
- ② 11-55/1-55/2 CONCRETE UNDERGROUND FROM NEW BEYOND A CONCRETE WALL TO EXISTING CONCRETE WALL. PROVIDE REINFORCEMENTS. ROUTE CONCRETE MOORE & GARDNER DISCLOSED. EXPOSED. THEN DOWN WALL OF EXISTENCE TO 12" ABOVE GATE AND PERFORATE WALL. ROUTE UNDERGROUND TO GATE. MAKE CONNECTIONS TO NEW BEYOND.
- ③ SET DATA ROOM IDENT. THIS SHEET.
- ④ DRESSING CHAIR: REMOVE. UTILIZE EXISTING GATE. REMOVE FOR NEW ENTRY.
- ⑤ REMOVE (2) MEDIA CONNECTERS IN EXISTING ROOM. MEDIA CONNECTERS MUST CROSS OF ONE IN-45 CLUB FROM AND ONE IN. MATERIAL ROOM.
- ⑥ REMOVE (2) PART IN PATCH PANEL. PROVIDE 50 AMPHON FIBER PATCH CORDS FROM PATCH PANEL TO PROVIDED MEDIA CONNECTERS IN NOTE 3.
- ⑦ ELECTRICAL ROOM: FROM OUTSIDE OF THE ELECTRICAL ROOM TO ROOM. PATCH CORD AT ELECTRICAL ROOM TO EXISTENCE AT GATE 17. PROVIDE 12 STRAND 50/125 ALUMINUM GATE MOORE & GARDNER PROVIDE CABLE TERMINAL ONE END OF FIBER ON CONDUIT/PROVIDED PATCH PANEL FROM GATE 17. TERMINATE OTHER END OF FIBER ON PATCH PANEL AT GATE 17.
- ⑧ PROVIDE TWO PULL BOXES. STED FOR M.C. TO ROUTE FIBER INTO BUILDING. REMOVE THE OLD PULL BOX ON THE EXISTING WALL. CLOSE TO GATE AS POSSIBLE. INSTALL OTHER PULL BOX ON INTERIOR WALL AT SAME HEIGHT AS EXISTING PULL BOX.
- ⑨ PROVIDE 4" CONDUIT WITH (2) 1-1/2" WIREBUSTERS THROUGH DATA ROOM WALL AND ELECTRICAL ROOM TO MEDIA CONNECTOR AND PATCH PANEL. PROVIDE 12 STRAND 50/125 ALUMINUM GATE MOORE & GARDNER WALL. USE A 10 GIGABIT CLAMP. ROUTE CONDUIT AND WIREBUSTERS DOWN TO INTERIOR PULL BOX. COORDINATE WITH COR AND MTC & FIBERSAFE AS REQUIRED TO MAINTAIN THE RATING.
- ⑩ PROVIDE A WIREMALL 10'x4'x21" x 20'0 (20) FEET 4" EXISTENCE WITH (2) 1-1/2" WIREBUSTERS. PROVIDE 12 STRAND 50/125 ALUMINUM GATE MOORE & GARDNER CHANNEL. ROOM AND NECESSARY WIREMALL TO MAINTAIN THE RATING. PROVIDE 12 STRAND 50/125 ALUMINUM GATE MOORE & GARDNER CHANNELS TO FIT EXISTENCE. INCLUDING THIS FOR EMPLOYMENT. INCLUDING: PROVIDE FOLLOWING: EXISTENCE AND MOUNT TO SHIELDS. REMOVE THE DISCLOSED. 12 PORT IN TERMINATION BOX. MEDIA CONNECTOR WITH (2) 1-1/2" WIREBUSTERS. PROVIDE 12 STRAND 50/125 ALUMINUM GATE MOORE & GARDNER PART IN PATCH PANEL. PROVIDE 50 AMPHON FIBER PATCH CORD FROM PATCH PANEL TO MEDIA CONNECTOR. PROVIDE CABLE PATCH CORD FROM MEDIA CONNECTOR TO LABEL. P. GOOD CONNECTION. PROVIDE 20 AMP DUPLEX CABLE WITH COR AND OVERLAY. REMOVE EXISTENCE TO PATCH MEDIA CONNECTOR AND P. GOOD CONNECTION.
- ⑪ INTERCOM: REMOVE FROM EXISTENCE AT GATE 17. DISCLOSED AT GATE 15. PROVIDE 4" GATE CABLE WITH (2) 1-1/2" WIREBUSTERS. PROVIDE EXISTENCE AT GATE 17 TO EXISTENCE AT GATE 15. PROVIDE 6 STRAND 50/125 ALUMINUM GATE MOORE & GARDNER FIBER CABLE. TERMINATE ONE END OF FIBER ON PATCH PANEL. IN EXISTENCE AT GATE 17. DISCLOSED WITH ONE 10' TERMINAL OTHER END ON PATCH PANEL. IN EXISTENCE AT GATE 15.
- ⑫ PROVIDE FIBER/PATCH CORD RACK. EXISTENCE SHALL BE INSTALLED WITH A 12-12-18" CONCRETE FORMING. CABLE RACKER MUST BE OUTDOOR RATED.
- ⑬ ELECTRICAL STONE.
- ⑭ 1" RED CONCRETE WITH ACCESS CONTROL CHAIRING. TURN UP IN BOTTOM OF CABLE SOURCE. LABEL OR FEDERAL.
- ⑮ DOOR POSITION: SWITCH.
- ⑯ PRINTER: PLACE. FIBER/STAMP GATE.

CONSULTANTS:

CLARKNEXSEN

440 Martin Luther King Jr Blvd
Macon, GA 31201
478.743.8415 Fax: 478.743.8239
www.churchwomen.com



ARCHITECT/ENGINEERS



690 MEANS STREET NW, STE. 200, ATLANTA, GA 30318

ELECTRICAL SITE PLAN

INSTALL PERIMETER FENCE

VAMC GAINESVILLE, FL

04-29-2018

RB

Two

FINAL SUBMITTAL

**OFFICE OF
CONSTRUCTION
AND FACILITIES
MANAGEMENT**

 Department of
Veterans Affairs