

- GENERAL NOTES:**
1. REFER TO H5 SERIES FOR PHASING DRAWINGS.
  2. ALL WORK, MATERIALS & EQUIPMENT ARE NEW UNLESS INDICATED AS EXISTING.
- KEYED NOTES (THIS SHEET ONLY)**
1. 4" CHILLED WATER SUPPLY AND RETURN LINES TO ROOFTOP UNIT 1-RTU7W. REFER TO H5.03 FOR CONTINUATION.
  2. 2" LPS LINE TO ROOFTOP UNIT 1-RTU7W. REFER TO H5.03 FOR CONTINUATION AND H3 SERIES FOR DETAILS.
  3. CONNECT NEW DUCTWORK TO EXISTING. REFER TO H4.01 FOR POINT OF CONNECTION AND VERIFY EXACT LOCATION AT FIELD.
  4. DUCT HUMIDITY TRANSMITTER FOR CONTROL OF 1-SH1. REFER TO H7 SERIES FOR CONTROL ALGORITHMS AND SCHEMATICS.
  5. DUCT HUMIDITY TRANSMITTER FOR CONTROL OF 1-SH2. REFER TO H7 SERIES FOR CONTROL ALGORITHMS AND SCHEMATICS.
  6. CONNECT NEW DUCTWORK TO EXISTING. EXHAUST FAN AND PROVIDE SMOKE DETECTOR IN VERTICAL SECTION (REFER TO H7 SERIES FOR HVAC CONTROLS). BALANCE FAN AT 6005 CFM, 6005 RPM.
  7. PROVIDE DAMPER AND SMOKE DETECTOR IN VERTICAL SECTION OF DUCT. REFER TO H7 SERIES FOR HVAC CONTROLS.
  8. RELOCATE EXISTING FAN COIL AND PIPING TO ACCOMMODATE DUCTWORK FROM 1RTU-7W. CHILLED WATER AND HOT WATER PIPING FROM RISER TO FAN COILS SHALL BE RELOCATED UNDER WALKWAY. RELOCATE EXISTING AIR DEVICES AND THERMOSTAT FROM 1727 TO 1728.
  9. 12 X 12 EXHAUST BRANCH TAKEOFF FROM BELOW. PROVIDE VOLUME DAMPER IN VERTICAL BRANCH.
  10. PROVIDE 22 GAUGE SHEET METAL SLEEVE OVER INSULATION WHERE PIPE CROSSES WALKWAY. PIPE SHALL BE LOCATED 6" FROM TOP OF TRUSS.
  11. PROVIDE 22 GAUGE SHEET METAL SLEEVE OVER INSULATION WHERE PIPE CROSSES WALKWAY. PIPE SHALL BE LOCATED 6" FROM TOP OF TRUSS.
  12. 1" LPS LINE FROM ROOFTOP UNIT 1-RTU7W. REFER TO H5.03 FOR CONTINUATION AND H3 SERIES FOR DETAILS.
  13. PROVIDE TERMINAL BOX CONTROL VALVE PIPING BRANCHES FROM HWS & HWR RISER AS SHOWN IN H3 SERIES. PROVIDE GATE VALVE IN HWS & HWR RISER ABOVE TERMINAL BOX BRANCHES.
  14. LPS LINE SHALL BE LOCATED BEHIND THE WALKWAY.
  15. PNEUMATIC TUBE RISE.

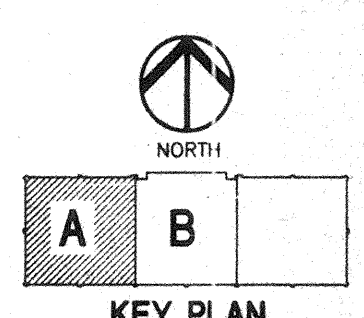

Revisions Date	<p><b>GARZA/BOMBERGER &amp; ASSOCIATES</b> ARCHITECTS PLANNERS 8848 FREDERICKSBURG RD. SUITE 100 SAN ANTONIO, TEXAS 78229</p> <p><b>GOETTING &amp; ASSOCIATES, INC.</b> MECH/ELEC. ENGINEERS</p>	<p>EXP. 2-28-95 2-6-15</p>	Drawing Title <b>MECHANICAL SEVENTH FLOOR AREA A - HVAC</b> Scale: 1/4" = 1'-0"		Project Title <b>EXPAND BONE MARROW UNIT - AUDIE L. MURPHY MEMORIAL HOSPITAL</b>		Date 03 FEB. 95			
			Approved: Chief Engineering		Project Number <b>871-083</b>		Building Number <b>1</b>		Checked <b>JBR</b>	
			Approved: Associate Director		Drawn <b>RAC</b>		Location <b>VAMC - SAN ANTONIO, TX.</b>		Drawing No. <b>H5.01</b>	
									Dwg. 1 of 3	