

LEGEND

NEW STUD WALLS

EXISTING WALLS TO REMAIN

ONE HOUR FIRE / SMOKE PARTITION (U-425)
SEAL TO UNDERSIDE OF DECK (SEE SHEET
A1.3 FOR LOCATION OF RATED WALLS)

EXISTING STRUCTURAL STEEL COLUMN

PUSH PAD FOR POWERED DOOR
OPENER

H.C. ACCESSIBLE SHOWER CONTROLS IN
PATIENT LITTER BATHS

FIRE EXTINGUISHER

SEE SHEET A-9.1 / A-9.2 FOR
WALL TYPE DETAILS/SECTIONS

INTERIOR ELEVATIONS

WINDOW/ CURTAIN WALL NUMBER

DOOR NUMBER

- NOTES:
1. ALL CORRIDOR WALLS, RATED OR NON-RATED, SHALL HAVE 5/8" GYP. BOARD CONTINUOUS ABOVE CEILINGS TO ROOF DECK AND SEALED. ALL PENETRATIONS SHALL BE SEALED TO PREVENT PASSAGE OF SMOKE.
 2. ALL WALLS SHALL BE TYPE "A" UNLESS OTHERWISE NOTED (REFER TO SHEET A9.1)

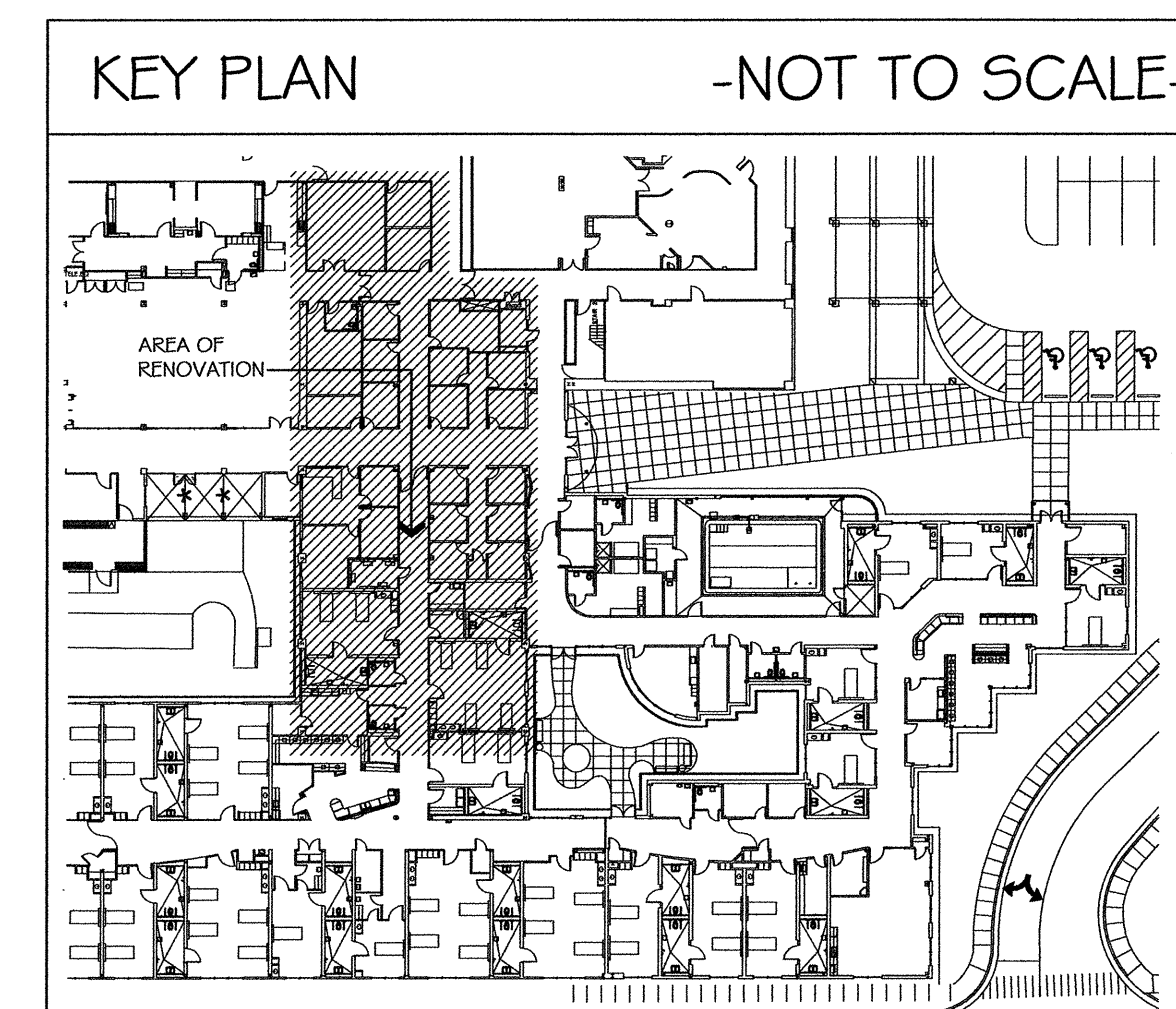

REVISIONS:	DATE:	DRAWN BY:		VIRGO GAMBILL ARCHITECTS 2531 CENTER WEST PARKWAY, SUITE 200 AUGUSTA, GEORGIA 30909 (706) 736-3661	MEMBERS OF THE AMERICAN INSTITUTE OF ARCHITECTS THIS DOCUMENT IS PROPERTY OF VIRGO GAMBILL ARCHITECTS. THE UNAUTHORIZED REPRODUCTION, COPYING, OR OTHERWISE USE OF THIS DOCUMENT IS STRICTLY PROHIBITED AND ANY INFRINGEMENT THEREUPON IS SUBJECT TO LEGAL ACTION. 2007 © VIRGO GAMBILL ARCHITECTS	APPROVED BY:	PROJECT TITLE:	DATE:
		J. OLIVER				MEDICAL CENTER DIRECTOR	RENOVATE "E" WING BUILDING 801, DOWNTOWN DIVISION AUGUSTA, GEORGIA	APRIL 29, 2011
		CHECKED BY:				APPROVED BY:	DRAWING TITLE:	VA PROJECT NO.
		R. S. VIRGO				FACILITY MANAGEMENT SERV LINE EXEC	NEW WORK DIMENSION PLAN	509-318E
								DRAWING NO.
								801-A1.2
								DWG. 7 of 44

Department of Veterans Affairs
VAMC Augusta, Georgia
Engineering Department (138)