

- DEMOLITION WORK KEYED NOTES:**  
(THIS DRAWING ONLY)
- 1 EXISTING SANITARY SEWER RISER TO REMAIN.
  - 2 EXISTING DOMESTIC HOT WATER RETURN RISER TO REMAIN.
  - 3 EXISTING CONDENSATE DRAIN PIPING TO REMAIN.

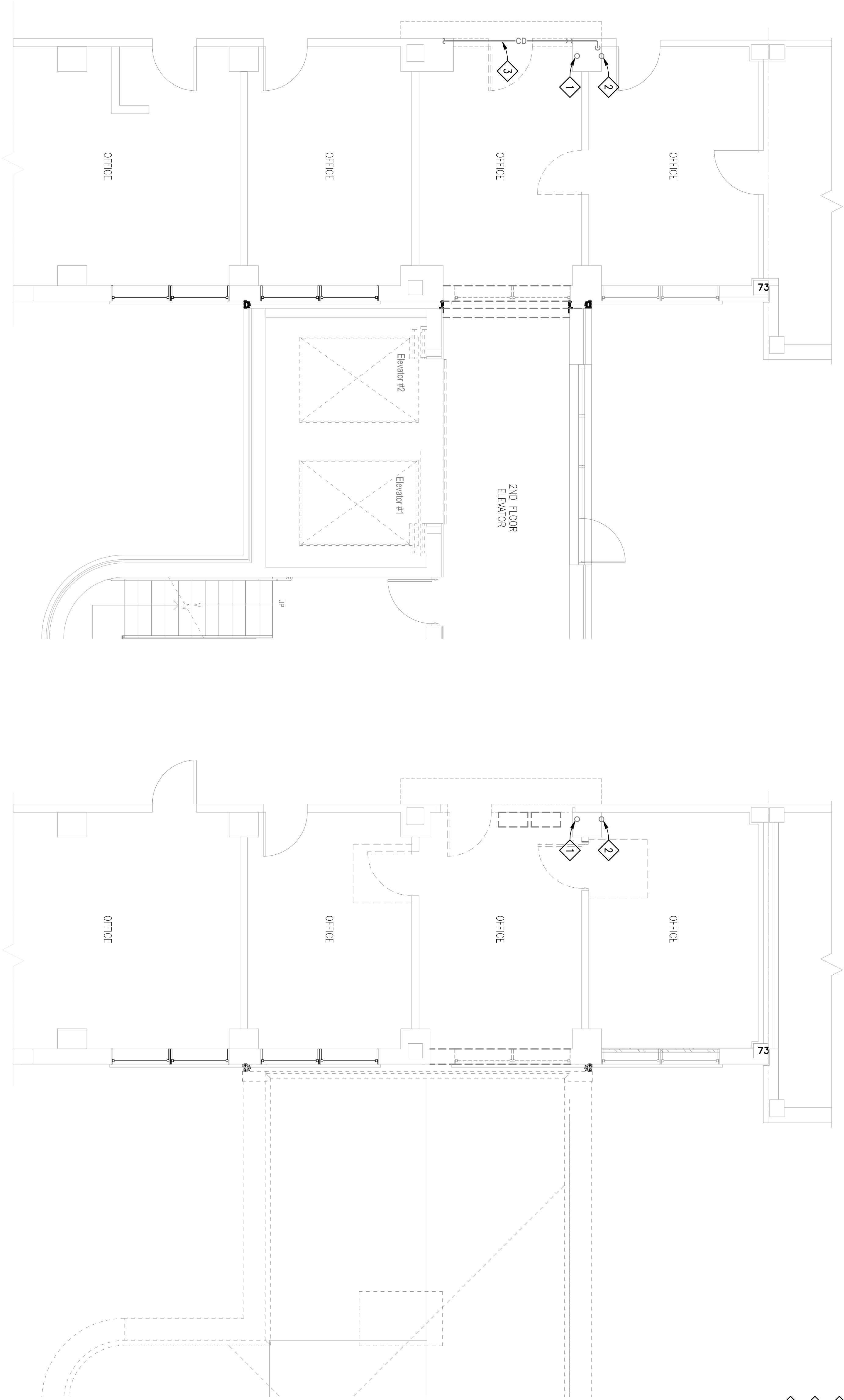

ENLARGED DEMOLITION FLOOR PLAN  
2ND FLOOR STAIRS – PLUMBING

SCALE: 1/4" = 1'-0"

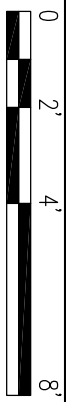

ENLARGED DEMOLITION FLOOR PLAN  
3RD FLOOR STAIRS – PLUMBING

SCALE: 1/4" = 1'-0"

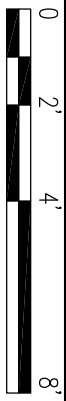

Revisions	Date

Toland ♦ Mizell ♦ Molnar, LLC  
590 MEANS STREET NW,  
SUITE 200  
ATLANTA, GA, 30318  
404-214-9774

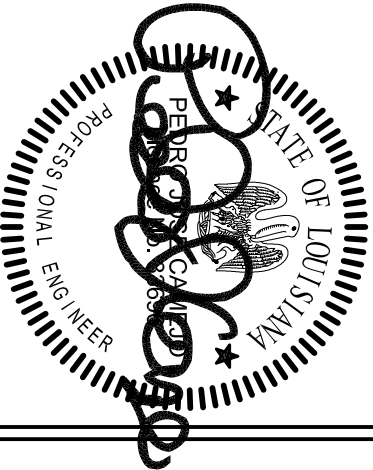

Drawing Title
ENLARGED DEMO FLOOR PLANS 2ND AND 3RD FLOOR STAIRS – PLUMBING
Approved Project Engineer

Project Title
2ND FLOOR OUTPATIENT MENTAL HEALTH
Building Number
BLDG 1 SOUTH WING
Checked
RDT
Drawn
DLB
Location
VA MEDICAL CENTER SHREVEPORT, LOUISIANA

Date
05-25-2011
Project No.
VA256-C-1047
DRAWING NO.
PD401
Day - 01

Veterans  
Administration

100% REVIEW  
SUBMITTAL