

MECHANICAL LEGEND		
SYMBOL	NAME	DESCRIPTION
	SUPPLY	SUPPLY DIFFUSER
	RET-RT	RETURN DIFFUSER
	EXH-RT	EXHAUST DIFFUSER
	SUP-AR	SUPPLY ARROW
	RET-AR	RETURN ARROW
	EXH-AR	EXHAUST ARROW
	TU	AIR TERMINAL UNIT
	AHU	AIR HANDLING UNIT
	UH	UNIT HEATER
	VDAMPER	VOLUME DAMPER
	FDAMPER	FIRE DAMPER
	MDAMPER	MANUAL BALANCING DAMPER
	ADAMPER	AIR DAMPER
	TE-ELBOW-UP	TEE-ELBOW UP
	TE-ELBOW-DOWN	TEE-ELBOW DOWN
	ELBOW-DOWN	ELBOW DOWN
	CAPS	FOR CLOSING PIPE
	RISER	PIPE RISER
	DROP	PIPE DROP
	ELBOW	PIPE ELBOW
	ELBOW-90	PIPE ELBOW AT 90°
	TEE-PLAN	TEE PIPE CONNECTION
	CROSS	CROSS
	LOUVER	LOUVER
	THERMO	THERMOSTAT
	MEDUP	MECHANICAL EQUIPMENT
	EXH-FAN	EXHAUST FAN
	RHUNT	REHEATING UNIT
	PIPE-SECT	PIPE SECTION
	PIPE-SECT	PIPE SECTION
	AIR	AIR
	SVD	SVD
		FOR EQUIPMENT NUMBERS SHOWN IN HEXAGON
		FOR DUCT NUMBERS
	FIRE-DAMP	FIRE DAMPER
	HUMIDSTAT	HUMIDISTAT
	SMOKE-DAMP	SMOKE DAMPER
	FAN COIL UNIT	FAN COIL UNIT
	GATE VALVE	GATE VALVE
	GLOBE VALVE	GLOBE VALVE
	RELIEF VALVE	RELIEF VALVE OR PRESSURE RELIEF
	CHECK VALVE	CHECK VALVE
	THREE-WAY MODULATING CONTROL VALVE	THREE-WAY MODULATING CONTROL VALVE
	TWO-WAY MODULATING CONTROL VALVE	TWO-WAY MODULATING CONTROL VALVE
	PRESSURE REDUCING VALVE	PRESSURE REDUCING VALVE
	MANUAL AIR VENT (COILS)	MANUAL AIR VENT (COILS)
	FLOW SETTER BALANCING VALVE	FLOW SETTER BALANCING VALVE
	MANUAL AIR VENT	MANUAL AIR VENT
	ANGLE GATE VALVE	ANGLE GATE VALVE
	ANGLE GLOBE VALVE	ANGLE GLOBE VALVE
	BUTTERFLY VALVE	BUTTERFLY VALVE
	TEST PLUG (PRESSURE/TEMPERATURE)	TEST PLUG (PRESSURE/TEMPERATURE)
	FAN	SUPPLY/RETURN FAN
	VAV BOX	VAV BOX
	CONCENTRIC REDUCER	CONCENTRIC REDUCER
	SPD	SPD
	CIRCULAR SUPPLY DIFFUSER	CIRCULAR SUPPLY DIFFUSER
	CIRCULAR RETURN DIFFUSER	CIRCULAR RETURN DIFFUSER
	FLOOR DRAIN	FLOOR DRAIN
	CHILLED WATER PUMP	CHILLED WATER PUMP
	STEAM TRAP	STEAM TRAP
	HC	HC

NOTES BY SYMBOL: SEE MECHANICAL BAY 1-12 (DRAWING 1A-222)

1. AFTER - FILTER SECTION  
2. DIFFUSER SECTION  
3. FLEX SECTION  
4. FAN SECTION  
5. COILING COIL  
6. ACCESS SECTION  
7. PRE-HEAT COIL SECTION  
8. PRE-HEAT SECTION  
9. MIXED AIR SECTION  
10. 4" HIGH HOODKEEPING PAD  
11. VIBRATION ISOLATOR  
12. FAN COIL UNIT 100-1206  
13. RETURN AIR FAN 100-1027  
14. GENERAL EXHAUST FAN 100-1020  
15. OUTSIDE AIR DAMPER  
16. OUTSIDE AIR LOUVER  
17. 2" HIGH x 8" WIDE x 8" DEEP ACCESSORY UNITS  
18. EXHAUST AIR PLUMB SHALL CONNECT TO A MINIMUM OF 5' OF DUCT  
19. FAN MOTOR  
20. 10" HIGH x 8" WIDE x 8" DEEP ACCESSORY UNITS  
21. EXHAUST AIR PLUMB SHALL CONNECT TO A MINIMUM OF 5' OF DUCT  
22. COL. PULL SPACE  
23. 1/4" HIGH x 1/4" WIDE PLUMB ACCESS PANEL  
24. MOTOR DAMPER  
25. 5/8" PLUMB ACCESS PANEL  
26. FREQUENCY WARNER FOR 100-1027  
27. 100-1  
28. 100-2

SHEET NOTES :  
1. SEE GENERAL ARCHITECTURAL NOTES,  
DWG X-4

RADIOLOGY - 276  
ORTHOPEDIC CLINIC - 258  
ABULATORY CARE - 262  
SEE DET PLAN 100-118

SHEET NOTES:  
1. SEE GENERAL ARCHITECTURAL NOTES,  
DWS X-4.

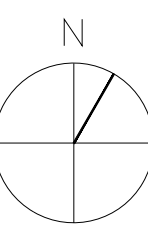
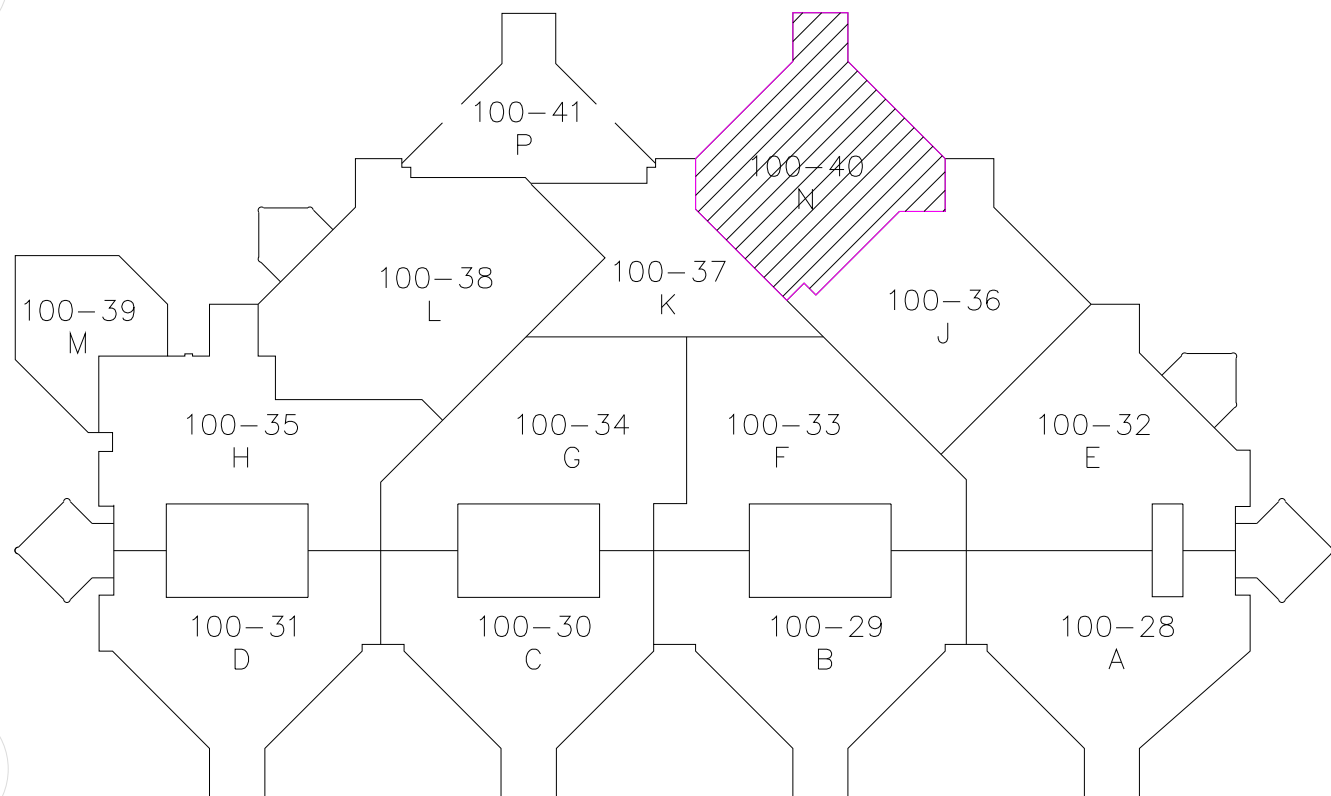

RECORD DRAWING 1. AMENDMENT NO. 1 2. AMENDMENT NO. 2 3. 100-1-10 4. 100-1-102	8-3-87 26 FEB 87 27 FEB 87 10 NOV 87 24 AUG 95 18 JAN 2005	Professional Seal	Drawing Title FIRST FLOOR PLAN - AREA N MECHANICAL	Project Title AS-BUILT Drawings	Date 2 JAN 87 Project No. 580-040 Drawing No. 100-28R2	VAMC, HOUSTON Department of Veterans Affairs
Revisions	Date		Approved:	Building Number 100	Checked Drawn	
			Approved:	Location VAMC, HOUSTON TEXAS.		