

INLET 1 WITH OUTLET CONTROL PLATE
NOT TO SCALE

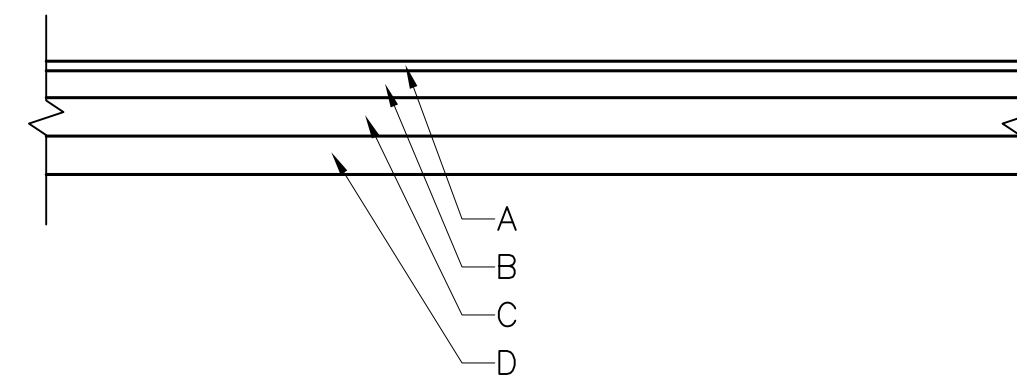

ASPHALT PAVEMENT SECTION
NOT TO SCALE

FACILITY	POTENTIAL PROBLEM	REMEDIES:	ENTITY RESPONSIBLE**:
OUTLET PROTECTION	DISLOGGED STONES EROSION BELOW OUTLET OUTLET SCOUR	REPLACE WITH LARGER STONES. ENLARGE RIPRAP APRON, OR LINE RECEIVING CHANNEL BELOW OUTLET. INSTALL PROPER FILTER FABRIC OR GRADED BEDDING BENEATH RIPRAP APRON.	CONTRACTOR ***
SUBSURFACE BASINS	OBSTRUCTED OUTLET BASIN NOT DEWATERING BETWEEN STORMS DAMAGED EMBANKMENTS SPILLWAY EROSION OUTLET EROSION GENERAL MAINTENANCE	REMOVE DEBRIS. CLEAR ORIFICE AND CHECK OUTLET PIPES FOR DEBRIS AND SEDIMENT. CLEAN INLET BOX GRATE. REBUILD AND COMPACT DAMAGED AREAS. * LINE SPILLWAY WITH ROCK OR FILTER FABRIC. MAKE SURE OUTLET IS FLUSH WITH GROUND AND ON LEVEL GRADE. INSTALL, EXTEND, OR REPAIR RIPRAP APRON AS REQUIRED. INSPECT THE SUBSURFACE DETENTION/INFILTRATION FACILITIES BETWEEN MAY 1 AND JUNE 1 OF EACH YEAR TO VERIFY ITS CONDITION. THE INSPECTION SHALL BE PERFORMED BY A QUALIFIED ENGINEER AND A CERTIFIED REPORT OF THE FINDINGS OF THE INSPECTION AND AN INDICATION OF ANY MAINTENANCE NEEDED TO PRESERVE THE FACILITY'S DESIGN CAPACITY SHALL BE SUBMITTED BY THE ENGINEER TO THE TOWNSHIP NO LATER THAN JUNE 30 OF EACH YEAR. THE DEVELOPER/OWNER SHALL BE RESPONSIBLE FOR ALL COSTS ASSOCIATED WITH THE INSPECTION AND REPORT.	CONTRACTOR ***
PIPES	CLOGGED PIPE	FLUSH PIPE	CONTRACTOR ***
INLET	SILT AND DEBRIS	REMOVE SILT AND DEBRIS	CONTRACTOR ***
EROSION AND SEDIMENT CONTROL	SOIL EROSION IN DISTURBED AREAS AND EMBANKMENTS FOLLOWING CONSTRUCTION	IMPLEMENT EROSION AND SEDIMENT CONTROL PLAN. INSTALL AND MAINTAIN BMPs AS REQUIRED. INSTALL AND MAINTAIN ADDITIONAL BMPs AS NECESSARY TO MEET THE REQUIREMENTS OF THE EROSION AND SEDIMENT CONTROL PLAN AND REGULATORY AGENCIES.	CONTRACTOR ***

Diagram illustrating a cross-section of a curb and gutter. The curb is shown on the left, with a hatched area indicating the curb structure. The gutter slope is labeled "16.7:1". The gutter is labeled "EDGE OF PAVE/ SIDEWALK". The gutter is labeled "12" MIN". The gutter is labeled "16.7:1". The gutter is labeled "4:1 MAX.". The gutter is labeled "EXISTING GRADE". The gutter is labeled "PROVIDE 4" TOPSOIL, SEED, AND MULCH". The gutter is labeled "PROVIDE FILL AS REQUIRED".

TYPICAL GRADING AT EDGE OF
PAVEMENT, SIDEWALK, AND NEW WORK

SEE ASPHALT PAVEMENT SECTION DETAIL

12" CRAFCO JOINT SEALANT
SEE NOTE 2

EXISTING BITUMINOUS PAVEMENT

FULL DEPTH SAWCUT
(SEE NOTE 2)

1'-0" MIN.

This diagram shows a cross-section of a full depth sawcut joint in asphalt pavement. A vertical line indicates the sawcut. To the left of the cut is the 'EXISTING BITUMINOUS PAVEMENT'. To the right is a new section of pavement. A '12" CRAFCO JOINT SEALANT' is applied along the cut surface. A dimension line indicates a minimum width of '1'-0" MIN.' for the new pavement section. A reference line points to the top of the pavement, labeled 'SEE ASPHALT PAVEMENT SECTION DETAIL'.

NOTES:
1. EXISTING GRADES SHALL BE MAINTAINED.
2. PROVIDE 12" CRAFTCO JOINT SEALANT

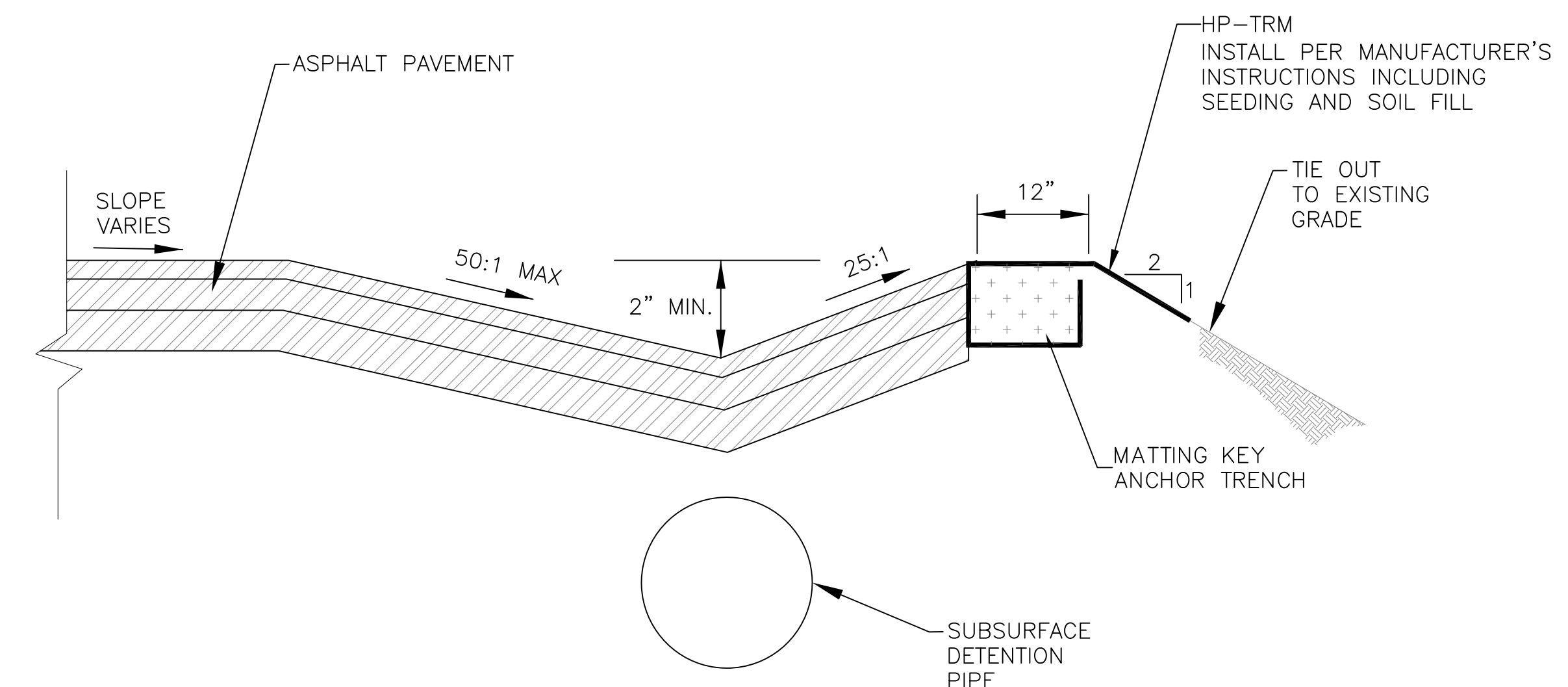
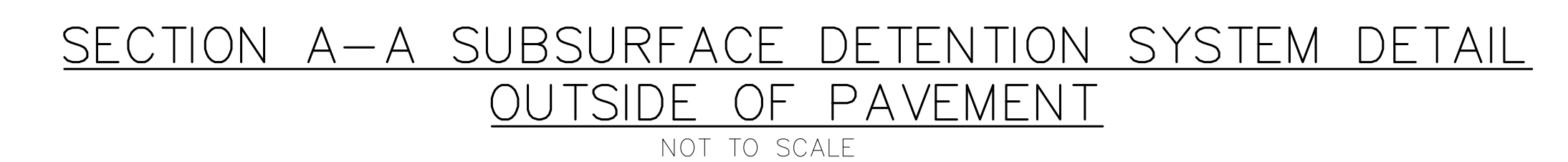

SECTION B-B SUBSURFACE DETENTION SYSTEM DETAIL
WITHIN PAVEMENT
NOT TO SCALE

CONSTRUCTION DOCUMENTS

Project Title PARKING LOT 7 EXPANSION		Date 06/23/2016
		Project No. 528A5-16-505
Building No. LOT 7	Checked CJC	Drawn TAD
Location CANANDAIGUA, NEW YORK		C-501 Dwg. 10 of 20

TS
 VA