

EXPAND EMERGENCY POWER GENERATION for the ERIE VAMC



PROJECT NO. 562-13-112

ERIE VA MEDICAL CENTER

135 E 38TH ST

ERIE, PA 16504

814-868-8661

| DRAWING INDEX | |
|---------------|--|
| SHEET # | SHEET NAME |
| GENERAL | |
| G001 | COVER SHEET |
| G002 | ENLARGED SITE PLAN |
| CIVIL | |
| C001 | EXISTING CONDITIONS PLAN |
| C100 | SITE PLAN |
| C101 | STORMWATER MANAGEMENT AND GRADING PLAN |
| C102 | UTILITY RELOCATION PLAN |
| C103 | PROPOSED UTILITIES PLAN |
| C104 | EROSION AND SEDIMENT CONTROL PLAN |
| C501 | CONSTRUCTION DETAILS |
| C502 | EROSION AND SEDIMENT CONTROL PLAN DETAILS |
| ARCHITECTURAL | |
| A001 | ARCHITECTURAL SYMBOLS, ABBREVIATIONS AND GENERAL NOTES |
| A002 | STRUCTURAL NOTES AND DUNNAGE DETAIL |
| A101 | ARCHITECTURAL PLANS AND ELEVATIONS |
| A201 | SECTIONS AND DETAILS |
| A301 | DOOR SCHEDULE AND MISCELLANEOUS DETAILS |
| PLUMBING | |
| P001 | PLUMBING PLANS, SYMBOLS AND ABBREVIATIONS, SCHEDULES & NOTES |
| MECHANICAL | |
| H001 | HVAC SYMBOLS, ABBREVIATIONS AND GENERAL NOTES |
| HD101 | HVAC - GENERATOR BLDG AND ROOM EE200 DEMOLITION PLANS |
| H101 | HVAC - GENERATOR BLDG PLANS |
| H102 | HVAC - ROOM EE200 PLANS (ALTERNATE #1) |
| H501 | HVAC DETAILS |
| H700 | HVAC SCHEDULES |
| H801 | HVAC CONTROL DIAGRAM |
| ELECTRICAL | |
| E001 | ELECTRICAL SYMBOLS, ABBREVIATIONS AND NOTES |
| E100 | ELECTRICAL SITE PLAN |
| ED101 | ELECTRICAL DEMOLITION |
| E201 | ELECTRICAL - ADDITION TO SWITCHGEAR BUILDING - POWER AND LIGHTING PLAN |
| E202 | ELECTRICAL - GENERATOR BLDG ROOF - LIGHTING AND POWER PLAN |
| E203 | ELECTRICAL - ROOM EE200 - POWER |
| E500 | ELECTRICAL DETAILS |
| E600 | ELECTRICAL RISER & CONTROLS DIAGRAM |
| E601 | ELECTRICAL EMERGENCY SYSTEM SINGLE LINE - EXISTING CONDITIONS |
| E602 | ELECTRICAL SINGLE LINE - NEW WORK |
| E603 | ELECTRICAL SINGLE LINE - NEW WORK - BUILDING 1 |
| E700 | ELECTRICAL SCHEDULES |
| SYSTEMS | |
| EF001 | FIRE ALARM SYMBOLS, ABBREVIATIONS AND NOTES |
| EF101 | FIRE ALARM PLAN - SWITCHGEAR BLDG & EE200 |
| ES001 | SECURITY SYMBOLS AND NOTES |
| ES100 | SECURITY - BUILDING 1 BASEMENT |
| ES101 | SECURITY PLAN - SWITCHGEAR BLDG |
| ES102 | SECURITY - BUILDING 1 LEVEL 1 |

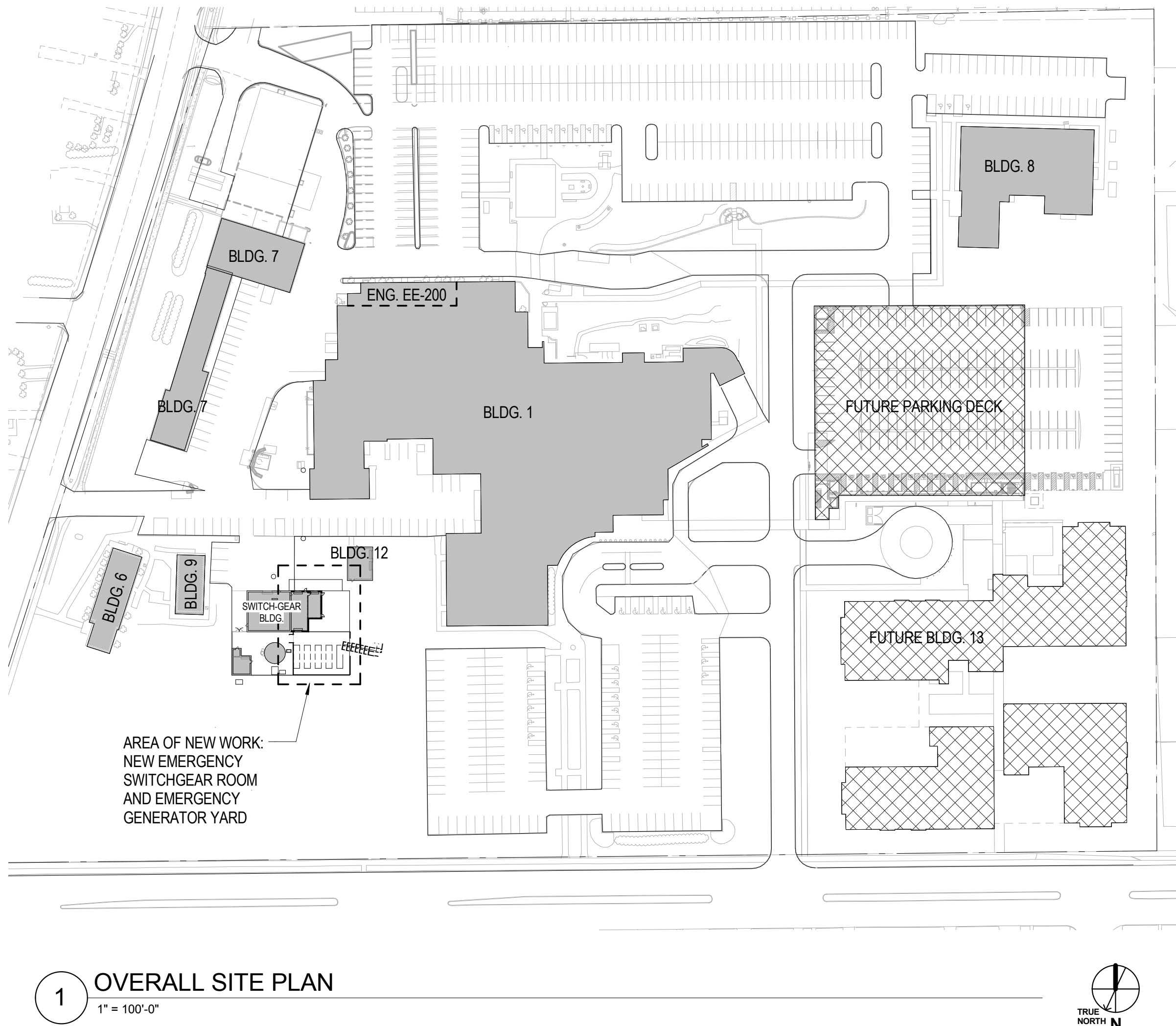

VICINITY MAP



SITE

LOCATION MAP



SITE

FULLY SPRINKLERED
CONSTRUCTION DOCUMENTS

| | | | | | | | | | | | | | | | | | |
|---|--|-----------------|--|--|--|---|--|---------------------------|--|--|--|----------------------|--|---|--|--|--|
| CONSULTANTS: | | SEAL | | ARCHITECTS/ENGINEERS: | | Approved: Director | | Drawing Title | | Project Title | | Project Number | | Office of Construction and Facilities Management | | | |
| BARBER & HOFFMAN 215 EXECUTIVE DRIVE #202 CRANBERRY TWP, PA 16066 | | | | URBAN ENGINEERS, INC. 1 WILLIAMSBURG PLACE, SUITE 210 WARRENDALE, PA 15066 | | Approved: Chief Operating Officer | | COVER SHEET | | EXPAND EMERGENCY POWER GENERATION for the ERIE VAMC | | 562-13-112 | | | | | |
| MOORE DESIGN ASSOCIATES 130 HEAVEN LANE MARS, PA 16046 | | | | AE WORKS AE Works Project Number: 13045 | | Approved: Vice President, Facilities Management | | Approved: Site Manager | | Location 135 E 38TH ST, ERIE, PA 16504 | | Building Number 1 | | | | | |
| REV: 1 Revisions: | | 7/01/16 Date | | | | Approved: Manager, Projects Section | | Approved: Project Manager | | Date 03/17/2016 | | Checked PR | | Drawn SB | | | |