

three inches = one foot
 one and one-half inches = one foot
 one inch = one foot
 three-quarters inch = one foot
 one-half inch = one foot
 three-eighths inch = one foot
 one-quarter inch = one foot
 one-eighth inch = one foot

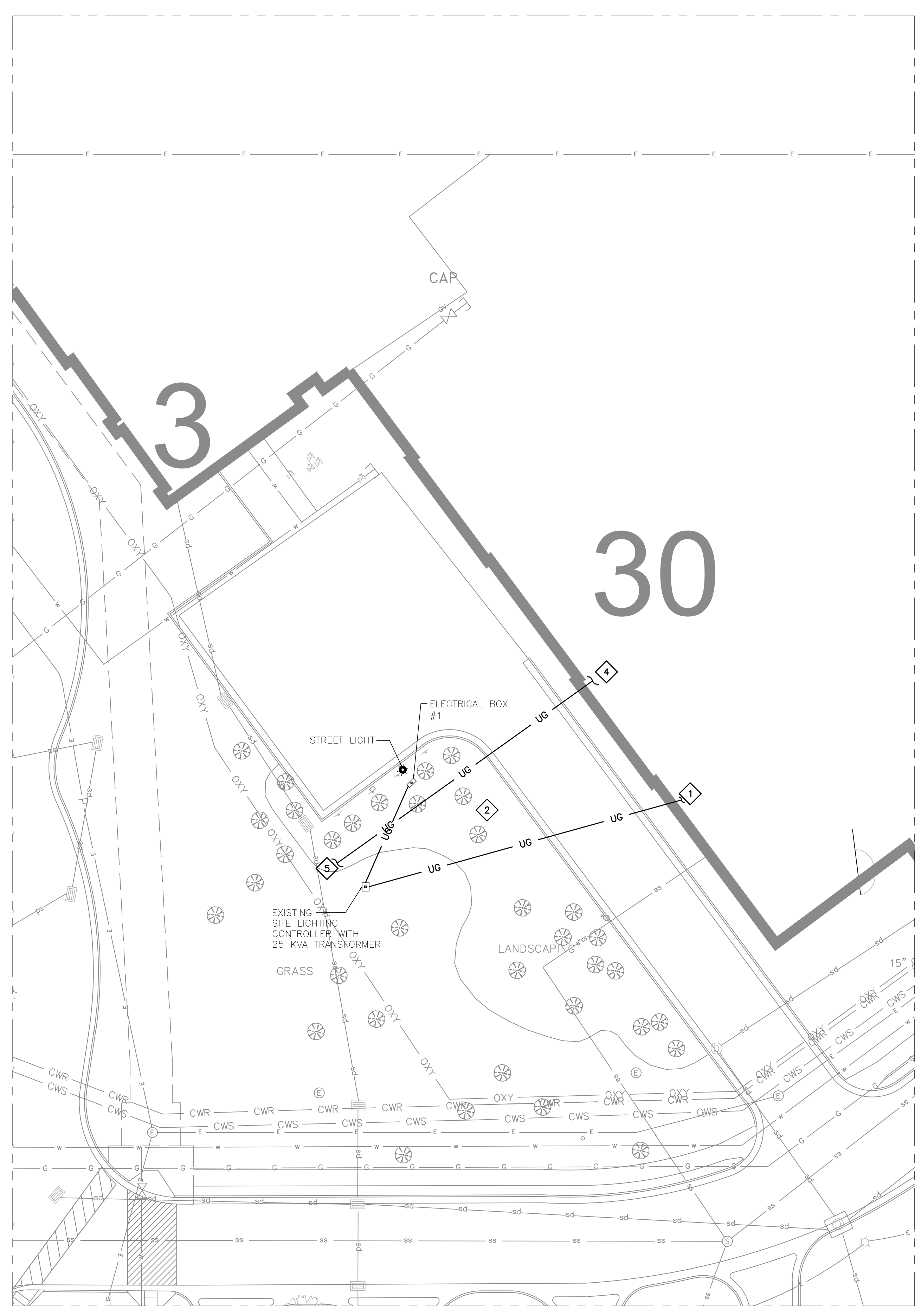

1 ELECTRICAL SITE PLAN-EXISTING
 E-200[E-200]
 1" = 20'

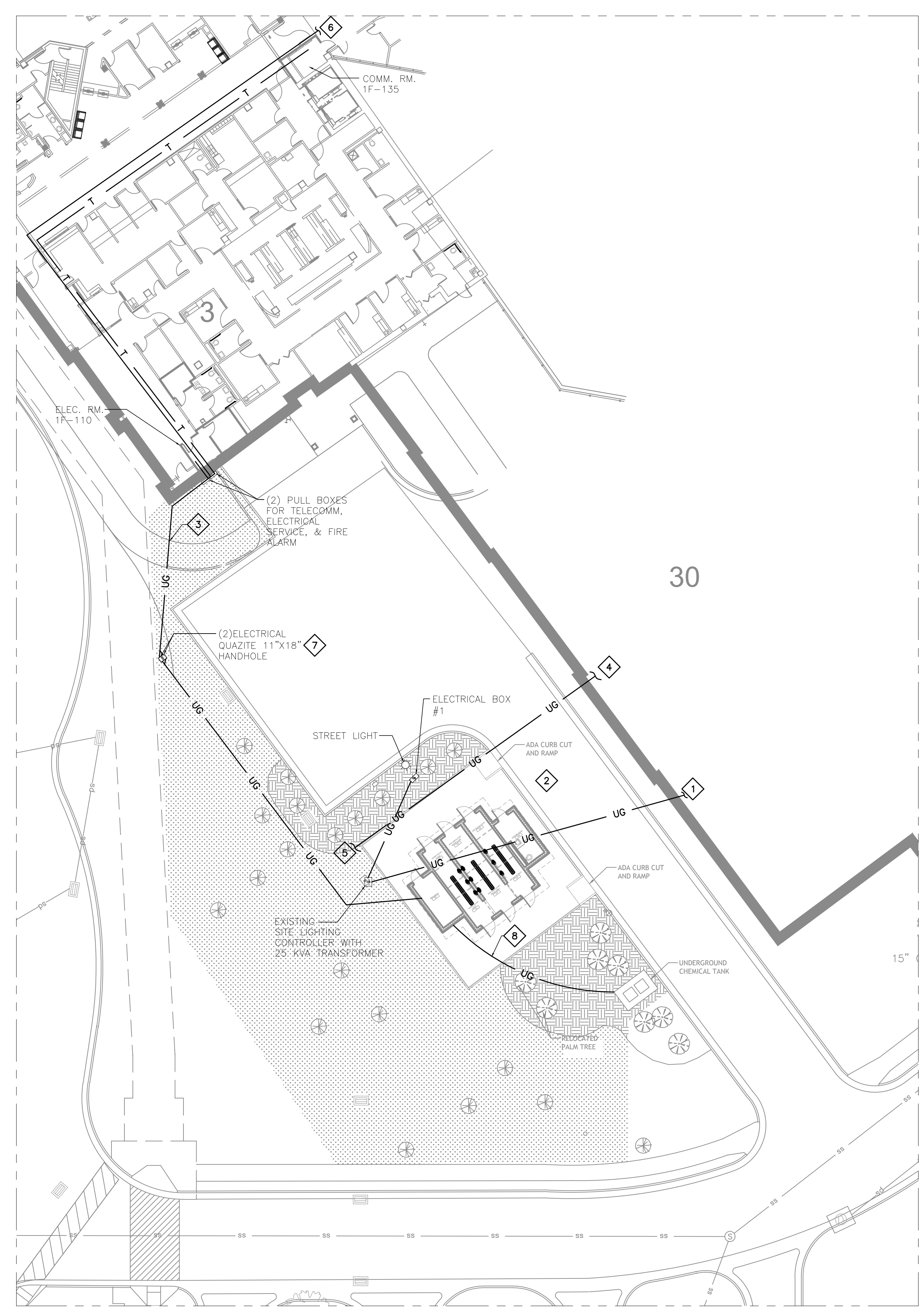

2 ELECTRICAL SITE PLAN-PHASE 1 INSTALL
 E-200[E-200]
 1" = 20'

E200 NOTES:

1. CONTRACTOR SHALL VERIFY EXACT ROUTING OF EXISTING UNDERGROUND RACEWAYS.
2. NOT ALL PULL BOXES ARE SHOWN. CONTRACTOR TO FURNISH AND INSTALL ALL PULL BOXES AS REQUIRED TO PROVIDE A COMPLETE AND FUNCTIONAL INSTALLATION THAT MEETS ALL APPLICABLE CODES.

E200 SPECIFIC NOTES:

- 1 TO EXISTING PANEL 3H1B
- 2 CONTRACTOR SHALL LOCATE ALL EXISTING UNDERGROUND RACEWAYS IN THE VICINITY OF THIS PROJECT PRIOR TO BREAKING GROUND. THE EXISTING RACEWAYS SHALL REMAIN AND TAKE PRIORITY OVER NEW CONSTRUCTION CONFLICTS. CONTRACTOR IS RESPONSIBLE FOR PROTECTING THE EXISTING RACEWAYS FROM DAMAGE. IF RACEWAYS AND CIRCUITS ARE DAMAGED DURING CONSTRUCTION CONTRACTOR SHALL REPAIR TO A LIKE NEW CONDITION WITHIN 24 HOURS OF DAMAGE AT NO ADDITIONAL COST TO THE OWNER.
- 3 PROVIDE (2) 2" AND (2) 1 1/4" CONDUITS FROM COMM ROOM 1F-135, ELECTRICAL PANEL IN ROOM 1F-110, AND CABINET 30 NEAR ROOM 1A-106 TO LOCATION SHOWN FOR NEW COMMUNICATION, ELECTRICAL SERVICE, AND FIRE ALARM PANEL IN DECONTAMINATION BUILDING.
- 4 TO EXISTING PANEL 3HP1.
- 5 TO POWER PEDESTAL AT CENTRAL LAWN.
- 6 (2) 1 1/4" CONDUITS WITH 62.5/125 MULTIMODE 6 STRANDED FIBER CABLE TO CABINET 30 NEAR ROOM 1A-106. CONTRACTOR IS TO FIELD LOCATE CABINET PRIOR TO BIDDING TO DETERMINE THE REQUIRED DISTANCE AND NUMBER OF PULL BOXES FOR RACEWAY RUN.
- 7 ROUTE ELECTRICAL SERVICE SEPARATE FROM COMMUNICATION AND (2) FIRE ALARM RACEWAYS IN EACH OF THE TWO QUAZITE BOXES.
- 8 CONTRACTOR TO FURNISH AND INSTALL A 1" PVC RACEWAY WITH PULL STRING FROM UNDERGROUND CHEMICAL TANK TO REMOTE LEAK MONITORING SYSTEM EQUIPMENT. COORDINATE ROUTING AND TERMINATION OF RACEWAY WITH MECHANICAL CONTRACTOR. MECHANICAL CONTRACTOR TO INSTALL CONDUCTORS IN RACEWAY PROVIDED AND PROVIDE A COMPLETE AND FUNCTIONAL SYSTEM INSTALLATION PER MECHANICAL DRAWINGS AND SPECIFICATIONS.

Revisions	Date

Consultants:

BKI BURK-KLEINPETER, INC.
 ENGINEERS, ARCHITECTS, PLANNERS, ENVIRONMENTAL SCIENTISTS
 4176 CANAL STREET, NEW ORLEANS, LA 70119-5994
 PHONE (504)486-5901 FAX (504)488-1714

Seal:

by *[Signature]* 07/16/15

A/E:

ROYAL ENGINEERS & CONSULTANTS, LLC
 4298 ELYSIAN FIELDS AVENUE
 NEW ORLEANS, LOUISIANA 70122
 www.royalengineering.net

Approved:

PROGRAM MANAGER, PROJECTS _____
 SAFETY/INDUSTRIAL HYGIENE _____
 HEALTH SYSTEM SPECIALIST _____
 MAINTENANCE SUPERVISOR _____
 MAINTENANCE FOREMAN _____
 MAINTENANCE FOREMAN _____

Drawing Title

ELECTRICAL SITE PLANS

Approved: Service Engineer _____
 Approved: Service Director _____

Project Title

VA Gulf Coast Decontamination Unit

Building Number: XX
 Checked: P.H.
 Drawn: C.V.
 Location: VAMC BILOXI, MS

Date: 07/16/2015
 Project No.: 520-13-136
 Drawing No.: **E200**
 Dwg. of: _____

FOR CONSTRUCTION

Department of Veterans Affairs