

PLANT SCHEDULE – IN GROUND CREMAINS AND PREPLACED CRYPTS

TREES	QTY	BOTANICAL NAME	COMMON NAME	CONT	SIZE	REMARKS
Qv	6	Quercus virginiana	Southern Live Oak	B & B	2" cal.	

LEGEND

- 439 PROPOSED CONTOUR LINE
- 439 EXISTING CONTOUR LINE
- 3'x7'-8" PRE-CAST LAWN CRYPTS
- 4'x4' IN-GROUND CREMAINS
- SM 13 BURIAL SECTION MARKER
- ZOYSIAGRASS SOD
- PENSACOLA BAHIAGRASS SEED
Paspalum notatum 'Pensacola'

NOTES:

- ALL DISTURBED AREAS TO RECEIVE ZOYSIAGRASS SOD UNLESS OTHERWISE INDICATED.
- RESTORE STAGING AREAS AS FOLLOWS (INCLUDING DISTURBED AREAS NOT SHOWN ON PLANTING PLANS:
 - REMOVE ALL CONSTRUCTION MATERIALS.
 - TILL SOIL TO 6" DEPTH.
 - SEED WITH PENSACOLA BAHIAGRASS
 - DISTURBED AREAS WITHIN 30 FT OF BACK OF CURB SHALL RECEIVE ZOYSIAGRASS SOD. SODDED AREAS SHALL HAVE 6" MINIMUM DEPTH TOPSOIL PRIOR TO SODDING.
- SEE 32 90 00 FOR PLANTING AND SEEDING REQUIREMENTS.

Revisions

Date

CONSULTANTS:

KCI TECHNOLOGIES

Aqua Engineering Inc.

ARCHITECT/ENGINEERS:

M·T·R LANDSCAPE ARCHITECTS

101 Bellevue Road Pittsburgh, PA 15229 (412) 931-6455

Drawing Title

PLANTING PLAN - PRE-PLACED CRYPTS & IN-GROUND CREMAINS

Approved Project Director

Project Title

Construct 1,361 Pre-Placed Crypts, 1,152 Niche Columbarium & 932 In-Ground Cremains

Location JACKSONVILLE NATIONAL CEMETERY
4083 Lannie Road Jacksonville, FL 32218

Date MARCH 10, 2016

Checked KR/MM

Drawn KR/AW

Project Number

928CM3001

Building Number

-

Drawing Number

L-40

Dwg. 20 of 41

BID SET

NATIONAL CEMETERY ADMINISTRATION OFFICE OF DESIGN AND CONSTRUCTION

Department of Veterans Affairs

PLANT SCHEDULE — COLUMBARIUM

<u>TREES</u>	<u>QTY</u>	<u>BOTANICAL NAME</u>	<u>COMMON NAME</u>	<u>CONT</u>	<u>SIZE</u>	<u>REMARKS</u>	
LxN	4	Lagerstroemia x 'Natchez'	Crape Myrtle	Cont.	10' ht.	Multistemmed (3-5 stems)	
UpE	5	Ulmus parvifolia 'Emer II'	Allee Lacebark Elm	B & B	3" cal.		
<u>SHRUBS</u>	<u>QTY</u>	<u>BOTANICAL NAME</u>	<u>COMMON NAME</u>	<u>CONT</u>	<u>SIZE</u>	<u>REMARKS</u>	
Vs	13	Viburnum suspensum	Sandankwa Viburnum	Cont.	3' ht.		
<u>SHRUB AREAS</u>	<u>QTY</u>	<u>BOTANICAL NAME</u>	<u>COMMON NAME</u>	<u>CONT</u>	<u>SIZE</u>	<u>SPACING</u>	<u>REMARKS</u>
LcR	47	Loropetalum chinense var. rubrum	Ruby Chinese Fringe Flower	Cont.	18" ht.	36" o.c.	
<u>GROUND COVERS</u>	<u>QTY</u>	<u>BOTANICAL NAME</u>	<u>COMMON NAME</u>	<u>CONT</u>		<u>SPACING</u>	<u>REMARKS</u>
LmBB	214	Liriope muscari 'Big Blue'	Big Blue Lilyturf	1 gal.		15" o.c.	
Tf	43	Tripsacum floridanum	Dwarf Fakahatchee Grass	3 gal.		24" o.c.	

LEGEND

	PROPOSED CONTOUR LINE
	EXISTING CONTOUR LINE
	ZOYSIAGRASS SOD
	PENSACOLA BAHIAGRASS SEED Paspalum notatum 'Pensacola'

NOTES:

- ALL DISTURBED AREAS TO RECEIVE ZOYSIAGRASS SOD UNLESS OTHERWISE INDICATED.
- RESTORE STAGING AREAS AS FOLLOWS (INCLUDING DISTURBED AREAS NOT SHOWN ON PLANTING PLANS:
 - REMOVE ALL CONSTRUCTION MATERIALS.
 - TILL SOIL TO 6" DEPTH.
 - SEED WITH PENSACOLA BAHIAGRASS
 - DISTURBED AREAS WITHIN 30 FT OF BACK OF CURB SHALL RECEIVE ZOYSIAGRASS SOD. SODDED AREAS SHALL HAVE 6" MINIMUM DEPTH TOPSOIL PRIOR TO SODDING.
- SEE 32 90 00 FOR PLANTING AND SEEDING REQUIREMENTS.

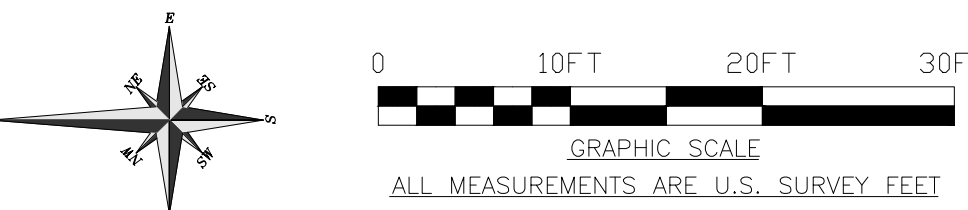

CONSULTANTS:

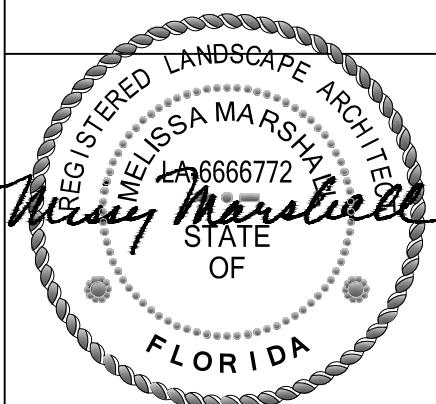

ARCHITECT/ENGINEERS:



Drawing Title
PLANTING PLAN - COLUMBARIUM

Approved Project Director

Project Title
Construct 1,361 Pre-Placed Crypts, 1,152 Niche Columbarium & 932 In-Ground Cremains

Location JACKSONVILLE NATIONAL CEMETERY
4083 Lannie Road Jacksonville, FL 32218

Date
MARCH 10, 2016

Checked
KR/MM

Drawn
KR/AW

Project Number
928CM3001

Building Number
-

Drawing Number
L-4.1

Dwg. 21 of 41

NATIONAL CEMETERY
ADMINISTRATION
OFFICE OF DESIGN
AND CONSTRUCTION



Scale: 1:10