

Plotting File: \\Projects\1313 Renovate Radiology & SPS VA Shreveport\3 1313 Drawings\Renovate Radiology & SPS - VA Shreveport\Sheets\A114 4TH FLOOR & ELEVATOR MACHINE ROOM REFLECTED CEILING PLANS.dwg
Plotted Date: May 20, 2015 - 3:56pm
C

A three inches = one foot
B one and one-half inches = one foot
C one inch = one foot
D three-quarters inch = one foot
E one-half inch = one foot
F three-eighths inch = one foot
G one-quarter inch = one foot
H one-eighth inch = one foot

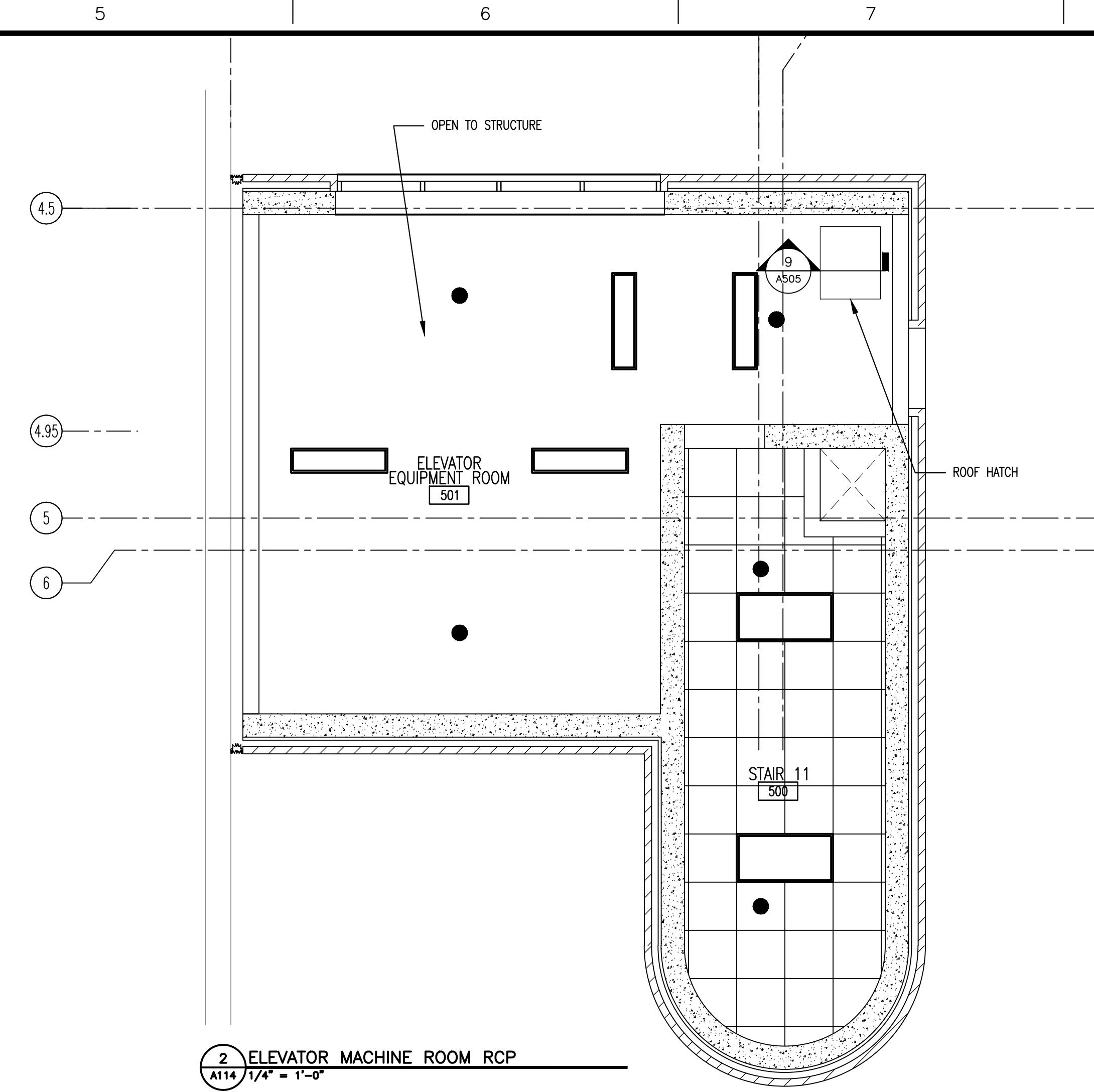
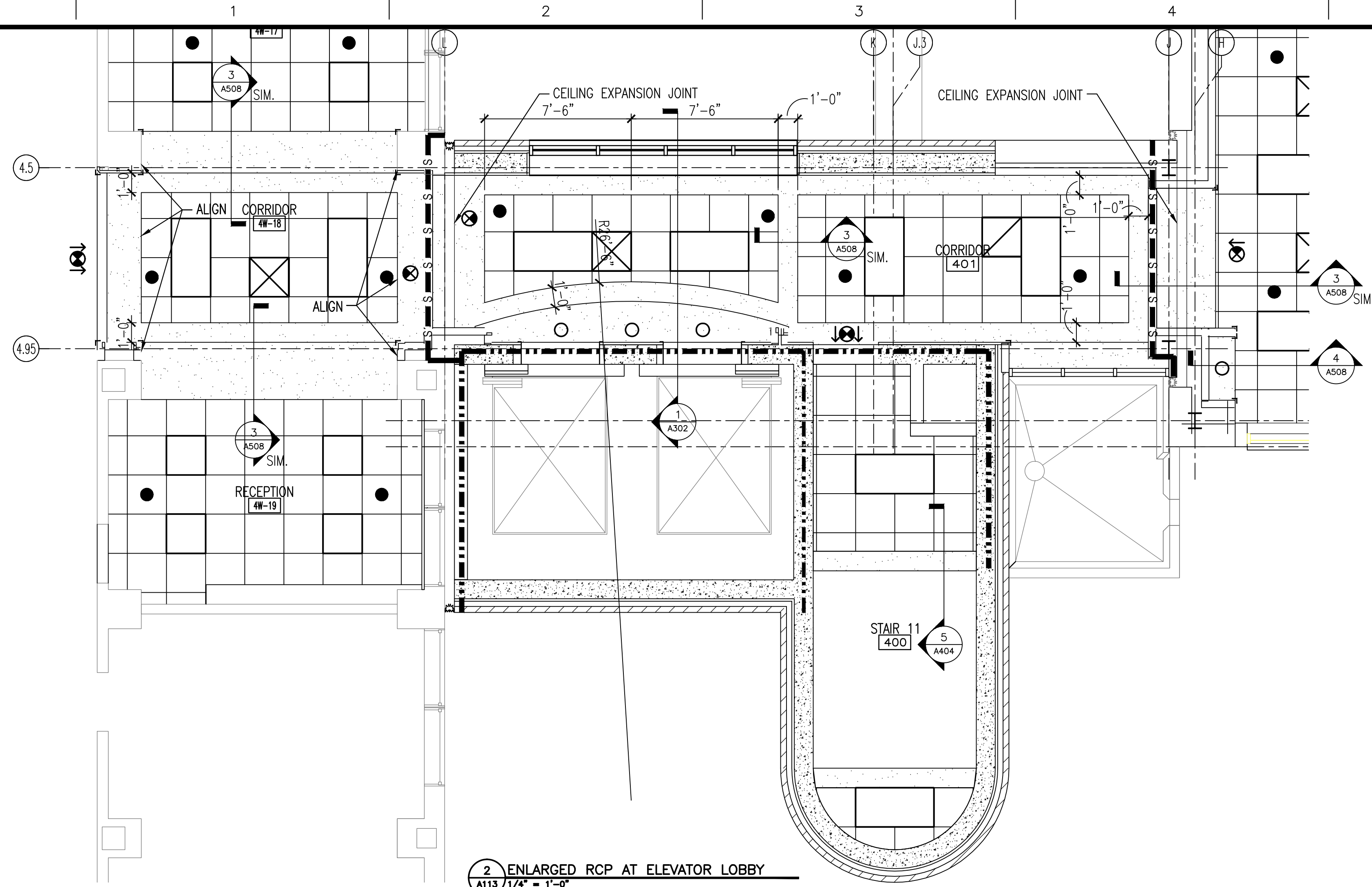

REFLECTED CEILING PLAN LEGEND			
	2'-0" X 4'-0" LAY-IN LIGHT FIXTURE		2' X 2' SUPPLY / RETURN GRILLE - SEE MECHANICAL
	1'-0" X 4'-0" LIGHT FIXTURE SURFACE-MTD OR SUSPENDED		CEILING ACCESS PANEL
	2'-0" X 2'-0" LAY-IN LIGHT FIXTURE		LINEAR SLOT DIFFUSER
	RECESSED DOWN LIGHT - SEE ELECTRICAL		SPRINKLER
	CEILING MOUNTED EXIT SIGN WITH DIRECTION ARROWS		OTS OPEN TO STRUCTURE
	2'-0" X 2'-0" ACT GRID		1-HOUR FIRE PARTITION
	NEW GYP BD CEILING/SOFFIT		2-HOUR FIRE PARTITION
			1-HOUR RATED SMOKE WALL

REFLECTED CEILING PLAN NOTES

1. EXACT ACCESS PANEL LOCATIONS TO BE COORDINATED BY GENERAL CONTRACTOR WITH ACTUAL MECHANICAL OR PLUMBING INSTALLATION.

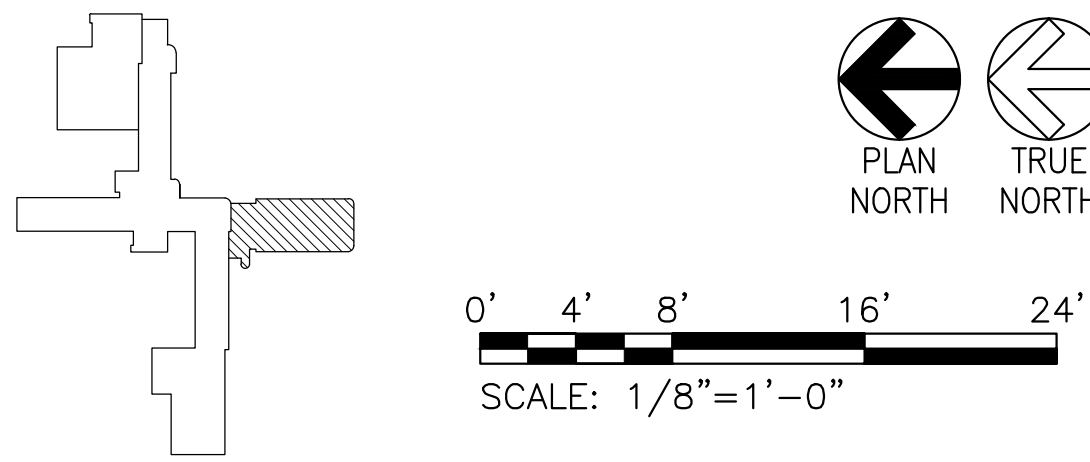
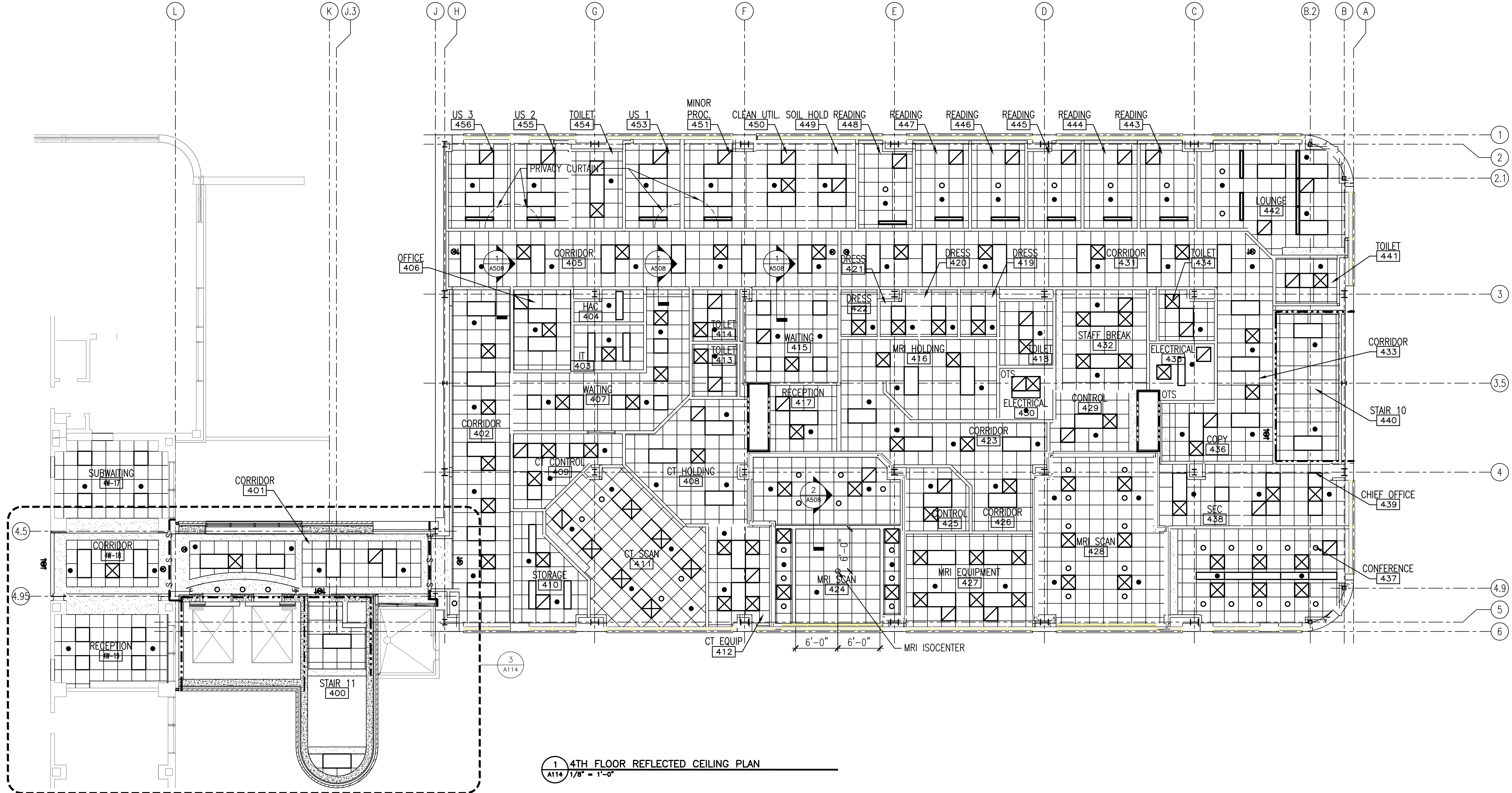

FINAL SUBMITTAL

Revisions:		Date:		CONSULTANTS:		ARCHITECT:		Drawing Title:		Project Title:		Project Number:		Office of Construction and Facilities Management	
								4TH FLOOR & ELEVATOR MACHINE ROOM REFLECTED CEILING PLANS		EXPAND RADIOLOGY AND SPS OVERTON BROOKS VAMC		667-083		VA	
								Approved: Project Director		Location: SHREVEPORT, LA		Building Number: 1		U.S. Department of Veterans Affairs	
										Date: 04-17-2015		Checked: XX		Dwg. 21 of 160	
												Drawing Number: A114			