

EQUIPMENT SCHEDULE									
MARK	DESCRIPTION	QTY.	FURNISHED		INSTALLED		PRODUCT (BASIS OF DESIGN)	NOTES	
			GC	VA	GC	VA			
1	DENTAL LUBRICATOR	4		X		X	ASSISTINA 301 PLUS/NSK CARE 3 PLUS	AMERWATER R03 MODEL #00HCS-2055	
2	WATER PURIFICATION SYSTEM	1	X		X				
3	DETERGENT DISPENSING SYSTEM	1		X		X			
4	ULTRASONIC CLEANER (SINGLE)	1		X		X	CAVIMAVE 20-W		
5	ULTRASONIC CLEANER (DOUBLE)	1		X		X	CAVIMAVE 20-WRD		
6	WASHER/DISINFECTOR	2+1 FUT				X	STERIS RELIANCE HAMO VISION		
7	PASS THROUGH	4	X		X	X	AAMSCO		
8	CART WASH	1		X	X	X	STERIS VISION 1327		
9	STEAM GUN	1	X		X		GETTINGE 7510		
10	ENDOSCOPE REPROCESSOR	3				X	MEDNATOR 2.0		
11	ENDOSCOPE DRYING CABINET	1		X	X	X			
12	DRYING CABINET	1		X		X			
13	LOW TEMPERATURE STERILIZER	2		X	X	X	AAMSCO V-PRO MAX		
14	STEAM STERILIZER (SMALL)	1		X	X	X	AAMSCO 400 SERIES		
15	STEAM STERILIZER (LARGE)	2		X	X	X	AAMSCO EVOLUTION		
16	PREP AND PACK TABLE	3		X		X			
17	LOCKER	48	X		X			1	
18	LOCKER ROOM BENCH	4	X		X			2	
30	CT SCANNER	1		X	X	X	TOSHIBA AQUILION		
31	MRI-CLOSED	1		X	X	X	HITACHI OASIS MARK II		
32	MRI-OPEN	1		X	X	X	HITACHI ECHELON OVAL		
33	ICE MACHINE/DISPENSER	1		X	X	X	SCOTSMAN MD5N25A-1J		

GENERAL EQUIPMENT NOTES:

1 ARCHITECTURAL AND ENGINEERING DOCUMENTS ARE BASED ON EQUIPMENT INFORMATION PROVIDED BY THE VAMC DURING DESIGN. THE BASIS OF DESIGN MODELS ARE LISTED ABOVE. PRIOR TO ROUGH-IN OF ANY VA-FURNISHED EQUIPMENT, CONTRACTOR SHALL VERIFY MAKE, MODEL, AND ALL W/E/P, STRUCTURAL AND OTHER REQUIREMENTS OF EQUIPMENT AND COORDINATE WITH CONSTRUCTION, UTILITIES OR ROUGH-IN. REFER TO SPEC SECTION 11 70 00 "EQUIPMENT" FOR ADDITIONAL INFORMATION.

KEY NOTES:

1 HALF-HEIGHT LOCKERS

2 SEE INTERIOR ELEVATIONS FOR LENGTHS

KEY NOTES:
1 HALF-HEIGHT LOCKERS
2 SEE INTERIOR ELEVATIONS FOR LENGTHS

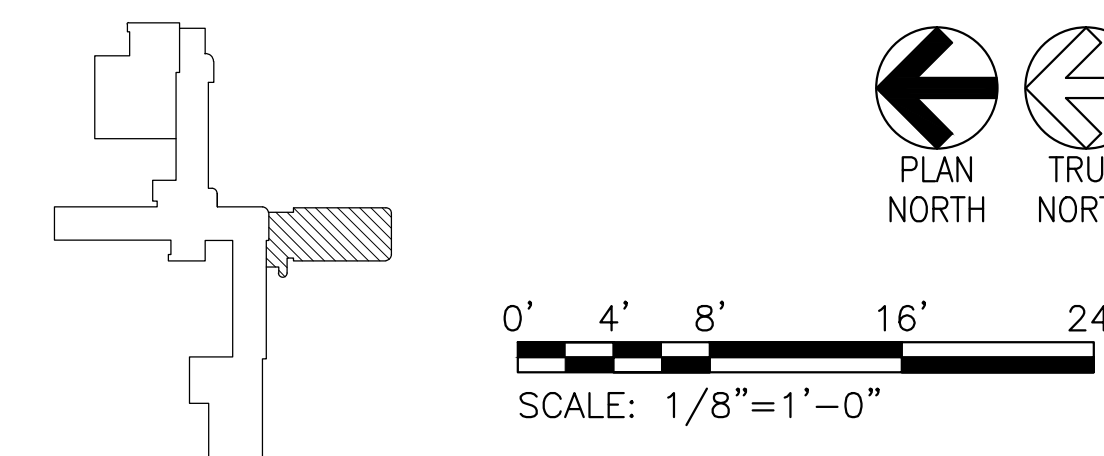

FINAL SUBMITTAL

<div> <div>Revisions:</div> <div>Date</div> </div>	CONSULTANTS:		<div> <div>ARCHITECT:</div> <div>  <div> <div>TOLAND</div> <div>MIZELL</div> <div>MOLNAR</div> </div> </div> <div> <div>590 Means Street NW, Suite 200</div> <div>Atlanta, GA 30318</div> <div>404.214.9774</div> </div> </div>	<div>Drawing Title:</div> <div>3RD FLOOR EQUIPMENT PLAN</div>	<div>Project Title:</div> <div>EXPAND RADIOLOGY AND SPS OVERTON BROOKS VAMC</div>	<div>Project Number:</div> <div>667-083</div>	<div> <div>OFFICE OF CONSTRUCTION AND FACILITIES MANAGEMENT</div> <div>  <div>U.S. Department of Veterans Affairs</div> </div> </div>			
					<div>Building Number:</div> <div>1</div>	<div>Drawing Number:</div> <div>A123</div>				
					<div>Approved: Project Director</div>	<div>Location:</div> <div>SHREVEPORT, LA</div>		<div>Date:</div> <div>04-17-2015</div>	<div>Checked:</div> <div>XX</div>	<div>Drawn:</div> <div>XX</div>
						<div>Dwg.</div> <div>22 of 160</div>				