

- ① (N) OUTDOOR PAD MOUNTED
LOOP FEED TRANSFORMER "T-2", 1000KVA
3 ϕ , 3W, 12KV DELTA PRIMARY,
3 ϕ , 4W, 480/277V WYE SECONDARY
GROUND NEUTRAL TO
GROUND ROD
- (E) FEEDER ⑩

T

(E)
SERVICE
MANHOLE

(E) MAIN SWITCHBOARD PANEL "90-MSB"
1600A, 277/480V, 3 ϕ , 4W BUS
BUS BRACING: 65,000 AIC SYM
SHORT CIRCUIT RATING: 65,000 AIC FULLY RATED

(E) 16#600MCM & 4#4/0
GRD IN EXISTING (4) 4" C
WITH CONCRETE ENCASED

(N) 4#600MCM & 1#4/0
GRD IN 4" C EACH X 4 SETS

LOCATED OUTDOOR
ADJACENT TO
ROOM 1A-112

(E)
1600AF/3P
1600AT

[GFP]

[SPD]
(E)

(E)
800AF/3P
800AT

SPARE

(E)
800AF/3P
800AT

OPTIONAL
STANDBY

(E)
200AF/3P
200AT

SPARE

(E)
200AF/3P
200AT

SPARE

(N) SECTION 2 PANEL "90-MSB"
1600A, 277/480V, 3 ϕ , 4W BUS
BUS BRACING: 65,000 AIC SYM
SHORT CIRCUIT RATING:
65,000 AIC FULLY RATED
NEMA 3 ENCLOSURE ⑮

(N)
600AF/3P
600AT

CRITI-
CAL

(N)
400AF/3P
400AT

LIFE
SAFETY

(N)
400AF/3P
400AT

SPARE

BUILDING 90

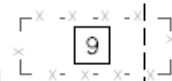
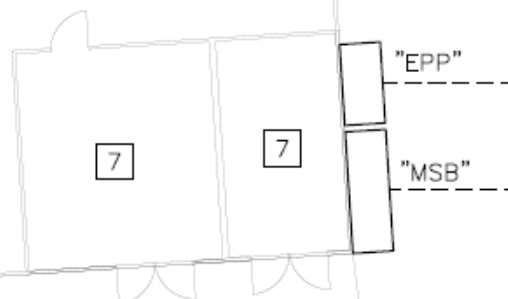

15

2

2

