

0 1 2 3 4 5 6 7 8 9 10  
three inches = one foot  
one and one-half inches = one foot  
one inch = one foot  
three-quarters inch = one foot  
one-half inch = one foot  
three-eighths inch = one foot  
one-quarter inch = one foot  
one-eighth inch = one foot

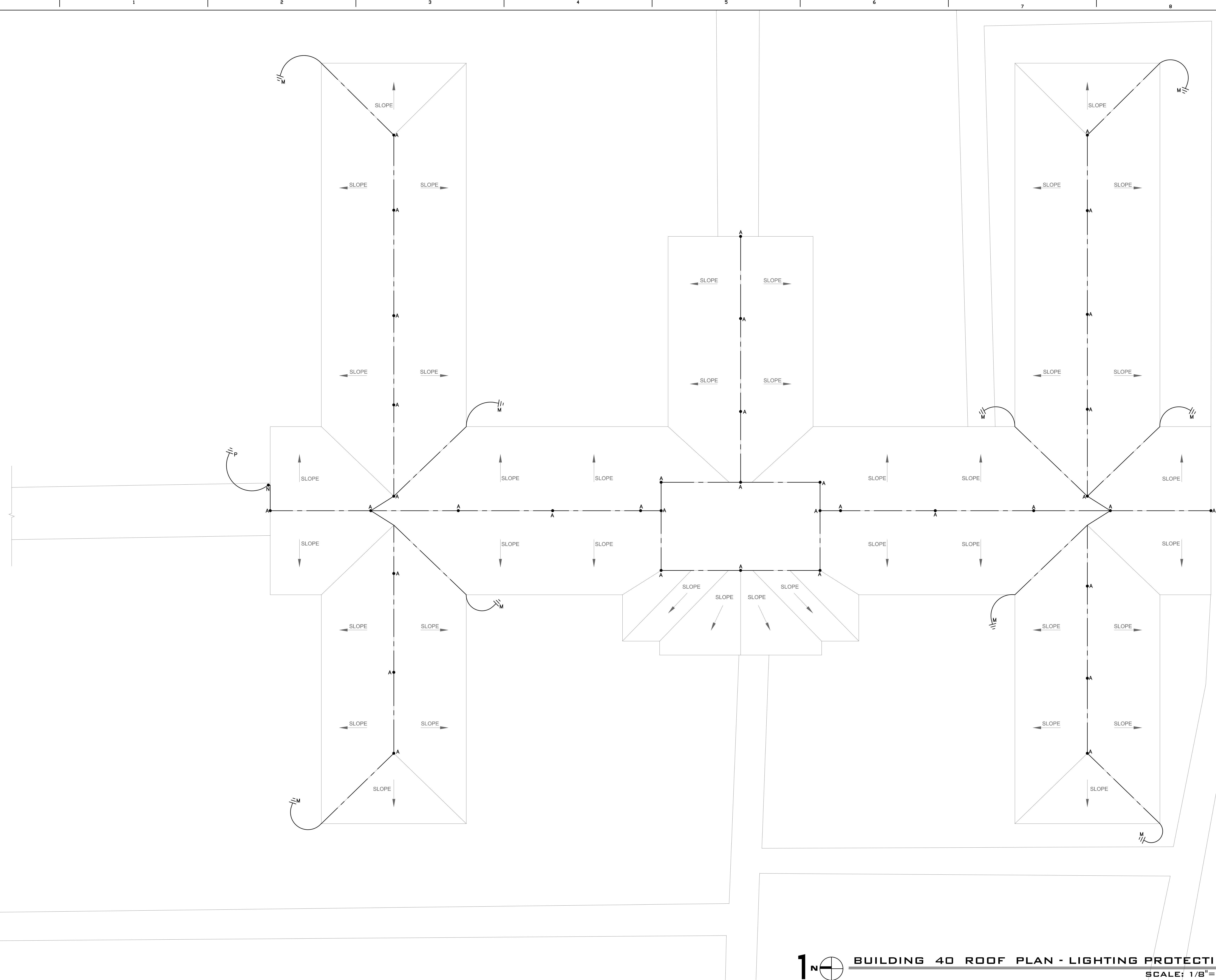

- GENERAL NOTES:
1. ELECTRICAL CONTRACTOR SHALL BE RESPONSIBLE FOR REMOVING EXISTING LIGHTNING PROTECTION SYSTEM HARDWARE AND CABLES.
  2. THE LIGHTNING PROTECTION SYSTEM SHALL BE INSPECTED AND APPROVED BY UL WITHOUT VARIATION PRIOR TO FINAL ACCEPTANCE.

**1**  **BUILDING 40 ROOF PLAN - LIGHTNING PROTECTION**  
SCALE: 1/8" = 1'-0"

**S E G**  
SALLADIEN ENGINEERING GROUP, P.C.  
1507 ALEX DRIVE, SUITE 101  
BIRMINGHAM, ALABAMA 35210  
205.833.7033 FAX: 205.314.0180  
www.segengineering.com  
PROJECT: 09-97

Revisions	Date

**BIRCHFIELD  
PENUEL &  
ASSOCIATES,  
ARCHITECTS**  
2805 CRESCENT AVENUE • SUITE 200 • BIRMINGHAM, ALABAMA 35209

  
**5/27/10**

**Replace Shingles - Building 39 - 40**  
**Department of Veterans Affairs**  
**MEDICAL CENTER**  
**TUSCALOOSA, ALABAMA**

Drawing Title BUILDING 40 ROOF PLAN- LIGHTNING PROTECTION
Approved: Chief Engineer

Project Title <b>REPLACE SHINGLES - BUILDINGS 39 &amp; 40</b> <b>DEPARTMENT OF VETERANS AFFAIRS</b>		
Building Numbers <b>39 &amp; 40</b>	Checked <b>JJS</b>	Drawn <b>DB</b>
Location VA MEDICAL CENTER TUSCALOOSA, ALABAMA		

Date : <b>06-04-2010</b>
Project Number : <b>679-10-103</b>
DRAWING NO. <b>40-E2.1</b>
Dwg <b>10</b> of <b>10</b>

**Veterans  
Administration**