

A  
three inches = one foot  
1  
0  
6  
B  
one and one half inches = one foot  
2  
0  
6  
C  
one inch = one foot  
2  
0  
6  
D  
three quarters inch = one foot  
2  
0  
6  
E  
one half inch = one foot  
2  
0  
6  
F  
one quarter inch = one foot  
2  
0  
6  
G  
one eighth inch = one foot  
2  
0  
6  
H  
one eighth inch = one foot  
2  
0  
6  
I  
one eighth inch = one foot  
2  
0  
6  
J  
one eighth inch = one foot  
2  
0  
6  
K  
one eighth inch = one foot  
2  
0  
6  
L  
one eighth inch = one foot  
2  
0  
6  
M  
one eighth inch = one foot  
2  
0  
6  
N  
one eighth inch = one foot  
2  
0  
6  
O  
one eighth inch = one foot  
2  
0  
6  
P  
one eighth inch = one foot  
2  
0  
6  
Q  
one eighth inch = one foot  
2  
0  
6  
R  
one eighth inch = one foot  
2  
0  
6  
S  
one eighth inch = one foot  
2  
0  
6  
T  
one eighth inch = one foot  
2  
0  
6  
U  
one eighth inch = one foot  
2  
0  
6  
V  
one eighth inch = one foot  
2  
0  
6  
W  
one eighth inch = one foot  
2  
0  
6  
X  
one eighth inch = one foot  
2  
0  
6  
Y  
one eighth inch = one foot  
2  
0  
6  
Z  
one eighth inch = one foot  
2  
0  
6

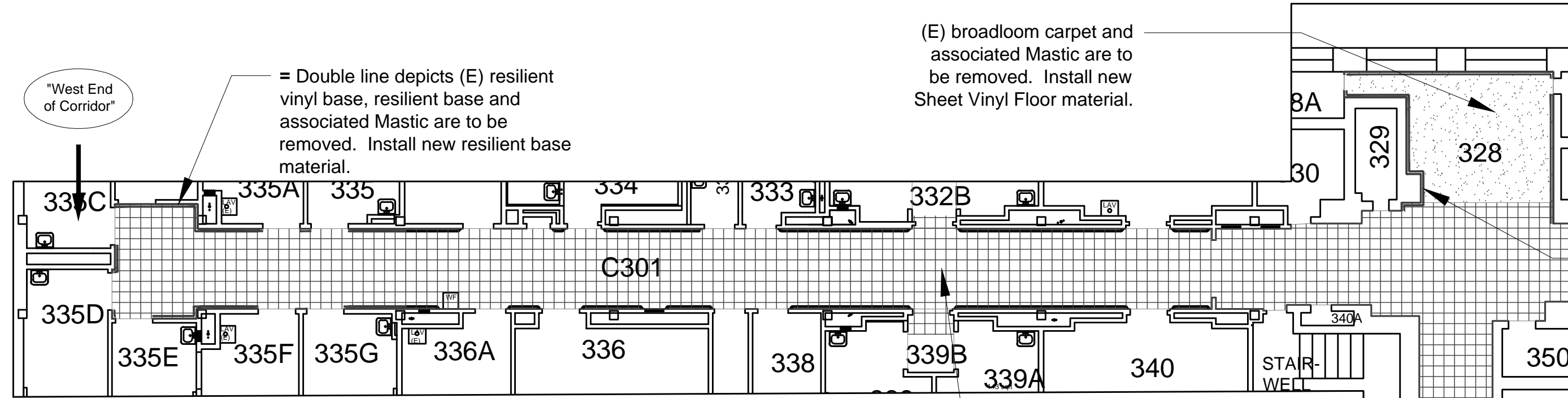

1 PARTIAL FLOOR PLAN, 3RD FLOOR - WEST  
3/32" = 1'-0"

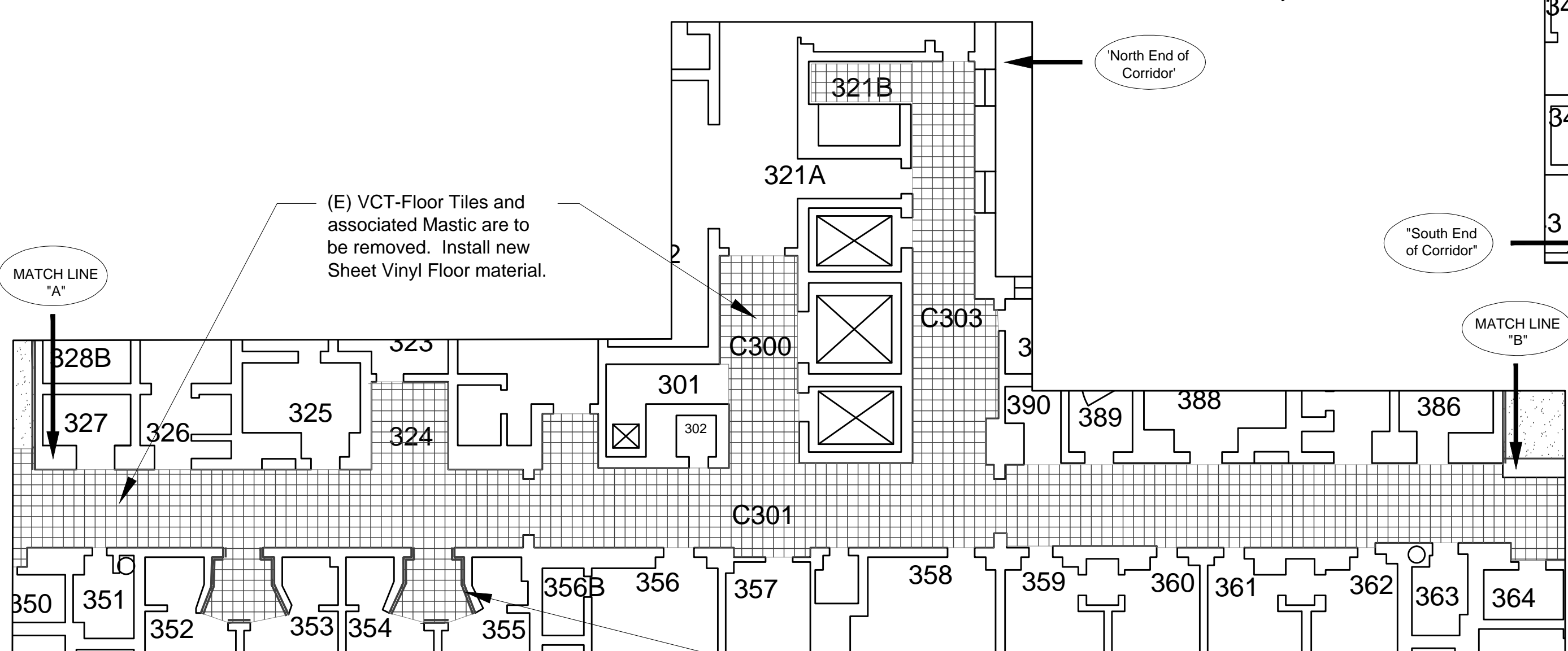

2 PARTIAL FLOOR PLAN, 3RD FLOOR  
3/32" = 1'-0"

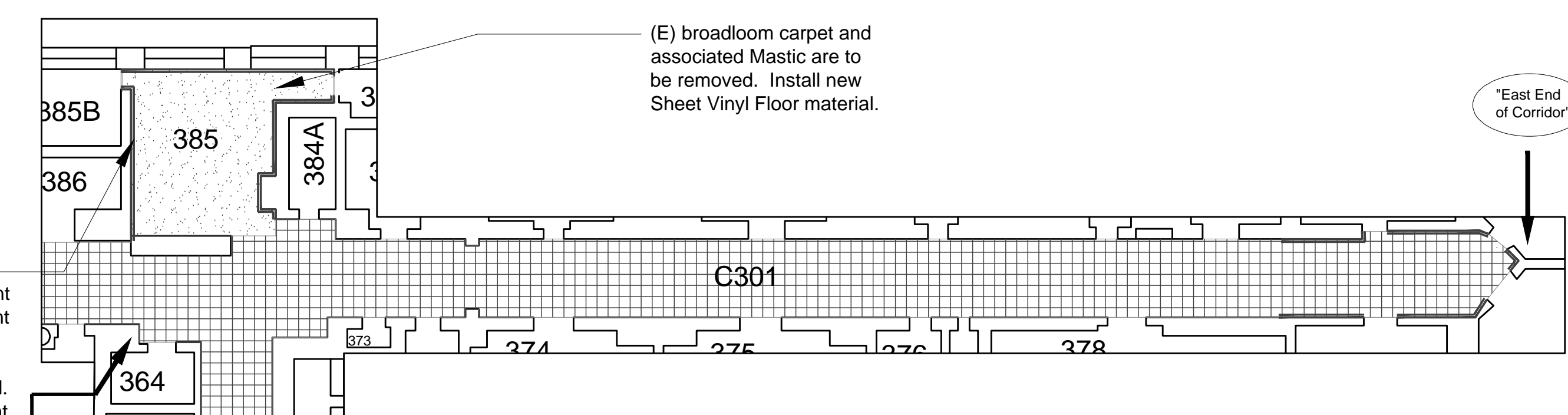

3 PARTIAL FLOOR PLAN, 3RD FLOOR - EAST  
3/32" = 1'-0"

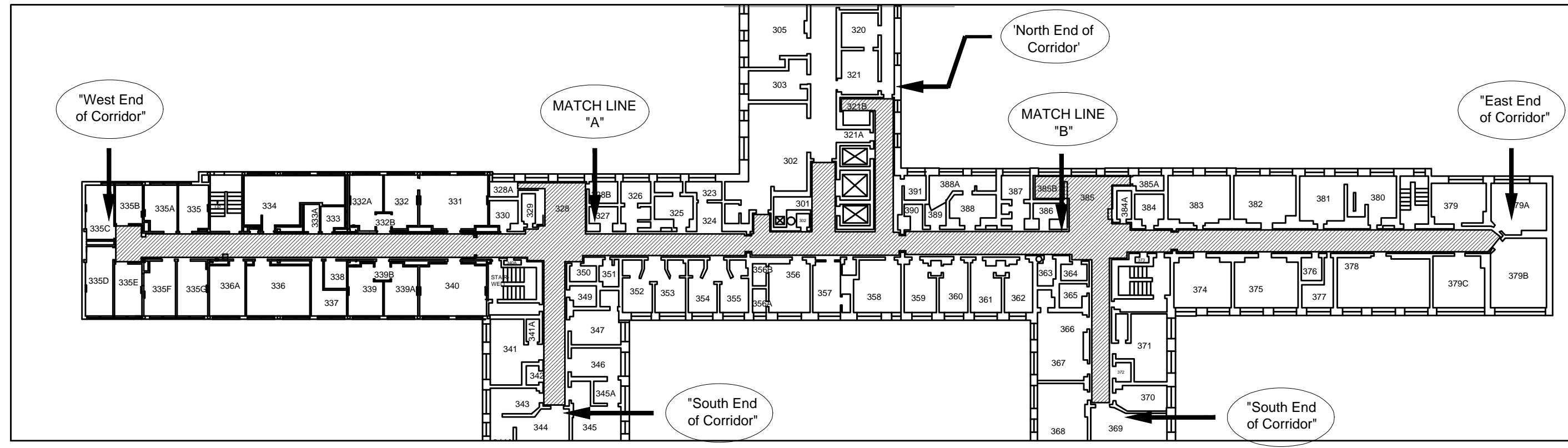

KEY PLAN THIRD FLOOR  
1/32" = 1'-0"

- DEMOLITION PLAN NOTES:
1. REMOVE WALL DECORATIVE BORDER ALONG CORRIDOR WALLS.
  2. WHERE DECORATIVE BORDER IS REMOVED, APPLY FINISHING COMPOUND TO A LEVEL 5 FINISH. COMPOUND SHALL MEET ASTM C475 AND ASTM C840 AND BE FREE OF ANTIFREEZE, VINYL ADHESIVES, PRESERVATIVES, BIOCIDES, AND OTHER VOCs.
  3. REMOVE ALL VINYL COVE BASE (VCB) WHERE APPLICABLE AND PREPARE WALLS TO RECEIVE NEW FINISH AND BASE.
  4. REMOVE VCT FLOOR TILE AS SHOWN AND PREPARE FLOOR TO RECEIVE NEW FINISH.
  5. REMOVE WIREMOLD FROM WALL. COIL PHONE LINES ABOVE CEILING. PREPARE WALL TO RECEIVE FINISHES.
  6. REMOVE FROM DOOR FRAMES ALL EXISTING DOOR SILENCERS AND REPLACE WITH NEW DOOR SILENCERS.
  7. EXISTING TERRAZO COVE BASE TO REMAIN UNTOUCHED. PROTECT EXISTING TERRAZO BASE WHEN PAINTING COVE GLAZE TILE.
  8. PREP AND PAINT EXISTING WOODEN BASE WHERE APPLICABLE.

- FLOOR PLAN NOTES
1. New Flooring material is to be installed with the pattern aligned as shown in Sheet A-202. Both the 'Field' - VSF1 and the 'Accent' - VSF2 have a pattern.
  2. The New Flooring is to terminate and abut the existing flooring that is to remain, beneath the center line of each door that borders the corridors. In some special instances there will not be a door to align the termination of the flooring. At these locations, the new flooring will be terminated in a straight line with the existing flooring without any type of termination strips.
  3. Install metal transition strips between carpet and resilient flooring where applicable.

