

A
three inches = one foot
1
0
6
B
one and one half inches = one foot
0
6
2
C
one inch = one foot
0
6
D
three quarters inch = one foot
0
6
E
one half inch = one foot
0
6
F
three eighths inch = one foot
0
6
G
one quarter inch = one foot
0
6
H
one eighth inch = one foot
0
6
I
one sixteenth inch = one foot
0
6

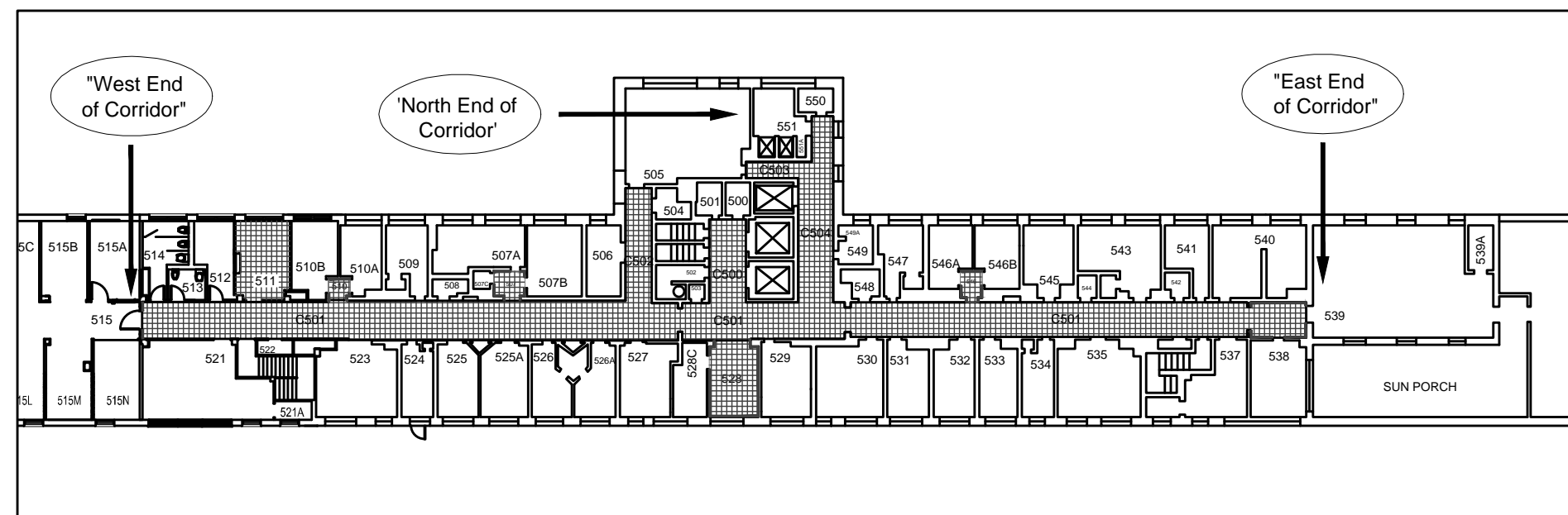

KEY PLAN 5TH FLOOR
1/32" = 1'-0"

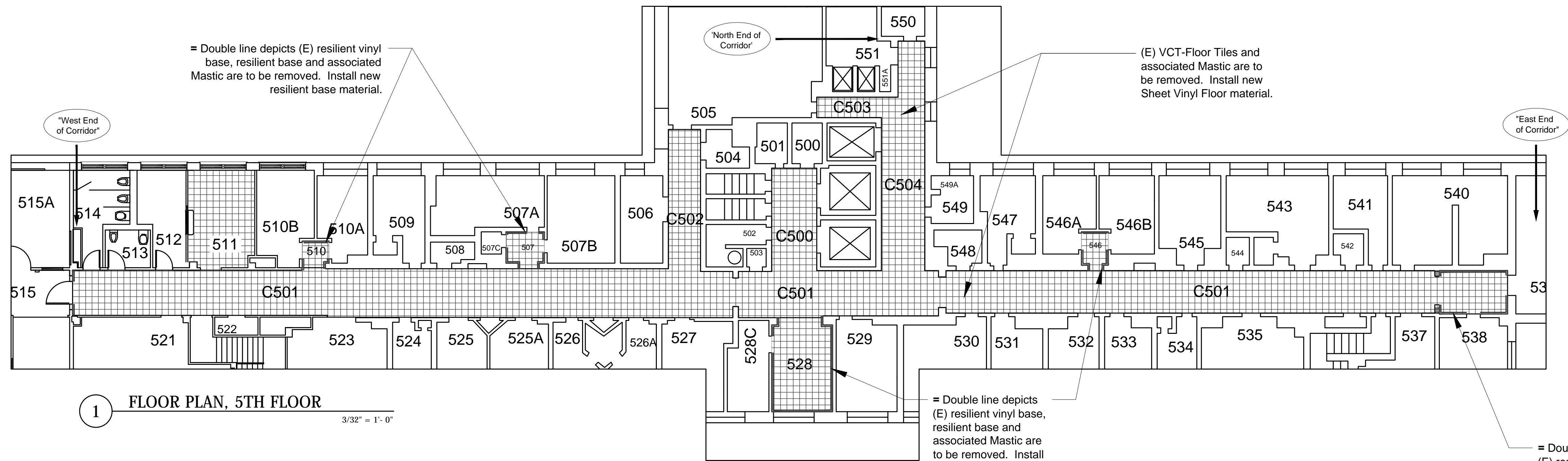

1 FLOOR PLAN, 5TH FLOOR
3/32" = 1'-0"

FLOOR PLAN NOTES

1. New Flooring material is to be installed with the pattern aligned as shown. Both the 'Field' - VSF1 and the 'Accent' - VSF2 have a pattern.
2. The New Flooring is to terminate and abut the existing flooring that is to remain, beneath the center line of each door that borders the corridors. In some special instances there will not be a door to align the termination of the flooring. At these locations, the new flooring will be terminated in a straight line with the existing flooring without any type of termination strips. Provide Floor leveling compound in all areas for installing the new flooring.
3. Contractor is to remove all wall-mounted items and store them for re-installation upon completion of the work. All items shall remain unaltered and undamaged. Contractor shall reinstall all items in locations as specified by the VA-Interior Designer. Items re-installed shall be mounted level, plumb and square. All existing mounting holes, brackets that are not to be reused shall be removed and the wall surface, patched, filled and sanded ready for paint.
4. Remove wall mounted 'wall paper' decorative border from corridor walls. Prepare wall surface with a skim coat of Gypsum Board finishing compound to meet 'Level-5' finish.
5. Remove all existing Vinyl and/or Rubber base from the corridor walls. Prepare the surface per manufacturer's instructions to receive new base.
6. Remove all surface mounted 'Wiremold' from corridor walls. If there is wiring in the 'Wiremold', then remove the wiring back to the nearest junction box or connection point that is in a box. Prepare wall for new finish.
7. Corridor walls are to be painted. Prepare the walls for a 'Level' 5 finish.
8. Existing Door Frames are to be painted. All door hardware is to remain unpainted. Protect all hardware from painting and paint preparation activities. Remove all door silencers and install new silencers in all of the locations on the door frame whether is had a silencer or was just an empty hole or was a previously filled in hole.
9. Cove tiles on corridor walls are to be painted - PT5 to match resilient base height and color.

- DEMOLITION PLAN NOTES:
1. REMOVE WALL DECORATIVE BORDER ALONG CORRIDOR WALLS.
 2. WHERE DECORATIVE BORDER IS REMOVED, APPLY FINISHING COMPOUND TO A LEVEL 5 FINISH. COMPOUND SHALL MEET ASTM C475 AND ASTM C840 AND BE FREE OF ANTIFREEZE, VINYL ADHESIVES, PRESERVATIVES, BIOCIDES, AND OTHER VOCs.
 3. REMOVE ALL VINYL COVE BASE (VCB) WHERE APPLICABLE AND PREPARE WALLS TO RECEIVE NEW FINISH AND BASE.
 4. REMOVE VCT FLOOR TILE AS SHOWN AND PREPARE FLOOR TO RECEIVE NEW FINISH.
 5. REMOVE WIREMOLD FROM WALL. COIL PHONE LINES ABOVE CEILING. PREPARE WALL TO RECEIVE FINISHES.
 6. REMOVE FROM DOOR FRAMES ALL EXISTING DOOR SILENCERS AND REPLACE WITH NEW DOOR SILENCERS.
 7. EXISTING TERRAZO COVE BASE TO REMAIN UNTOUCHED. PROTECT EXISTING TERRAZO BASE WHEN PAINTING COVE GLAZE TILE.
 8. PREP AND PAINT EXISTING WOODEN BASE WHERE APPLICABLE.

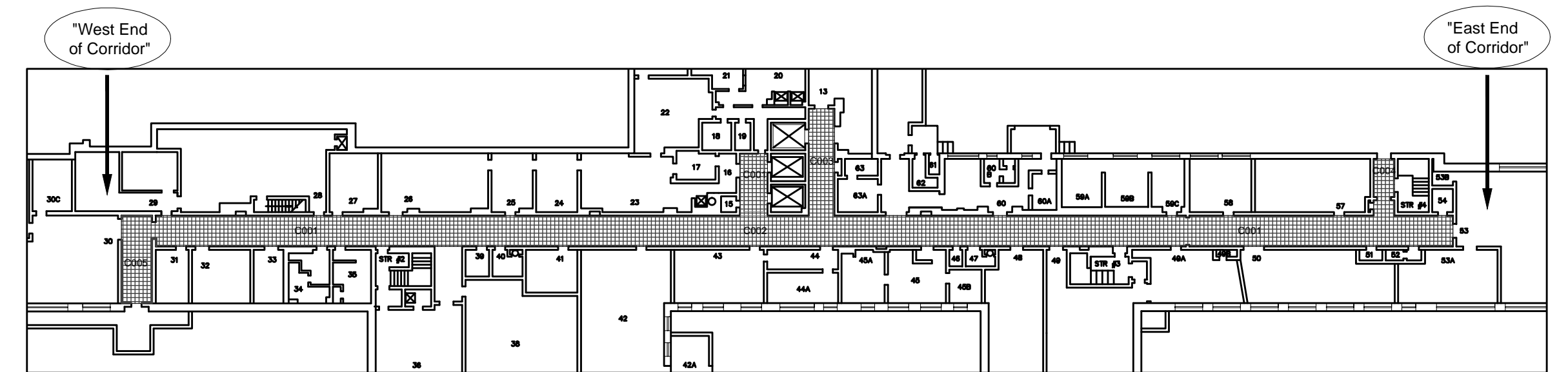

KEY PLAN BASEMENT
1/32" = 1'-0"

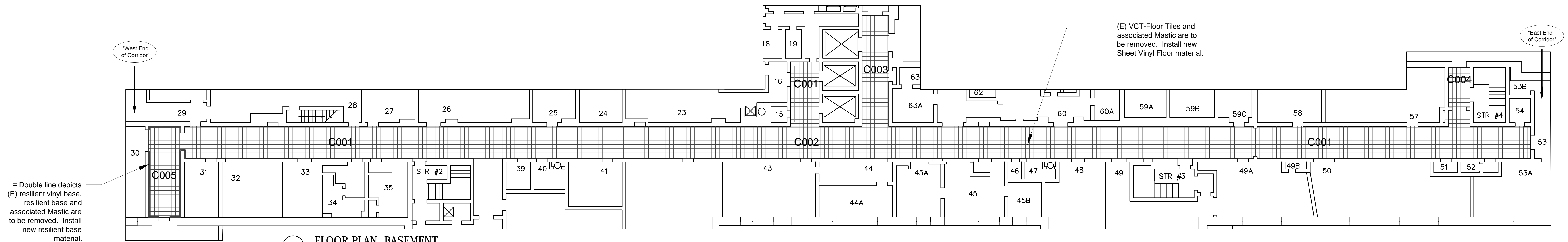

1 FLOOR PLAN, BASEMENT
3/32" = 1'-0"

BID ITEM # 2

Revisions:	Date:	VA Northern Indiana Health Care System, Fort Wayne 2121 Lake Avenue Fort Wayne, IN 46805	Approved: Medical Center Director Daniel D. Hendee, FACHE	Approved: Associate Director for Operations Helen Rhodes	Approved: Engineering Service Charles Applewhite	Drawing Title Floor Plan - 5th Floor & Basement	Project Title Interior Halls and Walls	Project Number 610A4-11-149		
						Approved: Project Director	Location VA NIHCS, Fort Wayne, IN	Building Number 1		
						Date 08/05/2011	Checked CDA	Drawn VM		Drawing Number A-103
										Dwg. 3 of 12