



DEPARTMENT OF VETERANS AFFAIRS

RALPH H. JOHNSON MEDICAL CENTER

109 BEE STREET
CHARLESTON, SOUTH CAROLINA 29401-5799



INDEX OF DRAWINGS

SHEET NO.	DRAWING TITLE
X-1	COVER SHEET
X-2	FIRST FLOOR KEY PLAN
X-3	SECOND FLOOR KEY PLAN
X-4	THIRD FLOOR KEY PLAN
X-5	FOURTH FLOOR KEY PLAN
X-6	FIFTH FLOOR KEY PLAN
X-7	NOTES & KEY TO SYMBOLS
L-1	SITE PLAN
A-1	GENERAL NOTES AND DETAILS
DE-1	TYPICAL WALL TYPES
FSW-1	FIRST FLOOR - OVERALL - FIRE / SMOKE WALLS
FSW-2	SECOND FLOOR - OVERALL - FIRE / SMOKE WALLS
FSW-3	THIRD FLOOR - OVERALL - FIRE / SMOKE WALLS
FSW-4	FOURTH FLOOR - OVERALL - FIRE / SMOKE WALLS
FSW-5	FIFTH FLOOR - OVERALL - FIRE / SMOKE WALLS
DFF-PB	BASEMENT - OVERALL - DEMOLITION
DFF-1	FIRST FLOOR - OVERALL - DEMOLITION
DFF-2	SECOND FLOOR - OVERALL - DEMOLITION
DFF-1-2H	FIRST & SECOND FLOOR - H SECTION - DEMOLITION
DFF-3	THIRD FLOOR - OVERALL - DEMOLITION
DFF-4	FOURTH FLOOR - OVERALL - DEMOLITION
DFF-5	FIFTH FLOOR - OVERALL - DEMOLITION
DFF-6	SIXTH FLOOR - OVERALL - DEMOLITION
FP-DE	FIRE PROTECTION DETAILS
FP-PB	PIPE BASEMENT - OVERALL - NEW WORK
FP-1	FIRST FLOOR - OVERALL - NEW WORK
FP-2	SECOND FLOOR - OVERALL - NEW WORK
FP-3	THIRD FLOOR - OVERALL - NEW WORK
FP-4	FOURTH FLOOR - OVERALL - NEW WORK
FP-5	FIFTH FLOOR - OVERALL - NEW WORK
FP-6	SIXTH FLOOR - OVERALL - NEW WORK
FP-1A	FIRST FLOOR - A SECTION - NEW WORK
FP-1AA	FIRST FLOOR - AA SECTION - NEW WORK
FP-1B	FIRST FLOOR - B SECTION - NEW WORK
FP-1BB	FIRST FLOOR - BB SECTION - NEW WORK
FP-1C	FIRST FLOOR - C SECTION - NEW WORK
FP-1CC	FIRST FLOOR - CC SECTION - NEW WORK
FP-1D	FIRST FLOOR - D SECTION - NEW WORK
FP-1DD	FIRST FLOOR - DD SECTION - NEW WORK
FP-1G	FIRST FLOOR - G SECTION - NEW WORK
FP-1J	FIRST FLOOR - J SECTION - NEW ADDITION - NEW WORK
FP-2A	SECOND FLOOR - A SECTION - NEW WORK
FP-2AA	SECOND FLOOR - AA SECTION - NEW WORK
FP-2B	SECOND FLOOR - B SECTION - NEW WORK
FP-2BB	SECOND FLOOR - BB SECTION - NEW WORK
FP-2C	SECOND FLOOR - C SECTION - NEW WORK
FP-2CC	SECOND FLOOR - CC SECTION - NEW WORK
FP-2D	SECOND FLOOR - D SECTION - NEW WORK
FP-2D-MRI	SECOND FLOOR - MRI PORTION - NEW WORK
FP-2EF	SECOND FLOOR - E & F SECTION - NEW WORK
FP-2G	SECOND FLOOR - G SECTION - NEW WORK
FP-182H	FIRST AND SECOND FLOOR - H SECTION - NEW WORK
FP-3A	THIRD FLOOR - A SECTION - NEW WORK
FP-3AA	THIRD FLOOR - AA SECTION - NEW WORK
FP-3B	THIRD FLOOR - B SECTION - NEW WORK
FP-3BB	THIRD FLOOR - BB SECTION - NEW WORK
FP-3C	THIRD FLOOR - C SECTION - NEW WORK
FP-4A	FOURTH FLOOR - A SECTION - NEW WORK
FP-4AR	FOURTH FLOOR - RENOVATED - NEW WORK
FP-4B	FOURTH FLOOR - B SECTION - NEW WORK
FP-4C	FOURTH FLOOR - C SECTION - NEW WORK
FP-5A	FIFTH FLOOR - A SECTION - NEW WORK
FP-5B	FIFTH FLOOR - B SECTION - NEW WORK
FP-5C	FIFTH FLOOR - C SECTION - NEW WORK
FP-RISER	RISER DIAGRAM
M-1	AHU SCHEDULE

PROJECT DESCRIPTION

SCOPE OF WORK

(BASE BID)
CONTRACTOR WILL PROVIDE THE NECESSARY LABOR, MATERIALS AND SUPERVISION, TESTING & CERTIFICATION TO PROVIDE A NEW CLASS A FIRE ALARM SYSTEM. COMPLETE WITH FIRE ALARM DEVICES, CONDUIT & WIRING, CONTROL PANELS, AS INDICATED ON DRAWINGS & IN SPECIFICATIONS. THE AREAS OF WORK ARE SHOWN ON THE DRAWINGS WHICH INCLUDE ALL FLOORS INCLUDING A BASEMENT CRAWL SPACE. WORK IS TO INCLUDE REMOVAL, REPLACEMENT, PATCHING AND REPAIR, SEALING OR FIRE STOPPING OF ALL MATERIALS AFFECTED BY INSTALLATION OF NEW WORK. TO MINIMIZE COST, THE EXISTING CONDUIT TO THE PULL STATIONS WILL BE USED. THE WORK WILL BE COORDINATED BY AREAS AND AFTER THE NEW SYSTEMS ARE READY TO PUT IN SERVICE. NEW ADDRESSABLE MODULES REQUIRED FOR THE TAMPERS, FLOW SWITCHES & DOOR HOLDERS. THE ADDRESSABLE MODULES CHANGED OUT AND COORDINATED. REMOVE THE EXISTING FIRE ALARM SYSTEM & ALL COMPONENTS AFTER NEW SYSTEM IS OPERATIONAL. COMPLETION OF WORK WITHIN 360 DAYS.

PHASING OF WORK

- THE CONTRACTOR IS WILL BE REQUIRED TO WORK HOURS OTHER THAN 8am to 4pm WHEN WORKING IN SPECIFIC AREAS OF THE MEDICAL CENTER AS DETERMINED BY THE CONTRACTING OFFICER. NO WORK CAN BE DONE AFTER 9pm.
- THE NEW FIRE ALARM SYSTEM WILL BE COMPLETELY INSTALLED & TESTED FOR THE ENTIRE BUILDING BEFORE DEMO OF EXISTING SYSTEM IS STARTED.
- THE CONTRACTING OFFICER WILL DEFINE THE AREAS OF WORK TO BE DONE AND WILL PROVIDE THE SEQUENCE OF WORK. THE CONTRACTOR WILL KEEP IN MIND THAT WORK IN OTHER AREAS ABOVE THE CEILING AND OUT OF SIGHT CAN BE SCHEDULED TO KEEP THE PROJECT MOVING. THIS WILL REQUIRE CLOSE COORDINATION WITH THE CONTRACTING OFFICER BECAUSE OF THE AMOUNT OF WORK THAT HAS TO BE DONE ABOVE THE CEILING IN ACTIVE HALLWAYS.

VA STAFF SIGNATURES

CAROLYN L. ADAMS MEDICAL CENTER DIRECTOR (00) RALPH H. JOHNSON MEDICAL CENTER CHARLESTON, SOUTH CAROLINA	HIMANSHU SINGH, MD ASSISTANT DIRECTOR (00) RALPH H. JOHNSON MEDICAL CENTER CHARLESTON, SOUTH CAROLINA
FLORENCE N. HUTCHISON, MD CHIEF OF STAFF (11) RALPH H. JOHNSON MEDICAL CENTER CHARLESTON, SOUTH CAROLINA	SCOTT ISAACS, MBA, FAAMA ASSOCIATE DIRECTOR (001) RALPH H. JOHNSON MEDICAL CENTER CHARLESTON, SOUTH CAROLINA
DAVID OLIVERA CHIEF INFORMATION OFFICER (ITD) RALPH H. JOHNSON MEDICAL CTR CHARLESTON, SOUTH CAROLINA	MARY C. FRAGGOS ASST. DIR. PATIENT NURSING SVC'S RALPH H. JOHNSON MEDICAL CTR CHARLESTON, SOUTH CAROLINA
MARIETTA A. HILL INFECTION CONTROL PRAC'T.(11C) RALPH H. JOHNSON MEDICAL CTR CHARLESTON, SOUTH CAROLINA	JACONDA LIGHTBURN INDUST. HYG. / SAFETY MGR. (003SFT) RALPH H. JOHNSON MEDICAL CTR. CHARLESTON, SOUTH CAROLINA
ROBERT SORENSON, PE ACTING MAINT OPS SUPERVISOR(138) RALPH H. JOHNSON MEDICAL CTR CHARLESTON, SOUTH CAROLINA	OKSER L. DUGGER INDUST. HYG/SAFETY (138) RALPH H. JOHNSON MEDICAL CTR. CHARLESTON, SOUTH CAROLINA
PATRICK J. BARRY CHIEF - ENVIR. MNGT. SVC. (137) RALPH H. JOHNSON MEDICAL CENTER CHARLESTON, SOUTH CAROLINA	
JAMES W. BRENNAN FACILITY GENERAL ENGINEER (138) RALPH H. JOHNSON MEDICAL CENTER CHARLESTON, SOUTH CAROLINA	JEFFREY A. SAGE CHIEF, ENGINEERING SERVICE (138) RALPH H. JOHNSON MEDICAL CENTER CHARLESTON, SOUTH CAROLINA
ROBERT T. DARLEY ENERGY MANAGER (138) RALPH H. JOHNSON MEDICAL CENTER CHARLESTON, SOUTH CAROLINA	

LOCATION MAP CHARLESTON, SOUTH CAROLINA

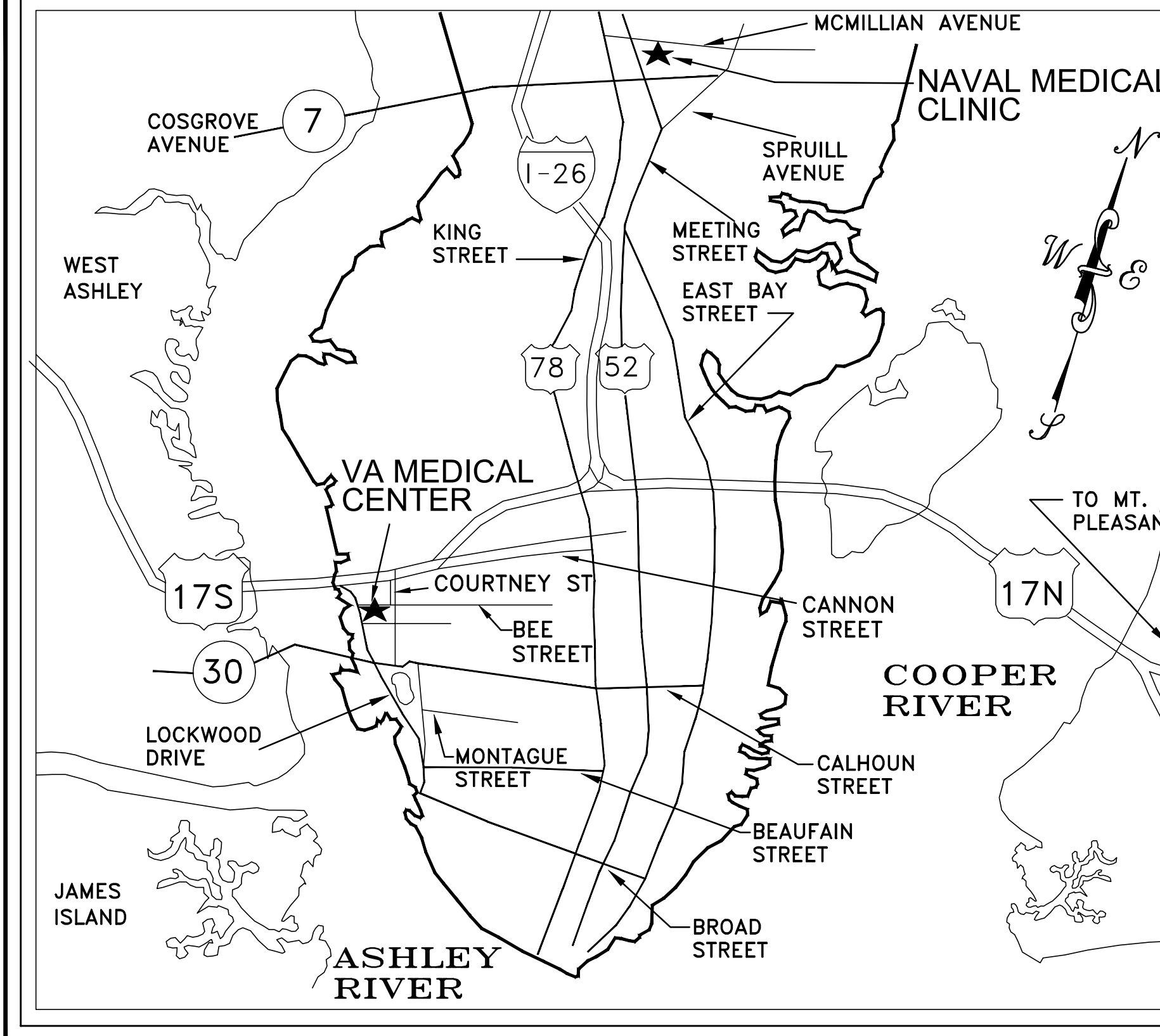

APPENDIX C

KEY SITE PLAN

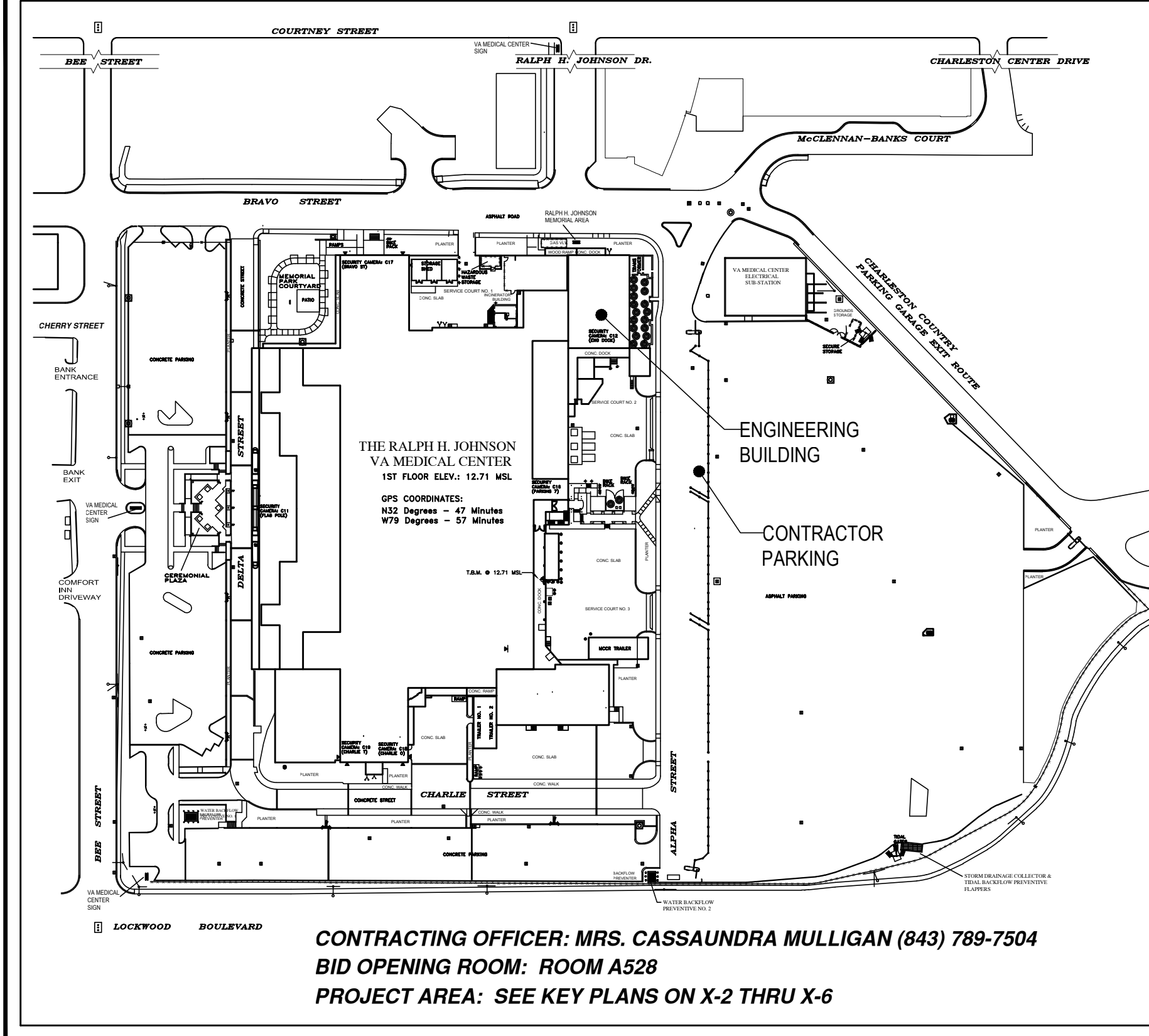

CONTRACTING OFFICER: MRS. CASSANDRA MULLIGAN (843) 789-7504
BID OPENING ROOM: ROOM A528
PROJECT AREA: SEE KEY PLANS ON X-2 THRU X-6

Revisions	Date	Project Team: William C. Neel, P.E. CAN Engineering Larry Shackelford, P.E. CAN Engineering Richard Fuselier, P.E. CAN Engineering Michael S. Edwards, AIA Watson Tate Savory Liollio Architecture	Consultants: Watson Tate Savory Liollio ARCHITECTURE 843.762.2222 wtliollio.com Charleston Asheville Charlotte Columbia	Architect/Engineer Seal SOUTH CAROLINA PROFESSIONAL ENGINEER No. 7425 09-15-11 WATSON TATE SAVORY LIOLLIO ARCHITECTURE WILLIAM C. NEEL	Architect/Engineer Seal SOUTH CAROLINA PROFESSIONAL ENGINEER No. 7425 09-15-11 WATSON TATE SAVORY LIOLLIO ARCHITECTURE WILLIAM C. NEEL	Architect/Engineer Seal SOUTH CAROLINA PROFESSIONAL ENGINEER No. 7425 09-15-11 WATSON TATE SAVORY LIOLLIO ARCHITECTURE WILLIAM C. NEEL	Architect/Engineer Address CAN Engineering, Inc. 4109 East North Street, Suite 200 Greenville, South Carolina 29615 Ph: (864) 271-2675 Fax: (864) 288-7970 Email: CANENGINE@aol.com CAN Project No. 100403	willow design ARCHITECTURE 408 LACKAWANNA AVE., SUITE 7C SCRANTON, PA 18503 v:570/330-9032 f:570/330-9017 www.willowdesign.biz SERVICES CREATED BY VETERANS OWNED SMALL BUSINESS	Drawing Title COVER SHEET Approved: Division Chief Approved: Service Director	Project Title REPLACE FIRE ALARM SYSTEM Building Number Checked WGN Drawn LGH Location CHARLESTON, SC	Date 15 SEPT 11 Project No. 534-12-108 DRAWING NO. X-1 Dwg.010f66	Department of Veterans Affairs
-----------	------	--	---	---	---	---	---	---	--	---	---	--------------------------------

FULLY SPRINKLERED