

DEDUCT ALTERNATE 1

LEGEND

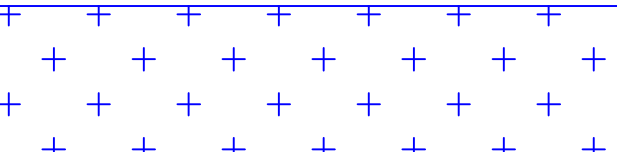

EXISTING ASBESTOS TILE FLOORING
TO BE ABATED.



EXISTING ASBESTOS SHEET FLOORING
TO BE ABATED.

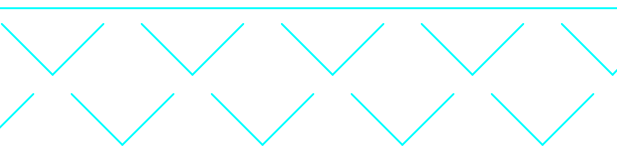

NEW 18"x18" SOLID VINYL TILE FLOORING TO BE INSTALLED.
AMTICO STONE PATTERNS OR EQUAL. COLOR TBD.



NEW 18"x18" SOLID VINYL TILE FLOORING TO BE INSTALLED
IN THIS AREA. AMTICO STONE PATTERNS OR EQUAL. COLOR TBD.

NOTES

- 1. ABATE EXISTING ASBESTOS CONTAINING FLOORING AND MASTIC IN ACCORDANCE WITH SPECIFICATION SECTION 02 82 13.19. REMOVE EXISTING BASE.
- 2. INSTALL NEW TILE FLOORING AND BASE IN THIS AREA.
- 3. INSTALL NEW NON-SKID TILE ON RAMPS. ARMSTRONG 12" X 12" SAFETY ZONE OR EQUAL. REPLACE EXISTING 6' BASE ON RAMPS WITH NEW 6" BASE.

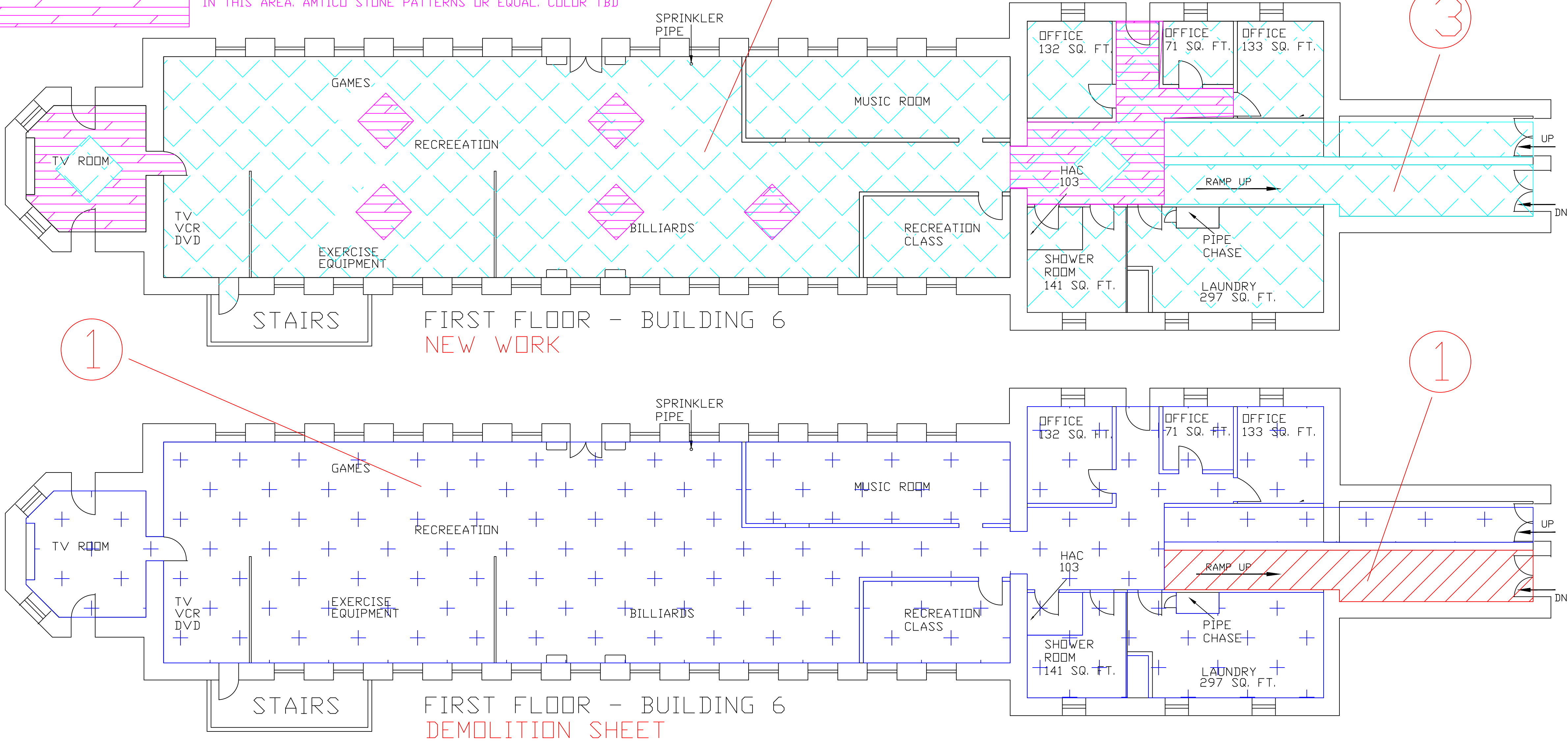

REVISIONS	DATE

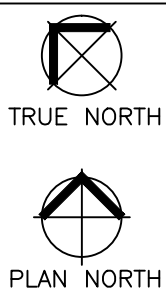

Drawing Title BUILDING 6 FIRST FLOOR	Project Title REPLACE FLOORING PHASE 1	Project No. 568-12-201 Building Number 6	Office of Facilities Management
Drawing Scale 1/8" = 1'	Location V.A. MEDICAL CENTER HOT SPRINGS, SD	DRAWING NO. A3 Dwg. 4 of 11	
Plot Scale 1/8" = 1'	Date 11/25/2011	Checked DS	Drawn DS
Approved: Division Chief	Approved: Service Director		