

0
three inches = one foot
1
one and one-half inches = one foot
2
one inch = one foot
3
three-quarters inch = one foot
4
one-half inch = one foot
5
three-eighths inch = one foot
6
one-quarter inch = one foot
7
one-eighth inch = one foot



1 EXISTING STEAM/CHILLED WATER LINES INTO BUILDING. CAP LINES INSIDE THE BUILDING.

EXISTING STEAM/CHILLED WATER LINES

1
M5.1
NOT TO SCALE



1 EXISTING EXHAUST FAN OPENING TO BE CAPPED INSIDE BUILDING WITH INSULATED CAP.

EXISTING EXHAUST FAN OPENINGS

2
M5.1
NOT TO SCALE



1 EXISTING HYDRONIC PIPING TO BE REMOVED.

EXISTING HYDRONIC PIPING

3
M5.1
NOT TO SCALE



1 EXISTING HYDRONIC PIPING TO BE REMOVED.

EXISTING HYDRONIC PIPING

4
M5.1
NOT TO SCALE



1 EXISTING HYDRONIC PIPING TO BE REMOVED.

EXISTING HYDRONIC PIPING

5
M5.1
NOT TO SCALE



1 TYPICAL EXISTING WINDOW UNIT TO BE REMOVED.

EXISTING WINDOW UNIT

6
M5.1
NOT TO SCALE



1 REMOVE EXISTING ROOFTOP UNIT AND ALL SUPPLY AND RETURN DUCTS. CAP AND SEAL ALL ROOF OPENINGS AIR AND WATER TIGHT.

EXISTING ROOF TOP UNIT

7
M5.1
NOT TO SCALE

HVAC DETAILS - BUILDING 93

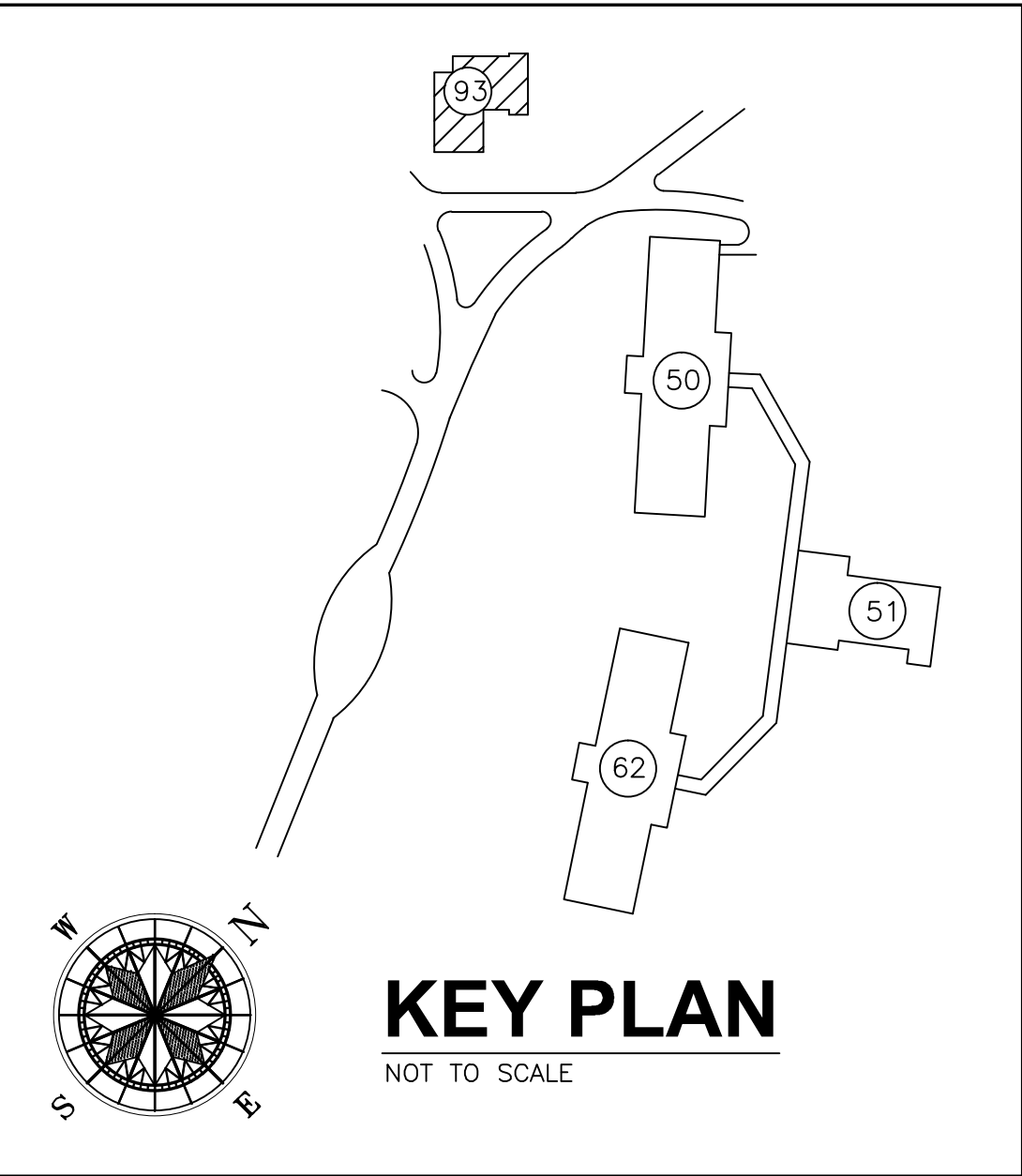

WHORTON ENGINEERING, INC.

HVAC - PLUMBING - PROCESS CONTROL

RANDALL WHORTON, P.E.
PH 256/820-9897 FAX 256/820-9896

25 SUMMERALL GATE ROAD
ANNISTON, ALABAMA 36205

WHORTON ENGINEERING PROJECT NO. 10159

ALABAMA
REGISTERED
No. 14192
PROFESSIONAL
ENGINEER
MECHANICAL
RANDALL D. WHORTON

Revisions

Date

MCE MILLS-CONOLY ENGINEERING, P.C.

8218 Old Federal Road
TELEPHONE: (334) 270-0010

Montgomery, AL 36117
FAX: (334) 270-0040

CAVHCS

Central Alabama Veterans Health Care System

Approved:

Approved:

Approved:

Approved:

Approved:

Approved:

Approved:

Approved:

Drawing Title

HVAC DETAILS - BUILDING 93

Safety Officer

Clinical Representative

Project Title

HVAC MODIFICATIONS TO BUILDINGS 83, 90, & 93 TUSKEGEE, ALABAMA

Building Number 93

Checked RDW

Drawn JAD

Location East Campus, Tuskegee, AL

Date 12/21/10

Project No. 619-10-445

DRAWING NO.

93M3.2

Dwg. 49 of 59

Veterans Administration