

1 FLOOR FRAMING PLAN
1/2" = 1'-0"

2 CEILING FRAMING PLAN
1/2" = 1'-0"

MEDICAL EQUIPMENT		WEIGHT
SP	Clea Stand w/ Optional Extension Rails	2551 lbs
MT	Maquet Table	1053 lbs
ME	Cerady IX Generator Cabinet	320 lbs
MP	Peripheral 40E Cabinet	441 lbs
MA	Main 40E Cabinet	826 lbs
MB	Image 40E Cabinet	441 lbs
UP	4400 UPS Cabinet - 25 kVA	1125 lbs
UC	Universal Power Controller - 25 kVA	1020 lbs
STRIKER EQUIPMENT		
A	Tandem Teleson: - F628 surgical light / lead shield adapter arm - Dual flat panel arm	500 lbs
B	Tandem Teleson: - TP-622-C (anesthesia boom) - TC single flat panel arm	255 lbs
C	Teleson: TP-632 (equipment boom)	220 lbs
D	Teleson: TP-612 (large monitor boom)	300 lbs
All Striker boom supports designed for a vertical load & moment of: All loads per manufacturer's requirements.		
Teleson:		1100 lbs & 5650 ft.-lbs

STRUCTURAL AND MISCELLANEOUS STEEL

1. Detailing, fabrication and erection shall conform to the Steel Construction Manual of AISC.
2. All steel to be A36 except as noted.
3. All welds to be made by Certified Welders to AWS Standards with E70XX electrodes.
4. Bolts to be A307 unless noted otherwise.
5. All structural tubing to be ASTM A500 Grade B fy = 46 ksi.
6. Do not oversize drilled or punched holes with burning torch.
7. Where reference is made to "Unistrut," members shall conform to the Unistrut Corporation requirements. All connection hardware to be connected w/ 1/2" Unistrut bolt, typical uno.

SPECIAL INSPECTIONS

1. Special inspections are to be performed by a qualified independent special inspector and shall conform to Section 109 and Chapter 11 of the 2007 Oregon Structural Specialty Code (OSSC).
2. Inspections are to be continuous or periodic as defined by IBC Chapter 17: Steel (OSSC table 1704.3).
3. During the welding of all members or connections except as noted in IBC Table 1704.3.
4. The special inspection requirements are equally applicable to prefabricated as well as bidder designed construction.
5. Any items failing to meet the project specifications shall be immediately brought to the attention of the architect and structural engineer.
6. The special inspector shall provide a copy of their report to the owner, architect, structural engineer, contractor, and building official as each test is completed.

- 1 (E) DECK CONSTRUCTION CONSISTS OF 2" COMPOSITE METAL DECK W/ 3" CONCRETE TOPPING (5" TOTAL THICKNESS).
- 2 (E) DECK CONSTRUCTION CONSISTS OF 1 1/2" COMPOSITE METAL DECK W/ 2 1/8" CONCRETE TOPPING.
- 3 UNISTRUT "F5001" - LOCATE PER SIEMENS REQUIREMENTS. PROVIDE UNISTRUT "F5001" BLOCKING BETWEEN SUPPORTS 4'-0" o/c MAXIMUM. SEE DETAILS.

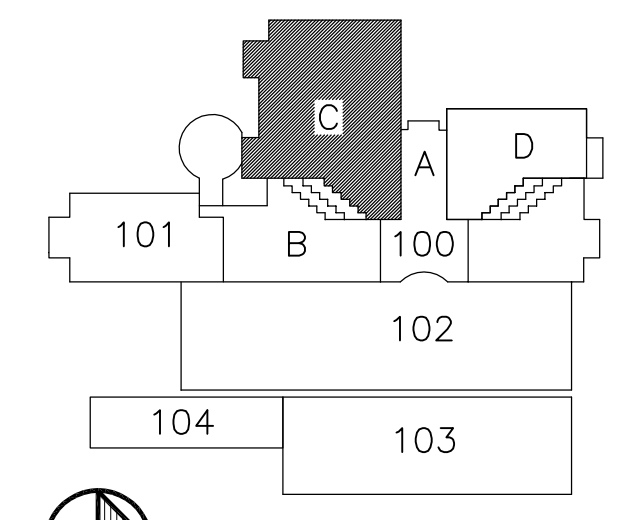

SCALE: As Noted

REGISTERED PROFESSIONAL
ARCHITECT
JOHN E. ANDERSON
EXPIRES 12/31/16

ANDERSON ARCHITECTS DABROWSKI
1430 SE 3RD AVE SUITE 200
PORTLAND, OR 97214
Tel 503.239.7377 Fax 503.239.7327

VETERANS AFFAIRS HEALTH CARE SYSTEM
PORTLAND, OREGON

PLANS & SECTIONS

Approved: Infection Ctrl.

Approved: Safety Map

Approved: Chief P&C

Approved: Chief M&R

Approved: Service Chief

Approved: Chief F&S

Approved: Director, VAWC

Project Title
**VA Medical Center Portland, Oregon
Bldg. 100 Third Floor - Hybrid OR**

Building No.
100C

Checked / Project Mgr.
JHW/JEN

Location
PORTLAND, OREGON

Date
04.11.16

Project No.
648-15-122 AD 15108

Drawing No.
S1

Page
15 of 37