

# CONCRETE BEAM SCHEDULE

MARK	WIDTH	DEPTH	REINFORCEMENT						ARR.	STIRRUPS	REMARKS
			BOTTOM		TOP		S=W	N=E			
			STRAIGHT NO. SIZE	BENT NO. SIZE							
RB-1	VARIABLES 12/14	27	2'-7"	2'-7"	2'-5"	2'-5"			7'-3"	Ø 12	
RB-2	VARIABLES 12/14	27	2'-7"	2'-7"	2'-5"	2'-5"			7'-3"	Ø 6	ADD 2'-8" T. CONT.
RB-3		16	3'-6"						7'-3"	Ø 6	ADD 3'-6" T. CONT.
RB-4		36	4'-8"	5'-9"	2'-6"				11'-3"	Ø 6	
RB-5		36	4'-7"								ADD 3'-9" T. CONT.
RB-6		36	4'-8"	6'-8"		2'-6"			11'-3"	Ø 6	
RB-7		18	4'-6"	6'-6"	2'-6"	2'-6"			10'-9"	Ø 6	
RB-8		18	4'-6"								ADD 3'-9" T. CONT.
RB-9		30	4'-8"	5'-9"	3'-7"	3'-7"			9'-3"	Ø 6	
RB-10		36	4'-8"	5'-9"		2'-9"			9'-3"	ALL Ø 6 END	EXTEND 3'-9" OVER E. SUPPLY TO MIDSPAN OF ADJ. BM.
RB-11		36	4'-7"								ADD 2'-8" T. CONT.
RB-12		36	2'-6"	6'-6"					6'-3"	Ø 6	
RB-13		36	4'-6"	6'-6"	4'-6"				5'-3"	Ø 6	
RB-14		30	2'-5"	3'-6"					5'-3"	Ø 6	
RB-15		30	2'-8"	5'-8"	2'-8"	2'-8"			6'-3"	Ø 6	
RB-16		30	4'-6"	5'-7"	2'-8"				6'-3"	Ø 6	
RB-17		48	15'-6"	7'-10"	3'-8"	3'-8"			20'-3"	Ø 6 & 8 BAL. Ø 6	
RB-18		48	15'-6"								ADD 3'-9" T. CONT. EXTEND STR. BOT. BARS 1'-6" WITH BOT. BARS OF ADJ. BM.
RB-19		12	2'-9"	2'-9"					3'-9"	Ø 6	
RB-20		18	3'-10"	3'-10"					5'-3"	Ø 6	
RB-21		18	2'-6"	4'-9"					5'-4"	Ø 12	
RB-22		36	4'-8"	5'-9"	2'-9"				8'-3"	Ø 6 ALL Ø 6 END	EXTEND 2'-9" OVER W. SUPPLY TO MIDSPAN OF ADJ. BM.
RB-23		36	4'-6"	6'-6"		4'-6"			4'-3"	Ø 6	
RB-24		30	2'-11"		2'-11"	4'-11"			10'-4"	Ø 6 & 8 BAL. Ø 6	ADD 3'-9" T. CONT. EXTEND STR. BOT. BARS TO PAST FACE OF E. SUPPLY.
RB-25		30	4'-6"						10'-4"	Ø 6 & 8 BAL. Ø 6	ADD 3'-9" T. CONT.
RB-26		30	4'-7"	6'-8"	2'-8"	4'-7"			8'-3"	Ø 6 ALL Ø 6 END	EXTEND STR. BOT. BARS 5'-0" PAST FACE OF W. SUPPLY.
RB-27		18	2'-5"		3'-7"	3'-7"			10'-4"	Ø 6 ALL Ø 6 END	EXTEND STR. BOT. BARS 5'-0" PAST FACE OF W. SUPPLY.
RB-28		30	4'-7"	6'-8"	4'-7"	6'-8"			10'-4"	Ø 6 ALL Ø 6 END	EXTEND STR. BOT. BARS 5'-0" PAST FACE OF W. SUPPLY.
RB-29		24	15'-9"	2'-9"	4'-9"	2'-8"			7'-3"	Ø 6	EXTEND STR. BOT. BARS 2'-0" PAST FACE OF W. SUPPLY.
RB-30		24	4'-6"								ADD 2'-9" T. CONT.
RB-31	VARIABLES 12/16	27	2'-6"	2'-6"							
RB-32	VARIABLES 12/14	27	2'-6"	2'-8"	2'-5"	2'-5"			5'-9"	Ø 12	
RB-33		30	4'-7"	4'-8"	2'-5"	4'-8"			7'-3"	Ø 6	
RB-34	VARIABLES 12/14	27	3'-8"		3'-8"	2'-6"			12'-3"	Ø 6 & 8 BAL. Ø 6	ADD 3'-9" T. CONT. EXTEND STR. BOT. BARS 1'-6" PAST FACE OF E. SUPPLY.
RB-35	VARIABLES 12/14	27	2'-7"	2'-7"		2'-8"			10'-3"	Ø 6 & 8 BAL. Ø 6	BEND @ W. END
RB-36		18	4'-5"						10'-3"	Ø 6	ADD 2'-5" T. CONT.
RB-37		18	4'-7"	3'-7"	3'-7"	3'-7"			9'-3"	Ø 6	EXTEND STR. BOT. BARS 1'-6" PAST FACE OF E. SUPPLY.
RB-38		18	2'-7"	3'-8"	2'-6"	2'-7"			8'-3"	Ø 6	EXTEND STR. BOT. BARS 1'-6" PAST FACE OF W. SUPPLY.
RB-39		18	2'-5"	2'-5"	2'-5"				6'-3"	Ø 6	BEND @ E. END
RB-40	VARIABLES 12/14	27	2'-7"	2'-7"	2'-8"				10'-3"	Ø 6 & 8 BAL. Ø 6	BEND @ E. END
RB-41		18	3'-8"	2'-8"							
RB-42		18	3'-9"	3'-9"		4'-8"			30'-3"	Ø 6 & 8 BAL. Ø 6	BEND @ W. END
RB-43		30	15'-7"	4'-8"	4'-8"	2'-5"			7'-3"	Ø 6	
RB-44		24	3'-7"	4'-8"	2'-6"						EXTEND STR. BOT. BARS 1'-6" PAST FACE OF E. SUPPLY.
RB-45		24	4'-6"								ADD 4'-8" T. CONT.
RB-46		48	6'-7"	8'-8"	4'-6"						EXTEND STR. BOT. BARS 1'-6" PAST FACE OF E. SUPPLY.
RB-47		48	15'-6"								ADD 4'-8" T. CONT.
RB-48		14	2'-8"	2'-9"	2'-6"				3'-9"	Ø 12 & 10 BAL. Ø 6	
RB-49		14	4'-6"						3'-9"	Ø 12	ADD 2'-10" T. CONT.
RB-50		23	3'-10"	2'-8"							
RB-51		14	4'-8"						9'-3"	Ø 6 & 8 BAL. Ø 6	ADD 2'-9" T. CONT. - SEE DET. SHEET 1549 FOR DETAILS FOR PIER.
RB-52	8 1/2" / 7 1/4"	18	5'-11"	4'-11"					9'-3"	Ø 6	
RB-53		16	3'-9"	2'-7"					9'-3"	Ø 6 & 8 BAL. Ø 6	

CONTINUED ON I-536

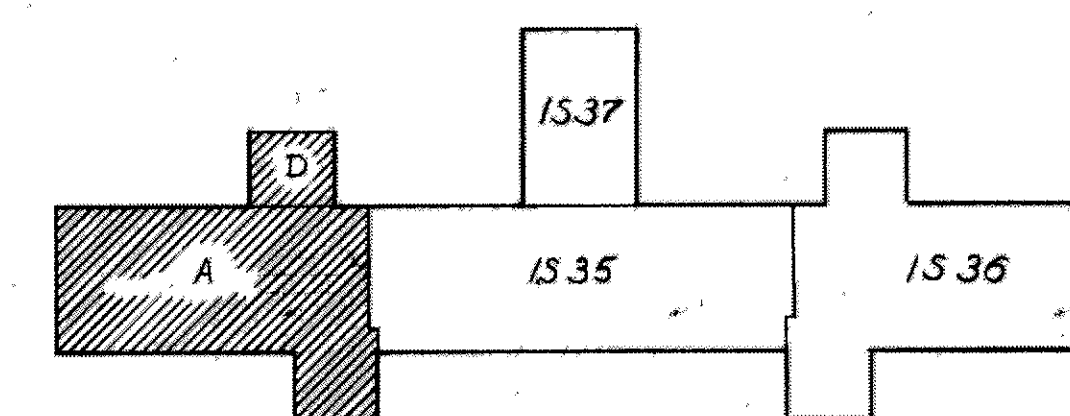

SCALE 1/8" = 1'-0"



AS BUILT

ROOF FRAMING PLAN UNITS A & D	
BUILDING NO. 1	
800 BED GM&S HOSPITAL & REGIONAL OFFICE MEDICAL CLINICS	
VETERANS ADMINISTRATION CLEVELAND (WADE PARK), OHIO	
DRAWN: J.A. HILMAN CHECKED: J.A. HILMAN DATE: 11/1/11	REVISIONS 1-534 11/1/11
DALTON-DALTON ASSOCIATES SMITH, HINCHMAN & GRYLLS ASSOC., INC. ARCHITECTS-ENGINEERS 979 THE ARCADE CLEVELAND 14, OHIO	
APPROVED DIRECTOR, DESIGN SERVICE	PROJ. NO. 6-4086

AS BUILT

FILE FOLDER NO. 2A

RETURN TRACINGS TO PLAN FILES