



PUMP SCHEDULE										
PUMP No.	LOCATION	SERVICE	TYPE	GPM	TOTAL HEAD FT @ 110	MOTOR				REMARKS
						HP	RPM	VOL % 60 HZ	PH	
DMP-1	PUMP RM. #1	DOMESTIC WATER LOWER LEVEL THRU 4th FLOOR	VERTICAL TURB.	245	134	15	3500	480	3	FACTORY PACKAGED SYSTEM
DMP-2 & 3	PUMP RM. #1	DOMESTIC WATER LOWER LEVEL THRU 4th FLOOR	VERTICAL TURB.	490	134	25	3500	480	3	FACTORY PACKAGED SYSTEM
DMP-4	PUMP RM. #1	DOMESTIC WATER FLOORS 5, 6 & 7	VERTICAL TURB.	80	180	7 1/2	3500	480	3	FACTORY PACKAGED SYSTEM
DMP-5 & 6	PUMP RM. #1	DOMESTIC WATER FLOORS 5, 6 & 7	VERTICAL TURB.	160	180	15	3500	480	3	FACTORY PACKAGED SYSTEM
HMC-1 & 1A	MER-0065	HH-LOWER LEVEL THRU 4th FLOOR	IN - LINE	150	14	3/4	1150	480	3	PROVIDE TWO UNITS ONE AS STAND-BY
HMC-2 & 2A	MER-0065	HH-FLOORS 5, 6 & 7	IN - LINE	21	22	1 1/2	1750	480	3	PROVIDE TWO UNITS ONE AS STAND-BY
HMC-3 & 3A	MER-0065	KITCHEN CANTINEEN & SPILLAGE ROOM	IN - LINE	12	10	1/2	1750	120	1	PROVIDE TWO UNITS ONE AS STAND-BY
SP-1 & 2	PIPE GALLERY	EQUIPMENT DRAINAGE	DUPLEX	50	30	1	1750	480	3	VERTICAL-FACTORY PACKAGED SYSTEM
SEP-1 & 2	EMERGENCY CENTER	ROOM DRAINAGE	DUPLEX	50	37	1 1/2	1750	480	3	VERTICAL-FACTORY PACKAGED SYSTEM

WATER HEATER SCHEDULE									
UNIT No.	LOCATION	SERVICE	GPM	ENT	LVT	STEAM & CONT. VALVE			REMARKS
						PRESSURE	CONT. VALVE	STEAM TRAP	
DWH-1	MER0065	DOMESTIC HW LOWER LEVEL THRU 4th FLOOR	150	40°F	140°F	30 PSI	80/70	24/210	HEATER SHALL BE CAPABLE OF PRODUCING 160°F WATER AT A REDUCED CAPACITY.
DWH-2	MER0065	DOMESTIC HW LOWER LEVEL THRU 4th FLOOR	150	40°F	140°F	30 PSI	80/70	24/210	HEATER SHALL BE CAPABLE OF PRODUCING 160°F WATER AT A REDUCED CAPACITY.
DWH-3	MER0065	FLOORS 5, 6 & 7	45	40°F	140°F	30 PSI	24/20	7/250	HEATER SHALL BE CAPABLE OF PRODUCING 160°F WATER AT A REDUCED CAPACITY.
DWH-4	MER0065	FLOORS 5, 6 & 7	45	40°F	140°F	30 PSI	24/20	7/250	HEATER SHALL BE CAPABLE OF PRODUCING 160°F WATER AT A REDUCED CAPACITY.
DWH-5	MER0065	DOMESTIC HW KITCHEN	72	40°F	140°F	30 PSI	38/75	11/525	HEATER SHALL BE CAPABLE OF PRODUCING 160°F WATER AT A REDUCED CAPACITY.
DWH-6	MER0065	DOMESTIC HW KITCHEN CANTINEEN & SPD	72	40°F	140°F	30 PSI	38/75	11/525	HEATER SHALL BE CAPABLE OF PRODUCING 160°F WATER AT A REDUCED CAPACITY.

AIR COMPRESSOR SCHEDULE												
UNIT No.	LOCATION	SERVICE	TYPE	TANK CAPACITY GAL.	DELIVERY		RPM	MOTOR		DISCH. PRESS. PSI	REMARKS	
					SCFM SYSTEM TOTAL	PSI		HP SYSTEM TOTAL	VOLT			PH
AC-1	PUMP RM. #1	PATIENT TOWER	MULTI-PLEX	200	180 SCFM	100	1100	75	480	3	60	FACTORY PACKAGED SYSTEM
AC-2	PUMP RM. #1	D & T BLOCK	MULTI-PLEX	200	210 SCFM	100	1100	75	480	3	60	FACTORY PACKAGED SYSTEM
AC-3	PUMP RM. #1	LABORATORY	MULTI-PLEX	200	135 SCFM	110	1100	75	480	3	100	FACTORY PACKAGED SYSTEM
AC-4	LOWER LEVEL MER 0020	SHOP	SIMPLEX	80	25 SCFM	175	700	7 1/2	480	3	60	
AC-5	LOWER LEVEL MER 0010	DENTAL	DUPLEX	240	184 SCFM	175	—	50	480	3	175	FACTORY PACKAGED SYSTEM

REFRIGERATED AIR DRYER SCHEDULE									
UNIT No.	LOCATION	SERVICE	ASSOCIATED AIR COMPRESSOR	SCFM @ 35°F.	PRESSURE DROP (PSID)	MOTOR			REMARKS
						HP	VOLTS	PH	
AD-1	PUMP RM. #1	PATIENT TOWER	AC-1	2 @ 140 SCFM	2.0	1	480	3	FACTORY PACKAGED SYSTEM
AD-2	PUMP RM. #1	D & T BLOCK	AC-2	2 @ 170 SCFM	1.5	1 1/2	480	3	FACTORY PACKAGED SYSTEM
AD-3	PUMP RM. #1	LABORATORY	AC-3	2 @ 110 SCFM	2.0	1	480	3	FACTORY PACKAGED SYSTEM
AD-5	LOWER LEVEL MER 0010	DENTAL	AC-5	1 @ 125 SCFM	7.0	3	480	3	FACTORY PACKAGED SYSTEM

VACUUM PUMP SCHEDULE												
UNIT No.	LOCATION	SERVICE	TYPE	TANK CAPACITY GAL.	DELIVERY			RPM	MOTOR		REMARKS	
					SCFM	ACFM	1/2 Hg		HP	VOLTS		PH
VP-1, 2 & 3	LOWER LEVEL MER 0065	PATIENT TOWER	TRI-PLEX	120	23 EA.	60 EA.	19	1800	5 EA.	480	3	FACTORY PACKAGED SYSTEM
VP-4, 5 & 6	LOWER LEVEL MER 0020	D & T BLOCK	TRI-PLEX	200	41 EA.	111 EA.	19	1800	7 1/2 EA.	480	3	FACTORY PACKAGED SYSTEM
VP-7, 8 & 9	LOWER LEVEL MER 0010	LABORATORY	TRI-PLEX	200	59 EA.	156 EA.	19	1800	10 EA.	480	3	FACTORY PACKAGED SYSTEM
VP-10 & 11	LOWER LEVEL MER 0010	DENTAL	DUPLEX	2 @ 40 EA.	312 EA.	—	8		15 EA.	480	3	FACTORY PACKAGED SYSTEM

GREASE INTERCEPTOR SCHEDULE			
MARK	RATED FLOW CAPACITY GPM	MOUNTING POSITION	LOCATION
GI-1	35	ON FLOOR	1 st FL. KITCHEN
GI-2	20	ON FLOOR	1 st FL. KITCHEN
GI-3	35	PARTIALLY RECESSED	1 st FL. KITCHEN
GI-4	75	FULLY RECESSED	LOWER LEVEL KITCHEN
GI-5	20	FULLY RECESSED	LOWER LEVEL KITCHEN
GI-6	20	ON FLOOR	LOWER LEVEL KITCHEN

- NOTE:
1. REMOVE GREASE CONTAINERS SHALL BE LOCATED AS INDICATED ON DWS.
 2. FOR ON FLOOR UNITS, THE GREASE CONTAINER ORIENTATION SHALL BE AS SHOWN ON DWS.
 3. INTERCEPTOR UNITS GI-3, GI-4 AND GI-5 SHALL HAVE AN INTERNALLY LOCATED P5-1 PUMP.
 4. PARTIALLY & FULLY RECESSED UNITS SHALL HAVE HEATED HOSE RUNNING TO REMOVE GREASE COLLECTION CONTAINERS. CONTAINERS SHALL BE PLACED ON THE FLOOR, NOT IN THE WALL.
 5. PIT SIZE SHALL BE BASED ON GREASE OIL PRODUCTION. GREASE OIL PRODUCTION SHALL CORRELATE WITH DWS. CONCRETE PITS ARE POURED.
 6. PITS FOR INTERCEPTOR GI-4 & GI-5 SHALL HAVE FLOOR ACCESS COVERS. SEE ARCH. DWS.

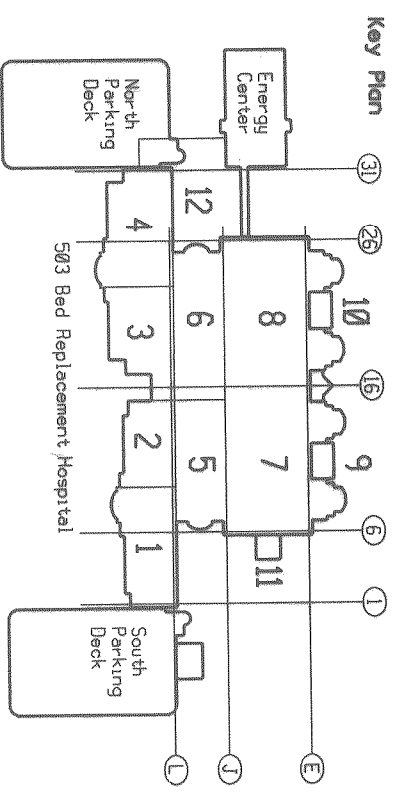
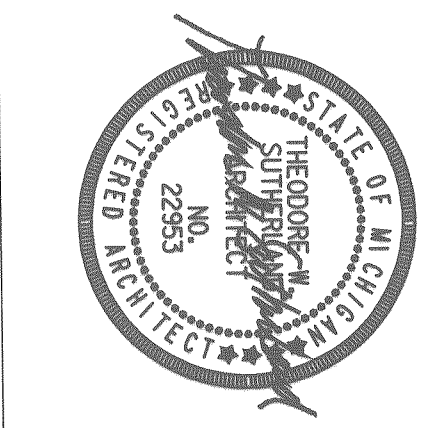

Drawing Title

PLUMBING EQUIPMENT SCHEDULE

Scale Note

Approved Area Project Manager

Project Title

503 BED REPLACEMENT HOSPITAL

Date

7-1-91

Project No.

553-080

Building Number

100

Checked

Drawn

Location

Detroit, Michigan

Drainage No.

P1-3

DWS

OR

Veterans Administration

Plot File

/usr/cglogin/iparms/vamsch21.dgn

Plot Date

16-SEP-1997 13:53