

VA MEDICAL CENTER
SPOKANE, WA
SECURITY / VIDEO AS-BUILTS
AUGUST, 2013

BY



DRAWING #	DRAWING TITLE
SE-0	COVER SHEET
SE-1	MATERIAL LIST / LEGEND
SE-2	SITE PLAN
SE-3	BUILDING RISERS
SE-3A	IDF RISERS
SE-4	BUILDING RISER
SE-5	BUILDING 1 BASEMENT WIRING DETAILS
SE-6	BUILDING 1 FIRST FLOOR WIRING DETAILS
SE-7	BUILDINGS 2, 3, 5, 6A, 7, 16 & 39 WIRING DETAILS
SE-8	BUILDINGS 4, 6, 12 & 14 WIRING DETAILS
SE-9	BUILDINGS 8, 20, 30, 31 & 32 WIRING DETAILS
SE-10	EQUIPMENT RACK DETAILS



MATERIAL LIST / LEGEND

MATERIAL LIST / LEGEND

[illegible]

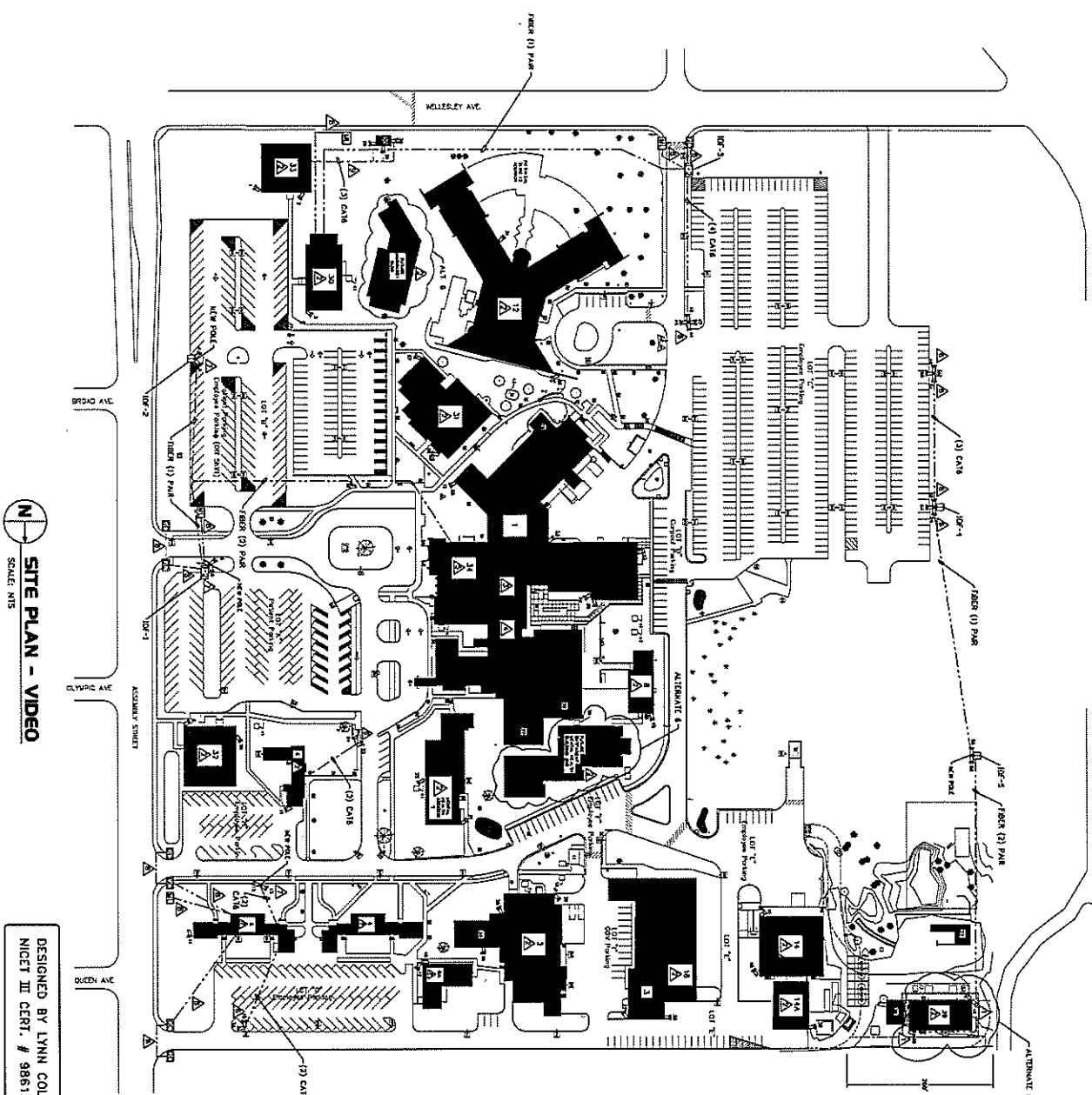

SITE PLAN - VIDEO
SCALE: NTS

DESIGNED BY LYNN COLBY
NICET III CERT. # 98615

- BUILDING NAMES**
- 1 MAIN HOSPITAL BLDG
 - 1E PHARMACY
 - 2 ENERGY PLANT/LAUNDRY
 - 3 PROJECTS/GARAGE/MAINTENANCE
 - 4 ENGINEERING
 - 5 ENGINEERING & MATERIAL MANAGEMENT/ENVIRONMENTAL
 - 6A TECHNOLOGY/HUMAN RESOURCES
 - 7 SUBSTANCE ABUSE TREATMENT/SOCIAL WORK
 - 8 PATIENT CARE SERVICES
 - 9 BLDG 10
 - 10 BOKKY GENERATOR
 - 11 TANKW GENERATOR
 - 12 KITCHEN PHARMACEUTICAL UNIT
 - 13 BLDG 11
 - 14 AAMA WAREHOUSE
 - 15 AAMA STORAGE
 - 16 FREEZING STORAGE AREA
 - 17 BLDG 4, 5, 6, 7, 8, 9 PADMOUNTED TRANSFORMER
 - 18 BLDG 2 PADMOUNTED TRANSFORMER
 - 19 BLDG 10 PADMOUNTED TRANSFORMER
 - 20 BLDG 10 VENTILATION SWITCHER
 - 21 LIQUID OXYGEN TANK
 - 22 BLDG 14 PADMOUNTED TRANSFORMER
 - 23 COOKING POWER TRANSFORMER
 - 24 CHILDREN PLANT TRANSFORMER
 - 25 BLDG 27 PADMOUNTED TRANSFORMER
 - 26 BLDG 27 PADMOUNTED TRANSFORMER
 - 27 CO-PATIENT CLINIC
 - 29 BLDG 30 PADMOUNTED TRANSFORMER
 - 30 EYE CLINIC/C.O.I.
 - 31 PHYSICAL THERAPY/PROSTHETICS
 - 32 PHYSICAL THERAPY
 - 33 DENTAL CLINIC
 - 34 EV/URGENT CARE
 - 37 NATIVE AMERICAN HEALING ARTS CENTER
 - 38 SWITCHGEAR BLDG
 - 39 GENERATOR BLDG
 - 40 MENTAL HEALTH BLDG
 - 41 BLDG 10
 - 42 HIGH VOLTAGE SWITCHGEAR

- KEYED NOTES THIS SHEET:**
- △ CAMERA ADDED
 - △ BUILDING RECEIVES NEW SECURITY PANEL, HUB CONNECTED TO MAIN OPTIC BACKBONE, ANY EXISTING SECURITY SYSTEM TO BE CONNECTED TO NEW PANEL, PANEL TO BE LOCATED IN RESPECTIVE FOR ROOM OF EACH BUILDING.
 - △ ALL EXISTING ACCESS CONTROLLED DOORS TO BE CONNECTED TO NEW SECURITY SYSTEM AND REQUIRED TO BE REKEYED TO NEW SECURITY SYSTEM TO BE FIELD VERIFIED PRIOR TO INSTALLATION.
 - △ LOCATE ALL NEW CCTV CAMS, SERVERS, STORAGE DEVICES AND NETWORK INTERFACES IN ROOM 80011A.
 - △ LOCATE NEW CCTV WORKSTATION IN SECURITY OFFICE, FIELD VERIFY FINAL LOCATION WITH END USER.
 - △ MOUNT SECURITY CAMERA ON EXISTING LIGHT POLE, WIRING BY ELECTRICAL CONNECTION.
 - △ NEW SECURITY CAMERA POLE.
 - △ 18/4 (COOPER) BETWEEN 18/ & 18/4 FOR REMOTE GATE OPERATION.
 - △ WHITE LENGTH NOT TO EXCEED 285'.

- GENERAL NOTES:**
1. ALL FIBER WILL BE 100-UM-APC.
 2. USE DIRECT BURIAL, WIRE AS REQUIRED.
 3. SEE LEGEND SHEET SC-1.
- EXISTING LIGHT**
- WHITE PATH**

- GENERAL NOTES:**
1. ALL TIEER WILL BE MULTI-MODE.
 2. USE DIRECT BURIAL WIRE AS REQUIRED.
 3. SEE LEGEND SHEET SE-1.

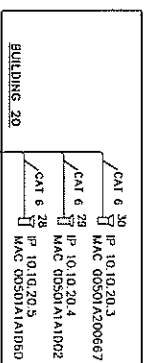
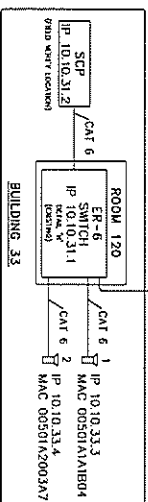
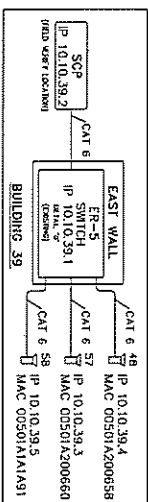
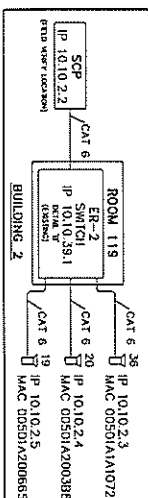
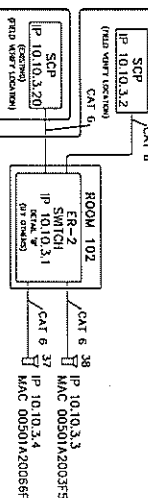
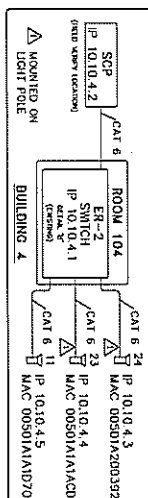
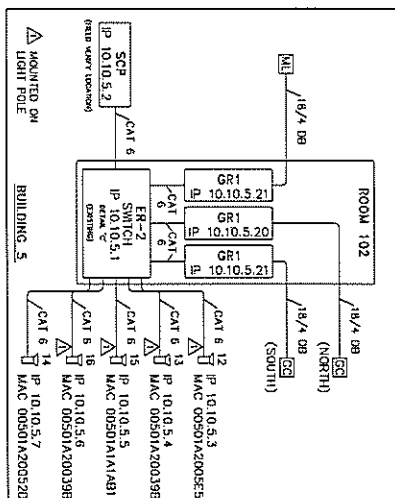
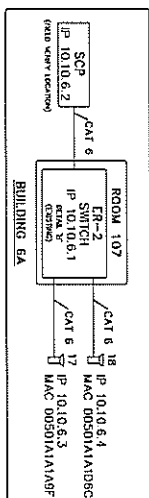
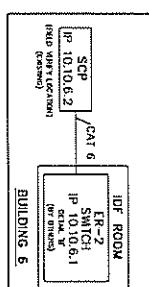
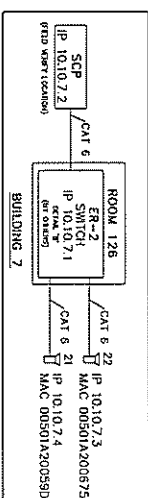
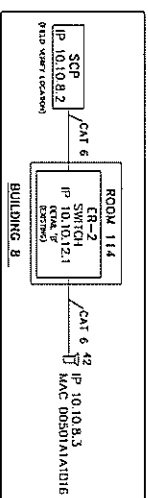
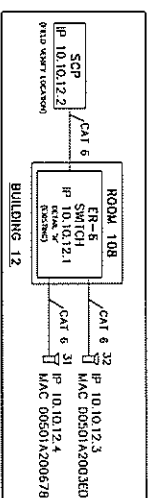
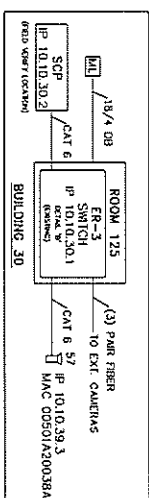
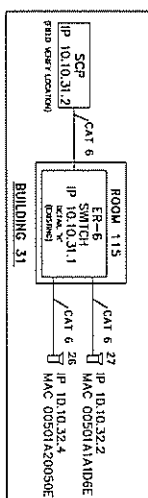
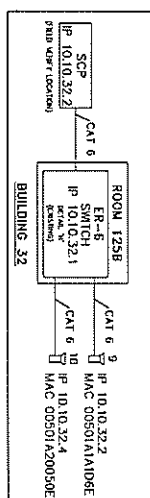
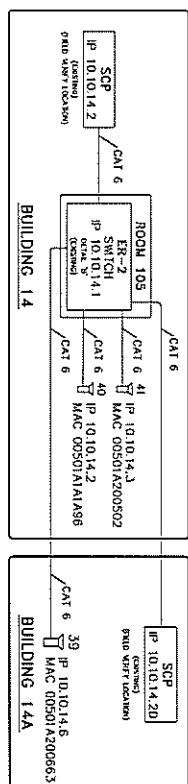

- GENERAL NOTES:**
1. ALL FIBER WILL BE MULTI-MODE.
 2. USE DIRECT BURIAL WIRE AS REQUIRED.
 3. SEE LEGEND SHEET SE-1.

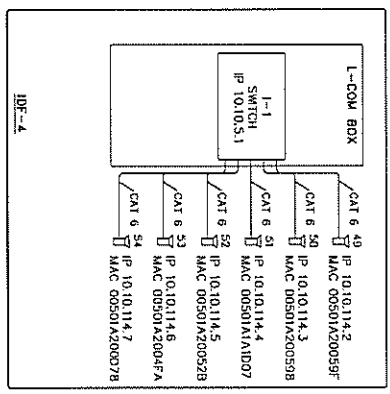
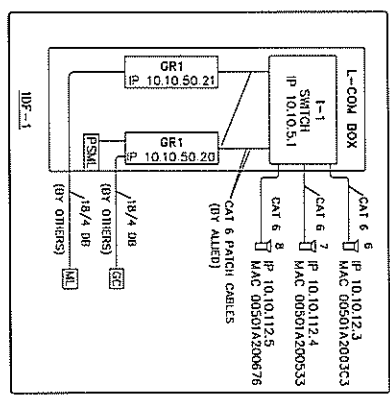
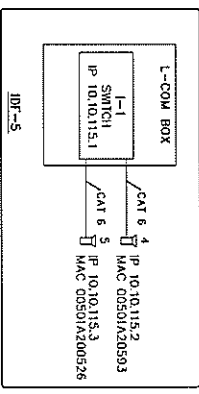
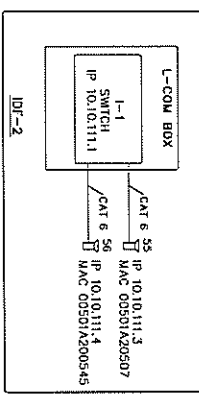
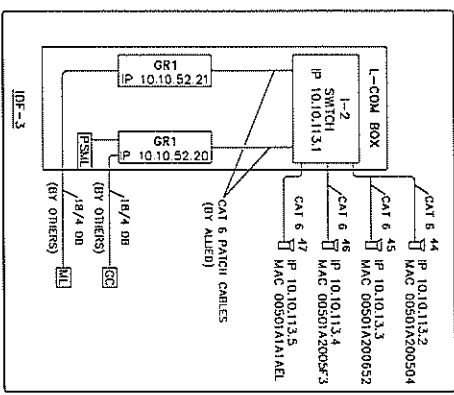

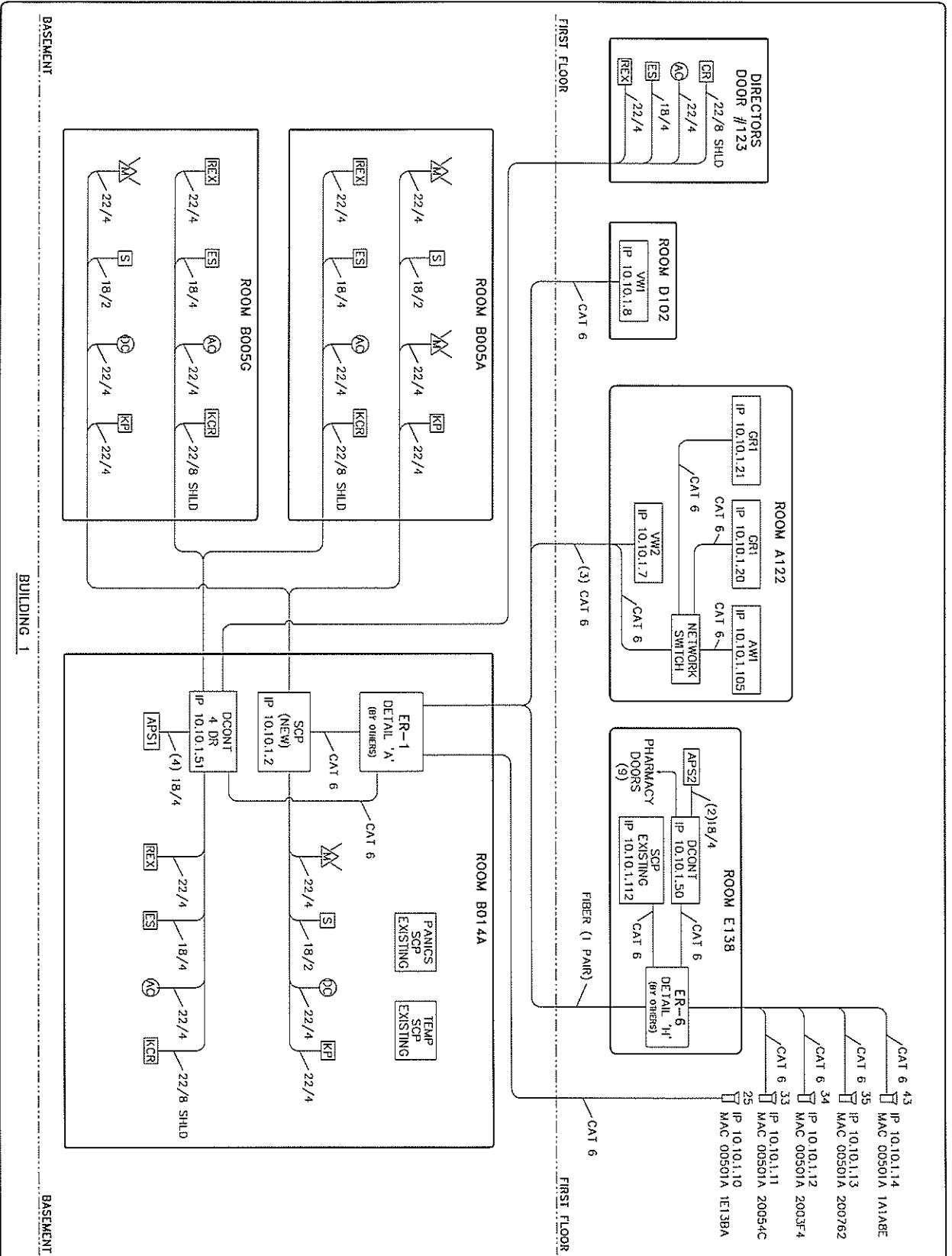

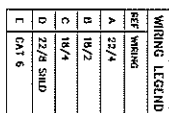

1. ALL FIBER WILL BE MULTI-MODE.
2. USE DIRECT BURIAL WIRE AS REQUIRED
3. SEE LEGEND SHEET SE-1.

1 EXISTING STRIKE

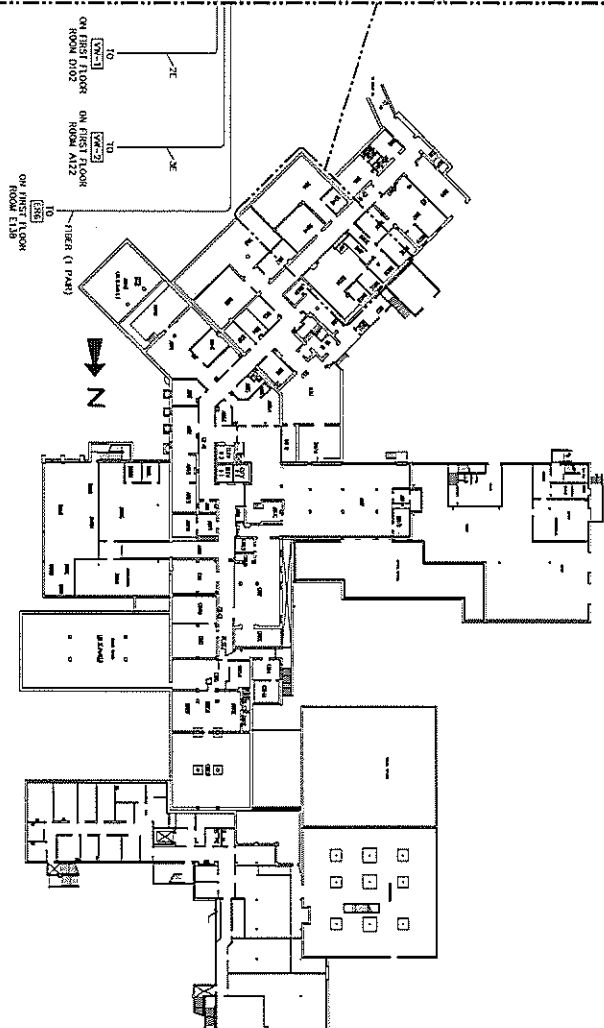

BUILDING 1 - BASEMENT
SCALE: 1/16"

ROTATED 45 DEGREES CCW FOR CLARITY
SCALE: NTS

1. ALL FIBER WILL BE MULTI-MODE.
2. USE DIRECT BURIAL WIRE AS REQUIRED.
3. SEE LEGEND SHEET SE-1.

KEYED NOTES THIS SHEET:

1 FIELD VERIFY EXACT LOCATION WITHIN ROOM.

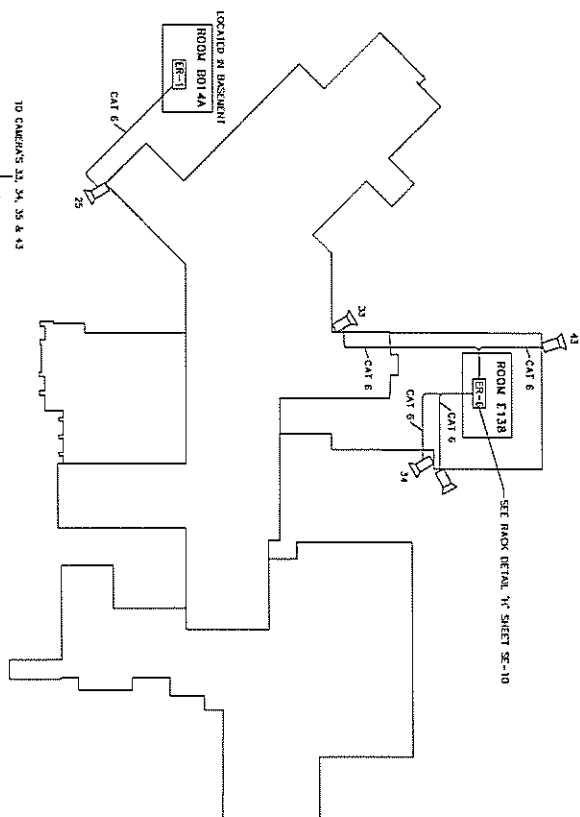

BUILDING 1 FIRST FLOOR CAMERA LAYOUT
SCALE: NIS

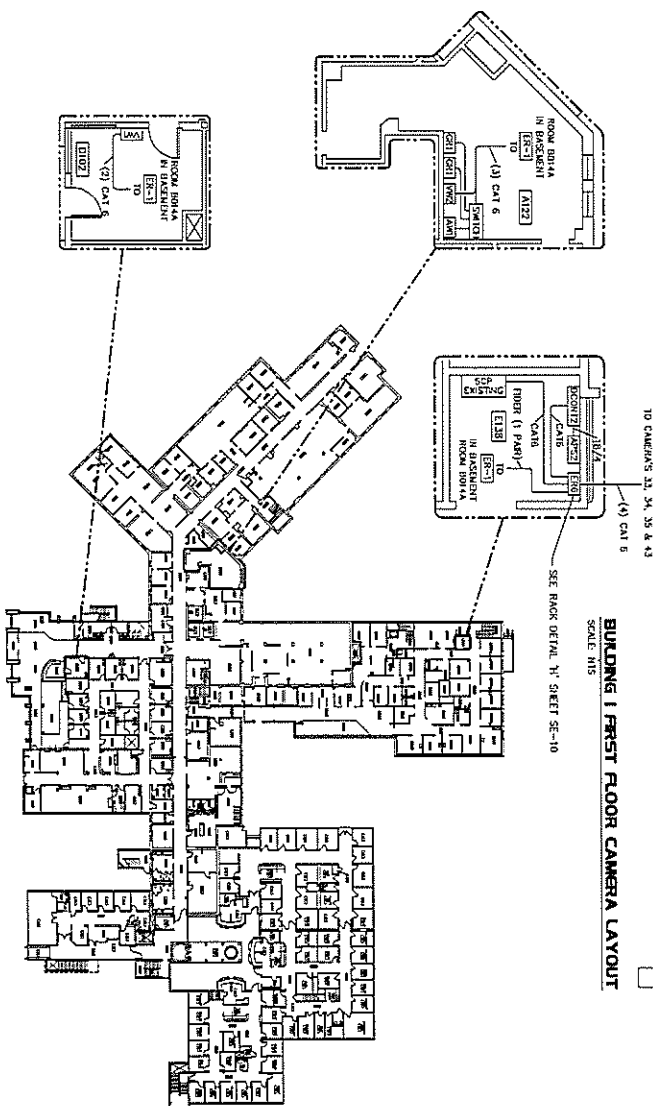

KEYED NOTES THIS SHEET:

- △ BUILDING RECEIVES NEW SECURITY PANEL HUB CONNECTED TO FIBER OPTIC BACKBONE. ANY EXISTING SECURITY SYSTEM TO BE CONNECTED TO NEW PANEL. PANEL TO BE LOCATED IN RESPECTIVE IDF ROOM OF EACH BUILDING.

△ MOUNT SECURITY CAMERA ON EXISTING LIGHT POLE.

GENERAL NOTES:

1. ALL FIBER WILL BE MULTI-MODE.
2. USE DIRECT BURIAL WIRE AS REQUIRED.
3. SEE LEGEND SHEET SE-1.

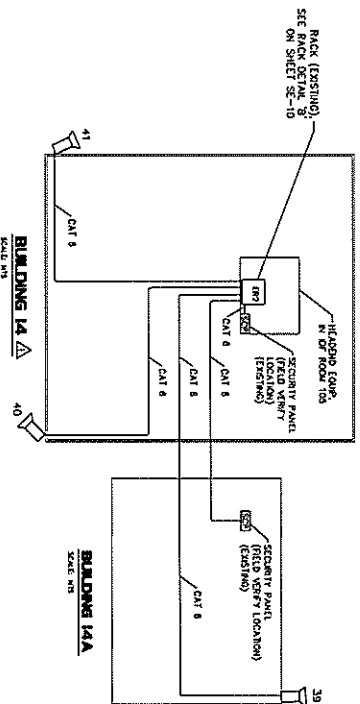
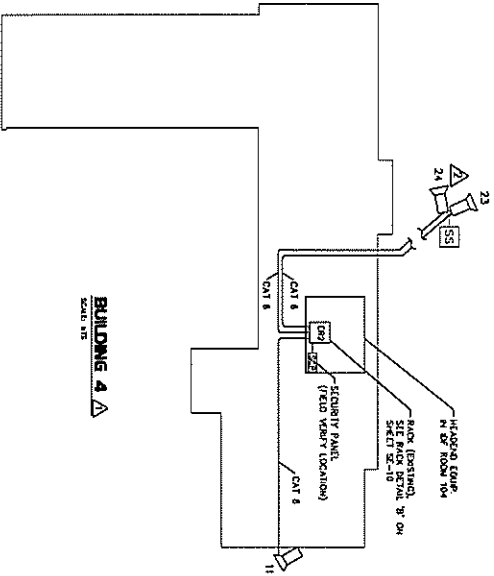
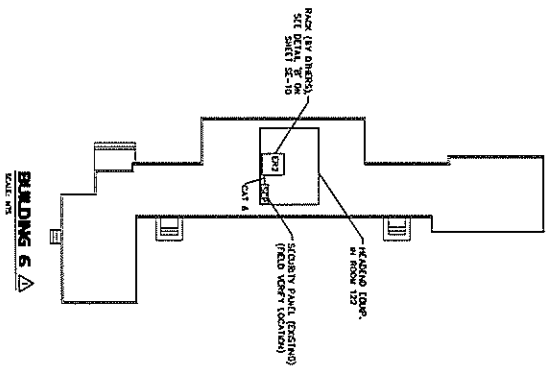
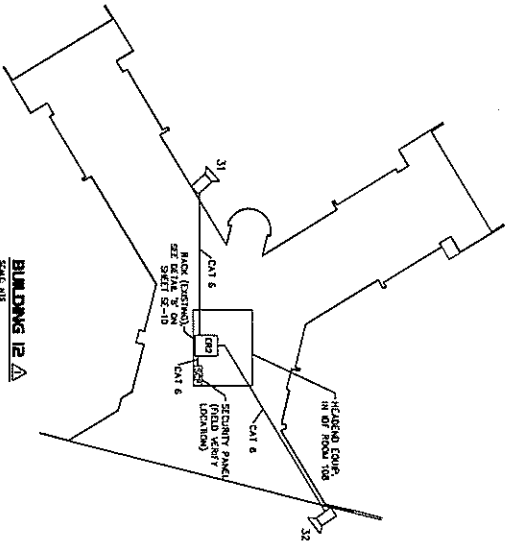

GENERAL NOTES:

1. ALL FIBER WILL BE MULTI-MODE.
2. USE DIRECT BURIAL WIRE AS REQUIRED.
3. SEE LEGEND SHEET SE-1.

2 18/4 (COPPER) BETWEEN IDF & GATE MOTOR CONTROL FOR
REMOTE GATE OPERATION.

