

one eighth inch = one foot  
one quarter inch = one foot  
one half inch = one foot  
three eighths inch = one foot  
three quarters inch = one foot  
one inch = one foot  
one and one half inches = one foot  
two inches = one foot  
three inches = one foot



**F1** LEVEL 02 EQUIPMENT PLAN  
1/4" = 1'-0"

<u>EQUIPMENT / ACCESSORY SCHEDULE</u>					
01	OFOI	BULLETIN BOARD	26	OFOI	FUTURE PNEUMATIC TUBE STATION
02	OFOI	SOAP DISPENSER, WALL-MTD.	27	OFOI	SHREDDER BOX
03	OFOI	PAPER TOWEL DISPENSER, WALL-MTD.	28	CFCI	MED / GAS SHUT-OFF VALVE
04	OFOI	WASTE RECEPTACLE (BELOW, IN PLAN)	29	OFOI	TELEPHONE, WALL MOUNTED
05	OFOI	GLOVES DISPENSER, WALL-MTD	30	OFOI	IV PREP POLE
06	OFOI	SHARPS DISPOSAL RECEPTACLE, WALL-MTD.	31	OFOI	COMPUTER MONITOR & LIFT
07	OFOI	DIAGNOSTIC RAIL	32	OFOI	SUSPENDED CPU HOLDER
08	CFOI	FILES STORAGE	33	CFCI	SS SINK w/ GOOSENECK FAUCET AND LEVER HANDLES
09	OFOI	MOBILE STOOL	34	OFOI	SUSPENDED MILLWORK PEDESTAL (BOX/BOX)
10	OFOI	CART PARK	35	OFOI	PULL-OUT KEYBOARD TRAY & COMPUTER KEYBOARD
11	OFOI	MOBILE CART	36	OFOI	FULL-HT REFRIGERATOR
12	CFCI	MED GAS OUTLETS: A / O / V	37	OFOI	MICROWAVE OVEN
13	OFOI	CHEMO SPILL CART	38	OFOI	COFFEE MACHINE
14	OFOI	SCALE	39	OFOI	MOBILE PEDESTAL
15	OFOI	EXAM TABLE	40	OFOI	IV POLE, RECLINER MOUNTED
16	OFOI	WIRE GRID SHELVEING	41	OFOI	IV POLE, MOBILE
17	OFCI	CUBICLE CURTAIN & TRACK	42	OFOI	SELF CHECK-IN KIOSK
18	CFCI	COUNTER	43	OFOI	PATIENT LIFT - FLOOR
19	OFOI	MOBILE EXAM LIGHT	44	OFOI	CRASH CART
20	OFOI	BIO-SAFETY HOOD	45	OFCI	ICE MACHINE
21	OFOI	SECURE STORAGE DISPENSING	46		NOT USED
22	OFOI	CENTRIFUGE	47	OFOI	FLAT SCREEN
23	OFOI	PRINTER / COPY / FAX (STANDING UNIT)	48		NOT USED
24	OFOI	PRINTER / COPY / FAX (COUNTER MOUNTED)	49	OFOI	UNDERCOUNTER REFRIGERATOR
25	OFOI	LABEL PRINTER			

HEALTHCARE CASEWORK COMPONENT (HCC) SCHEDULE (OFOI)			
HCC-01	HEALTHCARE COMPONENT CASEWORK (HCC) UNIT	HCC-15	WORKSTATION MODULE w/ RECESSED POWER & DATA OUTLETS AND AN INTEGRATED LAPTOP WORKSURFACE SUPPORTED BY AN ARTICULATING EXTENSION ARM
HCC-02	INTEGRATED SINK MODULE w/ ENCLOSURE, FAUCET & 24" W ABS-SINK PANEL	HCC-16	24" / 36" / 48" W UPPER PANEL MODULE
HCC-03	SOAP DISPENSER, INTEGRATED RAIL-MTD ACCESSORY	HCC-17	24" / 36" / 48" W MID-HT PANEL MODULE
HCC-04	SHARP DISPOSAL, INTEGRATED RAIL-MTD ACCESSORY	HCC-18	24" / 36" / 48" W LOWER PANEL MODULE
HCC-05	RAIL MOUNTED GLOVES DISPENSER	HCC-19	CLOSE-OUT CABINET TOP
HCC-06	MOTION ACTIVATED PAPER TOWEL DISPENSER	HCC-20	24" / 36" / 48" W STORAGE CABINET MODULE
HCC-07	INTEGRATED ACCESSORY RAIL FOR SOAP DISPENSER, SHARPS DISPOSAL RECEPTACLE		
HCC-08	DIAGNOSTIC RAIL		
HCC-09	INTEGRATED MOBILE LINEN CART		
HCC-10	WORK COUNTER w/ BACKSPLASH AND LINEN CART SPACE BELOW		
HCC-11	WORK COUNTER w/ BACKSPLASH AND 3-DRAWER MODULE BELOW		
HCC-12	SIT/STAND WORKSURFACE MODULE w/ CPU HANGER		
HCC-13	48" W WORKSURFACE MODULE w/BACKSPLASH		
HCC-14	WORKSTATION MODULE w/ POWER & DATA OUTLETS, ACCESSORY RAIL, AND COMPUTER MONITOR MOUNT		
HCC-15	HEADWALL UNIT w/ DIAGNOSTIC RAIL, POWER, DATA & GASES (OXYGEN, AIR & VACUUM)		

**EQUIPMENT / ACCESSORY SHEET NOTES**

- REFER TO INDICATED ELEVATION FOR ADDITIONAL INFORMATION.
- LINE OF ACCESSIBILITY CLEARANCE
- PATIENT LIFT SYSTEM SHOWN MAY NOT MATCH OWNER-PROVIDED SYSTEM. CONTRACTOR SHALL COORDINATE STRUCTURAL REQTS AND SYSTEM LAYOUT WITH COTY.

**EQUIPMENT / ACCESSORY ADDITIONAL NOTES**

- CONTRACTOR SHALL PROVIDE BACKING PLATES SECURED TO WALL FRAMING TO SUPPORT WEIGHT OF ALL WALL-HUNG / BRACED CASEWORK UNITS PER SPECIFICATIONS.
- ALL HEALTHCARE COMPONENT CASEWORK (HCC) UNITS TO BE PROVIDED WITH ALL ASSOCIATED SYSTEM WALL ANCHORAGE HARDWARE AND CLOSURE ELEMENTS.
- REFER TO SHEET AI-401 - ENLARGED RESTROOM PLANS & ELEVATIONS FOR MORE DETAILED PLANS AND ELEVATIONS.
- VERIFY CASEWORK DETAILS WITH ARCHITECT PRIOR TO ORDERING.

ALL NOTES LISTED ABOVE ARE APPLICABLE FOR THE PLANS, ELEVATIONS AND AXONOMETRICS ON THESE SHEETS.

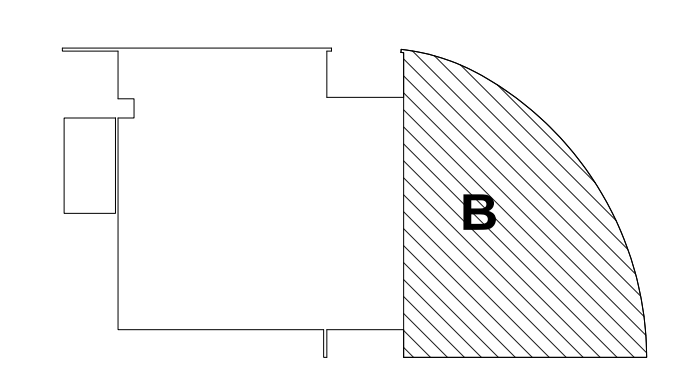

**KEY PLAN**

Scale: As indicated

**CONSULTANTS:**

STRUCTURAL	MEP ENGINEER	CIVIL ENGINEER	LANDSCAPE ARCHITECT
Saitul - Bouquet 155 N. Lake Ave., Suite 600 Pasadena, CA 91101 1626.304.2616 1626.304.2676	Glumac 617 West 7th St., Suite 500 Los Angeles, CA 90017 1213.239.8866 1213.239.8816	Kimley-Horn & Associates 765 The City Drive, Suite 400 Orange, CA 92668 1213.239.8866 1714.939.1030	Lynn Capouya, Inc. 17992 Mitchell South, Suite 110 Irvine, CA 92614 1949.756.0150

**ARCHITECT/ENGINEERS:**

ARCHITECT  
Perkins+Will  
617 West 7th St., Suite 1200  
Los Angeles, CA 90017  
1213.270.8400  
1213.270.8410

**PERKINS  
+ WILL**

Drawing Title LEVEL 02 AREA B EQUIPMENT PLAN
Approved: Project Director Approver

Project Title VETERANS AFFAIRS CANCER CENTER BUILDING	Project Number (PV #711021.000) 605-324
Location LOMA LINDA, CALIFORNIA	Building Number 31
Date AUGUST 22, 2014	Drawing Number AI-112B
Checked Checker	Drawn Author
	Dwg of

Office of  
Construction  
and Facilities  
Management

Department of  
Veterans Affairs

100% CONSTRUCTION DOCUMENT SUBMISSION  
FULLY SPRINKLERED BUILDING