

May 26, 2011 - 11:38am

R:_Projects\VA Kitchen\CA0\ asbestos CrawlSpace.dwg

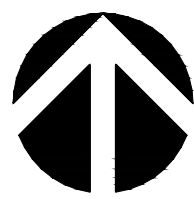

D1 PARTIAL CRAWLSPACE ASBESTOS PLAN
3/32" = 1'-0"

REVISIONS	DATE

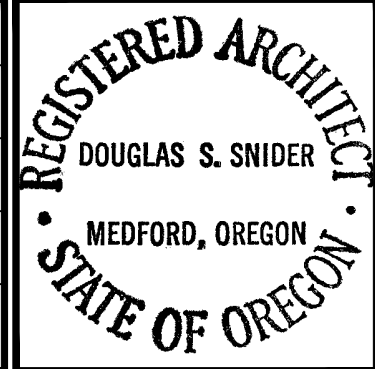

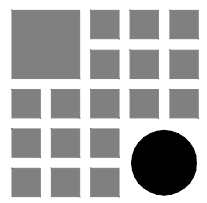

DOUGLAS SNIDER ARCHITECT, P.C.

45 Hawthorne
Medford, Oregon 97504

ARCHITECTURE
PLANNING
INTERIOR DESIGN
FACILITIES MANAGEMENT

MEMBER AMERICAN INSTITUTE OF ARCHITECTS

Web site: www.DouglasSnider.com
E-mail: Doug@DouglasSnider.com

Telephone (541) 772-5203
FAX (541) 772-9438



DEPARTMENT OF VETERANS AFFAIRS
**SOUTHERN OREGON
REHABILITATION CENTER & CLINICS**
8495 CRATER LAKE HIGHWAY
WHITE CITY, OREGON

DRAWING TITLE:

**PARTIAL CRAWLSPACE
ASBESTOS ABATEMENT PLAN**

PROJECT TITLE REPLACE NUTRITION & FOOD SERVICES		
DRAWN BY: DSS	DATE: 1JUN11	DRAWING NO.: ASB1
CHECK BY: RJS	VA PROJECT NO.: 692-338	DWG.1 OF 4

US DEPARTMENT OF
VETERANS AFFAIRS

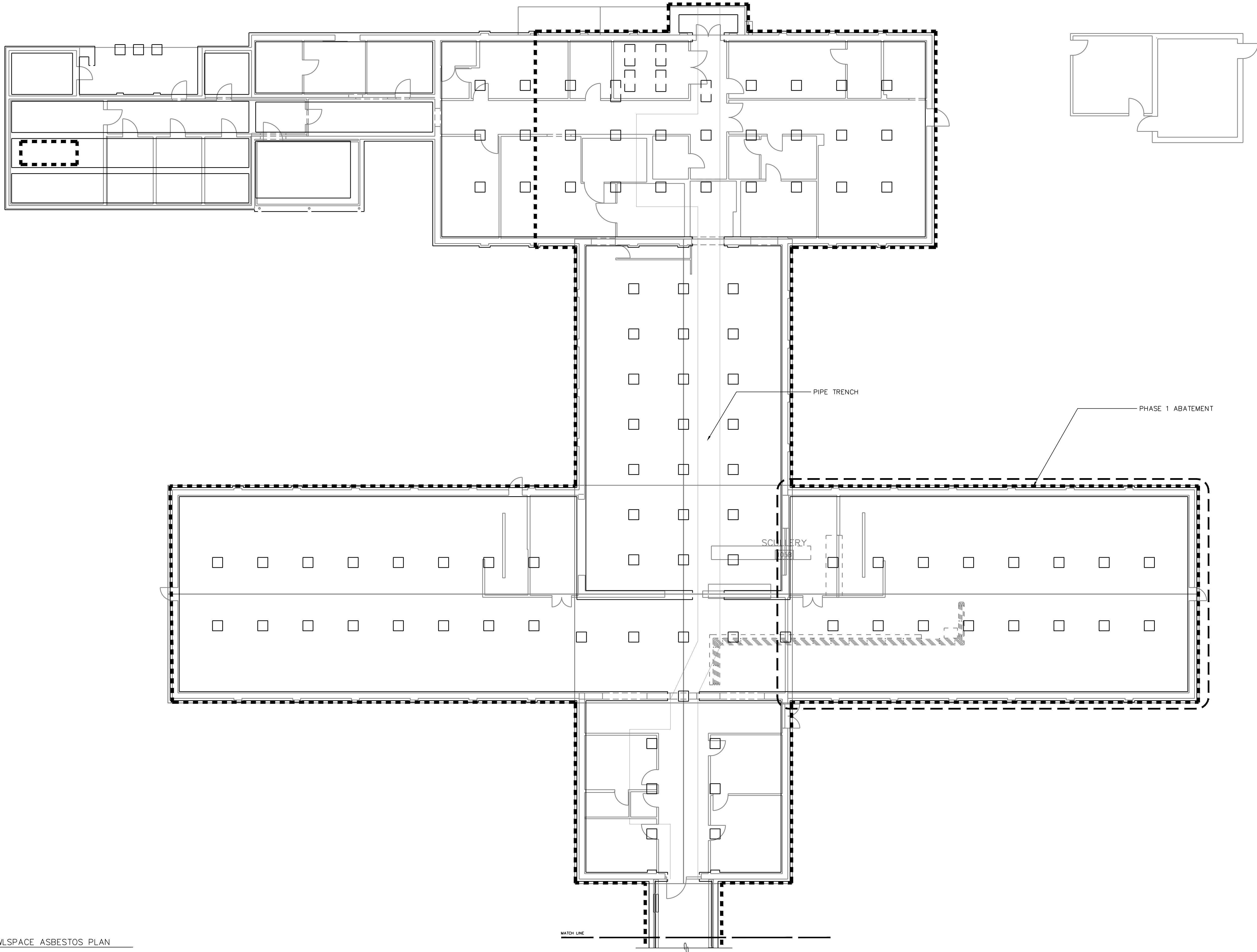

May 26, 2011 - 11:38am

R:_Projects\VA Kitchen\CA0\ asbestos CrawlSpace.dwg

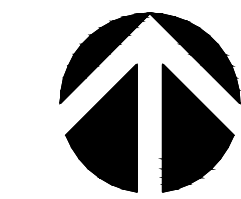

D1 PARTIAL CRAWLSPACE ASBESTOS PLAN
3/32" = 1'-0"

REVISIONS	DATE

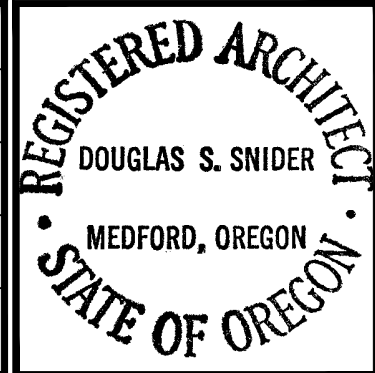

DOUGLAS SNIDER ARCHITECT, P.C.
ARCHITECTURE
PLANNING
INTERIOR DESIGN
FACILITIES MANAGEMENT
MEMBER AMERICAN INSTITUTE OF ARCHITECTS
45 Hawthorne Medford, Oregon 97504
Web site: www.DouglasSnider.com
E-mail: Doug@DouglasSnider.com

DEPARTMENT OF VETERANS AFFAIRS
SOUTHERN OREGON
REHABILITATION CENTER & CLINICS
8495 CRATER LAKE HIGHWAY
WHITE CITY, OREGON

DRAWING TITLE:
PARTIAL CRAWLSPACE
ASBESTOS ABATEMENT PLAN

PROJECT TITLE REPLACE NUTRITION & FOOD SERVICES		
DRAWN BY: DSS	DATE: 1JUN11	DRAWING NO.: ASB2
CHECK BY: RJS	VA PROJECT NO.: 692-338	DWG.2 OF 4

US DEPARTMENT OF
VETERANS AFFAIRS

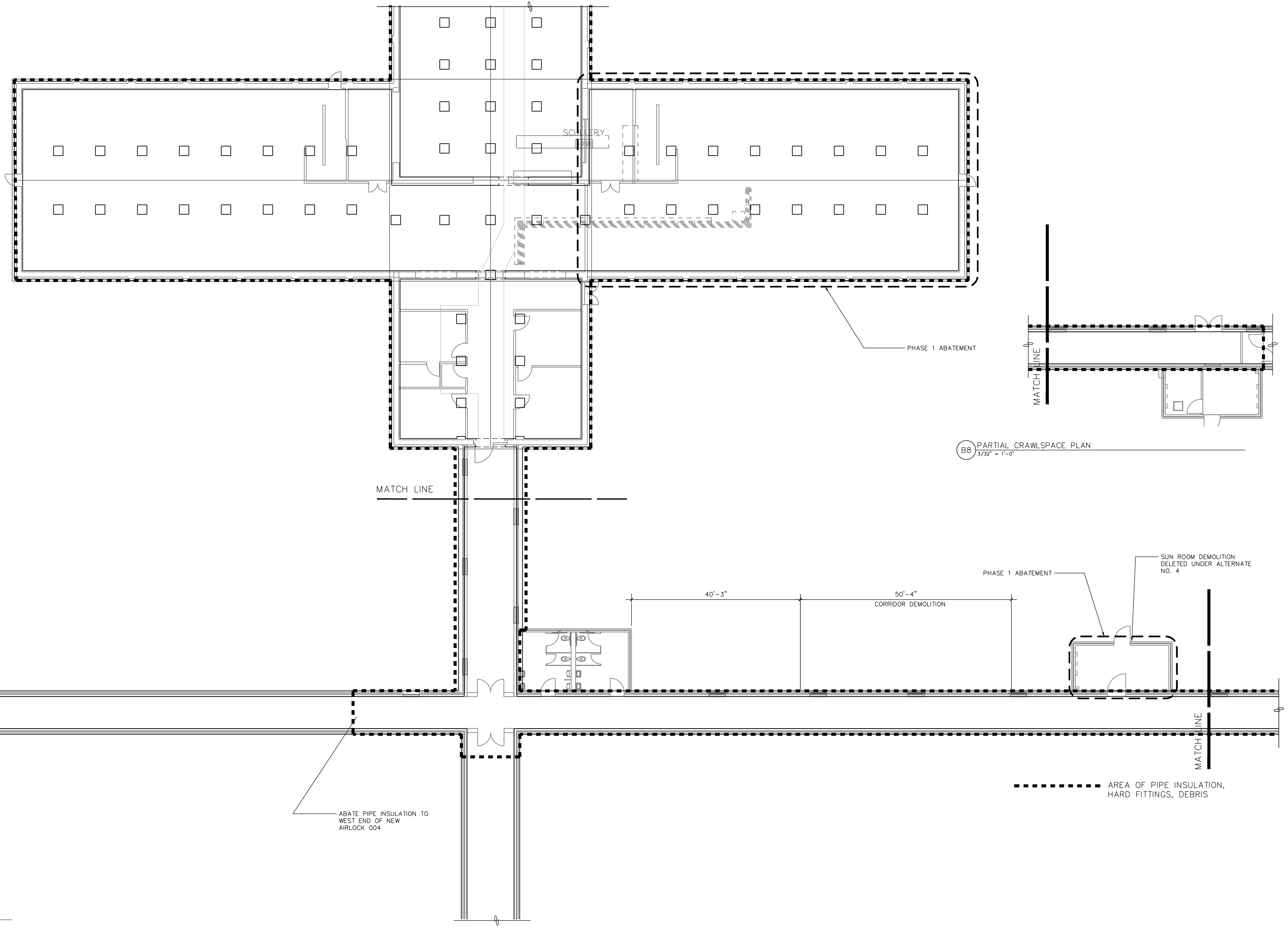

B8 PARTIAL CRAWLSPACE PLAN
3/32" = 1'-0"

R:_Projects\VA Kitchen\CA0\Asbestos First Floor.dwg May 26, 2011 - 11:38am

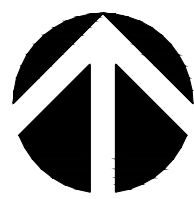

D1 FIRST FLOOR ASBESTOS ABATEMENT PLAN
1" = 10' - 6.6897"

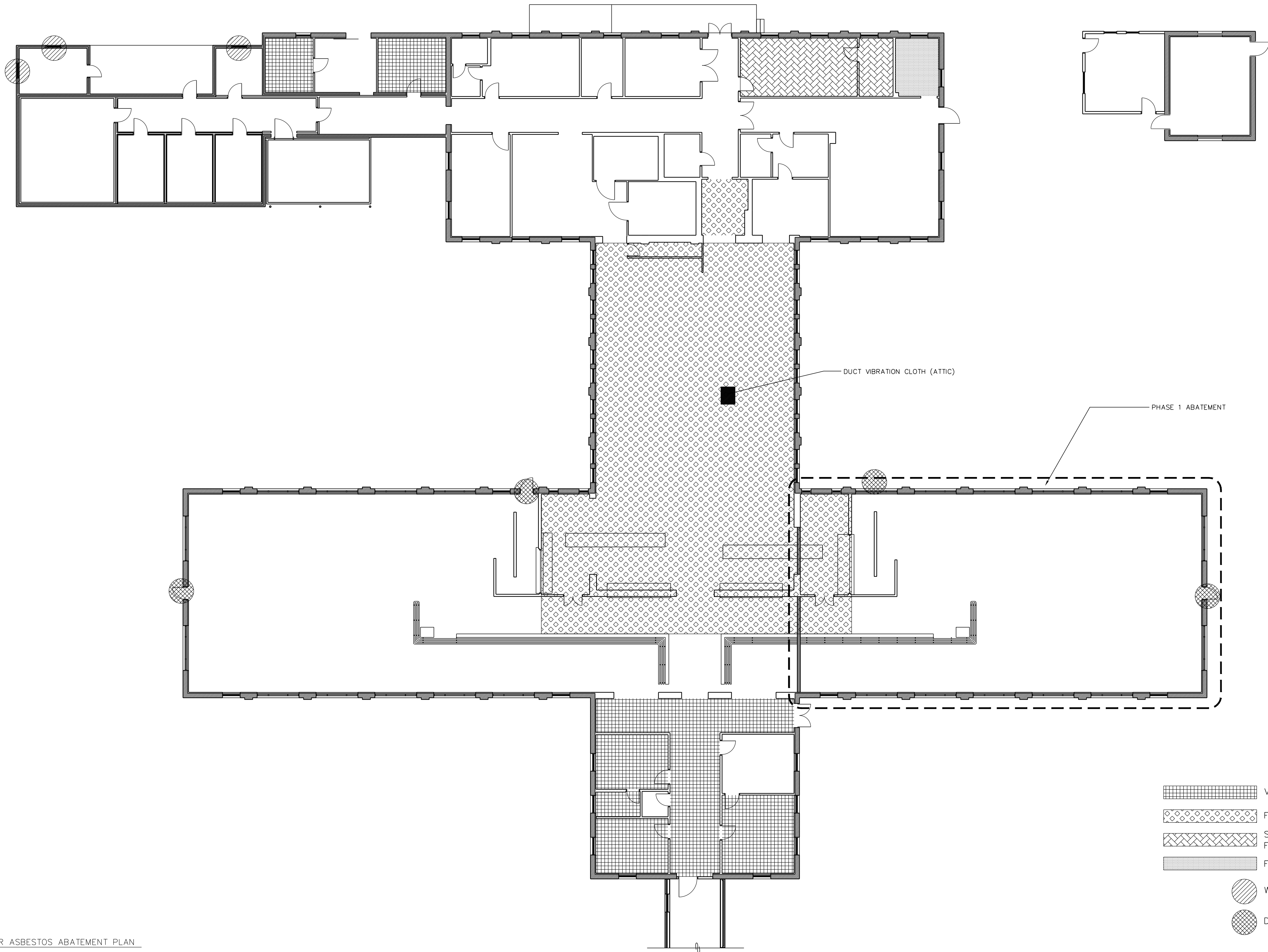

- VINYL FLOORING
- FLOOR TILE (UNDER CERAMIC TILE, CONCRETE BASE)
- SUSPECT FLOORING (3RD/4TH LAYER REMAINING FROM PREVIOUS ABATEMENT)
- FLOOR TILE (3RD LAYER)
- WINDOW CAULKING
- DOOR CAULKING

REVISIONS	DATE

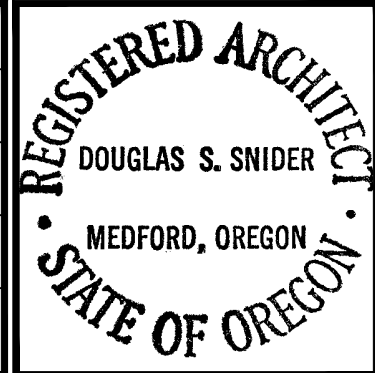

DOUGLAS SNIDER ARCHITECT, P.C.

ARCHITECTURE
PLANNING
INTERIOR DESIGN
FACILITIES MANAGEMENT

MEMBER AMERICAN INSTITUTE OF ARCHITECTS

45 Hawthorne
Medford, Oregon 97504

Web site: www.DouglasSnider.com
E-mail: Doug@DouglasSnider.com

Telephone (541) 772-5203
FAX (541) 772-9438

DEPARTMENT OF VETERANS AFFAIRS

**SOUTHERN OREGON
REHABILITATION CENTER & CLINICS**

8495 CRATER LAKE HIGHWAY
WHITE CITY, OREGON

DRAWING TITLE:

**PARTIAL FIRST FLOOR
ASBESTOS ABATEMENT PLAN**

PROJECT TITLE REPLACE NUTRITION & FOOD SERVICES		
DRAWN BY: DSS	DATE: 1JUN11	DRAWING NO.: ASB3
CHECK BY: RJS	VA PROJECT NO.: 692-338	DWG. 3 OF 4

US DEPARTMENT OF
VETERANS AFFAIRS

R:_Projects\VA Kitchen\CA0\ asbestos First floor.dwg May 26, 2011 11:40am

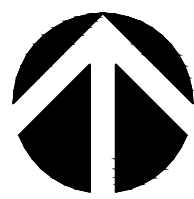

D1 PARTIAL FIRST FLOOR ASBESTOS ABATEMENT PLAN
1" = 10' - 9.3238"

REVISIONS	DATE

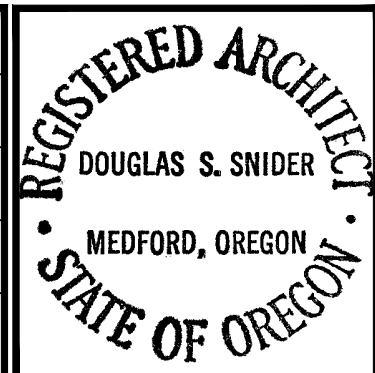

DOUGLAS SNIDER ARCHITECT, P.C.

ARCHITECTURE
PLANNING
INTERIOR DESIGN
FACILITIES MANAGEMENT

MEMBER AMERICAN INSTITUTE OF ARCHITECTS

45 Hawthorne
Medford, Oregon 97504

Web site: www.DouglasSnider.com
E-mail: Doug@DouglasSnider.com

Telephone (541) 772-5203
FAX (541) 772-9438

DEPARTMENT OF VETERANS AFFAIRS

**SOUTHERN OREGON
REHABILITATION CENTER & CLINICS**

8495 CRATER LAKE HIGHWAY
WHITE CITY, OREGON

DRAWING TITLE:

**PARTIAL FIRST FLOOR
ASBESTOS ABATEMENT PLAN**

PROJECT TITLE **REPLACE NUTRITION &
FOOD SERVICES**

DRAWN BY: DSS	DATE: 1JUN11	DRAWING NO.: ASB4
CHECK BY: RJS	VA PROJECT NO.: 692-338	DWG. 4 OF 4

US DEPARTMENT OF
VETERANS AFFAIRS

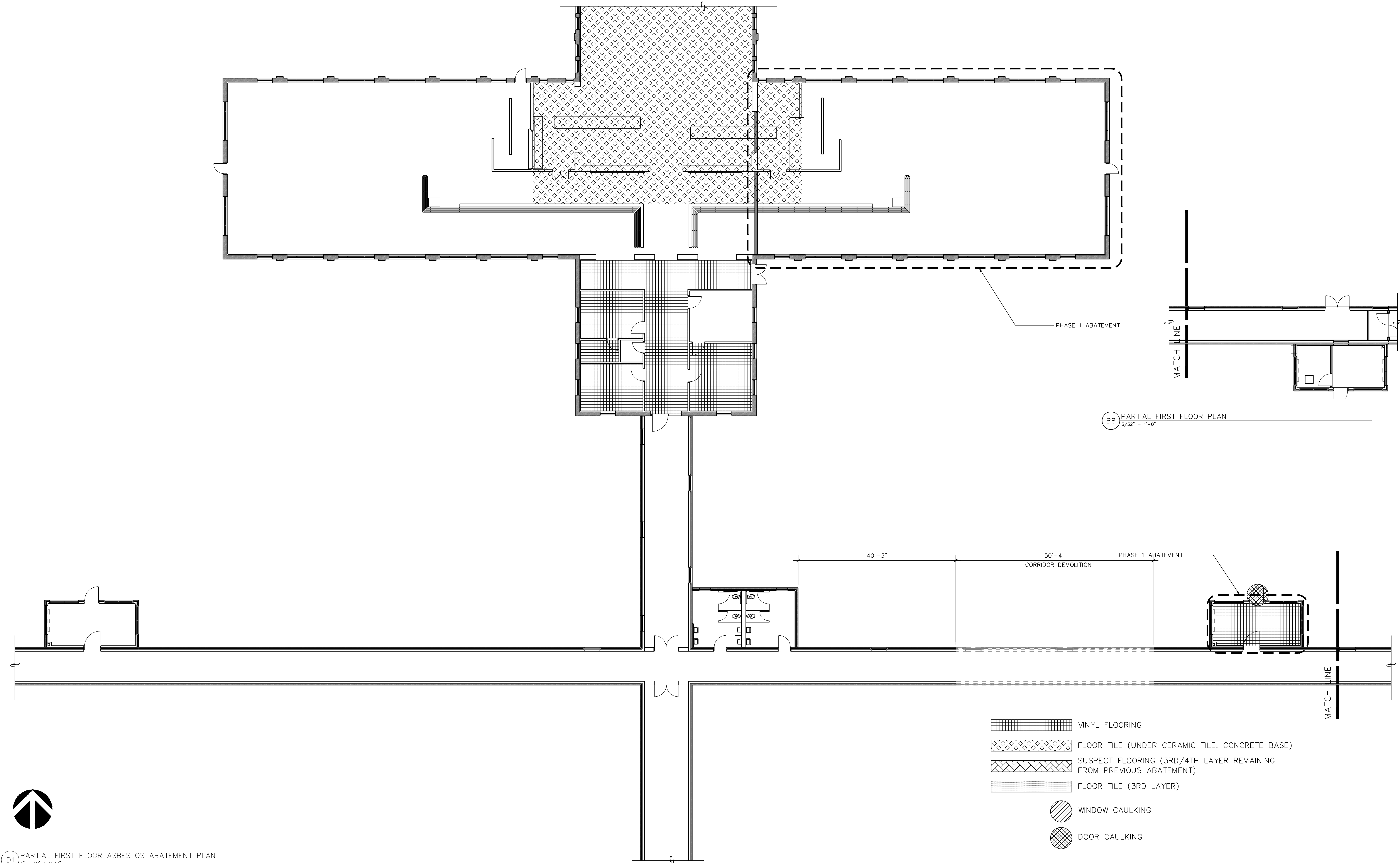

B8 PARTIAL FIRST FLOOR PLAN
3/32" = 1'-0"