

PROJECT TITLE		REPLACE NUTRITION & FOOD SERVICES
DRAWN BY:	DATE:	DRAWING NO.:
JL	01 JUN 2011	12.1
CHECK BY:	VA PROJECT NO.:	
JG	692-338	DWG. 2 OF 5

US DEPARTMENT OF VETERANS AFFAIRS

NOTE: ALL IRRIGATION HEADS INDICATED ON THE PLAN WITH AN "S" ARE TO RECEIVE A STANDARD SPRAY NOZZLE SUCH AS: RANIBED 8 W/PR NOZZLE. THE LANDSCAPE NOZZLE SHALL ADJUST THE FLOW TO SPECIFIED "MP" ROTATOR NOZZLES INDICATED AT THE TIME OF GROUNDCOVER PLANTING INSTALLATION. THE LANDSCAPE GROUNDCOVER PLANTING SHALL ADJUST INSTALLED MP ROTATOR NOZZLES TO PROVIDE COVERAGE TO ALL INSTALLED TREE AND SHRUB PLANTINGS.

[illegible]

318 S. GRAPE STREET
MEDFORD, OR 97501
PH. 541.770.7964
FAX 541.770.5164

REVISIONS	DATE

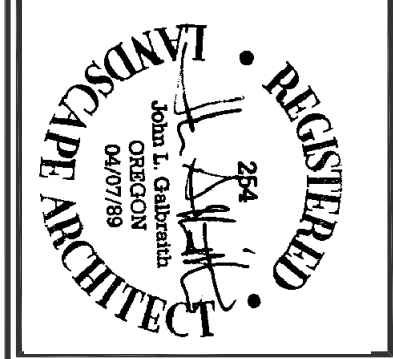

DOUGLAS SNIDER ARCHITECT, P.C.

ARCHITECTURE

PLANNING

INTERIOR DESIGN

FACILITIES MANAGEMENT

MEMBER AMERICAN INSTITUTE OF ARCHITECTS

44 Hawthorne
Medford, Oregon 97504

Web site: www.douglas-snider.com
Telephone: (541) 772-8800
Fax: (541) 772-8488
E-mail: Douglas@snider.com

DEPARTMENT OF VETERANS AFFAIRS

SOUTHERN OREGON
REHABILITATION CENTER & CLINICS

8495 CRATER LAKE HIGHWAY
WHITE CITY, OREGON

DRAWING TITLE:

PLANTING PLAN

galbraith
and associates
LANDSCAPE ARCHITECTURE
& SITE PLANNING

318 S. GRAPE STREET
MEDFORD, OR 97501
PH: 541.770.7964
FAX: 541.770.5164
OREGON LICENSE NO. 284 (C.A., 2880)

PROJECT TITLE
REPLACE NUTRITION &
FOOD SERVICES

DRAWN BY: J.L.
DATE: 01 JUN 2011
CHECK BY: JG
VA PROJECT NO.: 692-338
DRAWING NO.: L3.1
DWG. 3 OF 5

US DEPARTMENT OF
VETERANS AFFAIRS

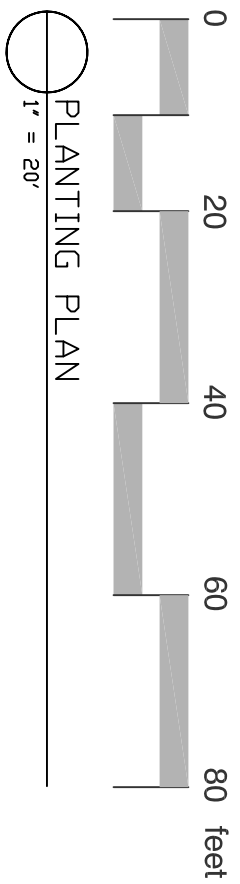
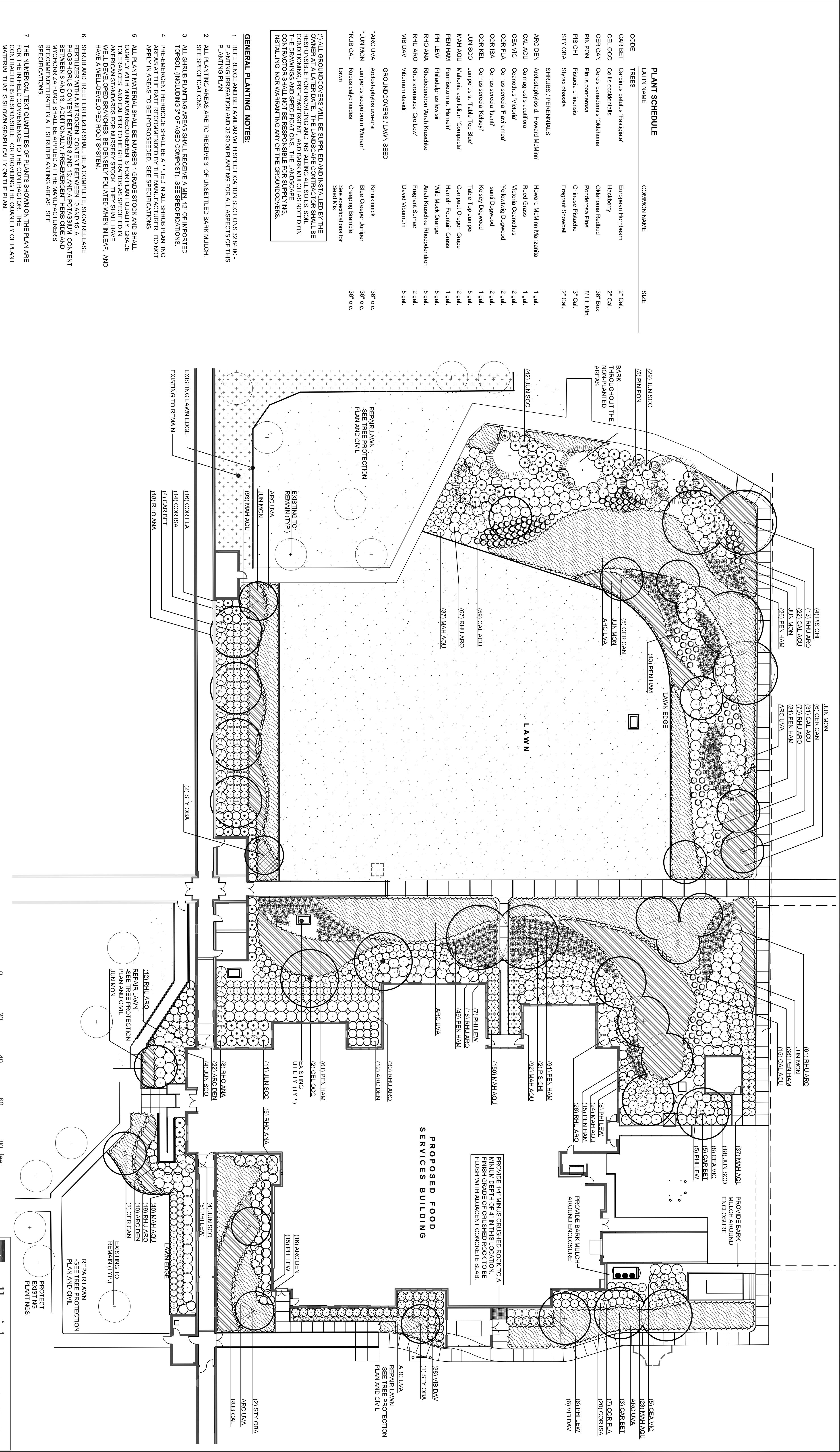

REVISIONS	DATE

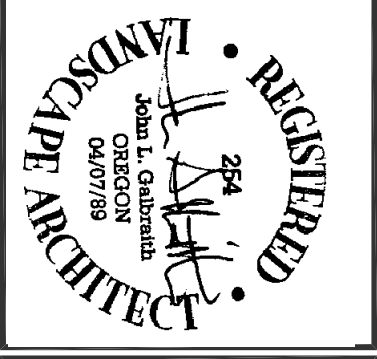

DOUGLAS SNIDER ARCHITECT, P.C.

ARCHITECTURE

PLANNING

INTERIOR DESIGN

FACILITIES MANAGEMENT

MEMBER AMERICAN INSTITUTE OF ARCHITECTS

40 Hawthorne
Medford, Oregon 97504
Web site: www.douglas-snider.com
Telephone (541) 772-8203
Fax (541) 772-8208
E-mail: Douglas@DouglasSnider.com

**DEPARTMENT OF VETERANS AFFAIRS
SOUTHERN OREGON
REHABILITATION CENTER & CLINICS**

8495 CRATER LAKE HIGHWAY
WHITE CITY, OREGON

DRAWING TITLE:

LANDSCAPE CONSTRUCTION DETAILS

galbraith
and associates

318 S. GRAPE STREET
MEDFORD, OR 97501
PH. 541.770.7964
FAX 541.770.5164

THESE DRAWINGS WERE PREPARED BY Douglas Snider, P.E., No. 0407769, Mechanical, State of Oregon

PROJECT TITLE **REPLACE NUTRITION & FOOD SERVICES**

DRAWN BY: JL
CHECK BY: JG

DATE: 01 JUN 2011
VA PROJECT NO.: 692-338

DRAWING NO.: **L4.1**
DWG. 4 OF 5

US DEPARTMENT OF VETERANS AFFAIRS

OREGON LICENSE No. 284 (C.A. 2980)

US DEPARTMENT OF VETERANS AFFAIRS

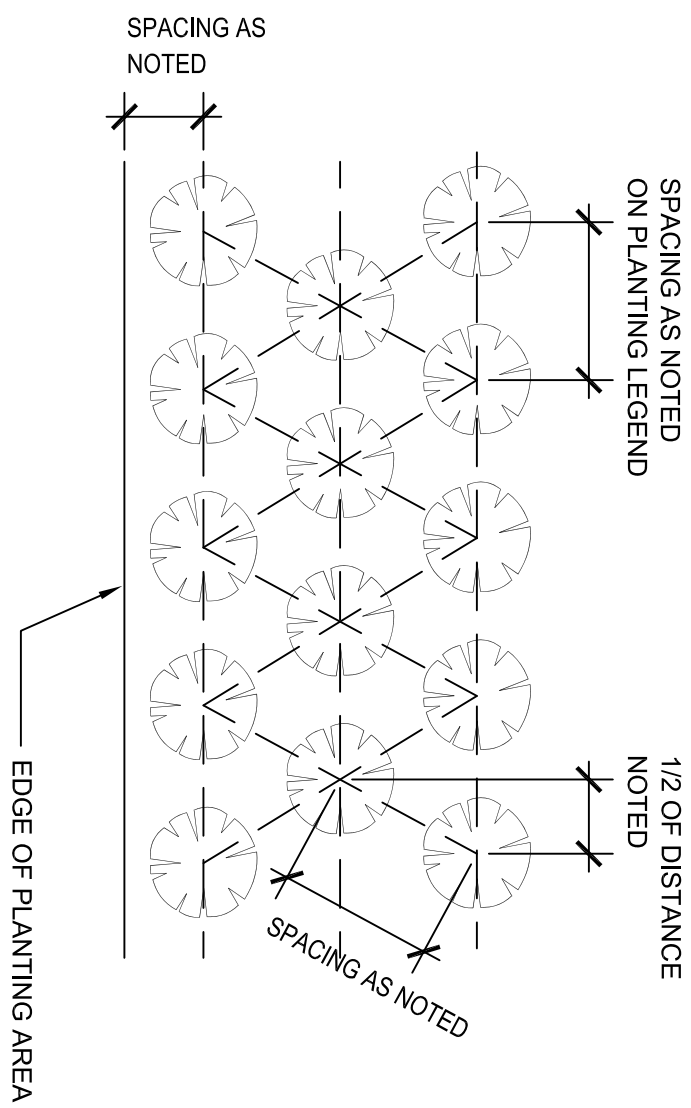

1 SECTION - GROUNDCOVER PLANTING LAYOUT
Scale: N.T.S.

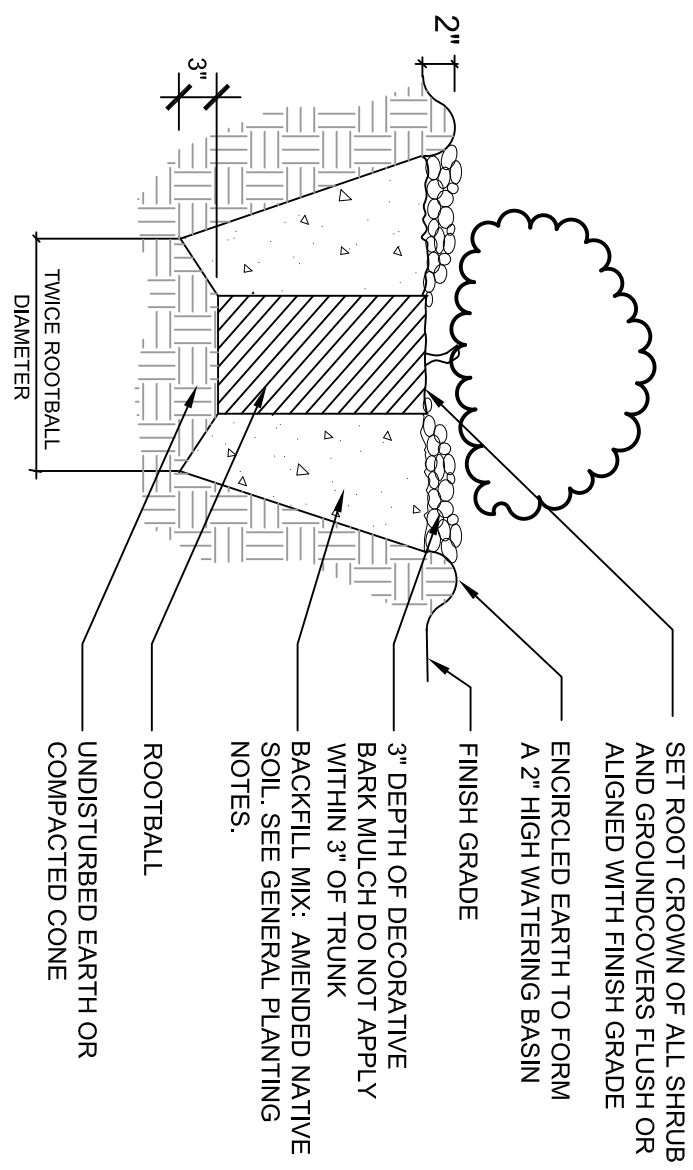

2 SECTION - SHRUB/GROUNDCOVER PLANTING
Scale: N.T.S.

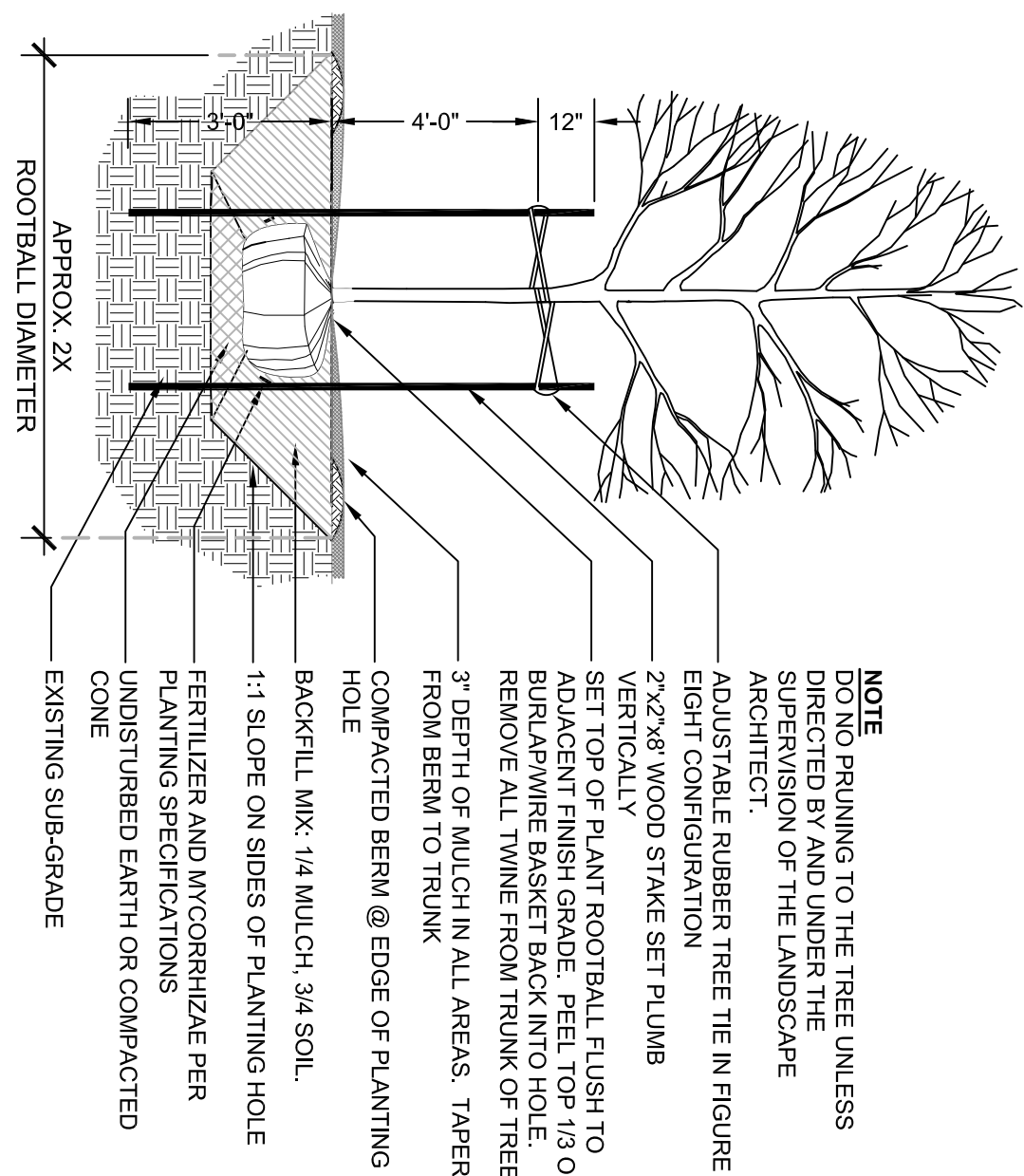

3 SECTION - TREE PLANTING
Scale: 1/2" = 1'-0"

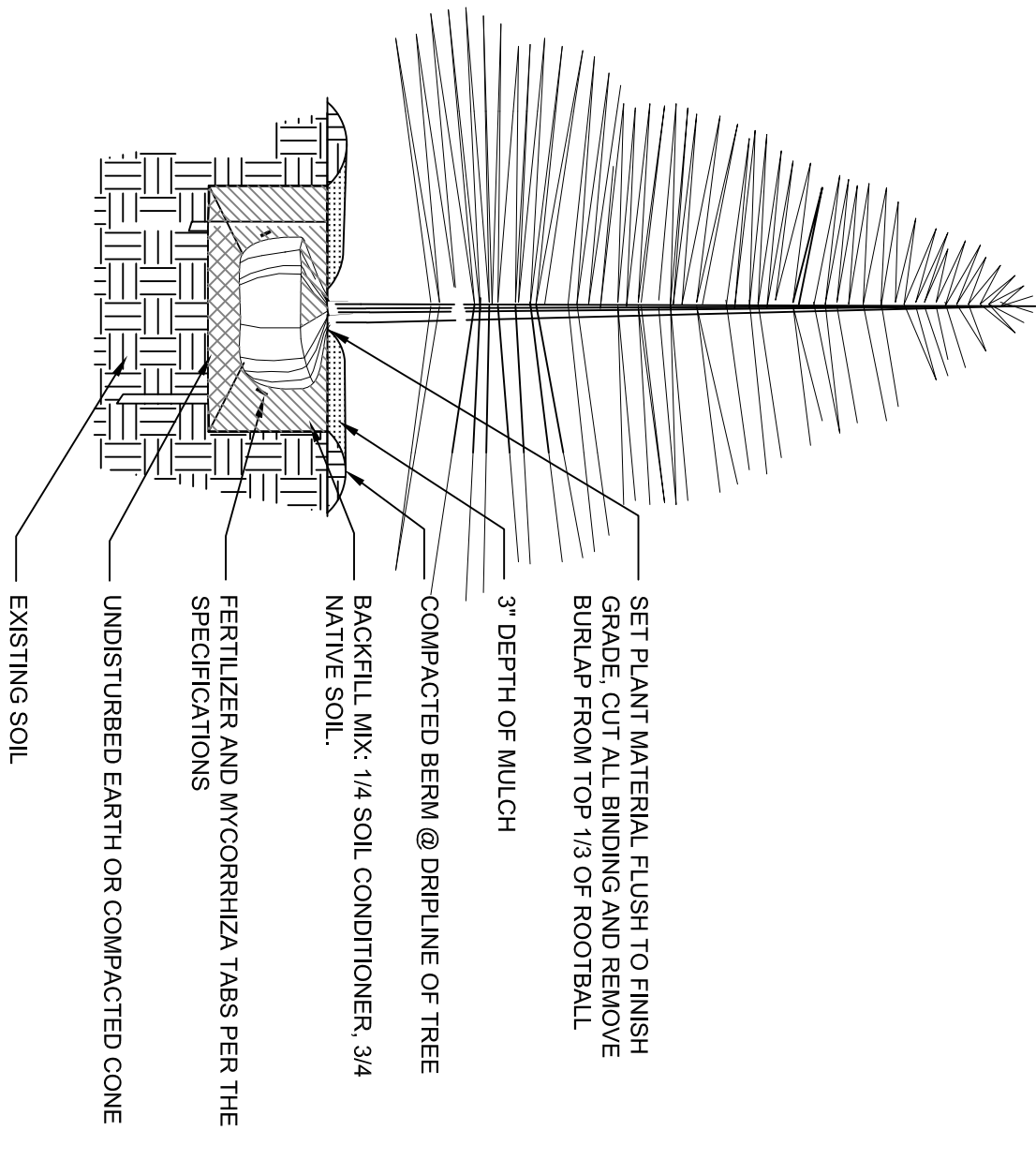

4 SECTION - CONIFEROUS TREE PLANTING
Scale: N.T.S.

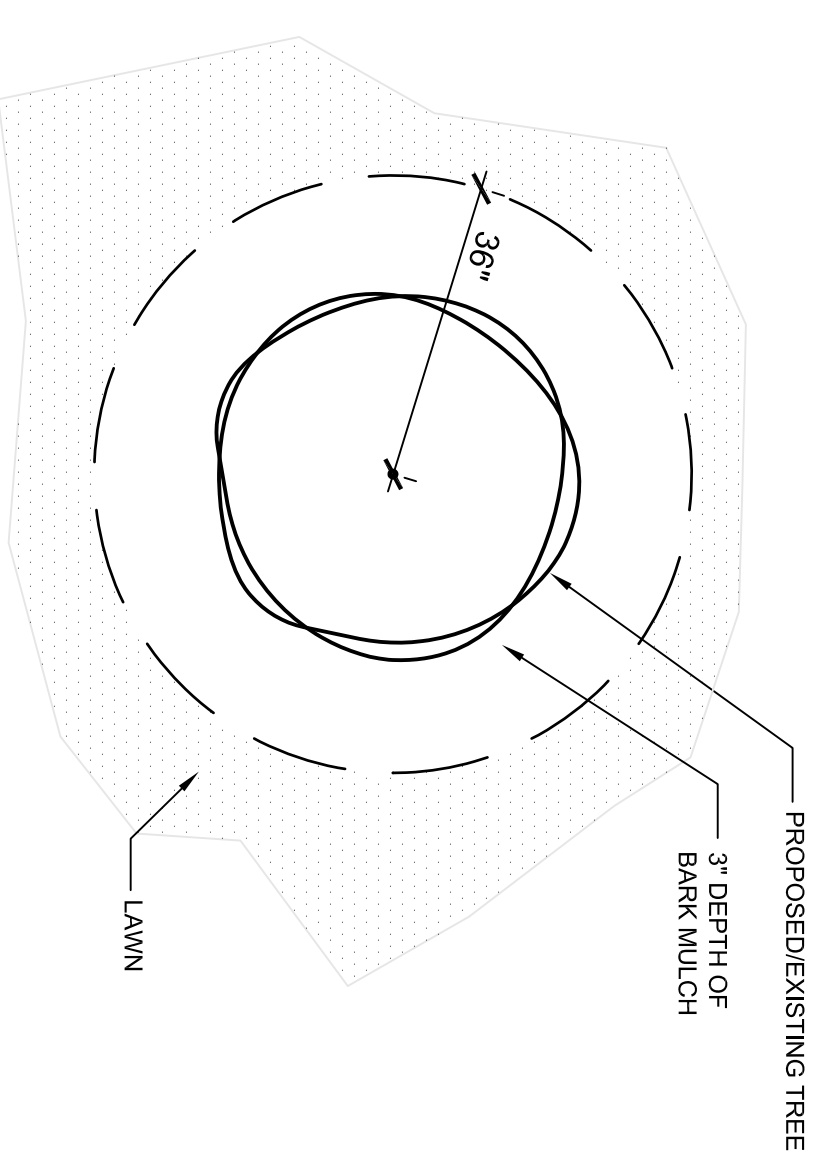

5 PLAN - MULCH RING @ LAWN TREE
Scale: 1" = 1'-0"

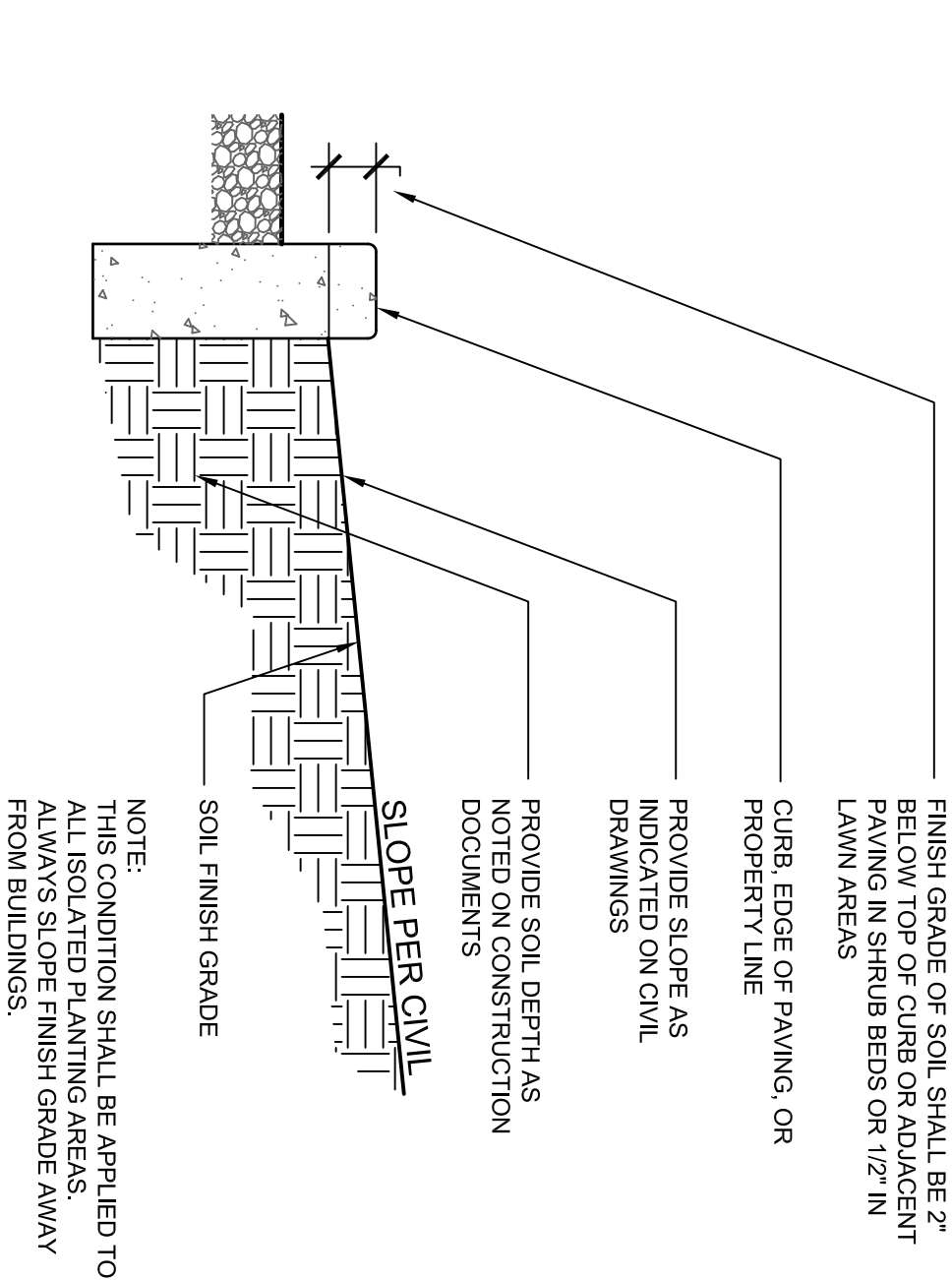

6 SECTION - SOIL PROFILE IN PLANTING AREAS
Scale: 1" = 1'-0"

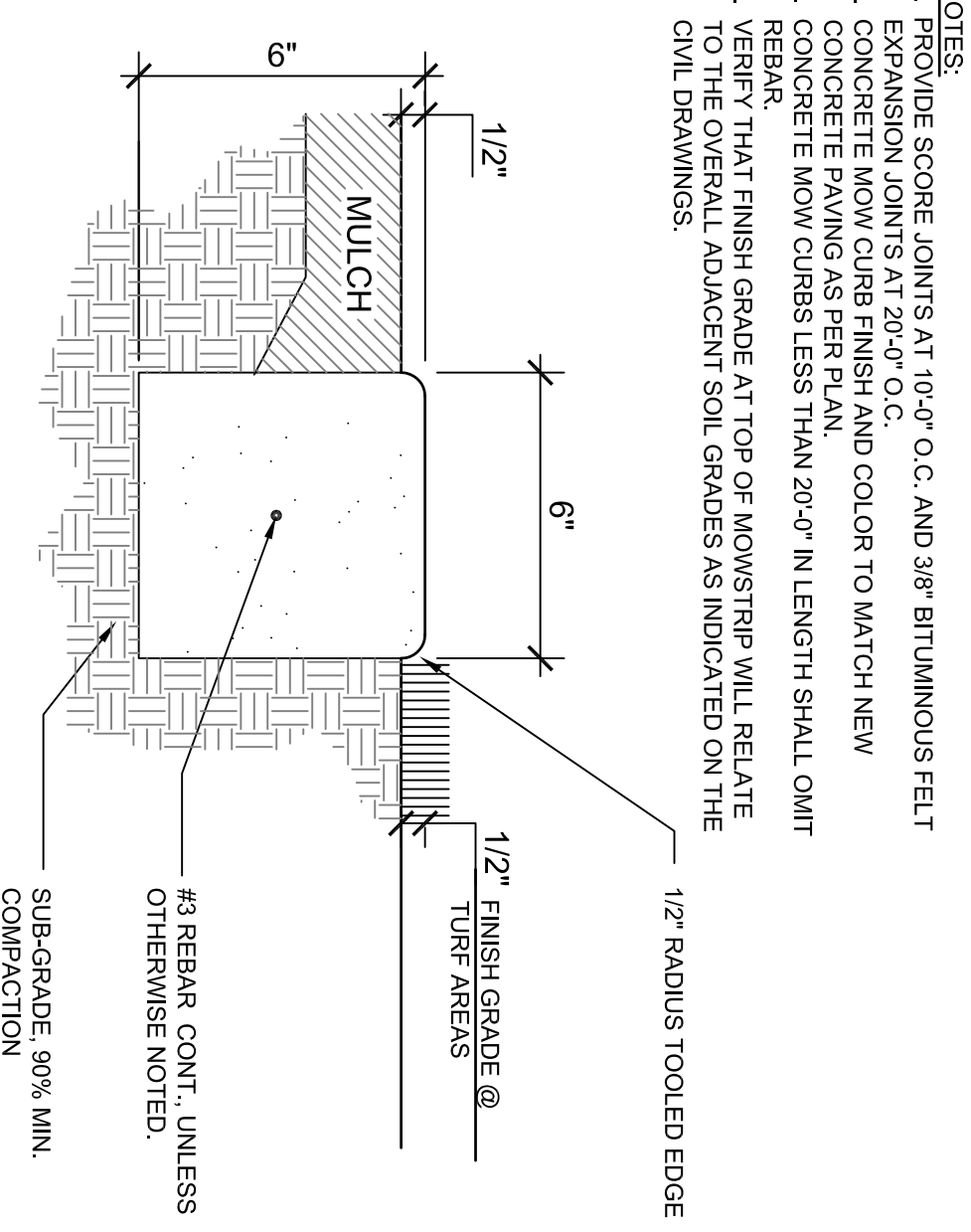

7 SECTION: CONCRETE MOWING STRIP
Scale: N.T.S.

REVISIONS	DATE

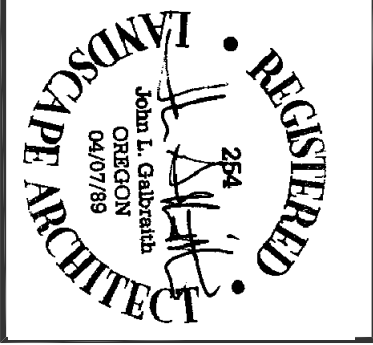

DOUGLAS SNIDER ARCHITECT, P.C.

ARCHITECTURE
PLANNING
INTERIOR DESIGN
FACILITIES MANAGEMENT

MEMBER AMERICAN INSTITUTE OF ARCHITECTS

40 Hawthorne
Medford, Oregon 97504
E-mail: Doug@DouglasSnider.com
Telephone: (541) 772-8203
Fax: (541) 772-8438

**DEPARTMENT OF VETERANS AFFAIRS
SOUTHERN OREGON
REHABILITATION CENTER & CLINICS**

8495 CRATER LAKE HIGHWAY
WHITE CITY, OREGON

DRAWING TITLE:

LANDSCAPE CONSTRUCTION DETAILS

galbraith
and associates
LANDSCAPE ARCHITECTURE
& SITE PLANNING

318 S. GRAPE STREET
MEDFORD, OR 97501
PH: 541.770.7964
FAX: 541.770.5164

OREGON LICENSE NO. 254 (C.A., 2980)

PROJECT TITLE: **REPLACE NUTRITION & FOOD SERVICES**

DRAWN BY: JL
DATE: 01 JUN 2011
CHECK BY: VA PROJECT NO.: 692-338

DRAWING NO.: **L4.2**
DWG. 5 OF 5