

three inches = one foot
one and one-half inch = one foot
one inch = one foot
three-quarters inch = one foot
one-half inch = one foot
three-eighths inch = one foot
one-quarter inch = one foot
one-eighth inch = one foot

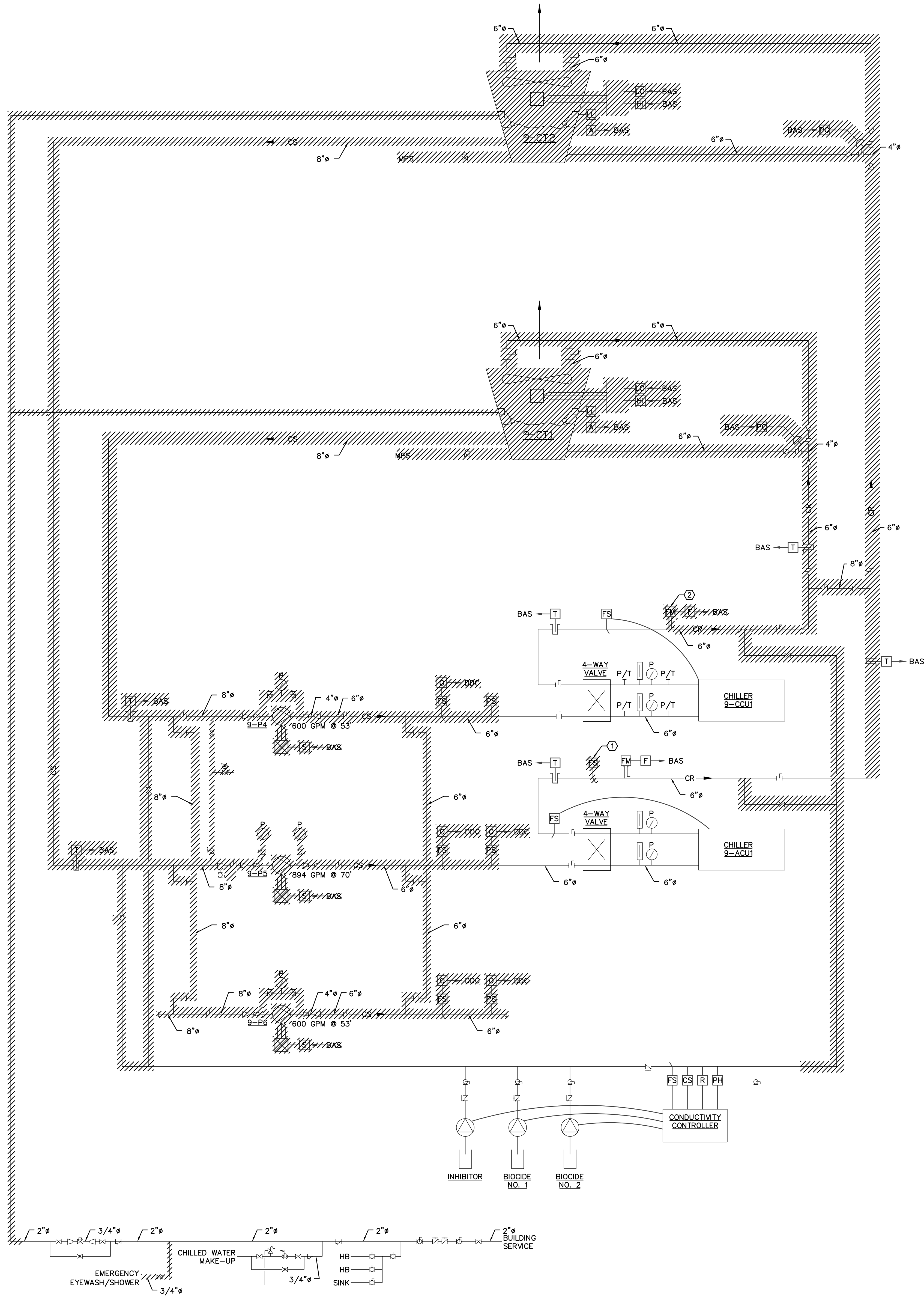

EXISTING CONDENSER WATER SYSTEM CONTROL SCHEMATIC

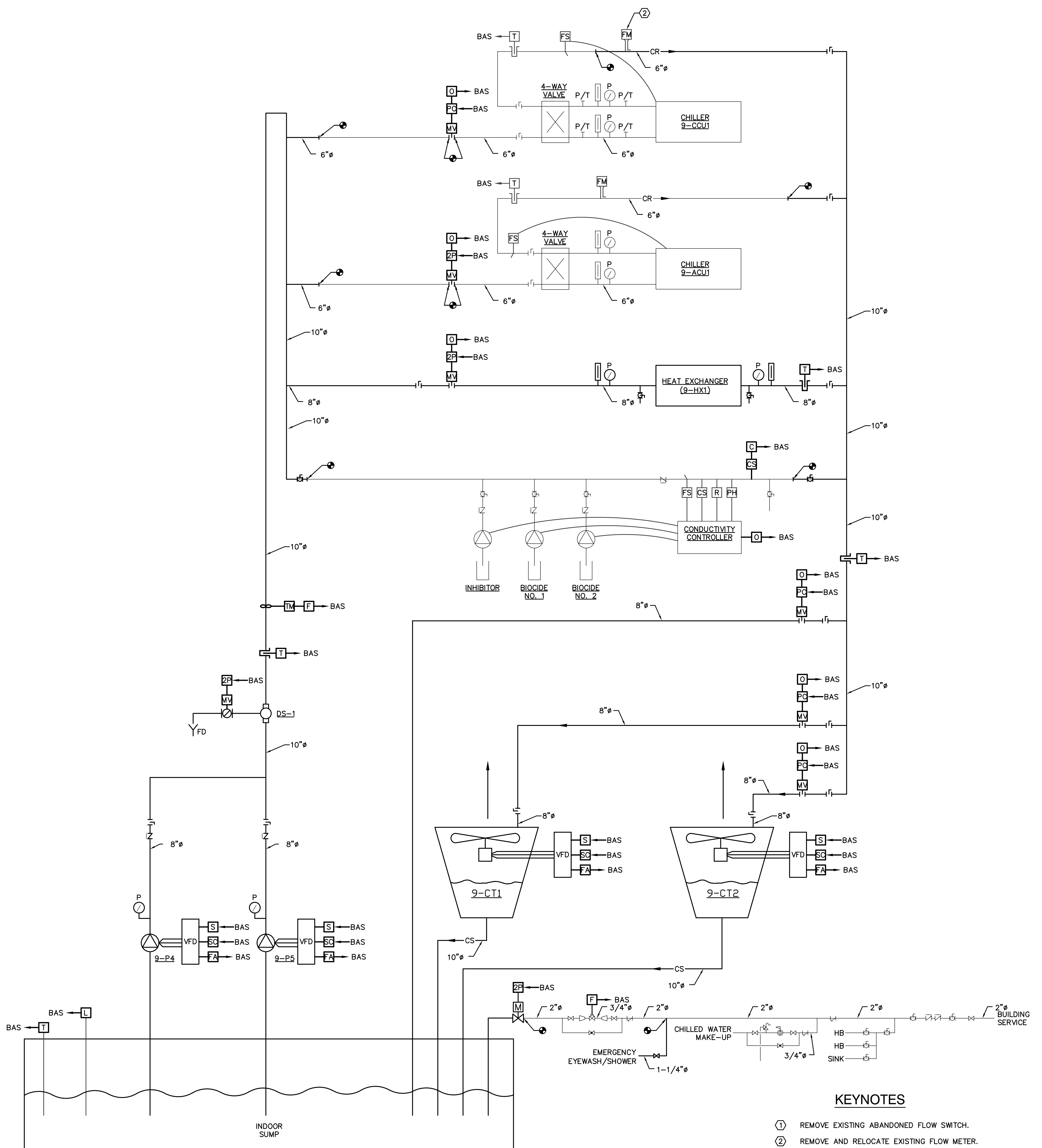

NEW CONDENSER WATER SYSTEM CONTROL SCHEMATIC

KEYNOTES

- REMOVE EXISTING ABANDONED FLOW SWITCH.
 - REMOVE AND RELOCATE EXISTING FLOW METER.
- CONDENSER WATER PUMP AND COOLING TOWER FAN VFD'S SHALL BE INTEGRATED TO THE JOHNSON MATATYSYS CONTROL SYSTEM. I/O POINT SIGNALS SHALL BE COMMUNICATED THRU THE N2 COMMUNICATIONS PORT ON THE VFD TO THE BAS.

GENERAL NOTES

- EXISTING WIRING, CONDUIT, PNEUMATIC TUBING, AND DEVICES THAT WOULD OTHERWISE BE ABANDONED ON THIS PROJECT SHALL BE REMOVE BY THE CONTRACTOR.

CONSTRUCTION DOCUMENTS 95 % SUBMITTAL		08/12/2005 02/07/2005		<div><div>SCHENDT</div><div>ENGINEERING CORPORATION</div><div>CONSULTING ENGINEERS</div><div>* PH. (719) 637-8850 * * FAX (719) 632-0300 *</div><div>sac@scengr.com</div><div>2912 BEACON ST. COLORADO SPRINGS, CO 80907</div></div>		Drawing Title MECHANICAL CONTROL SCHEMATICS		Project Title REPLACE COOLING TOWERS		Project Number 575-05-103		OFFICE OF FACILITIES MANAGEMENT	
Building Number BUILDING NO. 9													
Revisions		Date				Approved: Medical Center Director —		Location 2121 NORTH AVENUE GRAND JUNCTION, CO 81505		Drawing Number H9		Department of Veterans Affairs	
						Approved: Assistant Administrator, Engineering Department		Date 08/05/2005		Checked TBS	Drawn DJS		