

3 SECOND FLOOR, QUENCH VENT ROUTE
1/8" = 1'-0"

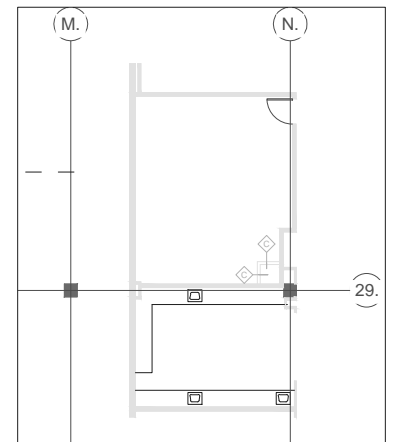

2 FIRST FLOOR, QUENCH VENT ROUTE
1/8" = 1'-0"

NOTES:

PHASING

1. THE CONTRACTOR SHALL SUBMIT A PLAN AND SCHEDULE TO THE CONTRACTING OFFICER IDENTIFYING THE PRECISE LOCATION AND INSTALLATION SEQUENCE OF ALL TEMPORARY CONSTRUCTION. THE CONTRACTOR SHALL NOT BEGIN WORK PRIOR TO RECEIVING AUTHORIZATION FROM CONTRACTING OFFICER.
2. IF WORK IN CERTAIN DEPARTMENTS NEED TO BE SUB-PHASED THE CONTRACTOR MAY NEED TO LOCATE ADDITIONAL TEMPORARY PARTITIONS TO SEPARATE THESE AREAS. FINAL CONFIGURATION AND PLACEMENT CONTINGENT ON FINAL AUTHORIZATION BY CONTRACTING OFFICER. DOORS SHALL BE SOLID CORE, LOCKABLE AND WELL SEALED.
3. EGRESS PATH SHALL BE MAINTAINED DURING SCHEDULED WORK.
4. TEMPORARY PARTITIONS SHALL BE CONSTRUCTED AS REQUIRED TO SEPARATE OCCUPIED AREAS OF THE HOSPITAL FROM CONSTRUCTION WORK AREAS. PROVIDE PARTITION TYPE "F" FROM FLOOR TO CEILING ABOVE.

MRI

1. DOOR AND DOOR FRAMES MAY REQUIRE TEMPORARY REMOVAL TO FACILITATE MAGNET DELIVERY. IN THIS CASE CONTRACTOR WILL BE RESPONSIBLE FOR REINSTALLATION OF THESE ITEMS AND PERFORM THE WORK REQUIRED TO RESTORE THE ORIGINAL CONDITIONS.
2. PROTECT ALL EXISTING FINISHES ALONG DELIVERY ROUTE.

1 OVERALL ORIENTATION AND PHASING PLAN
1/16" = 1'-0"

CONSULTANTS

KHC
303 DETROIT ST, SUITE 201
ANN ARBOR, MI 48104

Stamp

ARCHITECT / ENGINEERS

URS CORPORATION
2020 K ST NW, SUITE 300
WASHINGTON, DC 20006

FINAL CONSTRUCTION DOCUMENTS

Drawing Title
**OVERALL ORIENTATION AND
PHASING PLAN - BASEMENT**

Approved: Project Director

Project Title
**VA Radiation Department
Renovation**

Location
50 Irving St. NW, Washington, DC 20422

Date
02/01/2010

Checked
URS

Drawn
URS

Project Number
148
Number

Drawing Number
A101

**OFFICE OF
CONSTRUCTION
FACILITIES
MANAGEMENT**