

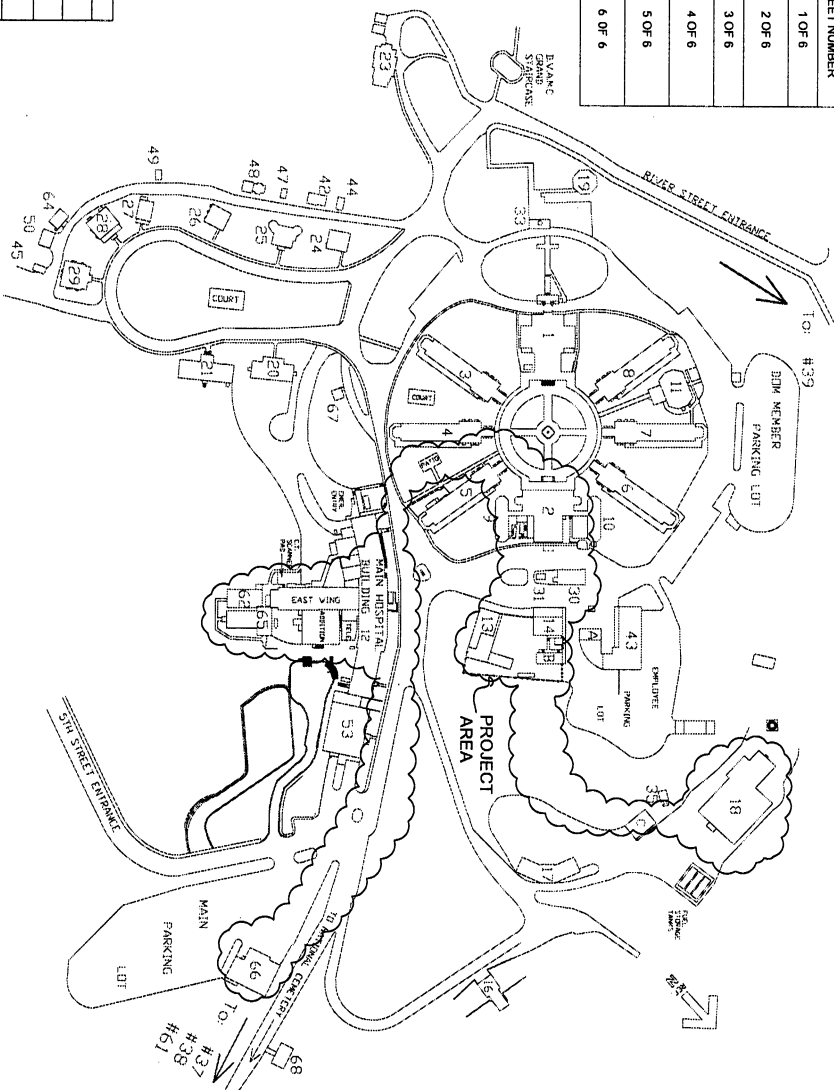

ASSESS/UPGRADE FIBER CABLE COMMUNICATIONS

PROJECT NO.: 568-12-207

DRAWING INDEX		
DRAWING NUMBER	TITLE	SHEET NUMBER
G-1	COVER SHEET	1 OF 6
C-1	PARTIAL SITE FIBER PLAN	2 OF 6
E-1	HOSPITAL BASEMENT LEVEL FIBER PLAN	3 OF 6
E-2	HOSPITAL GROUND, FIRST, SECOND, & THIRD LEVEL FIBER PLANS	4 OF 6
E-3	ARCADÉ BLDG. #1, & BLDG. B FIBER PLANS	5 OF 6
E-4	BLDG. #18 & #66 & #13 FIBER PLANS	6 OF 6

[illegible]



GENERAL CONTRACTOR SHALL BE RESPONSIBLE FOR GENERAL REGULATION INCLUDING EXCAVATION OF WALL FOOTINGS, STOPS & BRACKETS TO BE INSTALLED IN CONCRETE WALLS AND FOUNDATIONS. THE GENERAL CONTRACTOR SHALL BE RESPONSIBLE FOR THE PROTECTION OF ALL EXISTING UTILITIES AND STRUCTURES. THE GENERAL CONTRACTOR SHALL BE RESPONSIBLE FOR THE PROTECTION OF ALL EXISTING UTILITIES AND STRUCTURES. THE GENERAL CONTRACTOR SHALL BE RESPONSIBLE FOR THE PROTECTION OF ALL EXISTING UTILITIES AND STRUCTURES.

HOSPITAL B FIBER PLANN	Drawing Scale $1/8" = 1'-0"$
	Profr Scale $12" = 1'-0"$
Approved: Service Director	Approved: Division Chief

Location	BRAC'S V.A. MEDICAL CENTER 500 NORTH FIFTH STREET HOT SPRINGS, SD 57447
Date	3-19-2012
Checked	JH
Drawn	

568-12-207
Building Number
#12
DRAWING NO.
E-1

**Office of
Facilities
Management**

NUMBERED CONSTRUCTION NOTES

- [illegible]

GENERAL CONSTRUCTION NOTES:

1. CONSTITUTIONAL DUE PROCESS RIGHTS ARE VIOLATED BY THE STATE'S ENFORCEMENT OF A MANDATORY VOTING LAW THAT REQUIRES VOTERS TO VOTE IN PERSON AT A POLLING PLACE ON ELECTION DAY.
2. CONSTITUTIONAL DUE PROCESS RIGHTS ARE VIOLATED BY THE STATE'S ENFORCEMENT OF A MANDATORY VOTING LAW THAT REQUIRES VOTERS TO VOTE IN PERSON AT A POLLING PLACE ON ELECTION DAY.
3. CONSTITUTIONAL DUE PROCESS RIGHTS ARE VIOLATED BY THE STATE'S ENFORCEMENT OF A MANDATORY VOTING LAW THAT REQUIRES VOTERS TO VOTE IN PERSON AT A POLLING PLACE ON ELECTION DAY.
4. CONSTITUTIONAL DUE PROCESS RIGHTS ARE VIOLATED BY THE STATE'S ENFORCEMENT OF A MANDATORY VOTING LAW THAT REQUIRES VOTERS TO VOTE IN PERSON AT A POLLING PLACE ON ELECTION DAY.
5. CONSTITUTIONAL DUE PROCESS RIGHTS ARE VIOLATED BY THE STATE'S ENFORCEMENT OF A MANDATORY VOTING LAW THAT REQUIRES VOTERS TO VOTE IN PERSON AT A POLLING PLACE ON ELECTION DAY.
6. CONSTITUTIONAL DUE PROCESS RIGHTS ARE VIOLATED BY THE STATE'S ENFORCEMENT OF A MANDATORY VOTING LAW THAT REQUIRES VOTERS TO VOTE IN PERSON AT A POLLING PLACE ON ELECTION DAY.
7. CONSTITUTIONAL DUE PROCESS RIGHTS ARE VIOLATED BY THE STATE'S ENFORCEMENT OF A MANDATORY VOTING LAW THAT REQUIRES VOTERS TO VOTE IN PERSON AT A POLLING PLACE ON ELECTION DAY.
8. CONSTITUTIONAL DUE PROCESS RIGHTS ARE VIOLATED BY THE STATE'S ENFORCEMENT OF A MANDATORY VOTING LAW THAT REQUIRES VOTERS TO VOTE IN PERSON AT A POLLING PLACE ON ELECTION DAY.
9. CONSTITUTIONAL DUE PROCESS RIGHTS ARE VIOLATED BY THE STATE'S ENFORCEMENT OF A MANDATORY VOTING LAW THAT REQUIRES VOTERS TO VOTE IN PERSON AT A POLLING PLACE ON ELECTION DAY.
10. CONSTITUTIONAL DUE PROCESS RIGHTS ARE VIOLATED BY THE STATE'S ENFORCEMENT OF A MANDATORY VOTING LAW THAT REQUIRES VOTERS TO VOTE IN PERSON AT A POLLING PLACE ON ELECTION DAY.

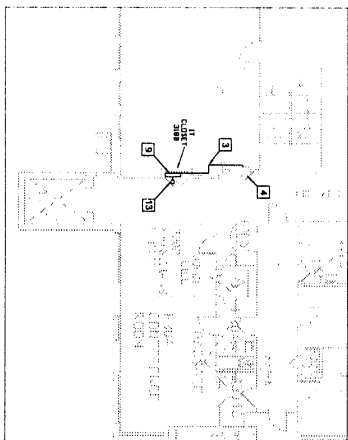
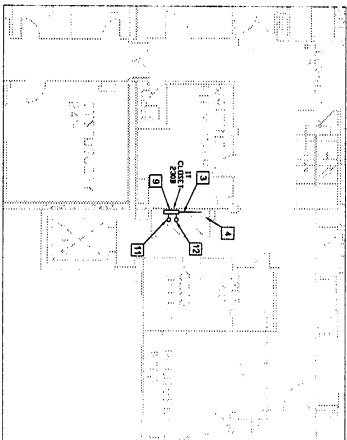
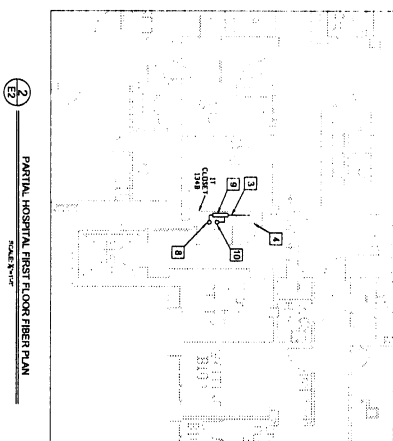
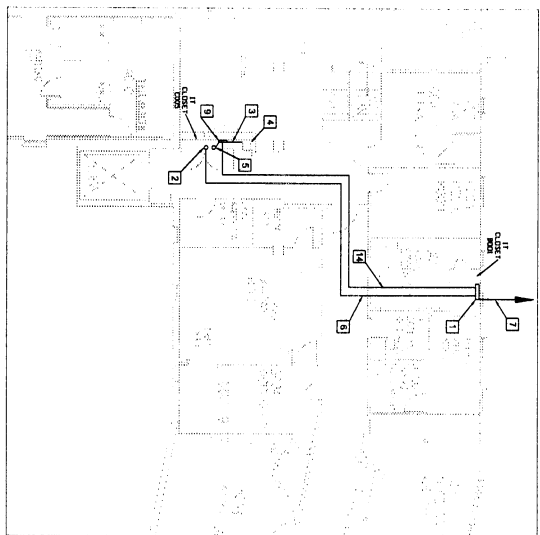

- NUMBERED CONSTRUCTION NOTES:**

 1. APPROVED BY: [REDACTED] DATE: 01/04/2017
 2. ONE (1) UNIT 1101A OF 18 APARTMENTS, UNITS 1101A1 TO 1101A2, LOCATED AT 1101A, 1101A1 AND 1101A2, 1101A3, 1101A4, 1101A5, 1101A6, 1101A7, 1101A8, 1101A9, 1101A10, 1101A11, 1101A12, 1101A13, 1101A14, 1101A15, 1101A16, 1101A17, 1101A18, 1101A19, 1101A20, 1101A21, 1101A22, 1101A23, 1101A24, 1101A25, 1101A26, 1101A27, 1101A28, 1101A29, 1101A30, 1101A31, 1101A32, 1101A33, 1101A34, 1101A35, 1101A36, 1101A37, 1101A38, 1101A39, 1101A40, 1101A41, 1101A42, 1101A43, 1101A44, 1101A45, 1101A46, 1101A47, 1101A48, 1101A49, 1101A50, 1101A51, 1101A52, 1101A53, 1101A54, 1101A55, 1101A56, 1101A57, 1101A58, 1101A59, 1101A60, 1101A61, 1101A62, 1101A63, 1101A64, 1101A65, 1101A66, 1101A67, 1101A68, 1101A69, 1101A70, 1101A71, 1101A72, 1101A73, 1101A74, 1101A75, 1101A76, 1101A77, 1101A78, 1101A79, 1101A80, 1101A81, 1101A82, 1101A83, 1101A84, 1101A85, 1101A86, 1101A87, 1101A88, 1101A89, 1101A90, 1101A91, 1101A92, 1101A93, 1101A94, 1101A95, 1101A96, 1101A97, 1101A98, 1101A99, 1101A100, 1101A101, 1101A102, 1101A103, 1101A104, 1101A105, 1101A106, 1101A107, 1101A108, 1101A109, 1101A110, 1101A111, 1101A112, 1101A113, 1101A114, 1101A115, 1101A116, 1101A117, 1101A118, 1101A119, 1101A120, 1101A121, 1101A122, 1101A123, 1101A124, 1101A125, 1101A126, 1101A127, 1101A128, 1101A129, 1101A130, 1101A131, 1101A132, 1101A133, 1101A134, 1101A135, 1101A136, 1101A137, 1101A138, 1101A139, 1101A140, 1101A141, 1101A142, 1101A143, 1101A144, 1101A145, 1101A146, 1101A147, 1101A148, 1101A149, 1101A150, 1101A151, 1101A152, 1101A153, 1101A154, 1101A155, 1101A156, 1101A157, 1101A158, 1101A159, 1101A160, 1101A161, 1101A162, 1101A163, 1101A164, 1101A165, 1101A166, 1101A167, 1101A168, 1101A169, 1101A170, 1101A171, 1101A172, 1101A173, 1101A174, 1101A175, 1101A176, 1101A177, 1101A178, 1101A179, 1101A180, 1101A181, 1101A182, 1101A183, 1101A184, 1101A185, 1101A186, 1101A187, 1101A188, 1101A189, 1101A190, 1101A191, 1101A192, 1101A193, 1101A194, 1101A195, 1101A196, 1101A197, 1101A198, 1101A199, 1101A200, 1101A201, 1101A202, 1101A203, 1101A204, 1101A205, 1101A206, 1101A207, 1101A208, 1101A209, 1101A210, 1101A211, 1101A212, 1101A213, 1101A214, 1101A215, 1101A216, 1101A217, 1101A218, 1101A219, 1101A220, 1101A221, 1101A222, 1101A223, 1101A224, 1101A225, 1101A226, 1101A227, 1101A228, 1101A229, 1101A230, 1101A231, 1101A232, 1101A233, 1101A234, 1101A235, 1101A236, 1101A237, 1101A238, 1101A239, 1101A240, 1101A241, 1101A242, 1101A243, 1101A244, 1101A245, 1101A246, 1101A247, 1101A248, 1101A249, 1101A250, 1101A251, 1101A252, 1101A253, 1101A254, 1101A255, 1101A256, 1101A257, 1101A258, 1101A259, 1101A260, 1101A261, 1101A262, 1101A263, 1101A264, 1101A265, 1101A266, 1101A267, 1101A268, 1101A269, 1101A270, 1101A271, 1101A272, 1101A273, 1101A274, 1101A275, 1101A276, 1101A277, 1101A278, 1101A279, 1101A280, 1101A281, 1101A282, 1101A283, 1101A284, 1101A285, 1101A286, 1101A287, 1101A288, 1101A289, 1101A290, 1101A291, 1101A292, 1101A293, 1101A294, 1101A295, 1101A296, 1101A297, 1101A298, 1101A299, 1101A300, 1101A301, 1101A302, 1101A303, 1101A304, 1101A305, 1101A306, 1101A307, 1101A308, 1101A309, 1101A310, 1101A311, 1101A312, 1101A313, 1101A314, 1101A315, 1101A316, 1101A317, 1101A318, 1101A319, 1101A320, 1101A321, 1101A322, 1101A323, 1101A324, 1101A325, 1101A326, 1101A327, 1101A328, 1101A329, 1101A330, 1101A331, 1101A332, 1101A333, 1101A334, 1101A335, 1101A336, 1101A337, 1101A338, 1101A339, 1101A340, 1101A341, 1101A342, 1101A343, 1101A344, 1101A345, 1101A346, 1101A347, 1101A348, 1101A349, 1101A350, 1101A351, 1101A352, 1101A353, 1101A354, 1101A355, 1101A356, 1101A357, 1101A358, 1101A359, 1101A360, 1101A361, 1101A362, 1101A363, 1101A364, 1101A365, 1101A366, 1101A367, 1101A368, 1101A369, 1101A370, 1101A371, 1101A372, 1101A373, 1101A374, 1101A375, 1101A376, 1101A377, 1101A378, 1101A379, 1101A380, 1101A381, 1101A382, 1101A383, 1101A384, 1101A385, 1101A386, 1101A387, 1101A388, 1101A389, 1101A390, 1101A391, 1101A392, 1101A393, 1101A394, 1101A395, 1101A396, 1101A397, 1101A398, 1101A399, 1101A400, 1101A401, 1101A402, 1101A403, 1101A404, 1101A405, 1101A406, 1101A4

GENERAL
NOTES:

[illegible]

Drawing: 1114
HOSPITAL GROUND, 1st,
3rd LEVEL FIBER PLANS

Project Title
ASSESS/UPGRADE
FIBER CABLES

Project No.	568-12-207
Building Number	812

**Office of
Facilities**

PLAN NORTH

Drawing Scale	$1/8" = 1'-0"$
Plot Scale	$12" = 1'-0"$

Approved: Division Chief

Location	BRIMCS V.A. METER 500 NORTH FIRST HOT SPRINGS, AR
Date	3-19-2012

DRAWING NO.
E-2

Management

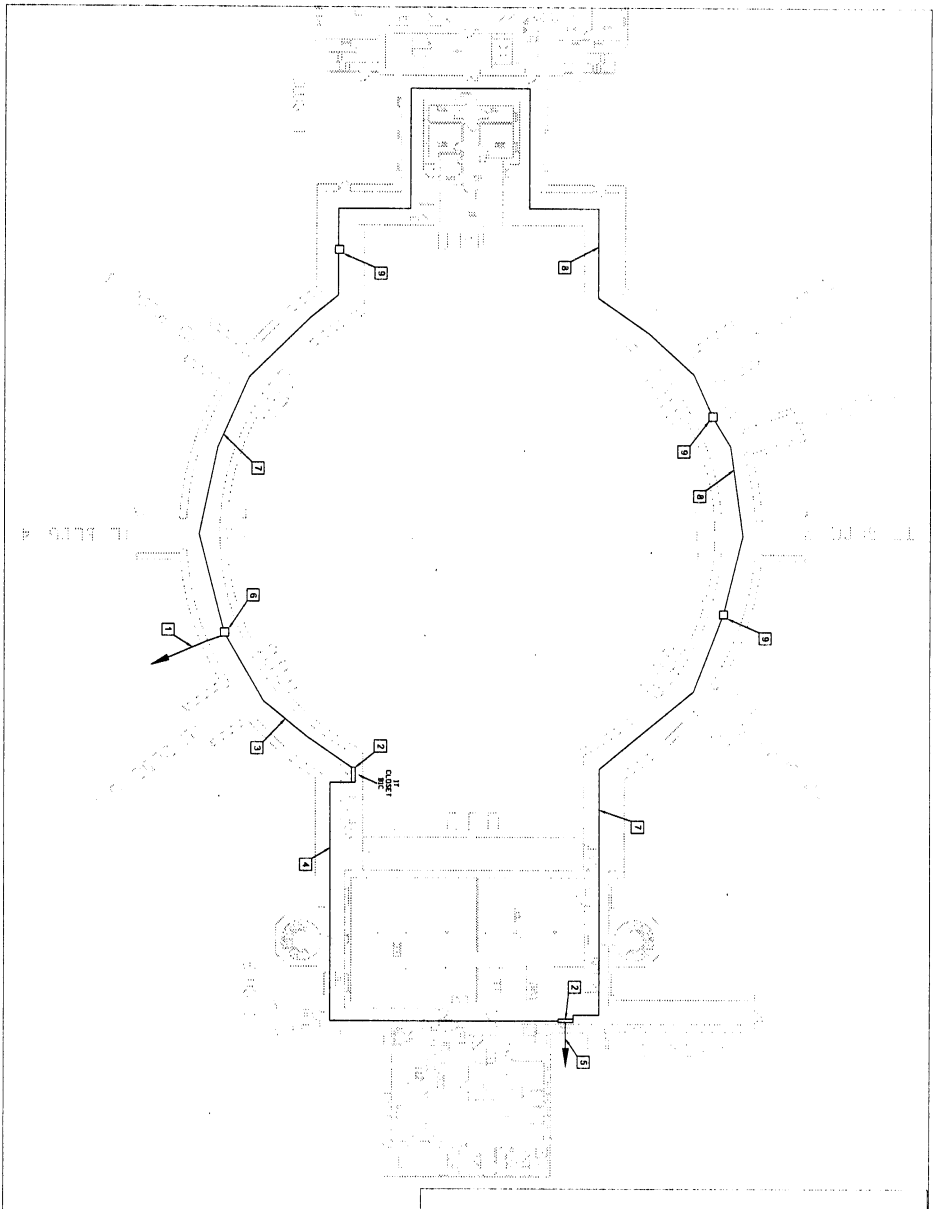

1 PARTIAL ARCADE BASEMENT LEVEL FIBER PLAN
SCALE: 1/8" = 1'-0"

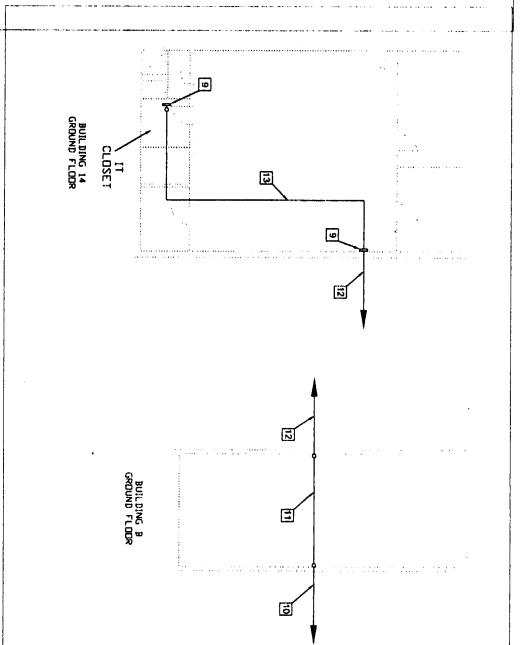

2 BLDG. #14 & B. GROUND LEVEL FIBER PLAN
SCALE: 1/8" = 1'-0"

NUMBERED CONSTRUCTION NOTES:

1. SEE SITE PLAN FOR THE LOCATION OF THE CLOSET. SEE SITE PLAN FOR THE LOCATION OF THE CLOSET.
2. SEE SITE PLAN FOR THE LOCATION OF THE CLOSET. SEE SITE PLAN FOR THE LOCATION OF THE CLOSET.
3. SEE SITE PLAN FOR THE LOCATION OF THE CLOSET. SEE SITE PLAN FOR THE LOCATION OF THE CLOSET.
4. SEE SITE PLAN FOR THE LOCATION OF THE CLOSET. SEE SITE PLAN FOR THE LOCATION OF THE CLOSET.
5. SEE SITE PLAN FOR THE LOCATION OF THE CLOSET. SEE SITE PLAN FOR THE LOCATION OF THE CLOSET.
6. SEE SITE PLAN FOR THE LOCATION OF THE CLOSET. SEE SITE PLAN FOR THE LOCATION OF THE CLOSET.
7. SEE SITE PLAN FOR THE LOCATION OF THE CLOSET. SEE SITE PLAN FOR THE LOCATION OF THE CLOSET.
8. SEE SITE PLAN FOR THE LOCATION OF THE CLOSET. SEE SITE PLAN FOR THE LOCATION OF THE CLOSET.
9. SEE SITE PLAN FOR THE LOCATION OF THE CLOSET. SEE SITE PLAN FOR THE LOCATION OF THE CLOSET.
10. SEE SITE PLAN FOR THE LOCATION OF THE CLOSET. SEE SITE PLAN FOR THE LOCATION OF THE CLOSET.
11. SEE SITE PLAN FOR THE LOCATION OF THE CLOSET. SEE SITE PLAN FOR THE LOCATION OF THE CLOSET.
12. SEE SITE PLAN FOR THE LOCATION OF THE CLOSET. SEE SITE PLAN FOR THE LOCATION OF THE CLOSET.
13. SEE SITE PLAN FOR THE LOCATION OF THE CLOSET. SEE SITE PLAN FOR THE LOCATION OF THE CLOSET.

GENERAL NOTES: GENERAL CONSTRUCTION AND/OR ALL INFORMATION SHALL BE THE PROPERTY OF THE ARCHITECT. THE ARCHITECT SHALL BE RESPONSIBLE FOR THE ACCURACY OF THE INFORMATION PROVIDED. THE ARCHITECT SHALL BE RESPONSIBLE FOR THE ACCURACY OF THE INFORMATION PROVIDED. THE ARCHITECT SHALL BE RESPONSIBLE FOR THE ACCURACY OF THE INFORMATION PROVIDED.	
DATE:	
PROJECT TITLE: ARCADE & BUILDING #14 & BUILDING B FIBER PLANS	
DESIGNER: 1/2" = 1'-0" 1/2" = 1'-0"	APPROVED: [Signature] [Title]
DATE: 1-10-2017	DATE: 1-10-2017
PROJECT NO.: 060-17-2017	PROJECT NO.: 060-17-2017
ARCHITECT: ARCH. #14 & B	ARCHITECT: ARCH. #14 & B
ENGINEER: E-3	ENGINEER: E-3
Office of Facilities Management 1000 14th St. N. Minneapolis, MN 55403	

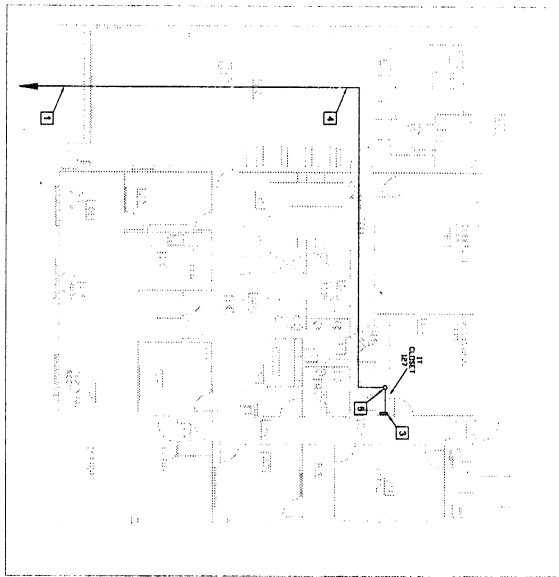

BUILDING #66 FIBER PLAN
SCALE 1/4" = 1'-0"

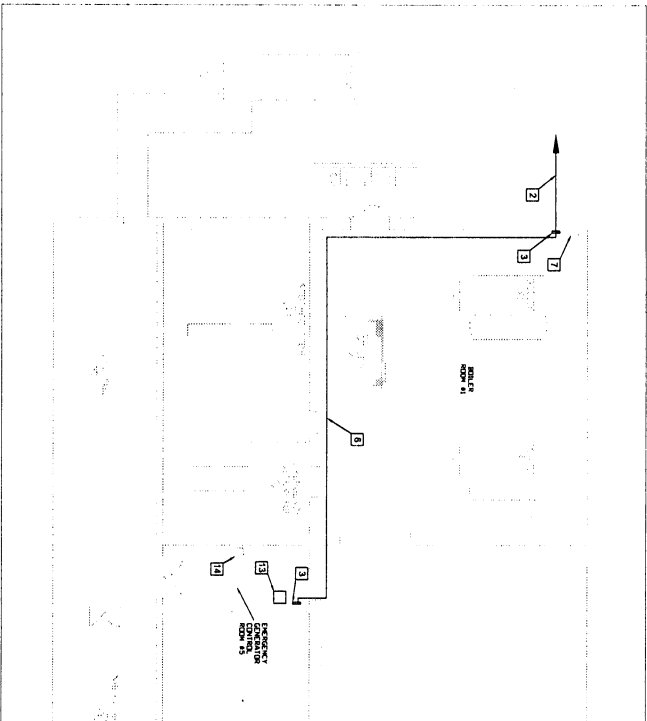

2
E4

PARTIAL BUILDING #18 FIBER PLAN

SCALE: 1/8"=1'-0"

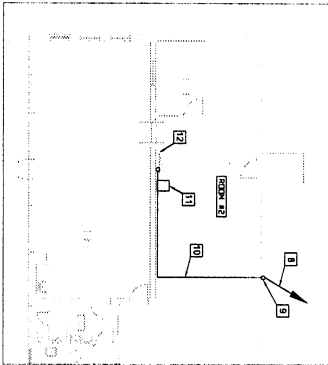

3
E4

PARTIAL BUILDING #13 FIBER PLAN

SCALE 3/4" = 1'-0"

- [illegible]

**GENERAL
NOTES:**

[illegible]

**BUILDINGS #18 & #66 & #13
FIBER PLANS**

ASSESS/UPGRADE FIBER CABLES

Project No.
568-12-207

Building Number
#18, #66, & #13

**Office of
Facilities
Management**



PLAN NORTH

Phot Scale
12" = 1' @ 0"

Approved: Service Director

Date 3-19-2017

Checked	Drawn
114	MM

1
 2
 3
 4
 5
 6
 7
 8
 9
 10
 11
 12
 13
 14
 15
 16
 17
 18
 19
 20
 21
 22
 23
 24
 25
 26
 27
 28
 29
 30
 31
 32
 33
 34
 35
 36
 37
 38
 39
 40
 41
 42
 43
 44
 45
 46
 47
 48
 49
 50
 51
 52
 53
 54
 55
 56
 57
 58
 59
 60
 61
 62
 63
 64
 65
 66
 67
 68
 69
 70
 71
 72
 73
 74
 75
 76
 77
 78
 79
 80
 81
 82
 83
 84
 85
 86
 87
 88
 89
 90
 91
 92
 93
 94
 95
 96
 97
 98
 99
 100
 101
 102
 103
 104
 105
 106
 107
 108
 109
 110
 111
 112
 113
 114
 115
 116
 117
 118
 119
 120
 121
 122
 123
 124
 125
 126
 127
 128
 129
 130
 131
 132
 133
 134
 135
 136
 137
 138
 139
 140
 141
 142
 143
 144
 145
 146
 147
 148
 149
 150
 151
 152
 153
 154
 155
 156
 157
 158
 159
 160
 161
 162
 163
 164
 165
 166
 167
 168
 169
 170
 171
 172
 173
 174
 175
 176
 177
 178
 179
 180
 181
 182
 183
 184
 185
 186
 187
 188
 189
 190
 191
 192
 193
 194
 195
 196
 197
 198
 199
 200
 201
 202
 203
 204
 205
 206
 207
 208
 209
 210
 211
 212
 213
 214
 215
 216
 217
 218
 219
 220
 221
 222
 223
 224
 225
 226
 227
 228
 229
 230
 231
 232
 233
 234
 235
 236
 237
 238
 239
 240
 241
 242
 243
 244
 245
 246
 247
 248
 249
 250
 251
 252
 253
 254
 255
 256
 257
 258
 259
 260
 261
 262
 263
 264
 265
 266
 267
 268
 269
 270
 271
 272
 273
 274
 275
 276
 277
 278
 279
 280
 281
 282
 283
 284
 285
 286
 287
 288
 289
 290
 291
 292
 293
 294
 295
 296
 297
 298
 299
 300
 301
 302
 303
 304
 305
 306
 307
 308
 309
 310
 311
 312
 313
 314
 315
 316
 317
 318
 319
 320
 321
 322
 323
 324
 325
 326
 327
 328
 329
 330
 331
 332
 333
 334
 335
 336
 337
 338
 339
 340
 341
 342
 343
 344
 345
 346
 347
 348
 349
 350
 351
 352
 353
 354
 355
 356
 357
 358
 359
 360
 361
 362
 363
 364
 365
 366
 367
 368
 369
 370
 371
 372
 373
 374
 375
 376
 377
 378
 379
 380
 381
 382
 383
 384
 385
 386
 387
 388
 389
 390
 391
 392
 393
 394
 395
 396
 397
 398
 399
 400
 401
 402
 403
 404
 405
 406
 407
 408
 409
 410
 411
 412
 413
 414
 415
 416
 417
 418
 419
 420
 421
 422
 423
 424
 425
 426
 427
 428
 429
 430
 431
 432
 433
 434
 435
 436
 437
 438
 439
 440
 441
 442
 443
 444
 445
 446
 447
 448
 449
 450
 451
 452
 453
 454
 455
 456
 457
 458
 459
 460
 461
 462
 463
 464
 465
 466
 467
 468
 469
 470
 471
 472
 473
 474
 475
 476
 477
 478
 479
 480
 481
 482
 483
 484
 485
 486
 487
 488
 489
 490
 491
 492
 493
 494
 495
 496
 497
 498
 499
 500
 501
 502
 503
 504
 505
 506
 507
 508
 509
 510
 511
 512
 513
 514
 515
 516
 517
 518
 519
 520
 521
 522
 523
 524
 525

ST	L
ST-100	100
ST-101	101
ST-102	102
ST-103	103
ST-104	104
ST-105	105
ST-106	106
ST-107	107
ST-108	108
ST-109	109
ST-110	110
ST-111	111
ST-112	112
ST-113	113
ST-114	114
ST-115	115
ST-116	116
ST-117	117
ST-118	118
ST-119	119
ST-120	120
ST-121	121
ST-122	122
ST-123	123
ST-124	124
ST-125	125
ST-126	126
ST-127	127
ST-128	128
ST-129	129
ST-130	130
ST-131	131
ST-132	132
ST-133	133
ST-134	134
ST-135	135
ST-136	136
ST-137	137
ST-138	138
ST-139	139
ST-140	140
ST-141	141
ST-142	142
ST-143	143
ST-144	144
ST-145	145
ST-146	146
ST-147	147
ST-148	148
ST-149	149
ST-150	150
ST-151	151
ST-152	152
ST-153	153
ST-154	154
ST-155	155
ST-156	156
ST-157	157
ST-158	158
ST-159	159
ST-160	160
ST-161	161
ST-162	162
ST-163	163
ST-164	164
ST-165	165
ST-166	166
ST-167	167
ST-168	168
ST-169	169
ST-170	170
ST-171	171
ST-172	172
ST-173	173
ST-174	174
ST-175	175
ST-176	176
ST-177	177
ST-178	178
ST-179	179
ST-180	180
ST-181	181
ST-182	182
ST-183	183
ST-184	184
ST-185	185
ST-186	186
ST-187	187
ST-188	188
ST-189	189
ST-190	190
ST-191	191
ST-192	192
ST-193	193
ST-194	194
ST-195	195
ST-196	196
ST-197	197
ST-198	198
ST-199	199
ST-200	200
ST-201	201
ST-202	202
ST-203	203
ST-204	204
ST-205	205
ST-206	206
ST-207	207
ST-208	208
ST-209	209
ST-210	210
ST-211	211
ST-212	212
ST-213	213
ST-214	214
ST-215	215
ST-216	216
ST-217	217
ST-218	218
ST-219	219
ST-220	220
ST-221	221
ST-222	222
ST-223	223
ST-224	224
ST-225	225
ST-226	226
ST-227	227
ST-228	228
ST-229	229
ST-230	230
ST-231	231
ST-232	232
ST-233	233
ST-234	234
ST-235	235
ST-236	236
ST-237	237
ST-238	238
ST-239	239
ST-240	240
ST-241	241
ST-242	242
ST-243	243
ST-244	244
ST-245	245
ST-246	246
ST-247	247
ST-248	248
ST-249	249
ST-250	