

three inches = one foot
one and one-half inches = one foot
one inch = one foot
three-quarters inch = one foot
one-half inch = one foot
three-eighths inch = one foot
one-quarter inch = one foot
one-eighth inch = one foot

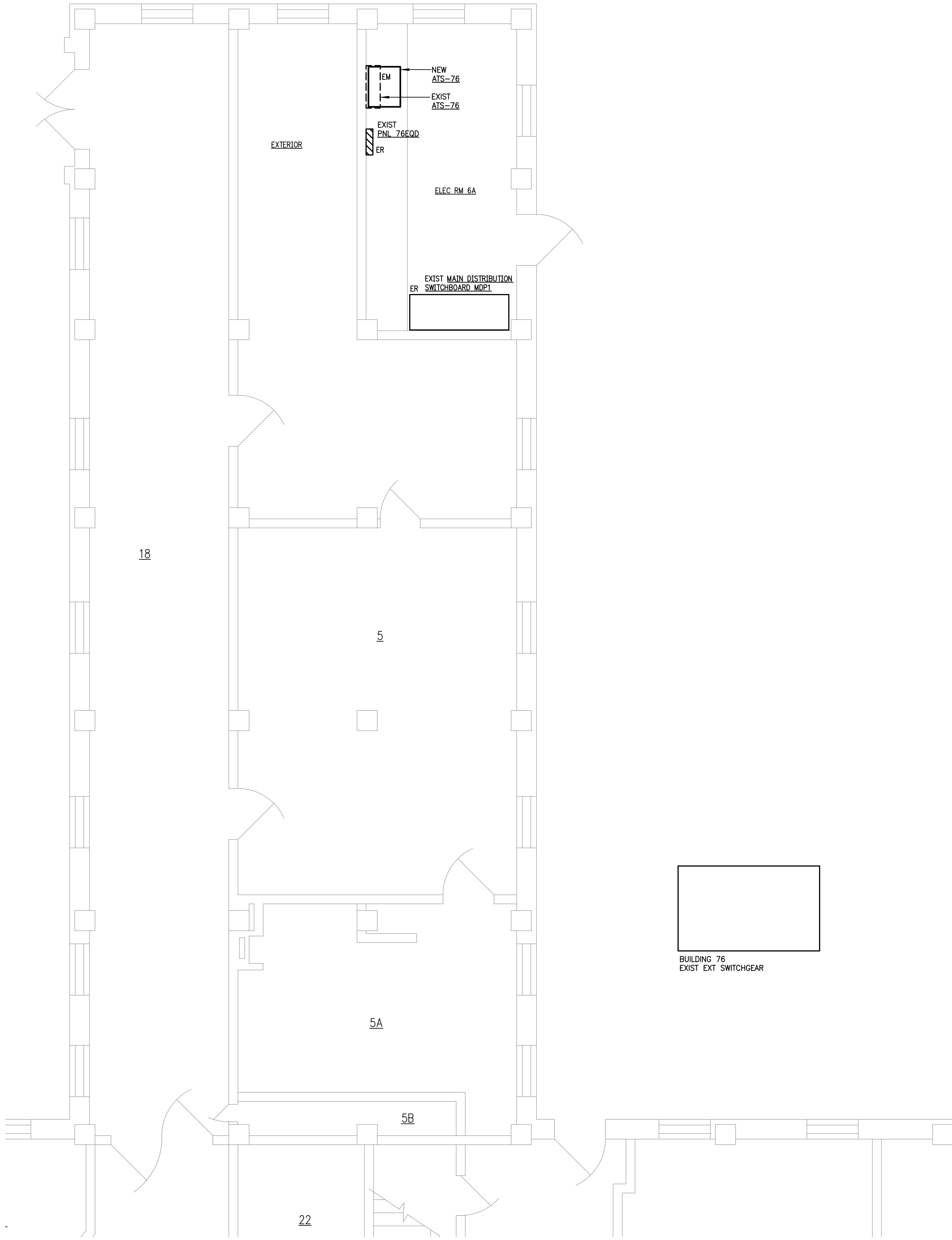

BLDG 76
PARTIAL SUB-BASEMENT FLOOR PLAN – POWER
SCALE: 1/4" = 1'-0"

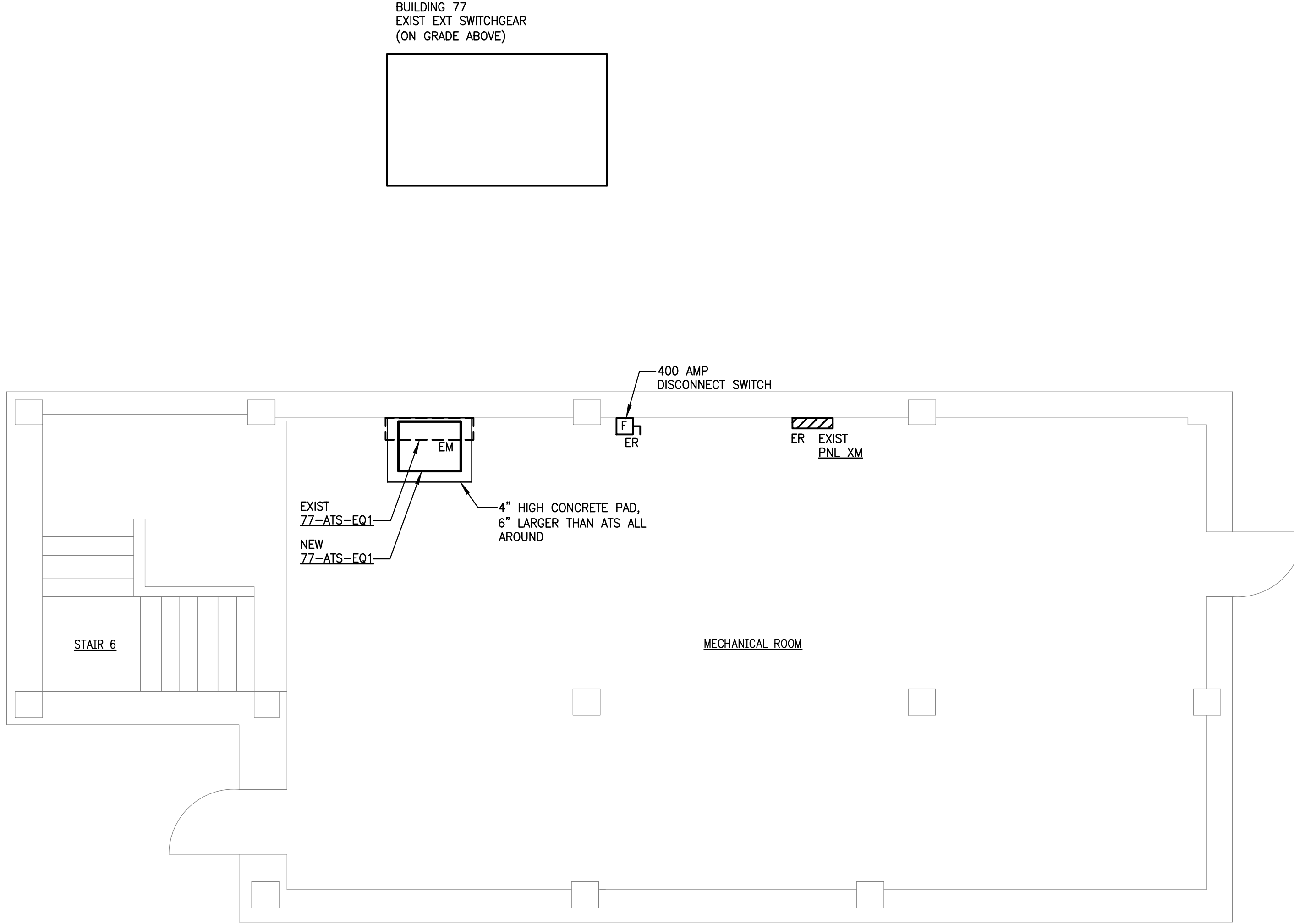

BLDG 77
PARTIAL SUB-BASEMENT FLOOR PLAN – POWER
SCALE: 1/4" = 1'-0"

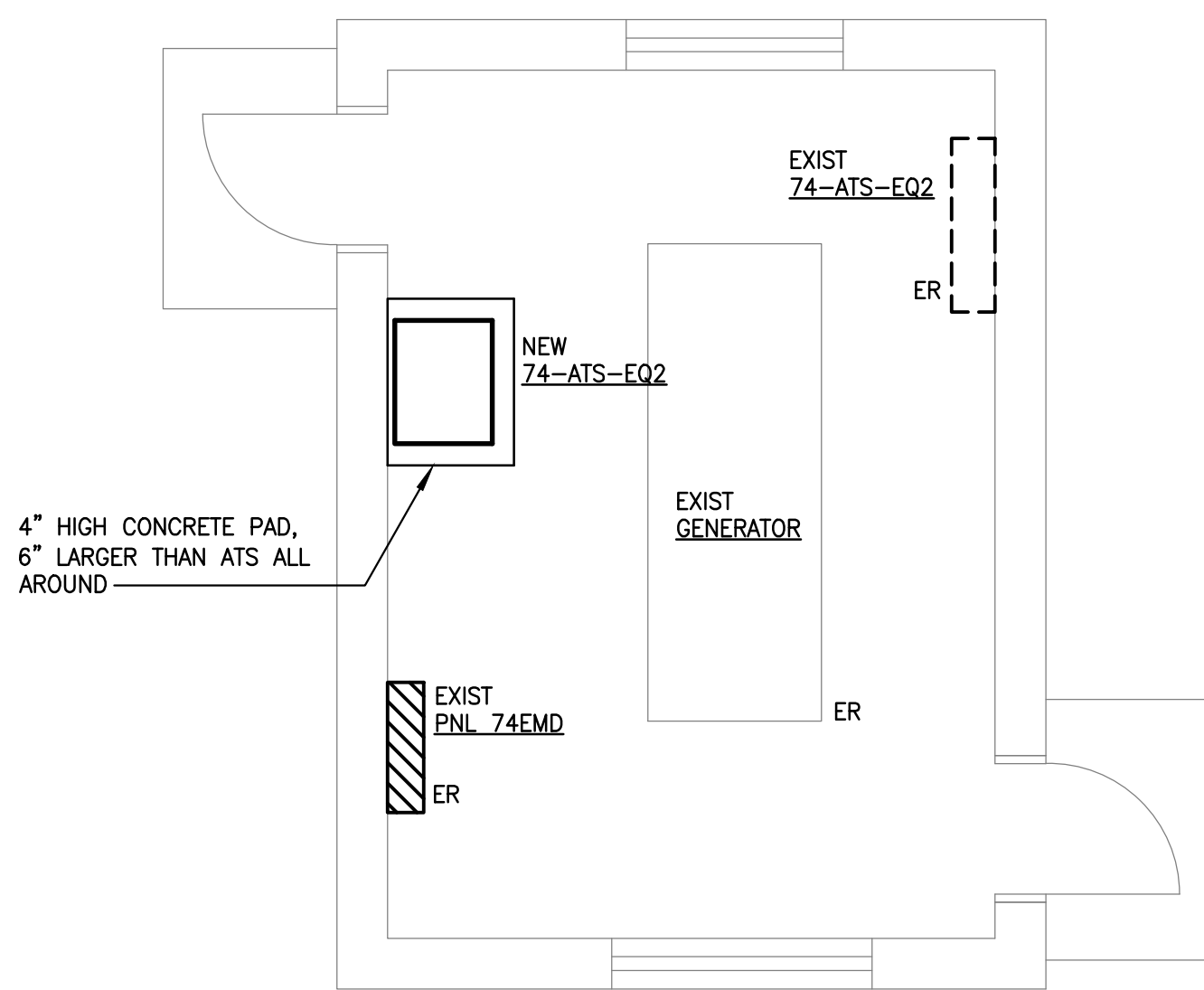

BLDG 141
GENERATOR BLDG – POWER
SCALE: 1/4" = 1'-0"

				<div><div><div>COMMONWEALTH OF VIRGINIA</div><div>NEAL A. CRAMER</div><div>Lic. No. 41825</div><div>PROFESSIONAL ENGINEER</div></div><div><div><div>Lawrence Perry & Associates, Inc.</div><div>Mechanical and Electrical Engineers</div><div>11 E. Salem Avenue SE, Suite 101 - Roanoke, Virginia 24011</div><div>Ph: (540) 342-1816 Fax: (540) 344-3410</div><div>Comm. No.: 10135</div><div>©2012 Lawrence Perry and Associates, Inc.</div></div></div></div>		APPROVED: Energy Engineer		APPROVED: Safety Manager		APPROVED: Service Chief		DRAWING TITLE BUILDINGS 76, 77 AND 141 PARTIAL FLOOR PLANS - POWER		PROJECT TITLE UPGRADE ELECTRICAL SYSTEM (REPLACE ATS)		DATE 02-17-12		Veterans Affairs
						APPROVED: Infection Control Officer		APPROVED: Chief of Staff		APPROVED: Chief of Facility Management Svc.		PROJECT NO. 658-12-106		DRAWING NO. ES 9 DWG. 10 OF 13				
						APPROVED: GEMS Coordinator		APPROVED: Associate Director		BUILDING NUMBER 76, 77 AND 141		CHECKED NAC			DRAWN WDC/RGW			
REVISIONS		BY DATE						APPROVED: Medical Center Director		LOCATION V.A.M.C. SALEM, VA. 24153								