

AMENDMENT NO. 1

**CBLH DESIGN, INC.
7850 FREEWAY CIRCLE
MIDDLEBURG HTS., OHIO 44130
PHONE: 440/243-2000
FAX: 440/243-3305
DATE: 01/05/2017
PROJECT NO.: 18903**

**AMENDMENT NO. 1 TO DRAWINGS AND TECHNICAL SPECIFICATIONS FOR
UPGRADE CCTV TO DIGITAL SYSTEM
CHALMER'S P. WYLIE AMBULATORY CARE CENTER
VA PROJECT NO. 757-16-102**

*Prepared by: CBLH Design, Inc.
7850 Freeway Circle, Middleburg Heights, Ohio 44130*

Bidding Documents, Specifications and Drawings dated 07/12/2016, for the above-named project are modified and supplemented as set forth in this Amendment. Wherein this Amendment varies from or conflicts with the original issue of Bidding Documents, the requirements of this Amendment shall govern.

Amendment and Amendment items are numbered consecutively from the commencement of the Project.

Items are not necessarily in sequence by Specification Section or Drawing Number.

This Amendment is comprised of three (3) items and three (3) attachments as noted.

The following Drawings, dated 01/05/2017, are included with this Amendment.

<u>Drawing No.</u>	<u>Title</u>	<u>Item No.</u>	<u>Size</u>
A3.1	FIRST FLOOR DEMO AND NEW WORK PLAN	1	30"x42"
A10.0	REFLECTED CEILING PLAN, SCHEDULES, AND DETAILS	2	30"x42"
E5.2	FOURTH FLOOR TELECOMMUNICATIONS RACK DETAILS AND NOTES	3	30"x42"

DRAWINGS

ITEM NO.1 **DRAWING A3.1**

Remove Drawing A3.1 originally issued July 12, 2016, and replace with Drawing A3.1 dated January 5, 2017, issued with Amendment No. 1, attached herewith.

ITEM NO.2 **DRAWING A10.0**

Remove Drawing A10.0 originally issued July 12, 2016, and replace with Drawing A10.0 dated January 5, 2017, issued with Amendment No. 1, attached herewith.

ITEM NO.3 DRAWING E5.2

Remove Drawing E5.2 originally issued July 12, 2016, and replace with Drawing E5.2 dated January 5, 2017, issued with Amendment No. 1, attached herewith.

DEMOLITION GENERAL NOTES

- CONTRACTOR SHALL COORDINATE DEMOLITION WITH OWNER. SALVAGE AND TURN OVER TO OWNER DOORS, HARDWARE, TOILET ACCESSORIES, CURTAIN TRACKS, LIGHT FIXTURES AND OTHER ITEMS DESIGNATED BY OWNER. DELIVER TO OWNER ALL ITEMS AS NOTED.
- DISPOSITION OF MECHANICAL, PLUMBING, GAS, AIR, VAC, PIPING, FIRE PROTECTION AND ELECTRICAL ITEMS ENCOUNTERED IN AREAS TO BE DEMOLISHED ARE DESCRIBED IN RESPECTIVE DRAWINGS AND SPECIFICATIONS. CONTRACTOR SHALL COORDINATE WORK WITH ALL TRADES.
- WALLS, DOORS, FIXTURES, ETC. TO BE REMOVED ARE SHOWN DASHED. SELECTED ITEMS ARE LABELED TO IDENTIFY THE ITEM TO BE REMOVED.
- LOOSE EQUIPMENT OR FURNITURE NOT IDENTIFIED FOR REMOVAL, RE-USE OR RELOCATION IS TO BE TURNED OVER TO OWNER.
- INSTALL SECURE TEMPORARY DUST PARTITIONS TO SEPARATE DEMOLITION & CONSTRUCTION AREAS FROM OCCUPIED SPACE. TEMPORARY WALL SHALL CONSIST OF STUD AND GYPSUM WALL BOARD CONSTRUCTION SEALED AT THE TOP AND BOTTOM OF WALL.
- REFER TO MECHANICAL AND ELECTRICAL DRAWINGS FOR ADDITIONAL DEMOLITION ITEMS AND REQUIREMENTS.
- REMOVE EXISTING FLOOR AND BASE MATERIALS IN AREAS SCHEDULED TO RECEIVE NEW FLOORING, PREP EXISTING FLOOR TO RECEIVE NEW FINISH.
- REMOVE EXISTING CEILING MATERIALS AND SUPPORT SYSTEM IN AREAS SCHEDULED TO RECEIVE NEW CEILING.
- REMOVE ALL DEBRIS, RUBBISH, AND OTHER MATERIALS RESULTING FROM DEMOLITION OPERATIONS IN ACCORDANCE WITH LOCAL, STATE, AND FEDERAL LAWS FROM THE PROJECT SITE. BURNING OF REMOVED MATERIALS IS NOT PERMITTED ON PROJECT SITE.
- COORDINATE WITH OWNER FOR SHUTOFF, CAPPING AND CONTINUATION OF UTILITY SERVICES AS REQUIRED. NOTIFY OWNER MINIMUM TWO (2) WEEKS BEFORE TO SCHEDULE SHUTDOWNS. DO NOT INTERRUPT EXISTING UTILITIES SERVING OCCUPIED OR FACILITIES USED.
- MAKE PORTABLE FIRE EXTINGUISHER AVAILABLE DURING DEMOLITION PROCESS.
- USE OF EXPLOSIVES IS NOT PERMITTED.
- COMPLY WITH ALL GOVERNING REGULATIONS PERTAINING TO ENVIRONMENTAL PROTECTION (FEDERAL, STATE AND LOCAL).
- CONTRACTOR TO PATCH AND REPAIR ALL EXISTING FIREPROOFING AFTER INSTALLATION OF NEW WORK AS REQUIRED TO MAINTAIN REQUIRED FIRE RATING. CONTRACTOR TO USE MATERIALS COMPATIBLE WITH EXISTING FIREPROOFING FOR PATCH WORK.

DEMOLITION KEYNOTES (D0)

- D02 REMOVE EXISTING FLOORING AND RUBBER BASE. PREPARE SUBSTRATE FOR NEW WORK.
- D04 REMOVE EXISTING DRYWALL TO 8" AFF AND EXISTING RUBBER BASE. PROVIDE NEW DRYWALL AND RUBBER BASE.

FLOOR PLAN GENERAL NOTES

- ALL INTERIOR PARTITION DIMENSIONS TO FACE OF CONCRETE BLOCK, FACE OF GYPSUM WALL BOARD, OR FACE OF EXISTING WALL UNLESS OTHERWISE NOTED.
- VERIFY ALL DIMENSIONS AND CONDITIONS IN THE FIELD PRIOR TO COMMENCEMENT OF WORK. WHEN DIMENSIONS AND/OR CONDITIONS AS INDICATED ON THE DRAWINGS CONFLICT WITH ACTUAL, CONTACT ARCHITECT FOR CLARIFICATION BEFORE PROCEEDING WITH WORK.
- NO ATTEMPT HAS BEEN MADE TO SHOW SECTIONS CUTS OR DETAIL DESIGNATORS AT ALL LOCATIONS WHERE SIMILAR CONDITIONS OCCUR.
- ANY MATERIAL INDICATIONS OR NOTES SHOWN ON ONE SECTION (USUALLY THE FIRST SECTION OF EACH SHEET), ELEVATION OR DETAIL ALSO APPLY TO ALL SIMILAR CONDITIONS ON OTHER SECTIONS, ELEVATIONS, OR DETAILS.
- SECTIONS AND DETAILS ARE TYPICAL FOR ALL LOCATIONS AT WHICH SIMILAR CONDITIONS OCCUR UNLESS NOTED AS APPLICABLE TO A SPECIFIC LOCATION ONLY.
- ALL METAL STUDS SHALL BE 4" ACTUAL UNLESS OTHERWISE NOTED. BRACE AS REQUIRED FOR LATERAL SUPPORT.
- WALL THICKNESS INDICATED ON 1/8" AND 1/4" SCALE FLOOR PLANS SHALL BE CONSTANT FOR THE ENTIRE LENGTH OF WALL, UNLESS OTHERWISE NOTED.
- ALL FIRE RATED ASSEMBLIES SHALL EXTEND FROM FLOOR TO STRUCTURE ABOVE CONTINUOUSLY WITH OPENINGS AROUND STRUCTURE, HVAC, PLUMBING, ETC. FIRESTOPPED.
- PROVIDE BEHIND WALL REINFORCING FOR ATTACHMENT OF MILLWORK, CASEWORK, ACCESSORIES, ETC.
- NEW OPENINGS FOR MECHANICAL WORK SHALL BE EITHER CORE DRILLED OR POWER SAILED, NO JACKHAMMERING.
- P&M DENOTES "PATCH TO MATCH EXISTING CONSTRUCTION AND FINISHES". ALL PATCHING OF EXISTING MATERIAL SHALL BE DONE WITH THE MATERIALS AND WORKMANSHIP MATCHING ADJACENT SURFACES.
- NO ATTEMPT HAS BEEN MADE TO INDICATE ALL AREAS REQUIRING CUTTING AND PATCHING DUE TO MECHANICAL AND/OR ELECTRICAL WORK.
- PATCH AND LEVEL FOR NEW FLOORING AT AREAS WHERE EXISTING FLOORING HAS BEEN REMOVED.
- PATCH AND MATCH EXISTING WALL, FLOOR, AND CEILING SURFACES FOR NEW FINISHES AT AREAS WHERE EXISTING WALLS, DOORS, FRAMES, CASEWORK, COUNTERTOPS, LOCKERS, ETC HAVE BEEN REMOVED OR SURFACES CUT FOR INSTALLATION OF SERVICES, EQUIPMENT, ETC.
- WHERE EXISTING OR NEW CAMERAS OR EQUIPMENT OCCUR, CONTRACTOR SHALL ASSUME THAT PATCHING AND MATCHING IS REQUIRED AS PART OF THE EXISTING DEMOLITION OR NEW WORK.

BID AND CONSTRUCTION
FULLY SPRINKLERED

Office of
Construction
and Facilities
Management



Project Number
757-16-102

Building Number
1

Drawing Number

A3.1

Dwg. 3 of 47

Project Title
UPGRADE CCTV TO DIGITAL
SYSTEM

Location
420 NORTH JAMES ROAD, COLUMBUS, OHIO 43219

Date
07/12/2016

Checked
JV

Drawn
SW

Drawing Title
FIRST FLOOR DEMO AND NEW WORK PLAN

Approved: Project Director

ARCHITECTURAL PROJECT 18903.00

ARCHITECTS/ENGINEERS:



7850 Freeway Circle
440.243.2000 t
Cleveland, OH 44130
440.243.3305 f

KEY PLAN

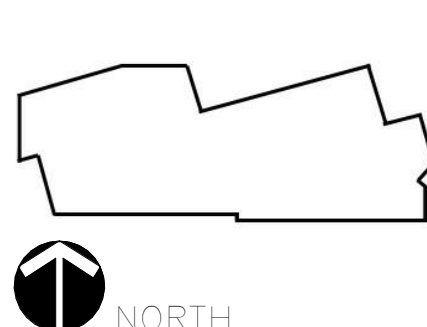

CONSULTANTS:



AMENDMENT 1	01/05/2017
BID AND CONSTRUCTION	07/12/2016
Revisions	Date

SECTION - COUNTER SUPPORT

A3.1 SCALE: 3/4" = 1'-0"

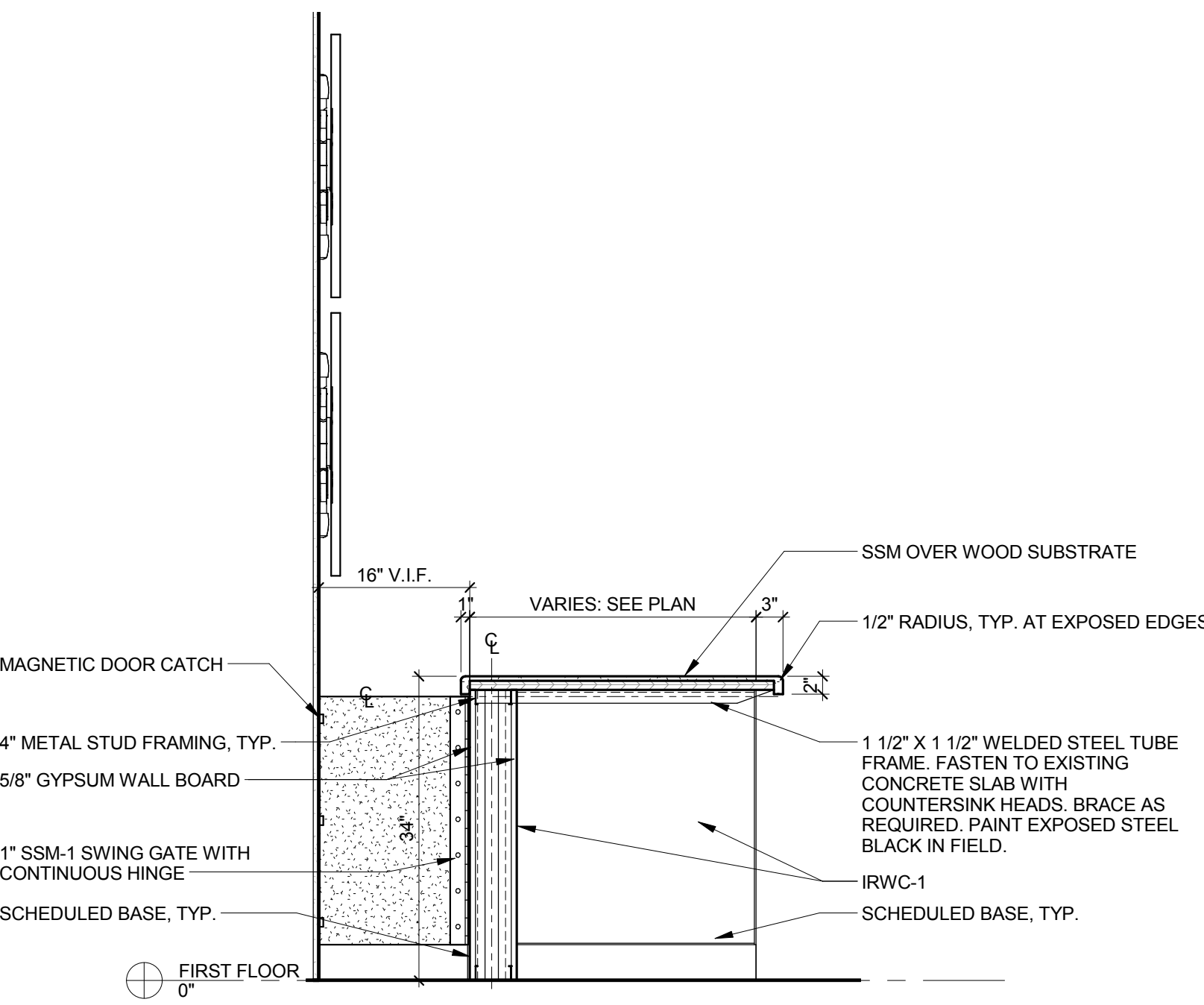

INTERIOR ELEVATION - CONTROL ROOM

A3.1 SCALE: 1/4" = 1'-0"

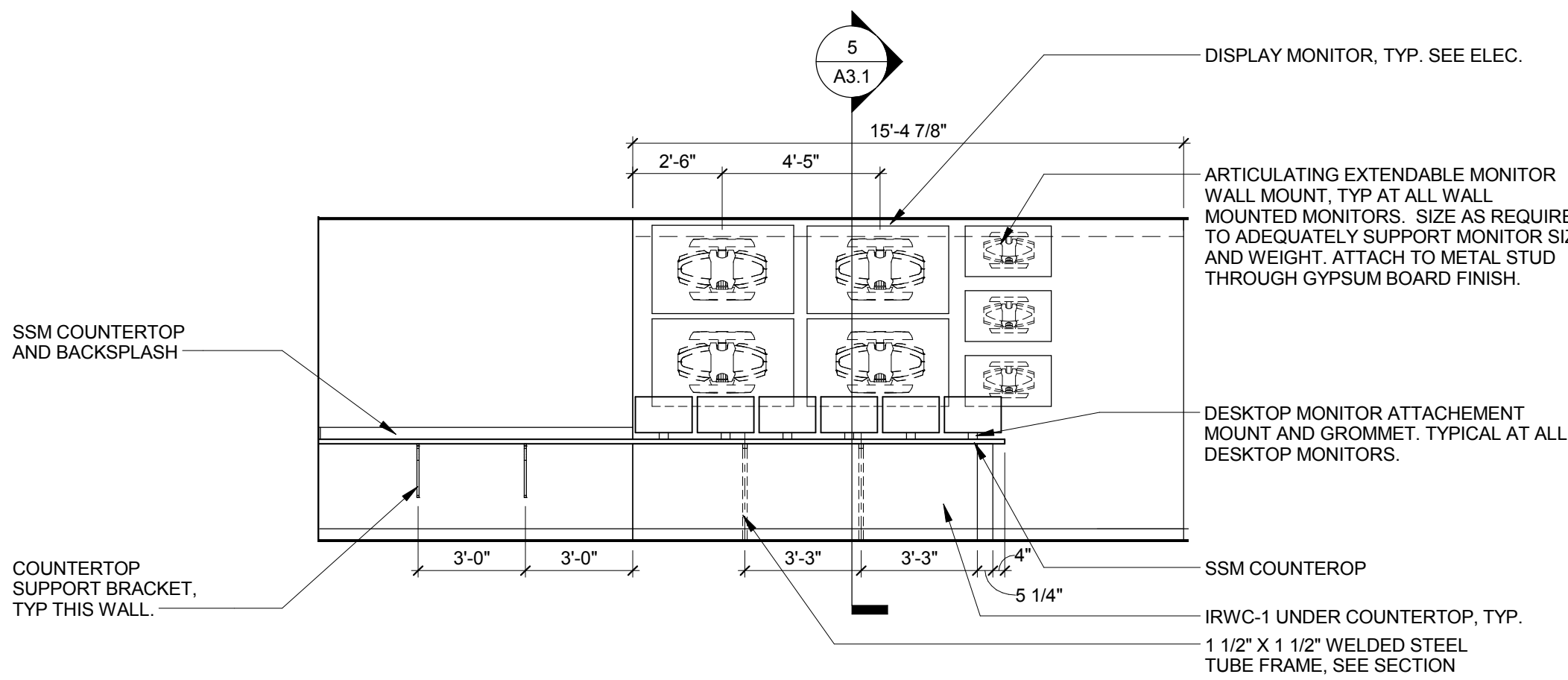

FIRST FLOOR KEY PLAN

A3.1 SCALE: 1/16" = 1'-0"



PARTIAL FIRST FLOOR DEMOLITION PLAN

A3.1 SCALE: 1/8" = 1'-0"

PARTIAL FIRST FLOOR PLAN

A3.1 SCALE: 1/8" = 1'-0"

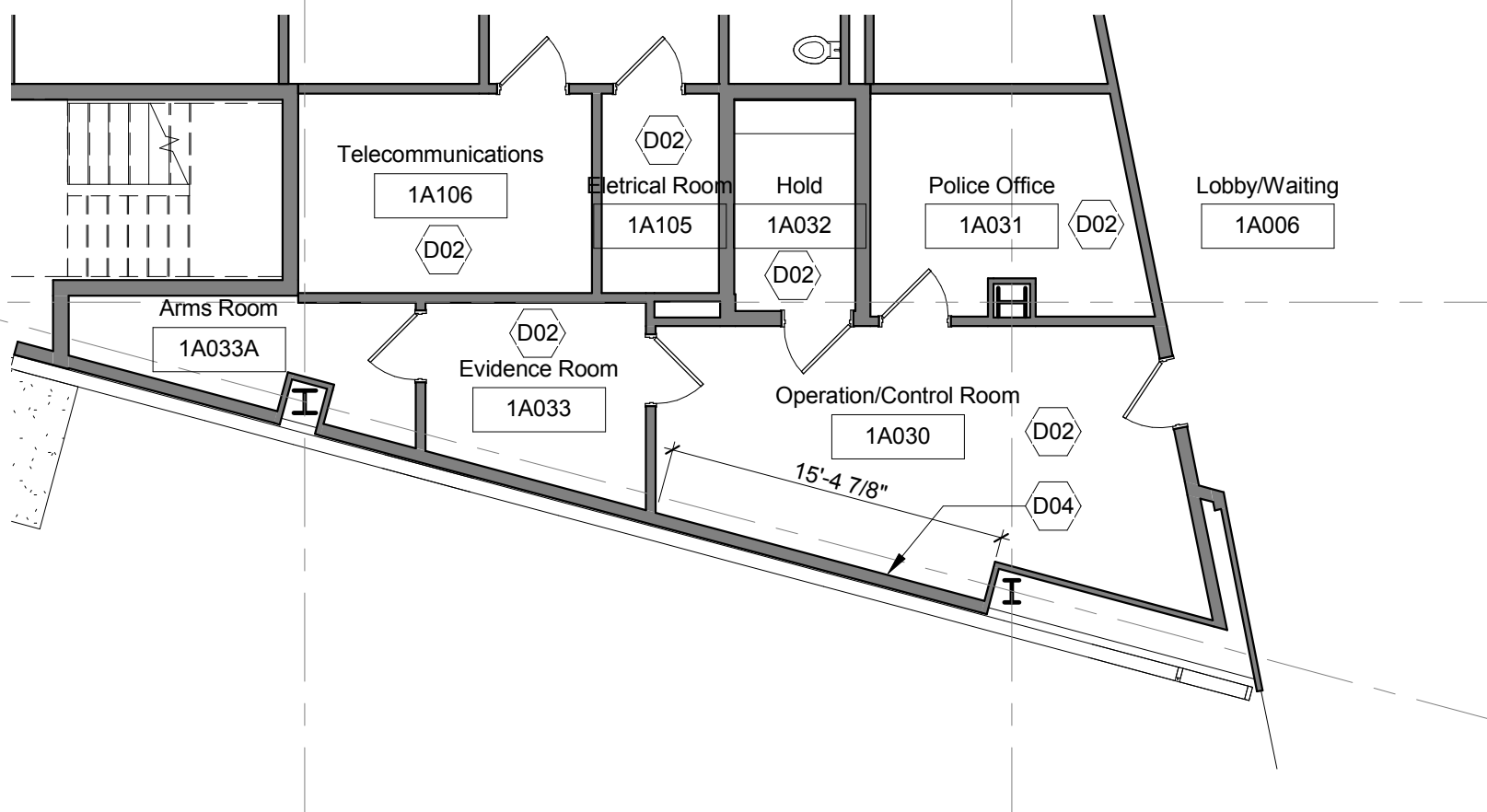
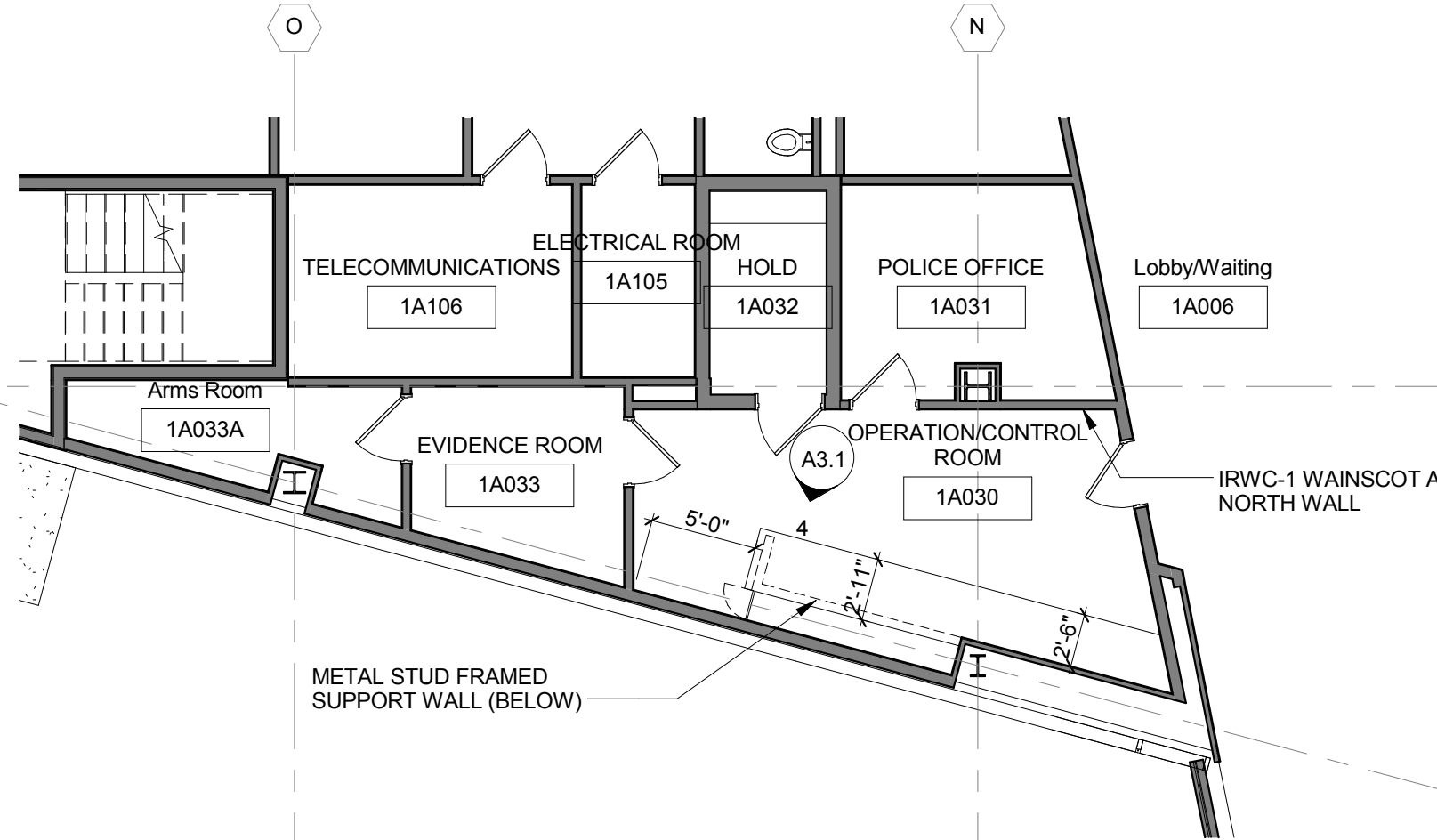

DOOR FRAME DETAILS

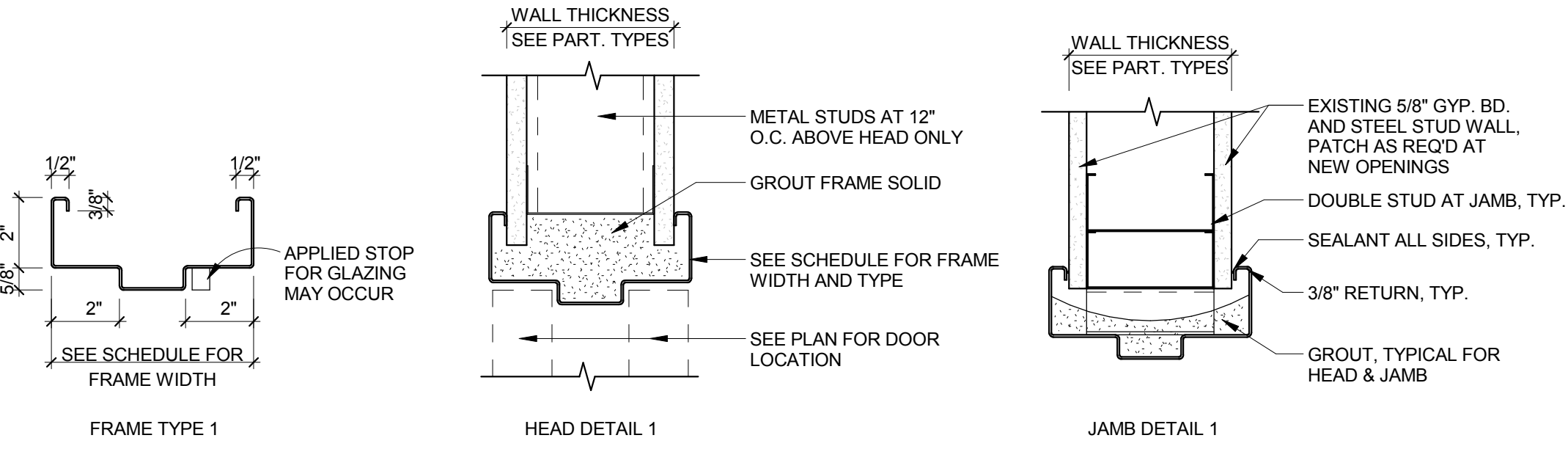

DOOR AND FRAME ELEVATIONS

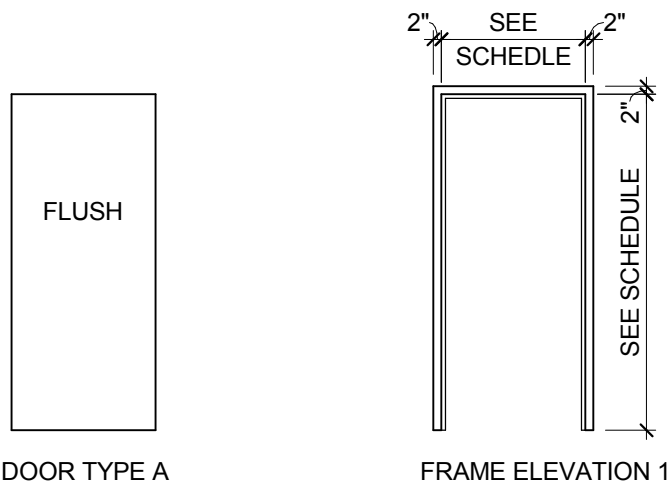

ROOM FINISH SCHEDULE

ROOM		FLOOR		BASE		WALLS				CEILING	CEILING	ARCH. WOODWORK	NOTES	
NUMBER	NAME	SUBSTR.	FINISH	SUBSTR.	FINISH	SUBSTR. NEW	NORTH	SOUTH	EAST	WEST	SUBSTR. NEW			FINISH
FIRST FLOOR														
1A030	OPERATION/CONTROL ROOM	C	VCT1	GYP	RB1	GYP	P2/A*	P2/A	P1/A	P1/A	--	--	SSM1	*48" IRWC-1 WAINSCOTT
1A031	POLICE OFFICE	C	VCT1	GYP	RB1	--	P&M*	P&M*	P&M*	P&M*	--	--		*AS REQUIRED FOR NEW WALL BASE INSTALLATION
1A032	HOLD	C	VCT1	GYP	RB1	--	P&M*	P&M*	P&M*	P&M*	--	--		*AS REQUIRED FOR NEW WALL BASE INSTALLATION
1A033	EVIDENCE ROOM	C	VCT1	GYP	RB1	--	P&M*	P&M*	P&M*	P&M*	--	--		*AS REQUIRED FOR NEW WALL BASE INSTALLATION
1A105	ELECTRICAL ROOM	C	VCT1	GYP	RB1	--	P&M*	P&M*	P&M*	P&M*	--	--		*AS REQUIRED FOR NEW WALL BASE INSTALLATION
1A106	TELECOMMUNICATIONS	C	VCT1	GYP	RB1	--	P&M*	P&M*	P&M*	P&M*	--	--		*AS REQUIRED FOR NEW WALL BASE INSTALLATION
FOURTH FLOOR														
4A003A	CORRIDOR	C	VCT1	GYP	RB1	GYP	P1/A	P1/A	P1/A	P1/A	--	AT1		
4A003B	SECURITY TELE. COMM.	C	VCT1	GYP	RB1	GYP	P1/A	P1/A	P1/A	P1/A	--	EXP		

ROOM FINISH LEGEND

FLOOR	WALL
VCT VINYL COMPOSITE TILE	P PAINT
BASE	SUBSTRATE
RB RESILIENT BASE	C CONCRETE
	GYP GYPSUM BOARD
CEILINGS	
AT ACOUSTICAL CEILING TILE	
GENERAL NOTES	
1. EXP DENOTES EXPOSED STRUCTURE.	
2. SEE REFLECTED CEILING PLAN FOR CEILING HEIGHTS.	
3. PAINT ALL NEW METAL DOORS AND DOOR FRAMES (INCLUDING VISION PANELS IN DOORS) UNLESS NOTED. SEE PAINT SPECIFICATIONS FOR FINISH.	
4. REFER TO SPECIFICATION SECTION 090600 FOR INTERIOR AND EXTERIOR FINISHES, MATERIALS AND COLORS.	

REFLECTED CEILING PLAN LEGEND

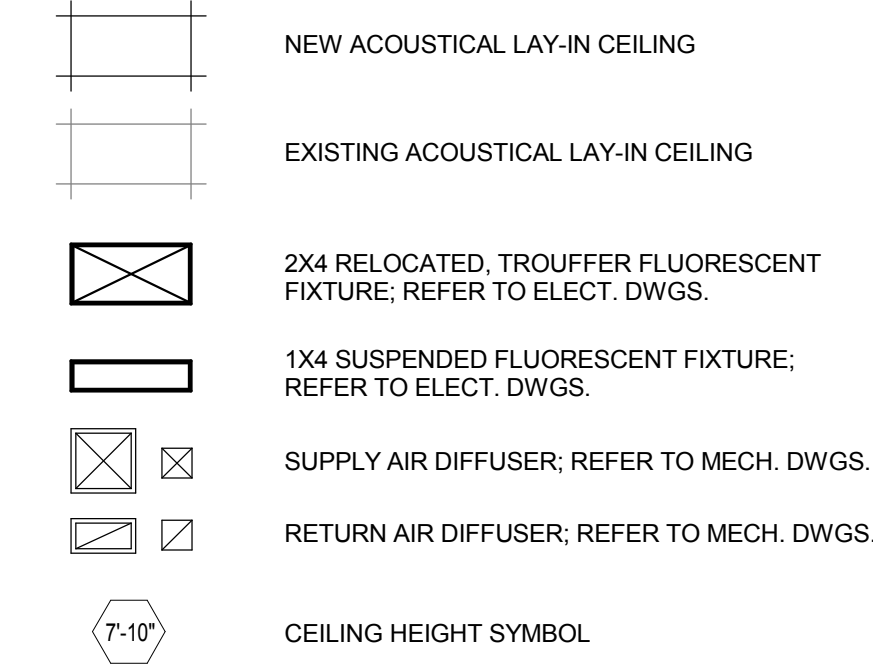

PARTITION TYPES

SCALE: 1" = 1'-0"

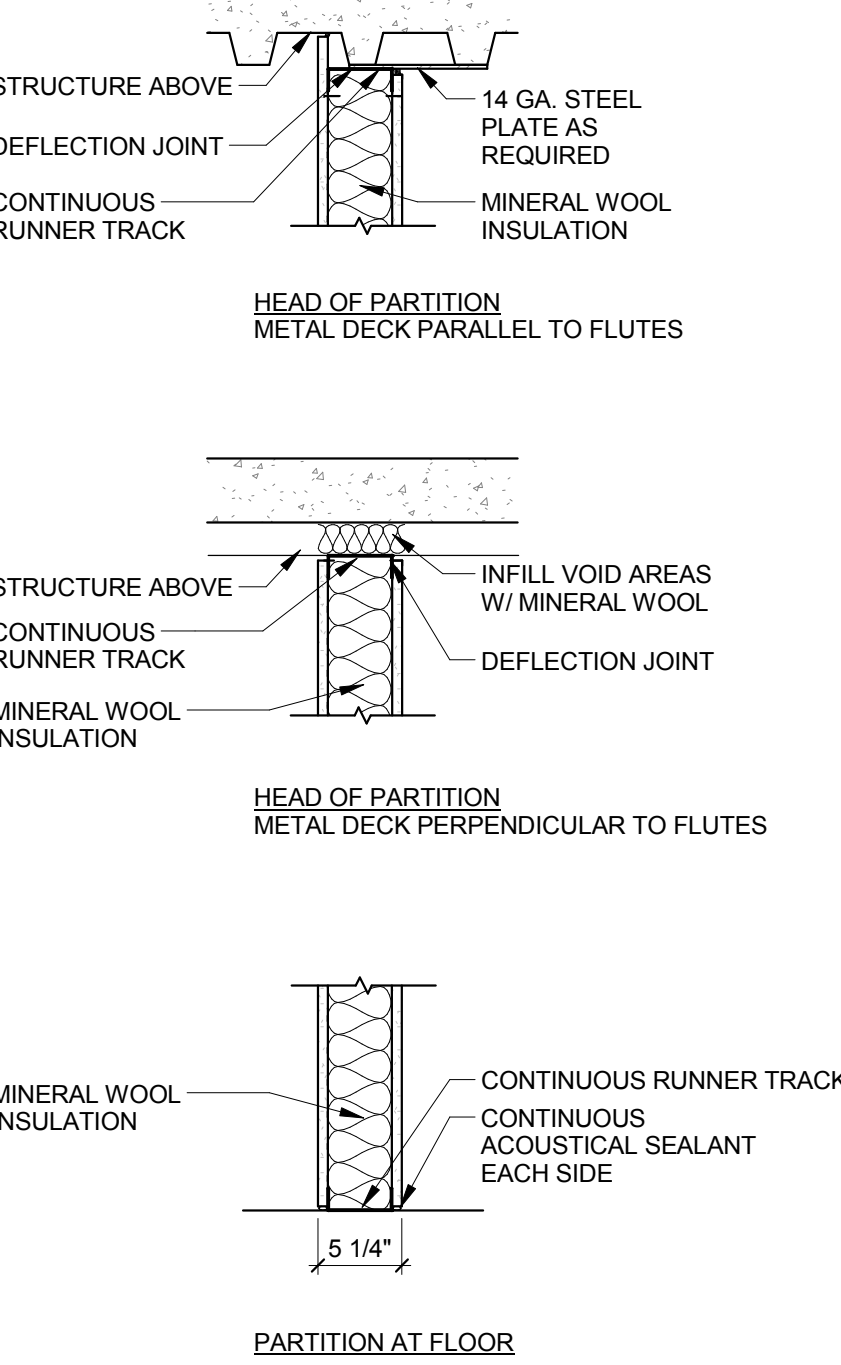

PARTITION TYPE 'C'

NON-RATED
(1) LAYER OF 5/8\"/>

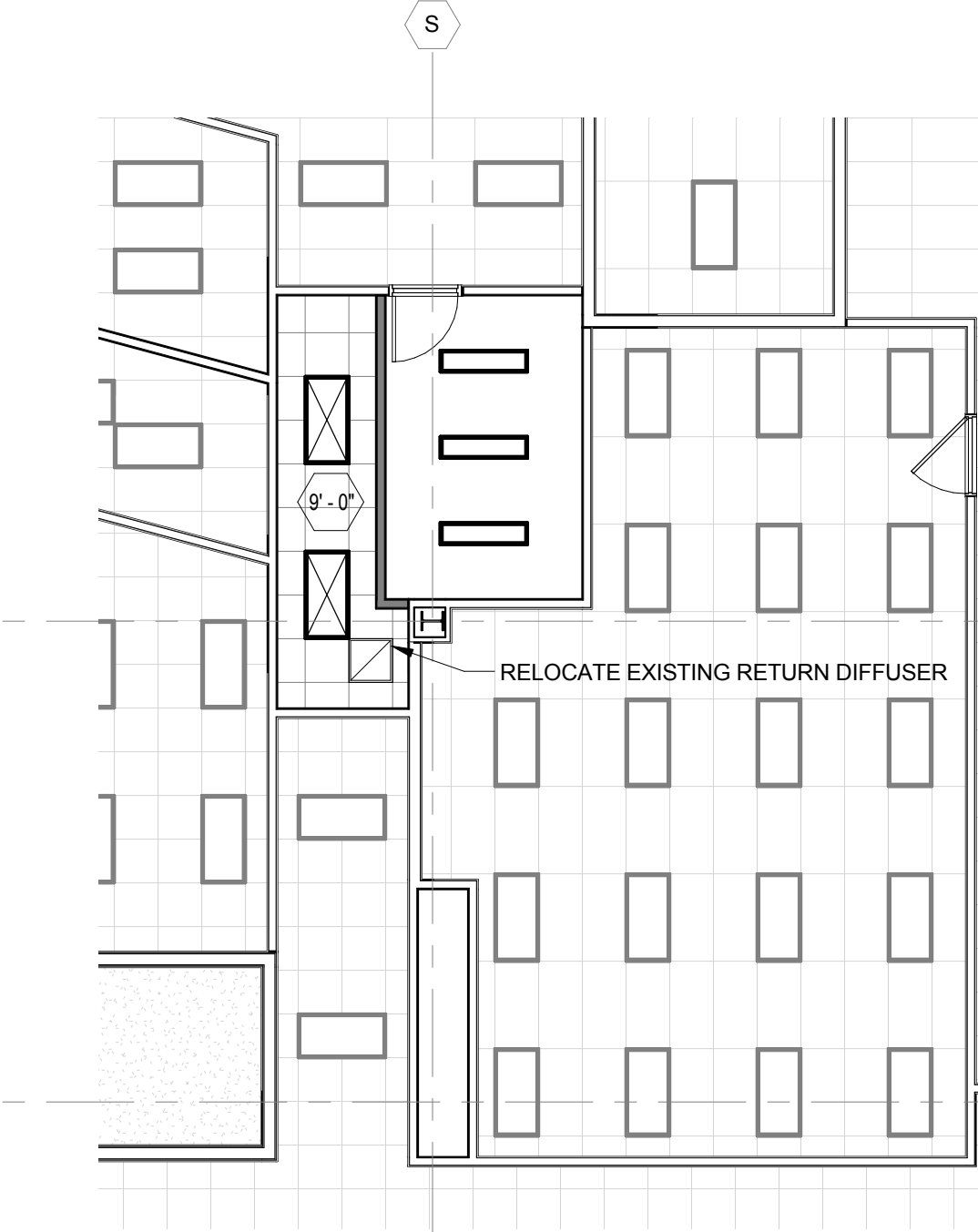

1 FOURTH FLOOR REFLECTED CEILING PLAN

SCALE: 1/8" = 1'-0"

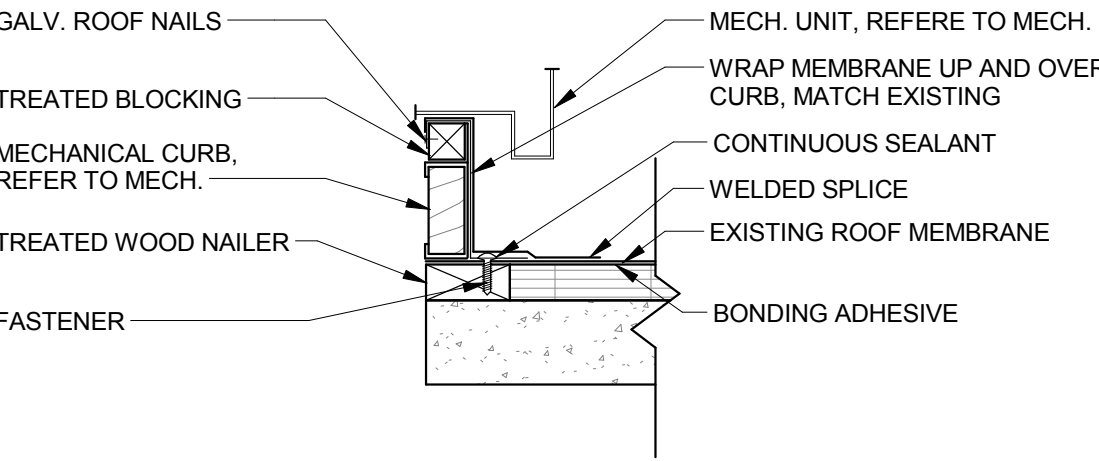

2 ROOF CURB FLASHING DETAIL

SCALE: 1 1/2" = 1'-0"

BID AND CONSTRUCTION FULLY SPRINKLERED

AMENDMENT 1
BID AND CONSTRUCTION
Revisions

01/05/2017
07/12/2016
Date

CONSULTANTS:

KEY PLAN

ARCHITECTS/ENGINEERS:

ARCHITECTURAL PROJECT 18903.00

7850 Freeway Circle
440.243.2000 t

Cleveland, OH 44130
440.243.3305 f

Drawing Title
REFLECTED CEILING PLAN, SCHEDULES, AND DETAILS

Approved: Project Director

Project Title
UPGRADE CCTV TO DIGITAL SYSTEM

Location
420 NORTH JAMES ROAD, COLUMBUS, OHIO 43219

Date
07/12/2016

Checked
JV

Drawn
SW

Project Number
757-16-102
Building Number
1

Drawing Number
A10.0
Dwg. 5 of 47

Office of Construction and Facilities Management

U.S. Department of Veterans Affairs

VA FORM 08-6231

1/4/2017 3:21:32 PM C:\newit Local Files\15051_R14_FTH_OT_compbell.rvt

AMENDMENT #1	01/05/2017
BID AND CONSTRUCTION	07/12/2016
Revisions	Date

CONSULTANTS:

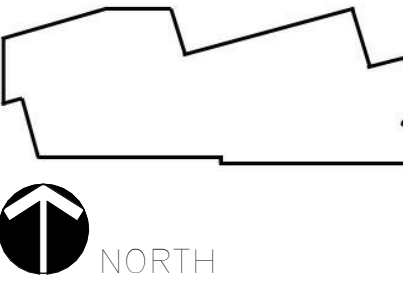

ENGINEERS
INCORPORATED

KEY PLAN



NORTH

ARCHITECTS/ENGINEERS:

7850 Freeway Circle
440.243.2000 t

Cleveland, OH 44130
440.243.3305 f

ARCHITECTURAL PROJECT 18903.00



Drawing Title

FOURTH FLOOR TELECOMMUNICATIONS
RACK DETAILS AND NOTES

Approved: Project Director

Project Title

UPGRADE CCTV TO DIGITAL
SYSTEM

Location

420 N. JAMES RD., COLUMBUS, OH 43219

Date

07/12/2016

Checked

MPL

Drawn

CPC

Project Number

757-16-102

Building Number

1

Drawing Number

E5.2

Dwg. 42 of 47

Office of
Construction
and Facilities
Management

 U.S. Department
of Veterans Affairs

FOURTH FLOOR
TR ROOM #4A041 - RACK DETAIL

1/8" = 1'-0"

0' 4' 8' 16' 32'

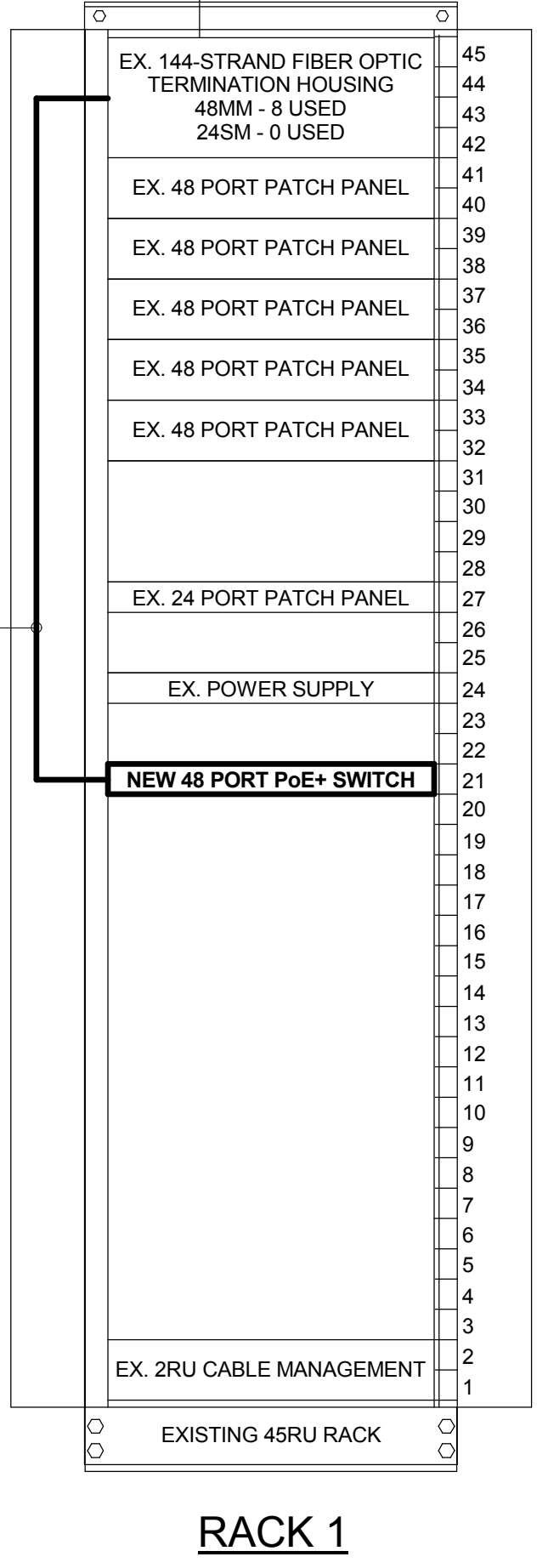

FOURTH FLOOR
SECURITY ROOM #4A003B - RACK DETAIL

1/8" = 1'-0"

0' 4' 8' 16' 32'

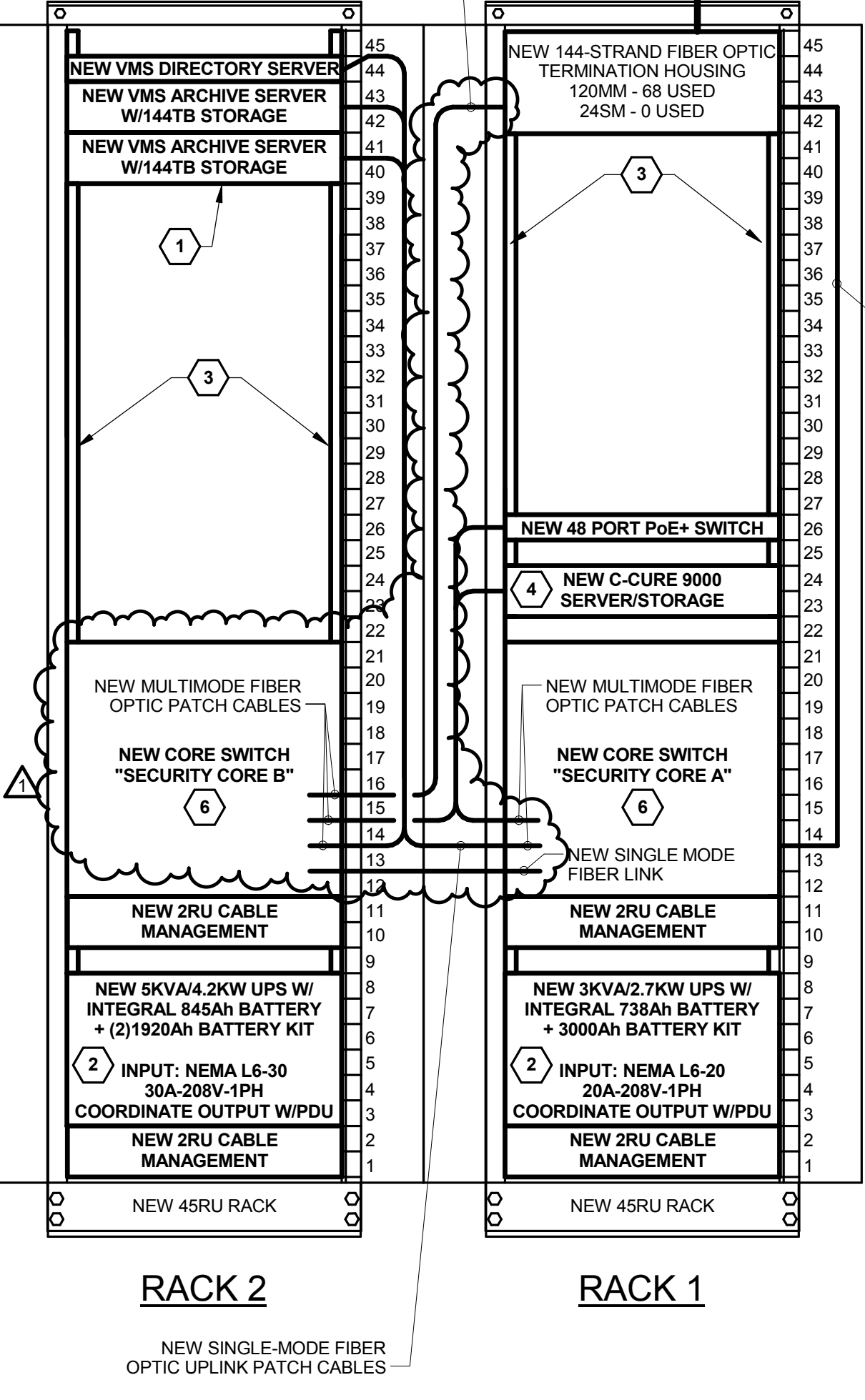

FOURTH FLOOR
MAIN TELECOM. ROOM #4A201 - RACK DETAIL

1/8" = 1'-0"

0' 4' 8' 16' 32'

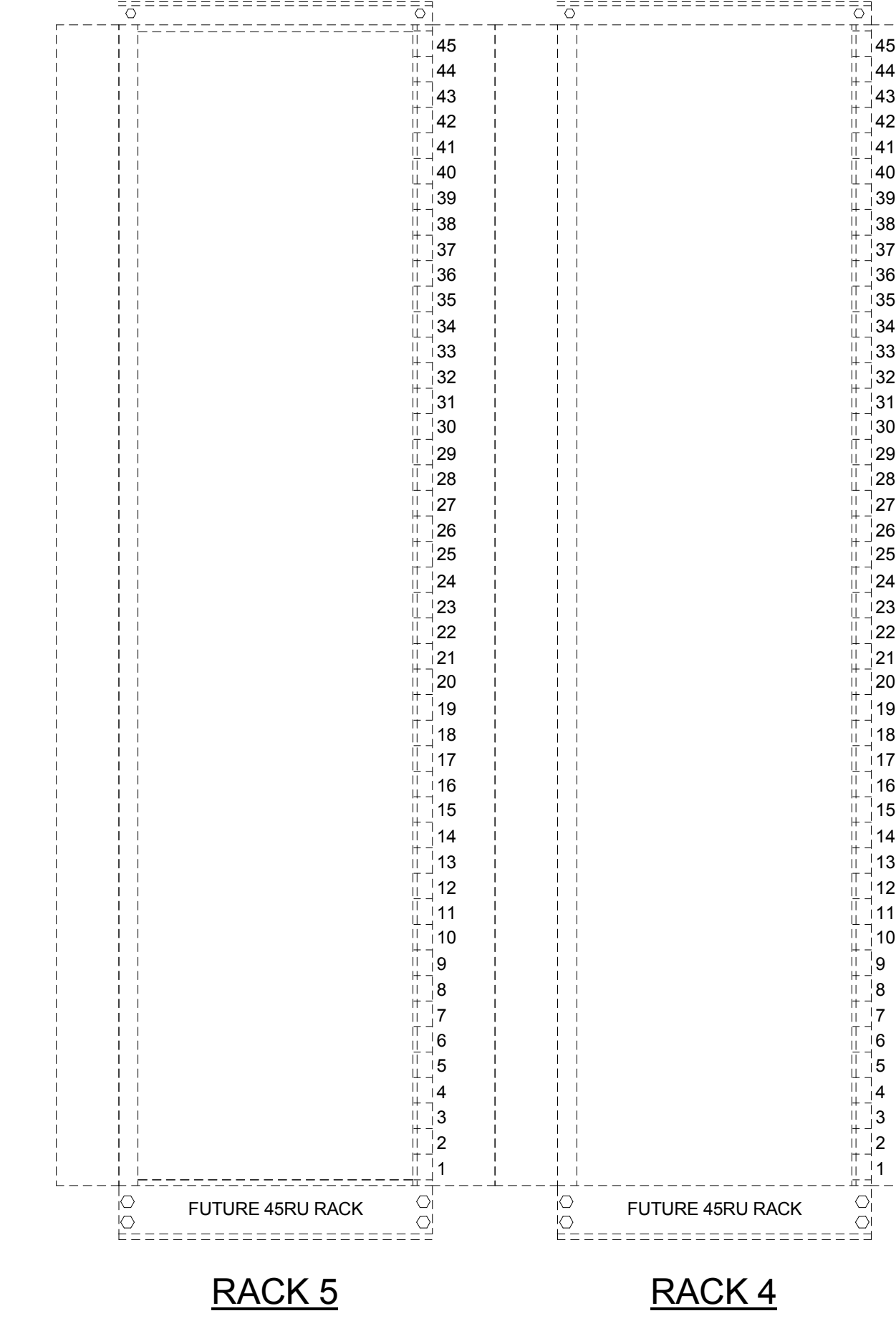
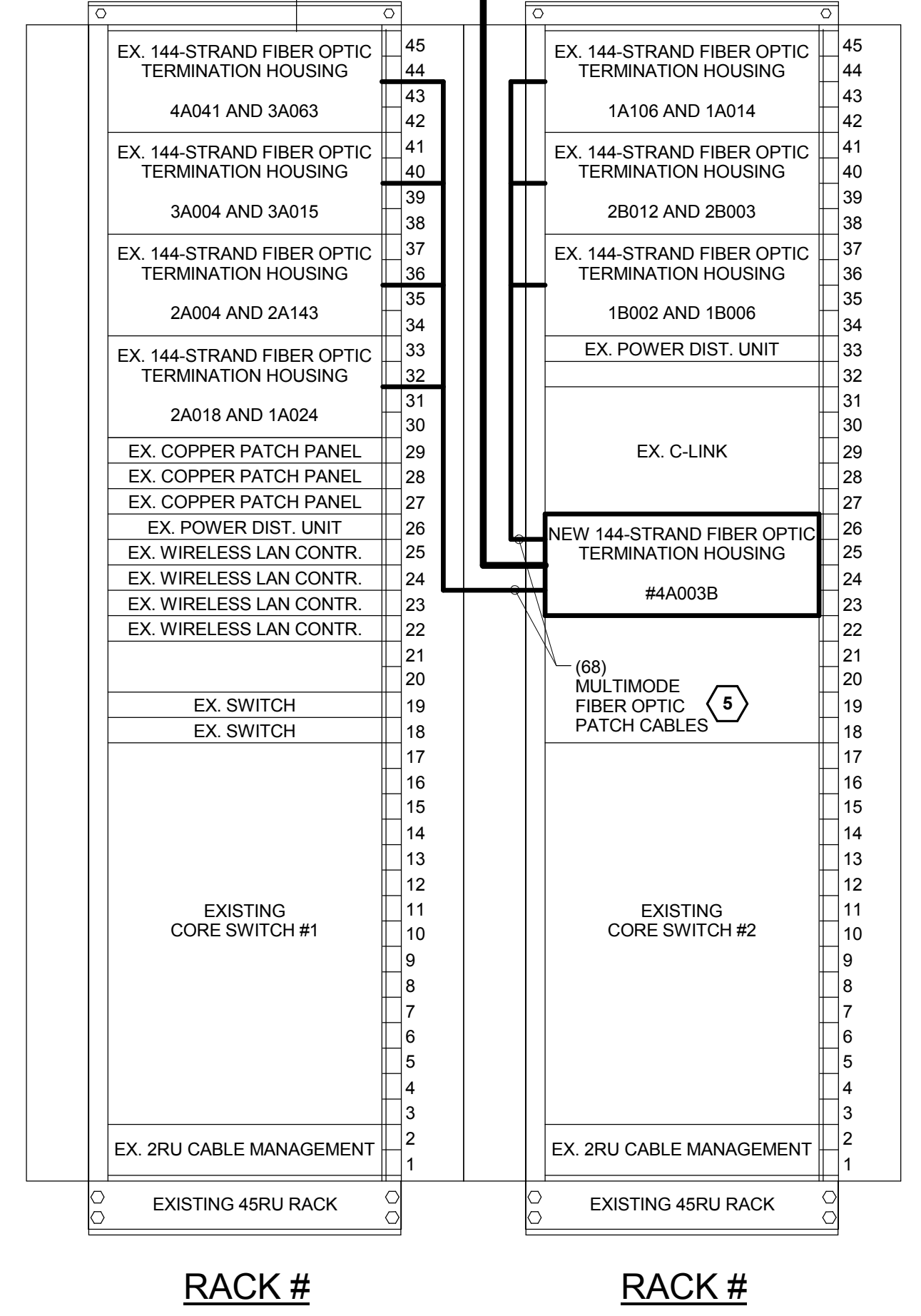

ARCHIVE SERVER SAMPLE CALCULATIONS					
VIDEO MANAGEMENT SYSTEM (VMS) ARCHIVE STORAGE CALCULATIONS SHALL BE PERFORMED BY THE CONTRACTOR. EACH VMS SYSTEM VENDOR PROVIDES CALCULATIONS FOR THEIR EQUIPMENT BASED ON CAMERA QUANTITIES, CAMERA VIDEO STREAM DATA RATES, VMS BANDWIDTH, RECORDING SPECIFICATIONS, AND OTHER FACTORS. CONTRACTOR SHALL PROVIDE STORAGE REQUIRED TO SUPPORT ALL NEW AND REPLACEMENT CAMERAS WITHIN THE SCOPE OF THIS PROJECT PLUS ADDITIONAL CAMERAS FROM FUTURE PARKING STRUCTURE PROJECT, PLUS FIFTY PERCENT (50%) ADDITIONAL SPARE CAPACITY FOR FUTURE CAMERAS. CONTRACTOR SHALL SUBMIT THE QUANTITY AND SPECIFICATIONS OF SERVERS REQUIRED TO SUPPORT CAMERAS AS PREVIOUSLY INDICATED. CONTRACTOR SHALL ACCOUNT FOR THE LIMITING FACTOR OF SERVERS (CAMERA QUANTITY, BANDWIDTH, PROCESSOR PERFORMANCE, ETC) AND SUBMIT SERVERS AS REQUIRED.					
RECORDING SPECIFICATIONS: VMS SHALL RECORD VIDEO SURVEILLANCE DATA AT FULL CAMERA RESOLUTION AND SHALL CAPTURE DATA AT 15 FRAMES PER SECOND (FPS). VMS SHALL RECORD 24 HOURS PER DAY, 7 DAYS PER WEEK, 365 DAYS PER YEAR. VMS SHALL BE CAPABLE OF RETAINING SURVEILLANCE DATA FOR A MINIMUM OF 30 DAYS. VMS SYSTEM SHALL BE CAPABLE OF RETAINING SELECT VIDEO SURVEILLANCE DATA INDEFINITELY ON A UNIQUE RECORDING DEVICE AT THE DISCRETION OF VA POLICE FOR ON-GOING INVESTIGATIONS, COURT CASES, ETC.					
SAMPLE CALCULATION NOTE: SAMPLE CALCULATION IS FOR REFERENCE ONLY. SAMPLE CALCULATION WAS PERFORMED BY A SINGLE VMS VENDOR AND IS INDICATIVE OF THE CALCULATION PROCESS BUT SHOULD NOT BE UTILIZED FOR FINAL VMS PRODUCT SUBMITTAL. CONTRACTOR SHALL PROVIDE THEIR OWN CAMERA QUANTITIES, DATA RATES, BANDWIDTH, ETC. FOR CALCULATIONS. SUBMIT STORAGE CALCULATIONS WITH SHOP DRAWINGS FOR APPROVAL.					
BASIS OF DESIGN	TYPE	QUANTITY	BANDWIDTH (Mbps/s)	BITRATE (Kbps/s)	DISK SPACE (GB)
AXIS P5515	INTERIOR PAN/TILT/ZOOM CAMERAS	126	371.58	2,949	120,394.9
AXIS Q8414-LVS	INTERIOR CORNER MOUNT FIXED CAMERAS	4	7.37	1,843	2,388.8
AXIS Q6115-E	EXTERIOR HIGH-ZOOM PAN/TILT/ZOOM CAMERAS	3	8.85	2,949	2,866.5
AXIS P5515-E	EXTERIOR STANDARD ZOOM PAN/TILT/ZOOM CAMERAS	13	38.34	2,949	12,421.7
1.2 MEGAPIXELS	FUTURE PARKING STRUCTURE CAMERAS	36	61.93	1,720	20,065.8
TOTAL 30-DAY STORAGE REQUIRED: 158,147B + 50% SPARE CAPACITY = 237,217B (MINIMUM) REQUIRED CAPACITY FOR NEW VMS SYSTEM.					

MINIMUM EQUIPMENT REQUIREMENTS	
ARCHIVE SERVER	INTEL XEON E5-2620V3, 16GB RAM, (2) 4GB 12Gb/s RAID CONTROLLERS, WINDOWS SERVER 2012, STORAGE AS REQUIRED PER CALCULATIONS
DIRECTORY SERVER	INTEL XEON E3-1240V5, 16GB RAM, 240GB SSD, NVIDIA GTX720TI
C-CURE SERVER	INTEL XEON E3-1240V5, 16GB RAM, (1) 4GB 12Gb/s RAID CONTROLLERS, (2) 300GB 15,000RPM HARD DISK DRIVES, NVIDIA GTX720TI, DVD-RW, 1G ETHERNET ADAPTER
NOTE	CONTRACTOR SHALL VERIFY SYSTEM REQUIREMENTS WITH MANUFACTURER AND WITH DESIRED SYSTEM PERFORMANCE AND SPECIFICATIONS. PROVIDE HARDWARE CAPABLE OF MEETING THE STORAGE, THROUGHPUT, VIDEO OUTPUT, ETC. REQUIRED BY THE SYSTEM.

- RACK DETAIL CODED NOTES
- CONTRACTOR SHALL PROVIDE NEW VIDEO MANAGEMENT SYSTEM (VMS) AND CONNECT COMPLETE PER MANUFACTURER'S DOCUMENTATION. PROVIDE SOFTWARE SERVER AND DATA ARCHIVE SERVERS NECESSARY FOR SYSTEM FUNCTION. SERVER QUANTITY AND STORAGE CAPACITIES ARE SHOWN FOR REFERENCE ONLY. PROVIDE QUANTITY OF SERVERS AND STORAGE CAPACITY AS CALCULATED BY VMS MANUFACTURER. REFER TO ARCHIVE SERVER SAMPLE CALCULATIONS FOR ADDITIONAL INFORMATION AND WORK REQUIREMENTS.
 - PROVIDE RACK-MOUNTED UNINTERRUPTIBLE POWER SUPPLY (UPS) FOR CONNECTION OF VIDEO MANAGEMENT SYSTEM EQUIPMENT. SIZING INDICATED IN DIAGRAM SHALL BE CONSIDERED MINIMUM REQUIREMENTS. CONTRACTOR SHALL SIZE UPS TO SUPPORT EQUIPMENT UPON LOSS OF NORMAL AND EMERGENCY POWER FOR UP TO 30 MINUTES AT FULL LOAD. REFER TO VIDEO MANAGEMENT SYSTEM EQUIPMENT DOCUMENTATION FOR POWER REQUIREMENTS. PROVIDE UPS SIZING CALCULATIONS WITH SUBMITTALS FOR APPROVAL. COORDINATE UPS OUTPUT WITH POWER DISTRIBUTION UNITS.
 - PROVIDE (2) NEW RACK MOUNTED VERTICAL POWER DISTRIBUTION UNITS (PDU) FOR CONNECTION TO VIDEO MANAGEMENT SYSTEM EQUIPMENT. (1) VERTICAL PDU SHALL BE RESERVED FOR FUTURE USE WITH REDUNDANT POWER SOURCE. COORDINATE WITH UPS SPECIFICATION FOR HARDWARE CONNECTION AND LOAD SIZING. POWER DISTRIBUTION UNITS SHALL HAVE INTEGRAL METERING AND RECEPTACLES COMPATIBLE WITH SERVER CORD AND PLUG.
 - CONTRACTOR SHALL PROVIDE NEW SOFTWARE HOUSE C-CURE 9000 R SERIES SERVER. SOFTWARE CLIENT AND ALL REQUIRED INSTALLATION AND PROGRAMMING. UPGRADE EXISTING C-CURE 800 DATABASE/SOFTWARE TO C-CURE 9000R SERIES AND MIGRATE EXISTING DATA PER MANUFACTURER'S DOCUMENTATION (DATA MIGRATION REQUIRES INCREMENTAL UPGRADES FROM C-CURE 800 TO C-CURE 9000 Q SERIES TO C-CURE 9000 R SERIES). CONTRACTOR SHALL PROVIDE ADDITIONAL PROGRAMMING REQUIRED TO MIGRATE PORTIONS OF DATA MANUALLY WHEN SOFTWARE AUTOMATED MIGRATION IS NOT AVAILABLE. ALL VA FACILITY PERSONALIZATION (SURVEILLANCE CAMERA IDENTIFICATION, ACCESS CONTROL IDENTIFICATION, SURVEILLANCE CAMERACAPACCESS CONTROL ASSOCIATION, ETC.) IS TO BE PROGRAMMED BY CONTRACTOR/VENDOR AND SHALL NOT BE THE RESPONSIBILITY OF THE VA.
 - PROVIDE MULTIMODE FIBER OPTIC PATCH CABLE TO PATCH DARK FIBER IN EXISTING TELECOMMUNICATIONS CLOSETS OVER TO NEW SURVEILLANCE EQUIPMENT RACKS TO SERVE NEW POE SURVEILLANCE SWITCHES. PROVIDE UPDATED FIBER TERMINATION BOX DIRECTORIES AFTER COMPLETION OF WORK.
 - CONTRACTOR SHALL PROVIDE NEW SECURITY/SURVEILLANCE SYSTEM NETWORK CORE SWITCHES. PROVIDE ALL GBICS, ACCESSORIES AND PROGRAMMING REQUIRED FOR A COMPLETE INSTALLATION. REFER TO SECURITY/VIDEO SURVEILLANCE NETWORK DIAGRAM FOR ADDITIONAL INFORMATION AND WORK REQUIREMENTS.