

three inches = one foot  
one and one-half inches = one foot  
one inch = one foot  
three-quarters inch = one foot  
one-half inch = one foot  
three-eighths inch = one foot  
one-quarter inch = one foot  
one-eighth inch = one foot

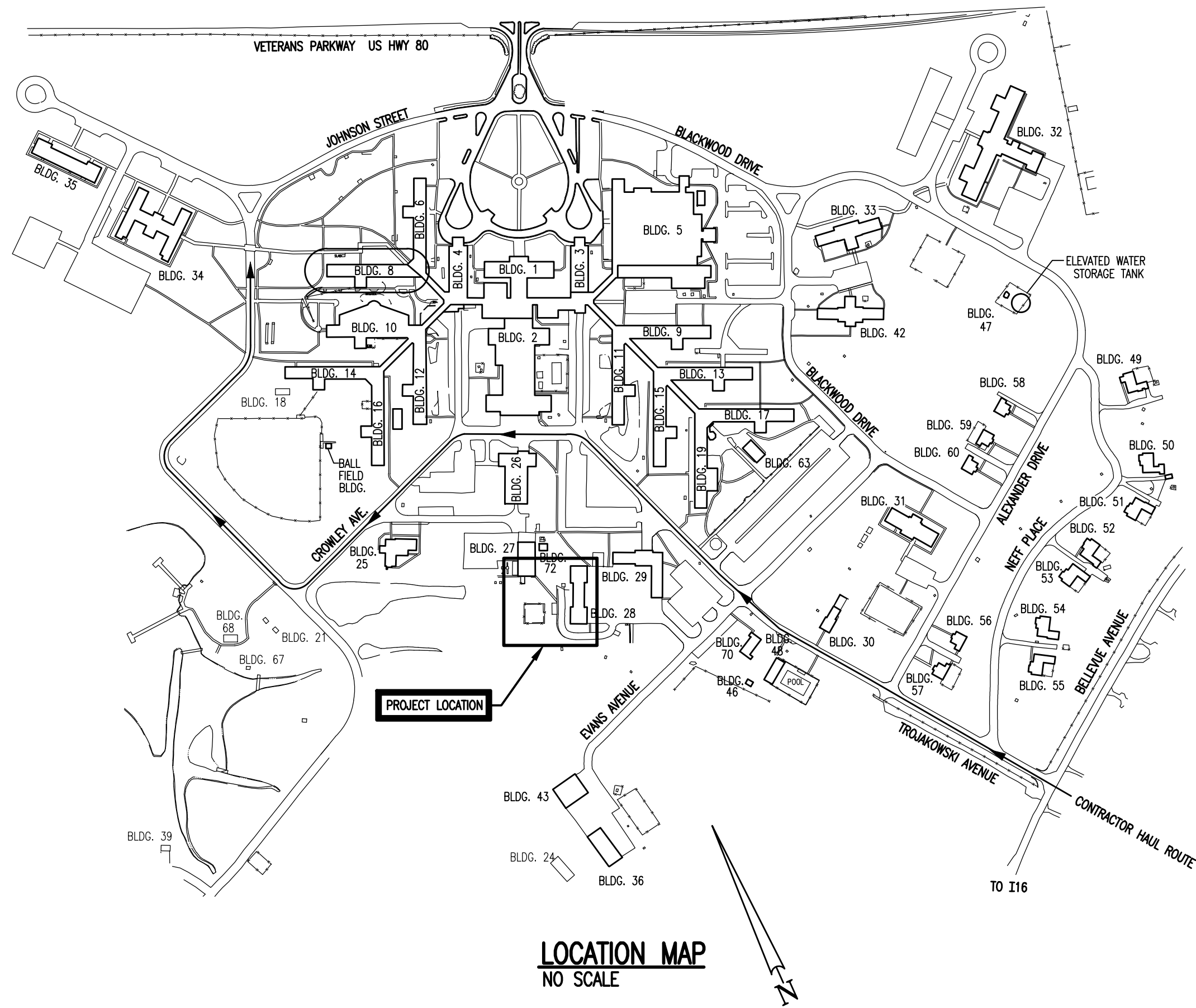

# CARL VINSON V.A. MEDICAL CENTER

## DUBLIN, GEORGIA

### CONNECT 500 TON CHILLER TO EES

#### PROJECT No. 557-09-109

| INDEX OF DRAWINGS |          |  | PROJECT GENERAL NOTES  |  |  | BID ALTERNATES  |  |  |  |  |  |
|-------------------|----------|--|--|--|--|---|--|--|--|--|--|
| SHEET. NO.        | DWG. NO. | DRAWING TITLE                                      |  |  |  |   |  |  |  |  |  |
| 1.                | X1.1     | COVER SHEET: GENERAL NOTES, SITE MAP & SHEET INDEX | <p>① THE CONTRACTOR SHALL SUBMIT A WRITTEN SCHEDULE OF WORK TO THE COTR FOR APPROVAL WHICH DETAILS CONSTRUCTION START AND CONSTRUCTION COMPLETION. PROVIDE WORK FLOW PLANS AND SCHEDULE OF WORK PRIOR TO STARTING ANY WORK.</p> <p>② THE CONTRACTOR SHALL NOT BE ALLOWED TO DRIVE OR PARK ON ANY PROPERTY OTHER THAN VA ROADS AND ASSIGNED AREAS WITHOUT CONSENT OF COTR.</p> <p>③ THE CONTRACTOR SHALL LOCATE ALL STORAGE TRAILERS AND OFFICE TRAILERS IN DESIGNATED AREA(S) TO BE DETERMINED BY COTR.</p> <p>④ THE CONTRACTOR SHALL INSURE THAT NO SMOKING IN OTHER THAN AREAS OFFICIALLY MARKED AS SMOKING AREAS WILL BE PERMITTED ON VA PREMISES.</p> <p>⑤ THE CONTRACTOR SHALL UNDER NO CIRCUMSTANCES INSTALL ANY WORK ON VA PREMISES THAT CONTAINS LEAD.</p> <p>⑥ THE CONTRACTOR SHALL INSURE THAT EACH WORKER WILL BE REQUIRED TO WEAR APPROPRIATE SAFETY EQUIPMENT AT ALL TIMES (I.E. SAFETY SHOES, EAR PLUGS, SAFETY GLASSES OR GOGGLES, SAFETY HELMET, ETC.) AND IS RESPONSIBLE TO ENSURE THAT NON-WORKERS ARE PREVENTED FROM INJURING THEMSELVES IN ANY WORK AREA.</p> <p>⑦ THE CONTRACTOR SHALL NOT INSTALL ANY MATERIALS OR EQUIPMENT UNTIL SUBMITTALS FOR SUCH HAVE BEEN APPROVED IN WRITING BY BOTH THE A/E AND THE VA.</p> <p>⑧ THE CONTRACTOR SHALL INSURE THAT ALL TOOLS USED IN THIS PROJECT BE PROPERLY SECURED AT ALL TIMES TO PREVENT ANY OF THESE TOOLS BEING A HAZARD TO PATIENTS.</p> <p>⑨ ALL AREAS THAT ARE DISTURBED DUE TO DIRECT OR INDIRECT CONSTRUCTION OPERATIONS SHALL BE RESTORED BY THE CONTRACTOR TO A CONDITION EQUAL TO OR BETTER THAN THE CONDITION PRIOR TO BEING DISTURBED. EXISTING INSIDE STRUCTURES, CEILINGS, WALLS, FLOORS, ETC. AND OUTSIDE UNDERGROUND UTILITIES SHALL BE PROTECTED AT ALL TIMES. DAMAGES CAUSED BY NEW WORK SHALL BE REPAIRED BY THE CONTRACTOR AT NO COST TO THE VA. ANY DAMAGES SHALL BE REPAIRED AND RESTORED TO ORIGINAL CONDITION.</p> <p>⑩ THE CONTRACTOR SHALL ARRANGE FOR ALL EQUIPMENT AND MATERIAL DELIVERIES FOR THIS PROJECT EITHER BE MADE AT THE CONTRACTOR'S STORAGE SITE, OR AT THE SPECIFIC INSTALLATION OR USAGE SITE. ALL EQUIPMENT MATERIAL AND PRODUCTS WILL BE RECEIVED <u>ONLY</u> BY THE CONTRACTOR UPON DELIVERY AND WILL NOT BE RECEIVED OR HANDLED BY THE VA.</p> <p>⑪ THE CONTRACTOR MUST PROVIDE RED LINE AS-BUILTS TO THE A/E A MINIMUM OF TWO WEEKS BEFORE REQUESTING FINAL INSPECTION. A COPY OF THE TRANSMITTAL IS TO BE SENT TO THE COTR CONCURRENTLY.</p> <p>⑫ THE CONTRACTOR WILL BE RESPONSIBLE FOR ACQUIRING I.D. BADGES FOR EACH MEMBER OF HIS WORK FORCE BEFORE ANY MEMBER WILL BE ALLOWED TO PERFORM WORK ON VA PREMISES. SEE COTR.</p> <p>⑬ THE CONTRACTOR SHALL PICK UP A COPY OF A BLANK "HOT WORK" PERMIT FROM THE COTR AND MAKE APPROPRIATE COPIES TO ALLOW HOT WORK PERMITS TO BE FILLED OUT BY THE CONTRACTOR AND SIGNED BY THE COTR BEFORE ANY "HOT WORK" IS DONE. PERMIT REQUESTS SHALL BE SUBMITTED A MINIMUM OF 72 HOURS IN ADVANCE OF SCHEDULED WORK.</p> <p>⑭ THE CONTRACTOR SHALL INSURE THAT ANY SMOKE DETECTORS HAVING ANY POTENTIAL FOR EXPOSURE TO CONSTRUCTION SMOKE, DUST &amp; DEBRIS SHALL BE SUITABLY ATTENDED TO, TO PREVENT ACCIDENTAL ALARM. ALL SUCH ACTION MUST BE FIRST COORDINATED AND CLEARED WITH COTR, THE VA SAFETY MANAGER, AND THE VA SAFETY SPECIALIST. ALL FIRE ALARM DEVICES SHALL BE ACTIVE WHEN CONTRACTOR'S FORCES ARE VACANT FROM ANY AREA AT ANY TIME.</p> <p>⑮ WHEN IT IS NECESSARY TO BARRICADE AN AREA FOR EXCAVATION, MOVING EQUIPMENT, ETC. BARRICADES AND OTHER RESTRICTIONS AND/OR WARNING DEVICES ARE TO BE PROVIDED BY THE CONTRACTOR. CLOSURES OF STREETS, PARKING LOTS AND OTHER TRAFFIC AREAS WILL NOT BE PERMITTED UNLESS APPROVED BY THE COTR.</p> <p>⑯ NEW WORK SHALL BE STAGED OR PERFORMED TO PROVIDE MINIMUM INTERRUPTIONS OF SERVICE TO ESSENTIAL BUILDINGS.</p> <p>⑰ PRIOR TO INTERRUPTION OF ANY SERVICE TO FIRE PROTECTION SYSTEMS OR HYDRANTS, THE CONTRACTOR SHALL SUBMIT A WRITTEN SCHEDULE AND PLAN TO THE COTR AND LOCAL FIRE OFFICIAL FOR REVIEW AND APPROVAL. NO WORK ON SUCH SYSTEMS OR HYDRANTS SHALL BE PERFORMED WITHOUT WRITTEN APPROVAL.</p> |  |  | STATEMENT OF BID ITEM(S)  |  |  |  |  |  |
| 2.                | E1.1     | DETAILS - ELECTRICAL                               |  |  |  |   |  |  | ITEM 1, GENERAL CONSTRUCTION: FURNISH ALL TOOLS, LABOR MATERIALS, EQUIPMENT, PERMITS, LICENSES, AND SUPERVISION FOR "CONNECT 500 TON CHILLER TO EES", PROJECT NUMBER 557-09-109, LOCATED AT THE CARL VINSON VA MEDICAL CENTER IN DUBLIN, GA., IN ACCORDANCE WITH THE DRAWINGS AND SPECIFICATIONS TO PROVIDE CONNECTION FROM AN EXISTING COMBINATION 2,000KW, 480/277 VOLT PAD-MOUNTED EMERGENCY GENERATOR AND EXISTING 2500KVA PAD-MOUNTED, OIL-FILLED, 3 PHASE, 480/4,160 VOLT UTILITY TYPE TRANSFORMER TO A 4,160 VOLT AUTOMATIC TRANSFER SWITCH INCLUDING ALL PRIMARY MEDIUM VOLTAGE AND CONTROL WIRING AND CONDUIT. THE PROJECT INCLUDES INSTALLATION OF AN ALARM SYSTEM CONNECTION FOR AN EXISTING 10,000 GALLON, PAD-MOUNTED, DIESEL FUEL TANK; INSTALLATION AND CONNECTION OF A GENERATOR ANNUNCIATOR (EXISTING, RETAINED AND PROVIDED BY THE VA) FOR THE EXISTING GENERATOR (INSTALLATION OF THE ANNUNCIATOR TO BE ACCOMPLISHED BY THE MANUFACTURER OF THE EXISTING GENERATOR WITH ALL COSTS TO BE INCLUDED IN THIS CONTRACT.); PLUS ALL REQUIRED SAFETY AND OPERATING CONTROL AND ALARM WIRING FROM THE 4,160 VOLT AUTOMATIC TRANSFER SWITCH TO GENERATOR CONTROLLER, ANNUNCIATOR AND MECHANICAL CONTROL SYSTEMS. |  |  |
| 3.                | E1.2     | DETAILS - ELECTRICAL                               |  |  |  |   |  |  | ITEM 2, SPLICING OF THE EXISTING 4,160V CABLE TO CONNECT TO NEW MEDIUM VOLTAGE ATS WILL REQUIRE THE CONTRACTOR TO SWITCH THE EXISTING CHILLER PLANT FROM THE FEEDER TO BE SPLICED TO AN ALTERNATE FEED WHILE SPLICING, CONNECTION TO THE NEW ATS, AND TESTING ARE COMPLETED SEE ONE-LINE DIAGRAM, SHEET E1.2.  |  |  |
| 4.                | E3.1     | SITE PLAN - ELECTRICAL                             |  |  |  |   |  |  |  |  |  |
|                   |          |  | <p>Medical Center Director:</p> <p>Associate Director:</p> <p>Chief of Staff:</p> <p>Assoc. Dir. for Patient Services:</p> <p>service Line Mgrs. for Affected Area:</p>  |  |  | <p>Recommended Approvals:</p> <p>Operations Service Line Manager:</p> <p>Infection Control:</p> <p>Safety Manager:</p> <p>General Engineer:</p> <p>COTR:</p>                        |  |  |  |  |  |
|                   |          |  | <p>Utility Foreman:</p>  |  |  | <p>Drawing Title</p> <p>COVER SHEET: GENERAL NOTES, SITE MAP &amp; SHEET INDEX</p> <p>Approved Project Director</p> <p>FINAL SUBMITTAL</p>  |  |  |  |  |  |
|                   |          |  |  |  |  | <p>Project Title</p> <p>CONNECT 500 TON CHILLER TO EES</p> <p>Building Number</p> <p>Checked PJC</p> <p>Drawn RFB</p> <p>Location CARL VINSON VA MEDICAL CENTER DUBLIN, GEORGIA</p> |  |  |  |  |  |
|                   |          |  |  |  |  | <p>Date</p> <p>January 27 2012</p> <p>Project No.</p> <p>557-09-109</p> <p>Drawing No.</p> <p>X1.1</p> <p>Dwg. 1 Of 4</p>   |  |  |  |  |  |

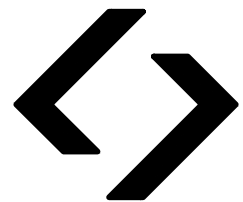

APPLIED  
ENGINEERING  
SOLUTIONS, INC.

440 Martin Luther King, Jr. Blvd., Suite 101A  
Macon, Georgia 31201  
(478) 314-1270  
www.aes-pe.com

TECHNICON  
ENGINEERS/ARCHITECTS  
MACON & ATLANTA

Veterans  
Administration