

IF THIS SHEET IS NOT 30" x 42" FULL SIZE, USE GRAPHIC SCALES

one inch = one foot

three-quarter inch = one foot

one-half inch = one foot

three-eighths inch = one foot

one-quarter inch = one foot

one-eighth inch = one foot

## GENERAL NOTES

- ALL WORK SHALL CONFORM TO ALL FEDERAL, STATE LOCAL RULES, LAWS, REGULATIONS, VETERANS AFFAIRS (VA) SPECIFICATION. ALL PLUMBING WORK SHALL CONFORM TO NATIONAL PLUMBING CODE, ALL ELECTRICAL WORK SHALL CONFORM TO NATIONAL ELECTRICAL CODE, AND ALL HEATING AND VENTILATING WORK SHALL COMPLY WITH AMERICAN SOCIETY OF HEATING, REFRIGERATING AND AIR-CONDITIONING ENGINEERS (ASHRAE) STANDARDS.
- BEFORE BEGINNING ANY CUTTING OR DEMOLITION WORK, THE CONTRACTOR SHALL CAREFULLY SURVEY THE EXISTING CONDITIONS AND DETERMINE THE EXTENT OF THE WORK TO BE DONE. THE CONTRACTOR SHALL INSURE THAT STRUCTURAL ITEMS ARE NOT WEAKENED AND SHALL BE RESPONSIBLE FOR INCREASING OR ADDING STRUCTURAL SUPPORTS AS MAY BE REQUIRED AS A RESULT OF ANY CUTTING, REMOVAL OR DEMOLITION WORK.
- CONTRACTOR SHALL REMOVE COMPLETELY AND TERMINATE ALL EXPOSED MECHANICAL, ELECTRICAL OR PLUMBING ITEMS NOT INDICATED OR NECESSARY FOR THE FUNCTION ABILITY OF THE NEW DESIGNS.
- SHUT-DOWN AND TIE-INS: 72 HOUR MINIMUM NOTICE SHALL BE GIVEN THE CONTRACTING OFFICER IN WRITING FOR ALL SHUT-DOWNS OR TIE-INS. SHUT-DOWNS AND TIE-INS SHALL BE DONE AT SUCH TIMES AND HOURS SO AS NOT TO INTERFERE WITH THE VETERANS AFFAIRS OPERATION. ALL OVERTIME EXPENSES REQUIRED FOR SHUT-DOWNS AND TIE-INS SHALL BE BORNE BY THE CONTRACTOR.
- REMOVALS SHALL BE PERFORMED WITHOUT DAMAGE TO ADJACENT RETAINED WORK, HOWEVER WHERE SUCH WORK IS DAMAGED, THE CONTRACTOR SHALL PATCH, REPAIR OR OTHERWISE RESTORE DAMAGED ITEMS TO THE SATISFACTION OF THE CONTRACTING OFFICER.
- THE CONTRACTOR SHALL VERIFY ALL DIMENSIONS AND CONDITIONS IN THE FIELD. DISCREPANCIES BETWEEN ACTUAL CONDITIONS AND DRAWINGS AND/OR SPECIFICATIONS SHALL BE REPORTED TO THE CONTRACTING OFFICER IN WRITING FOR CLARIFICATION. WORK SHALL NOT PROCEED UNTIL SUCH CLARIFICATION HAS BEEN RECEIVED.
- SHOULD UNFORESEEN CONDITIONS OR OTHER CAUSES NECESSITATE CONSTRUCTION DETAILS NOT IN ACCORDANCE WITH THESE PLANS, THE CONTRACTOR SHALL NOTIFY THE CONTRACTING OFFICER AND SUBMIT HIS DETAILS SHOWING THE PROPOSED METHODS TO ACCOMPLISH THE REQUIRED RESULTS.
- THE CONTRACTOR SHALL BE RESPONSIBLE FOR ALL PATCHING, REPAIRING AND FINISHING OF ALL DISTURBED AREAS. PATCHING OF SURROUNDING AREAS SHALL BE WITH MATERIALS TO MATCH EXISTING.
- PROTECTION OF PERSONNEL: WHERE THE SAFETY OF PEDESTRIANS AND DRIVERS ARE ENDANGERED IN THE AREA OF REMOVAL WORK, BARRICADES FOR TRAFFIC SHALL BE USED AND ADVANCED NOTICE SHALL BE GIVEN TO THE CONTRACTING OFFICER PRIOR TO BEGINNING ANY SUCH WORK.
- THE CONTRACTOR SHALL CLEAN UP AND REMOVE DEBRIS FROM THE WORK SITE DAILY.
- THE CONTRACTOR SHALL MAINTAIN ACCESS TO EXISTING EXITS.
- CONTRACTOR RESTRICTIONS: THE CONTRACTOR SHALL CHECK WITH AND RECEIVE APPROVAL FROM THE CONTRACTING OFFICER FOR ROUTES OF ACCESS AND SUPPLY STORAGE AREAS REGARDING THE GENERAL WORK AREA WITHIN THIS CONTRACT. VA DOES NOT PROVIDE STORAGE AREAS FOR CONTRACTORS TO STORE MATERIAL ON SITE.
- ALL BIDDERS AND CONTRACTORS ARE RECOMMENDED TO VISIT THE SITE BEFORE SUBMITTING BIDS, TO INSPECT THE PREMISES AND VIEW THE EXISTING CONDITIONS TO VERIFY ALL CONDITIONS, SIZES AND QUANTITIES. PLANS ARE FURNISHED TO INDICATE THE SCOPE OF THE INTENDED CONTRACT WORK. EXISTING CONDITIONS WHICH MIGHT PRECLUDE OR INTERFERE WITH THE PROPOSED WORK AS DRAWN OR SPECIFIED SHALL BE BROUGHT TO THE ATTENTION OF THE CONTRACTING OFFICER FOR RESOLVING. RELOCATIONS MUST BE CHECKED TO VERIFY THEIR FEASIBILITY IN ACCORDANCE WITH THE NEW REQUIREMENTS.
- ALL NEW PENETRATIONS THRU EXISTING CONSTRUCTION SHALL BE PERFORMED IN A NEAT AND WORKMANLIKE MANNER. CARE SHALL BE TAKEN TO PROVIDE STRAIGHT AND CLEAN CUTS. PATCH TO MATCH EXISTING ADJACENT CONSTRUCTION. PROVIDE NEW WATERPROOFING TO MATCH EXISTING AS REQUIRED.
- THE CONSTRUCTION DOCUMENT DRAWINGS SHOW PRINCIPAL AREAS WHERE WORK MUST BE ACCOMPLISHED UNDER THIS CONTRACT. INCIDENTAL WORK MAY ALSO BE NECESSARY IN AREAS NOT SHOWN ON THE DRAWINGS DUE TO CHANGES AFFECTING EXISTING MECHANICAL, ELECTRICAL, PLUMBING, OR OTHER SYSTEMS. SUCH INCIDENTAL WORK IS ALSO A PART OF THIS CONTRACT. INSPECT THOSE AREAS, AND ASCERTAIN WORK NEEDED, AND DO THAT WORK IN ACCORDANCE WITH THE CONTRACT REQUIREMENTS, AT NO ADDITIONAL COST.
- TRADE, PRODUCT, OR MANUFACTURER'S NAMES OR CATALOG NUMBERS SHOWN ON THE DRAWINGS FOR NEW PRODUCTS ARE TO ESTABLISH QUALITY REQUIRED. IN EACH CASE ADD, BY INFERENCE, AFTER TRADE, PRODUCT, OR MANUFACTURER'S NAME, THE PHRASE "OR APPROVED EQUAL."
- PROTECT EXISTING WORK TO REMAIN FROM DAMAGE.
- WHERE CUTTING OF EXISTING SURFACES OR REMOVAL OF EXISTING FINISHES IS REQUIRED TO PERFORM THE WORK UNDER THIS CONTRACT, AND A NEW FINISH IS NOT INDICATED, FILL RESULTING OPENINGS AND PATCH THE SURFACE AFTER DOING THE WORK, AND FINISH TO MATCH ADJACENT EXISTING SURFACES.
- ALL WORK SHALL BE PERFORMED, MONDAY THRU FRIDAY, DURING NORMAL BUSINESS HOURS OF 8:00AM - 4:30PM, EXCEPT SATURDAY, SUNDAY AND HOLIDAYS, EXCEPT AS APPROVED BY THE CONTRACTING OFFICER. THE CONTRACTOR SHALL BE REQUIRED TO WORK PRIME TIME AND OVERTIME TO COMPLETE OR CONSTRUCT PORTIONS OF THIS WORK. THIS SHALL BE AS DIRECTED BY THE CONTRACTING OFFICER AT NO ADDITIONAL COST TO THE GOVERNMENT.
- CONTRACTOR SHALL ABIDE BY THEIR OWN EXPENSE TO THE LATEST EDITIONS OF ALL OSHA REGULATIONS AND REQUIREMENTS.
- CONTRACTOR SHALL BE RESPONSIBLE TO VERIFY AND ASCERTAIN IN THE FIELD, ALL EXISTING UTILITIES, EXISTING CONDITIONS, FIELD MEASUREMENTS, DIMENSIONS, QUANTITIES, RELATED TO THE PROJECT.
- CONTRACTOR SHALL PROVIDE TRAFFIC CONTROL DURING CONSTRUCTION.
- CONTRACTOR SHALL SUBMIT FOR APPROVAL ALL MATERIALS USED FOR CONSTRUCTION AND ALL EQUIPMENT INTENDED FOR INSTALLATION IN THIS PROJECT, PRIOR TO START OF CONSTRUCTION.
- THE CONTRACTOR SHALL BE RESPONSIBLE TO VERIFY AND ASCERTAIN THE LOCATION, DIRECTION, SIZE, OF ANY AND ALL UTILITIES EXISTING IN THE GENERAL VICINITY OF THE WORK AREA.  
IT SHALL BE THE CONTRACTOR'S RESPONSIBILITY TO REPAIR ANY UTILITY DISRUPTED, BROKEN, OR OTHERWISE RENDERED NON-FUNCTIONABLE DUE TO THE WORK PERFORMED AT NO ADDITIONAL COST TO THE GOVERNMENT DURING THIS COURSE OF WORK.  
THE CONTRACTOR SHALL IDENTIFY ANY NON-FUNCTIONING UTILITY/SYSTEM, PRIOR TO THE START OF WORK TO THE CONTRACTING OFFICER. IDENTIFICATION OF SUCH AFTER THE START OF WORK SHALL BE DEEMED AS DISTURBED/DAMAGED BY THE CONTRACTOR AND SHALL BE REPAIRED AT THE EXPENSE OF THE CONTRACTOR.
- IT SHALL BE THE CONTRACTOR'S RESPONSIBILITY TO PROPERLY SUPPORT ANY UTILITY ENCOUNTERED IN THE COURSE OF THIS WORK.
- THE CONTRACTOR SHALL LEAVE THE WORK SITE CLEAN AND SECURED AT THE END OF EACH WORKING DAY. THE WORK SITE SHALL NOT BE LEFT UNATTENDED AT ANY TIME BY THE CONTRACTOR, UNLESS THE WORK AREA IS PROPERLY SECURED BY THE CONTRACTOR.
- THE CONTRACTOR IS ADVISED THAT THEY ARE SOLELY RESPONSIBLE FOR THE SAFETY OF THE WORKSITE AND TAKE ALL ACTIONS TO ELIMINATE ANY SAFETY HAZARDS THAT SHALL EXIST AND POSE A THREAT OF HARM TO PATIENTS, EMPLOYEES OF THE CONTRACTOR OR OTHER(S). IT SHALL BE THE SOLE RESPONSIBILITY OF THE CONTRACTOR TO TAKE IMMEDIATE ACTION TO ALLEVIATE ANY SAFETY HAZARD THAT MAY EXIST WITHOUT DIRECTION FROM THE CONTRACTING OFFICER OR HIS DESIGNEE. THE CONTRACTOR SHALL TAKE IMMEDIATE CORRECTIVE ACTION TO ALLEVIATE ANY SAFETY HAZARD, CONDITION, ETC., AS INDICATED BY THE CONTRACTING OFFICER.
- ALL WORK SHALL BE AS DIRECTED BY REPRESENTATIVES OF THE DEPARTMENT OF VETERANS AFFAIRS.
- THERE SHALL BE NO CLAIMS AGAINST THE DEPARTMENT OF VETERANS AFFAIRS FOR WORK STOPPAGES DUE TO ACTS OF GOD, WEATHER CONDITIONS, STOP WORK ORDERS (VERBAL AND/OR WRITTEN), UNDERESTIMATION OF WORK, ESTIMATED QUANTITIES, MATERIALS, SUPPLIES, TOOLS, CORRECTION OF SAFETY PROBLEMS, OR ANY OTHER REASON.
- AT THE COMPLETION OF THE PROJECT, THE CONTRACTOR SHALL PROVIDE TO THE VETERANS AFFAIRS AN "AS CONSTRUCTED DRAWING" FOR THE WORK. THIS DRAWING SHALL BE SUBMITTED ON A 30" BY 42" DRAWING, COMPLETE WITH 2 COPIES. THIS DRAWING SHALL BE TECHNICALLY CORRECT AND DRAWN ACCORDING TO SOUND ENGINEERING PRINCIPLES. THIS SHALL SHOW ALL ELEVATIONS, DISTANCES, DIAMETERS, SCHEDULES, MATERIALS INSTALLED, SEQUENCE OF OPERATIONS OF ANY AND ALL ITEMS TO THE DEPARTMENT OF VETERANS AFFAIRS.  
CONTRACTOR IS ADVISED THAT THEY ARE RESPONSIBLE TO MAINTAIN ALL MEASUREMENTS DURING THE COURSE OF THIS PROJECT AND DIMENSIONS MISSING ON THE DRAWING SHALL NOT BE ACCEPTABLE. FINAL PAYMENT SHALL NOT BE PROVIDED UNTIL THIS DRAWING IS SUBMITTED AND APPROVED.
- CONTRACTOR SHALL SAW CUT WITH PROPER BLADE ANY CONCRETE OR PAVING ENCOUNTERED IN THE COURSE OF THIS WORK.  
ALL HOLES SHALL BE CORED DRILLED WITH DIAMOND CORE BITS.  
THE USE OF JACK HAMMERS IS PROHIBITED.
- CONTRACTOR SHALL BE RESPONSIBLE TO REMOVE ANY AND ALL DEBRIS FROM THE MEDICAL CENTER DAILY AND DISPOSE OF SAME OFF THE BASE IN ACCORDANCE WITH ALL LOCAL AND STATE REGULATIONS.
- CONTRACTOR SHALL PROVIDE FOR OWN STORAGE SPACE AND SECURITY FOR SAME. CONTRACTOR SHALL BE PROHIBITED FROM USING VA SPACE FOR STORAGE.
- ALL WORK SHALL BE PERFORMED BY THOSE WHO ARE SKILLED IN THEIR TRADE, JOURNEYMEN MECHANICS, TO PRODUCE A FIRST CLASS JOB. THE CONTRACTOR IS ADVISED THAT WORK DEEMED UNSUITABLE, UNACCEPTABLE, SECOND CLASS IN NATURE, BY THE VETERANS AFFAIRS SHALL BE DEEMED NON-ACCEPTABLE AND THE CONTRACTOR SHALL REMOVE, REPLACE, RE-DO, TO THE SATISFACTION OF THE DEPARTMENT OF VETERANS AFFAIRS, THE UNACCEPTABLE WORK AT NO ADDITIONAL COST TO THE GOVERNMENT. THERE SHALL BE NO ADDITIONAL CLAIMS AGAINST THE DEPARTMENT OF VETERANS AFFAIRS FOR THE ABOVE.
- THE CONTRACTOR SHALL BE RESPONSIBLE TO REROUTE ANY UTILITY ENCOUNTERED IN THE COURSE OF THIS PROJECT. THE CONTRACTOR IS ADVISED THAT THE VETERANS AFFAIRS HAS MADE THE ATTEMPT TO IDENTIFY MAJOR UTILITIES TO BE REROUTED.
- ALL QUANTITIES SHOWN ON THE DRAWING ARE ESTIMATED QUANTITIES ONLY. IT SHALL BE THE RESPONSIBILITY OF THE CONTRACTOR TO FIELD VERIFY AND ASCERTAIN ALL EXISTING CONDITIONS, DIMENSIONS AND QUANTITIES.
- THE GOVERNMENT SHALL NOT BE LIABLE FOR EXTRA PAYMENT SHOULD THE CONTRACTOR UNDERESTIMATE QUANTITIES OF MATERIALS.
- THE CONTRACTOR SHALL BE RESPONSIBLE TO REPAIR ANY DAMAGE CAUSED BY CONSTRUCTION OF THIS PROJECT AT THE CONTRACTOR'S EXPENSE.
- THE CONTRACTOR IS ADVISED THAT DRAWINGS ARE AVAILABLE FOR REVIEW FOR ALL UTILITIES. THE CONTRACTOR SHALL BE ADVISED THAT ALL UTILITIES ARE TO BE VERIFIED AND ASCERTAINED IN THE FIELD BY THE CONTRACTOR.
- CONTRACTOR SHALL INSTALL AND MAINTAIN A CONSTRUCTION FENCE AND GATES AS INDICATED ON THE DRAWINGS AND AS REQUIRED TO SECURE WORK AREA
- CONTRACTOR SHALL SAWCUT ANY INTERIOR OR EXTERIOR CONCRETE OR ASPHALT BEFORE REMOVING SAME.
- THE GOVERNMENT SHALL NOT BE LIABLE TO THE CONTRACTOR FOR DELAYS DUE TO NON-DELIVERY OF MATERIALS, WEATHER DELAYS, MANPOWER SHORTAGE, SUBMITTAL DELAYS, SUBMITTAL RETURNS, WORK STOPPAGES BY REPRESENTATIVES OF THE GOVERNMENT, FOR ANY REASON, SAFETY DELAYS, REMOVAL AND REPLACEMENT OF WORK DEEMED NON-ACCEPTABLE BY THE GOVERNMENT
- PRIOR TO ANY WELDING, CUTTING, BRAZING, SOLDERING, THE CONTRACTOR SHALL OBTAIN A HOT WORK PERMIT FROM THE DEPARTMENT OF VETERANS AFFAIRS FIRE DEPARTMENT, WITHOUT THIS PERMIT, HOT WORK SHALL NOT BE PERMITTED BY THE GOVERNMENT.
- THE CONTRACTOR SHALL MAINTAIN SECURITY FOR THE WORK AREA AND PROVIDE KEYS TO THE CONTRACTING OFFICER FOR ACCESS.
- THE CONTRACTOR SHALL PROVIDE STORAGE FOR MATERIALS. MATERIALS SHALL NOT BE STORED IN DEPARTMENT OF VETERANS AFFAIRS BUILDINGS.
- THE CONTRACTOR SHALL MAINTAIN THE WORK SITE IN A NEAT AND CLEAN CONDITION.
- THE CONTRACTOR SHALL NOT LEAVE THE WORK AREA UNATTENDED FOR ANY REASON UNLESS CONSTRUCTION FENCING IS INSTALLED AND SECURED.
- THE CONTRACTOR SHALL PARK IN APPROVED PARKING SPACES ONLY.

VERIFY LOCATION OF ALL UTILITIES PRIOR TO CONSTRUCTION. CONTRACTOR TO HIRE SERVICES OF AN OUTSIDE AGENCY FOR MARKING OUT ALL UNDERGROUND UTILITIES WITHIN WORK AREA. CONTRACTOR IS RESPONSIBLE FOR ANY DAMAGE TO EXISTING UTILITIES AND SHALL REPAIR / REPLACE AT NO COST TO VA.

# INSTALL FRONT GATE TRAFFIC CONTROL CENTER AND INCREASE SURFACE PARKING

PROJECT NO. 620A4-11-106

## VA HUDSON VALLEY HEALTHCARE SYSTEM

ROUTE 9D, CASTLE POINT, NEW YORK

### Campus Map

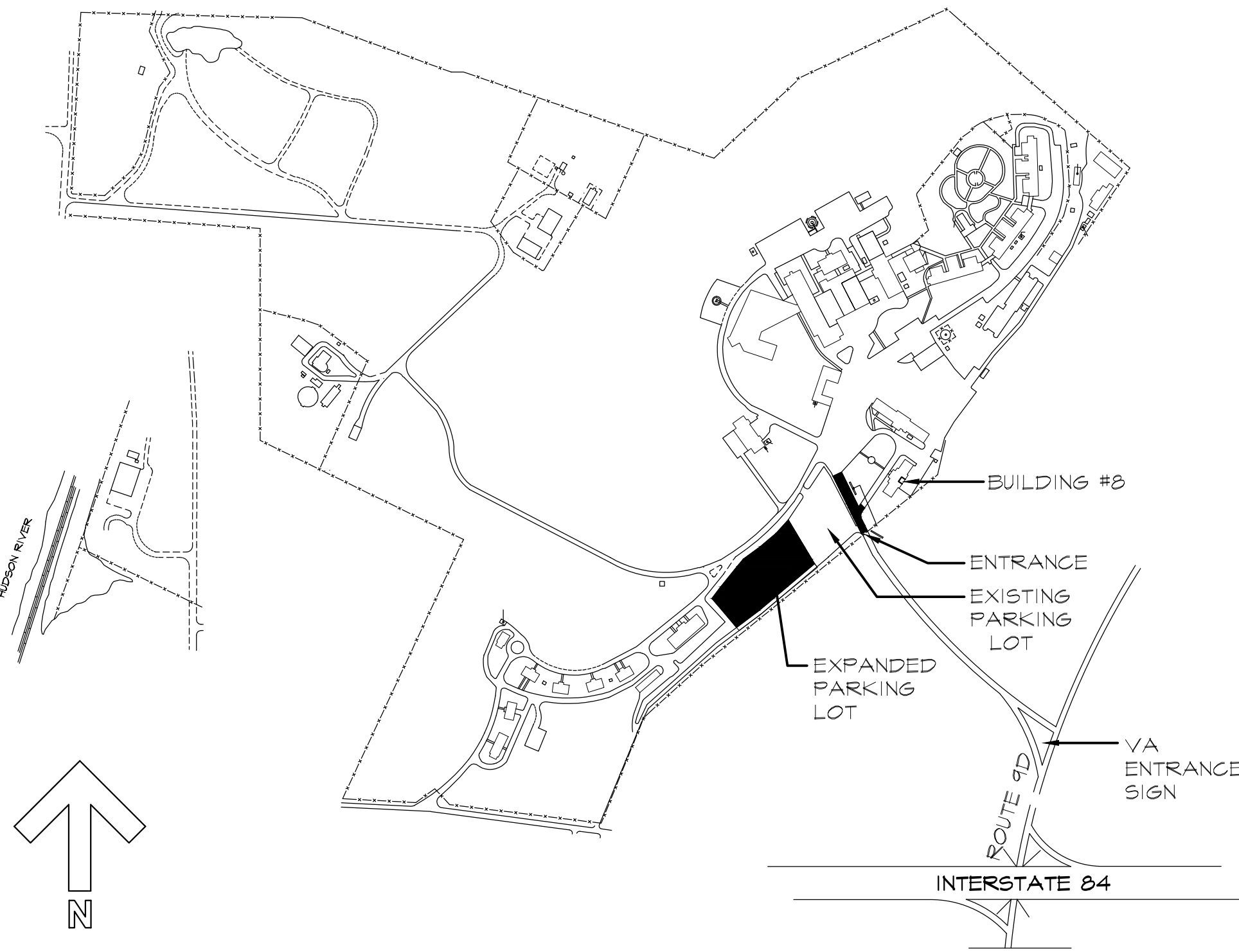

### Drawing List

Drawing #	Name	Sheet #
GI001	TITLE SHEET, AREA MAP, DRAWING LIST, GENERAL NOTES	1
GC101	PHASING PLANS	2
GD101	DEMOLITION PLAN AND NOTES	3
CD102	EXISTING PHOTOGRAPHS	4
CG101	NEW GRADING PLAN	5
CG102	NEW SEDIMENT AND EROSION CONTROL	6
CG501	DETAIL	7
CP101	NEW CONSTRUCTION PLAN	8
CP102	NEW STRIPING PLAN AND SIGNAGE PLAN	9
CP103	NEW GUARD BOOTH PLANS AND ELEVATIONS	10
CP501	SITE DETAILS - PAVEMENT	11
CP502	SITE DETAILS - SIDEWALKS	12
CP503	SITE DETAILS - STRIPING AND PAVEMENT MARKINGS	13
CP504	SITE DETAILS - SECURITY GATES AND LIGHT POLES	14
CP505	SIGNAGE DETAILS	15
CU001	NEW UTILITY PLAN	16
CU002	ELECTRICAL SITE LIGHTING PLAN	17
CU003	ELECTRICAL PHOTOMETRICS PLAN AND DETAILS	18

#### Architect:

**Kenneth Irving, Architect PC**

42 Memorial Plaza, Suite 301, Pleasantville, NY 10570  
Tel: 914-747-0002 Fax: 914-747-9211 E-Mail: mandrade@kiarch.com

#### Geotechnical Engineer:

**Tectonic Engineering &  
Survey Consultants P.C.**

P.O. Box 37 - Pleasant Hill Road  
Mountainville, New York 10953  
Tel: 800-829-6531

#### Civil Engineer:

**Kellard Sessions Consulting P.C.**

500 Main Street  
Armonk, New York 10504  
Tel: 914-273-2323

#### Electrical Engineer:

**EMTG Consulting Engineers**

227 West 29th Street Suite 5F - Fifth Floor, New York, NY 10001  
Tel: 212-268-6465 Fax: 212-268-6467

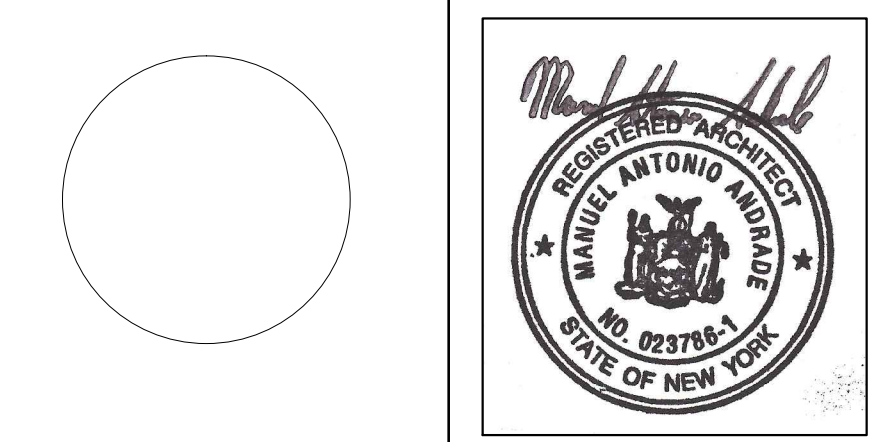

Revisions  
VA FORM 08-6231, DEC 1989



#### NOTE AND READ CAREFULLY:

The Contractor shall consult and study the requirements of each and every drawing and each specification section of this contract so that he /she may become acquainted with the project as a whole in order to determine how the work of his/her subcontractor or vendor may affect the work required under this contract.

Written Specifications are part of this contract

#### Key Plan

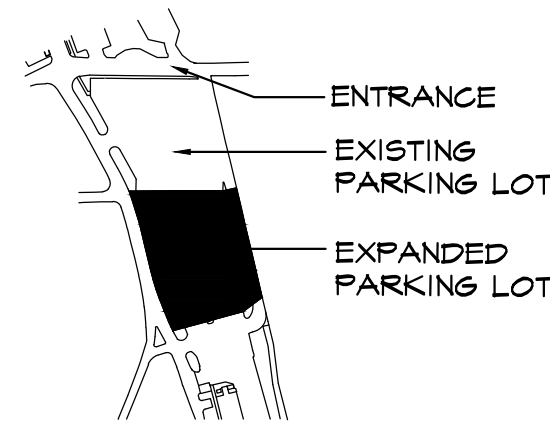

#### Drawing Title

**TITLE SHEET  
AREA MAP  
DRAWING LIST  
GENERAL NOTES**

Approved: Division Chief

Approved: Service Director

#### Project Title

**Install Front Gate Traffic Control  
Center & Increase Surface Parking  
Castle Point Campus, VAHVCS  
Castle Point, New York**

Building Number

Checked

**MA**

Drawn

**JTL/MS**

Location

**Castle Point, New York**

Date  
**7/12/2011**

Project No.  
**620A4-11-106**

DRAWING NO.

**GI001**

Dwg. 1 Of 18

