

REMOVE BASE COVE TOE

1. DRAWING D1-01 GROUND FLOOR DEMOLITION PLAN

A. Remove the toe of the base cove according to the Detail #1 below for the following walls that are to remain on the "C Wing" of this floor:

1. All exterior walls
2. All interior walls that are to remain both room side and corridor side.
3. The mechanical room where the chiller is located does not have any base cove.
4. All room side and corridor side of stairway walls.
5. Any chases that are to remain that may have a base cove toe if located in finished area.

2. DRAWING D1-02 AND D1-03 FIRST AND SECOND FLOOR DEMOLITION PLAN

A. Remove the toe of the base cove according to the Detail #1 below for the following walls that are to remain on the "C Wing" of these floors:

1. All exterior walls
2. All room side and corridor side of stairway walls.
3. Any chases that are to remain that may have a base cove toe if located in finished area.

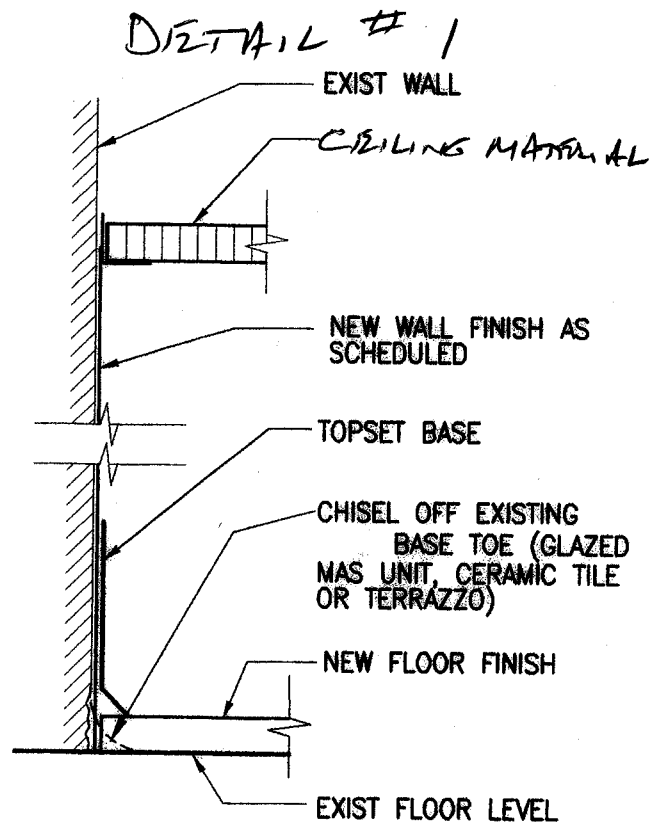

WALL SECTION
NOT TO SCALE