

NEW FLOOR PLAN (PHASE 1)

SCALE: 3/16" = 1'-0"

LEGEND

LINE TYPES

DEMO = DASHED
EXISTING = CONTINUOUS
NEW = FILLED

ARCHITECTURAL SYMBOLS

DOOR (SEE SCHED. / ELEVATION)
WINDOW (SEE SCHED. / ELEVATION)
ONE HOUR WALL
B-105 ROOM NUMBER
EXISTING BUILDING GRID
DIRECTION OF ELEVATION
DETAIL NUMBER
SHEET NUMBER
WALL TYPE SEE DETAIL 21/1A.23

GENERAL NOTES

- CUTTING OF HOLES THROUGH CONCRETE SHALL BE BY DIAMOND CORE DRILL OR PNEUMATIC HAMMER. IMPACT ELECTRIC MANUAL HAMMER TYPE DRILLS WILL NOT BE ALLOWED.
- JACKHAMMER NO HEAVIER THAN 70 lbs SHALL BE USED WHEN REMOVING LIGHT-WEIGHT LATEX MASTIC CONCRETE TOPPINGS FROM PATIO AREAS.
- CONTRACTOR TO PROVIDE COLOR COPIES OF MARKED-UP RECORD SET PLANS TO OWNER UPON PROJECT COMPLETION.
- SPECIAL TOOLS: IF ANY PART OF EQUIPMENT FURNISHED UNDER THIS CONTRACT REQUIRES SPECIAL TOOLS FOR MAINTENANCE, ADJUSTMENT, SETTINGS OR DISASSEMBLY/REASSEMBLY, THESE TOOLS SHALL BE FURNISHED WITH EQUIPMENT AS A STANDARD ACCESSORY.
- ALL DIMENSIONS ARE APPROXIMATE: CONTRACTOR TO VERIFY FIELD CONDITIONS PRIOR TO START OF CONSTRUCTION.
- CONTRACTOR TO PATCH AND REPAIR ALL WALLS, FLOORS, CEILINGS AND OTHER ITEMS DAMAGED DURING CONSTRUCTION TO MATCH EXISTING/INTENDED FUNCTIONS AND CONDITIONS.
- CONTRACTOR TO LOCATE ALL "VA RETAINED" MATERIAL TO THE EAST LOADING DOCK IN THE BASEMENT; PROJECT MANAGER WILL COORDINATE LOCATION OF MATERIAL.
- ALL MATERIAL NOT IDENTIFIED AS "VA RETAINED" IS TO BE REMOVED FROM THE PREMISES BY CONTRACTOR.
- REMOVE AND RELOCATE OR REROUTE ANY UTILITIES WHICH PRESENT AN OBSTRUCTION TO GENERAL CONSTRUCTION FOR THIS PROJECT.
- ALL UTILITIES SHALL BE ROUTED TO CLEAR OBSTRUCTIONS, MAINTAINING CLEAR ACCESS FROM CATWALK AT ALL TIMES.
- PROVIDE SEISMIC SUPPORT AND BRACING TO ALL UTILITIES AND GENERAL CONSTRUCTION IN THIS PROJECT.
- UTILITIES SHALL BE RUN CONCEALED EXCEPT IN UNFINISHED AREAS.
- ALL PENETRATIONS THROUGH FLOORS AND SMOKE BARRIERS SHALL BE TIGHTLY SEALED AND FIRE-STOPPED. ANY EXISTING CORE CUTS ARE TO BE FILLED WITH SIMILAR MATERIAL USING 12-GAUGE BACKING PLATE.
- "WARNING:" ASBESTOS PRESENT IN INTERSTITIAL AREAS IN FIRE PROOFING ON STRUCTURAL STEEL, OVERSPRAY ON 4-INCH I-BEAMS AND CONCRETE DECKS. CONTRACTOR TO WEAR RESPIRATOR AND PROTECTIVE COVERALLS IAW LOCAL, STATE & FEDERAL REGULATIONS. REFER TO SPEC. SEC. 01568, 69 & 70.
- "WARNING:" ASBESTOS PRESENT IN EXTERIOR WALL (TRANSITE) PANELS. DISPOSE OF ALL HAZARDOUS WASTE IAW LOCAL, STATE & FEDERAL REGULATIONS. CONTRACTOR TO WEAR RESPIRATOR AND PROTECTIVE COVERALLS IAW LOCAL, STATE & FEDERAL REGULATIONS. REFER TO SPEC. SEC. 01568, 69 & 70.
- "WARNING:" ASBESTOS PRESENT IN VINYL COMPOSITION FLOOR TILE & MASTIC. CONTRACTOR TO DISPOSE OF ALL HAZARDOUS WASTE IAW LOCAL, STATE & FEDERAL REGULATIONS. CONTRACTOR TO WEAR RESPIRATOR AND PROTECTIVE COVERALLS IAW LOCAL, STATE & FEDERAL REGULATIONS. REFER TO SPEC. SEC. 01568, 69 & 70.
- CORRIDOR AREAS ARE TO MAINTAIN 2-HR FIRE PROTECTION BARRIER MATCHING EXISTING CORRIDOR WALL CONSTRUCTION. REFER TO SPEC. SEC. 02050.
- CONTRACTOR TO PROVIDE 1/2" GYP. BOARD TEMPORARY WALL SEPARATING PUBLIC FROM PROJECT AREA(S). BARRIER TO BE AIR-TIGHT FLOOR TO CEILING WITH SECURED OPENING. REFER TO SPEC. SEC. 02050. USE OPTIONAL TEMPORARY-TO-PERMANENT DETAIL PROVIDED AS AN ALTERNATIVE TO BARRIER REQUIRING REMOVAL, AS AN EXPEDIENT.
- PROVIDE 4" SOUND-ATTENUATING BLANKET OVER ALL ROOMS EXCEPT WAITING AREAS, CORRIDORS AND ROOMS WITH HARD GYP. BD LIDS. PROVIDE 5" SOUND-ATTENUATING BLANKET OVER CONFERENCE ROOMS. ALL WALLS SHALL HAVE SOUND BATTIS ACHIEVING STC-40. THE ENCLOSURE IN THE INTERSTITIAL SPACE SHALL BE STC-45. CAULK AND SEAL ALL WALL PENETRATIONS, AND SEAL EDGES OF GYP. BOARD.
- APPLY FIREPROOFING MATERIAL IN ALL INTERIOR STRUCTURAL STEEL MEMBERS AND ON UNDERSIDE OF INTERIOR STEEL FLOOR, ROOF DECKS, AND INTERSTITIAL STRUCTURAL STEEL MEMBERS.

PLAN KEYNOTES

SYM.	SPEC #	DISCRIPTION
1	024100	REFER TO GENERAL NOTE 18 FOR CONST. BARRIER INFORMATION

SPACE TYPE

PATIENT / HIGH RISK	PATIENT / MODERATE RISK	NON-PATIENT GENERAL AREAS
Operating Suites	General Nursing Units	Lobbies
Catheter Care Units	Day Rooms	Public Corridors
Angiography Rooms	Primary Care Clinics	Elevators
TB Bedrooms/Exam Rooms	Food Preparation	Caribbean Retail Store
Intensive Care Units	General Radiology Rooms	Administrative Offices
Urgent Care Units	OT/PT Clinics	Receiving / Warehouse
SPD Storage / Sterilization	Pharmacy	Engineering Shops
Other Special Units Dialysis, Cancer, HIV, Transplant Etc.		

BARRIER / CONTROL TYPE

PATIENT / HIGH RISK	PATIENT / MODERATE RISK	NON-PATIENT GENERAL AREAS
Solid Wall Type: - Fire Rated Gyp In/Out - Gasketed Top / Bottom - Door/Frame/Best HW - Gasketed Door - Negative Pressure - Capped Supply Air	Solid Wall Type: - Fire Rated Gyp In/Out - Gasketed Top / Bottom - Door/Frame/Best HW - Gasketed Door - Negative Pressure - Capped Supply Air	Solid Wall Type: - Fire Rated Gyp In/Out - Gasketed Top / Bottom - Door/Frame/Best HW - Gasketed Door - Negative Pressure - Capped Supply Air

gkkworks
architecture and construction services
Project #40094

1775 Hancock Street, Suite 150, San Diego, CA 92110
619 398 0215 • 619 814 1249 fax

OEF / OIF Transition Center

New Floor Plan - Phase 1

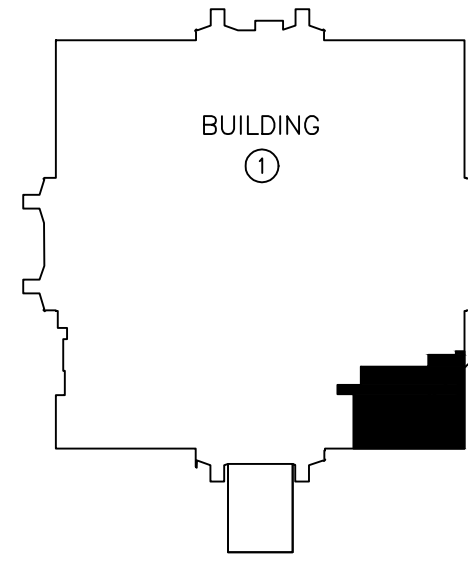

BUILDING NO. 1

Department of
Veterans Affairs
3350 LaJolla Village Dr.
San Diego, California 92161



USING SERVICE:	DATE: DECEMBER 23, 2010
FACILITIES MGMT:	CHECKED: K.H. A.N.
CHIEF OF STAFF:	DRAWN: A.D.T.K.
CHIEF OF OPERATIONS:	SCALE: AS NOTED
DIRECTOR:	DRAWING No. SD-2312
	1-A.6
	SHEET No. 14 OF 127
	PROJ. No. 664-CS1-102

KEY PLAN