

SCOPE:
UPGRADE POWER FOR CHILLERS 1,2,3 & 4.

DEMOLITION NOTES:

1. THE PLAN IS INTENDED TO COVER THE EXTENT AND SCOPE OF THE WORK REQUIRED FOR REMOVAL OR RELOCATION OF THE PROJECT SITE BEFORE SUBMITTING A BID FOR DEBATEMENT WORK.
2. ANY DISCREPANCIES BETWEEN THE DEBATEMENT PLANS AND ACTUAL FIELD CONDITIONS SHALL BE BROUGHT TO THE ATTENTION OF THE RESIDENT ENGINEER. ANY DEVIATION WORK WHICH MAY BE QUESTIONABLE DUE TO DISCREPANCIES SHALL BE REVIEWED WITH THE RESIDENT ENGINEER.
3. DEBATEMENT WORK SHALL INCLUDE THE PREPARATION OF EXISTING DEBATEMENT FOR CONNECTION TO NEW EQUIPMENT. COMPONENTS OF DEBATEMENT WORK WITH THE CONSTRUCTION PLANT.
4. ALL EQUIPMENT (PUMPS, ETC., REMOVED, RE-INSTALLED, REBUILT/RELOCATED) SHALL BE MAINTAINED IN GOOD WORKING ORDER AND SHALL BE UNHARMED THIS DEMAND FOR DISPOSAL SHALL BECOME CONTRACTOR'S RESPONSIBILITY, AS DIRECTED BY PROJECT RESIDENT ENGINEER. ALL REMOVED EQUIPMENT SHALL BE REMOVED FROM THE PROJECT SITE. REMOVAL, TRANSPORTATION AND DISPOSAL/RECYCLING OF ITEMS OFF-SITE SHALL BE THE RESPONSIBILITY OF THIS CONTRACTOR.
5. ALL LIFTING AND RIGGING NECESSARY FOR THE DEBATEMENT WORK SHALL BE THE RESPONSIBILITY OF THIS CONTRACTOR.
6. E.C. SHALL PROVIDE AND INSTALL ALL APPOINTMENTS NECESSARY TO RELOCATE THE EXISTING COMBINATION STARTER/DISCONNECT SWITCH, TO THE NEW LOCATION. THE CONTRACTOR SHALL BE RESPONSIBLE FOR THE REMOVAL AND RELOCATION OF THE EXISTING STARTER/DISCONNECT SWITCH TO THE OPERABLE SYSTEM. REFER TO DRAWING E-3 FOR NEW LOCATION.

KEYED DEMOLITION NOTES:

1. E.C. SHALL REMOVE THE EXISTING SPOOL BOX SERVING EXISTING CHILTS #2 & #3 INCLUDING ALL ASSOCIATED APPURTENANCES. CONTRACTOR SHALL COORDINATE WITH THE RESIDENT ENGINEER.
2. E.C. SHALL REMOVE THE EXISTING CONDUITS & CONDUITORS SERVING CHILTS #2 & #3. CONTRACTOR SHALL PROVIDE A NEW 2" DIA. 20'X18' FILLD TRANSFORMER IN SWITCHGEAR ROOM 50-118.
3. E.C. SHALL REMOVE THE EXISTING CONDUIT FROM THE EXISTING 4" CHILTS #4 TO THE EXISTING 4" CHILTS #1. CONTRACTOR SHALL PROVIDE PULL STRING FOR NEW 4" CAP COP CONDUIT ENDS.
4. E.C. SHALL TEMPORARILY RECONNECT FEED FROM EXISTING STARTER #1 TO CHILTS #4 TO ALLOW STARTER #1 TO BE TEMPORARILY MOVED. REMOVAL/INSTALLATION OF CHILTS #1, AFTER STARTER #1 IS IN PLACE, SHALL BE THE RESPONSIBILITY OF THE RESIDENT ENGINEER AND RECONNECT FEED. COORDINATE EXACT TEMPORARY LOCATION OF STARTER #4 IN FIELD WITH VA PERSONNEL.

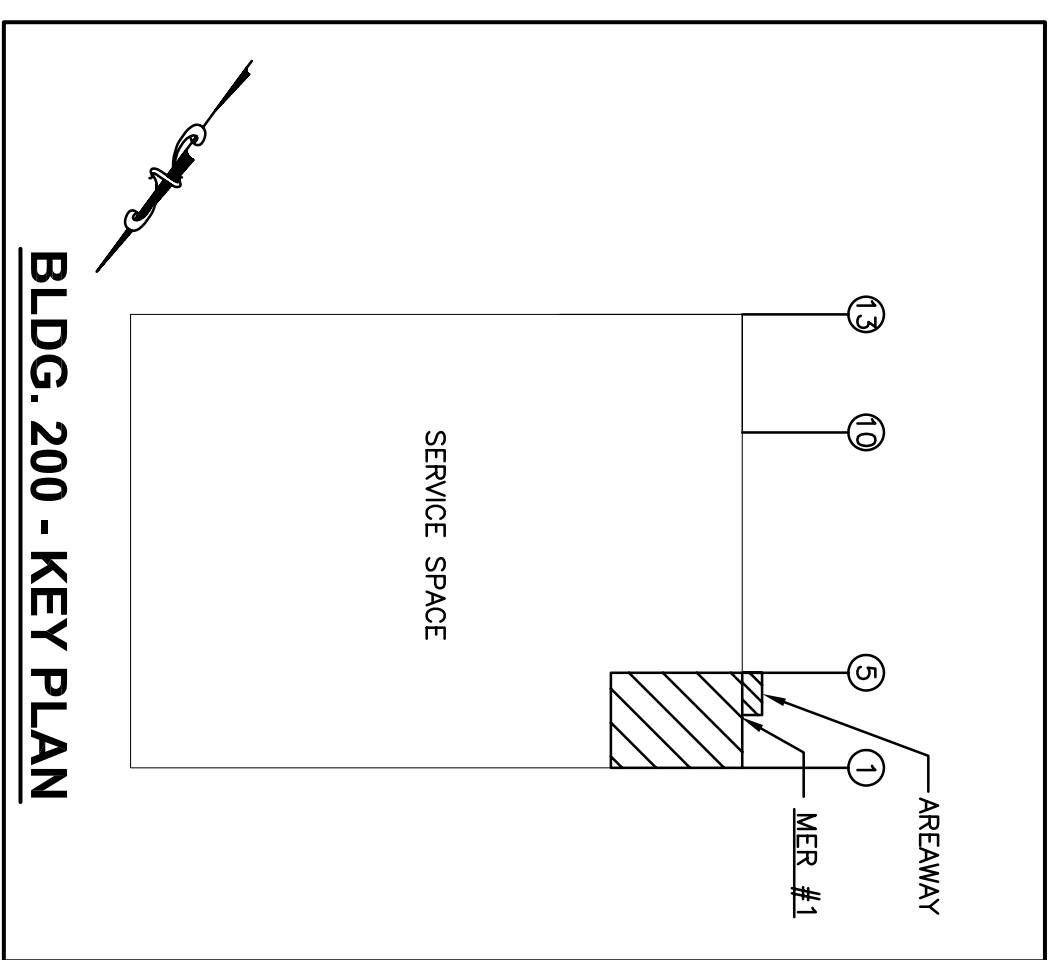

100% CONSTRUCTION DOCUMENTS

[illegible]