

1 GROUND FLOOR REFLECTED CEILING PLAN  
1/8" = 1'-0"

1A ENLARGED RECEPTION CEILING PLAN  
1/4" = 1'-0"

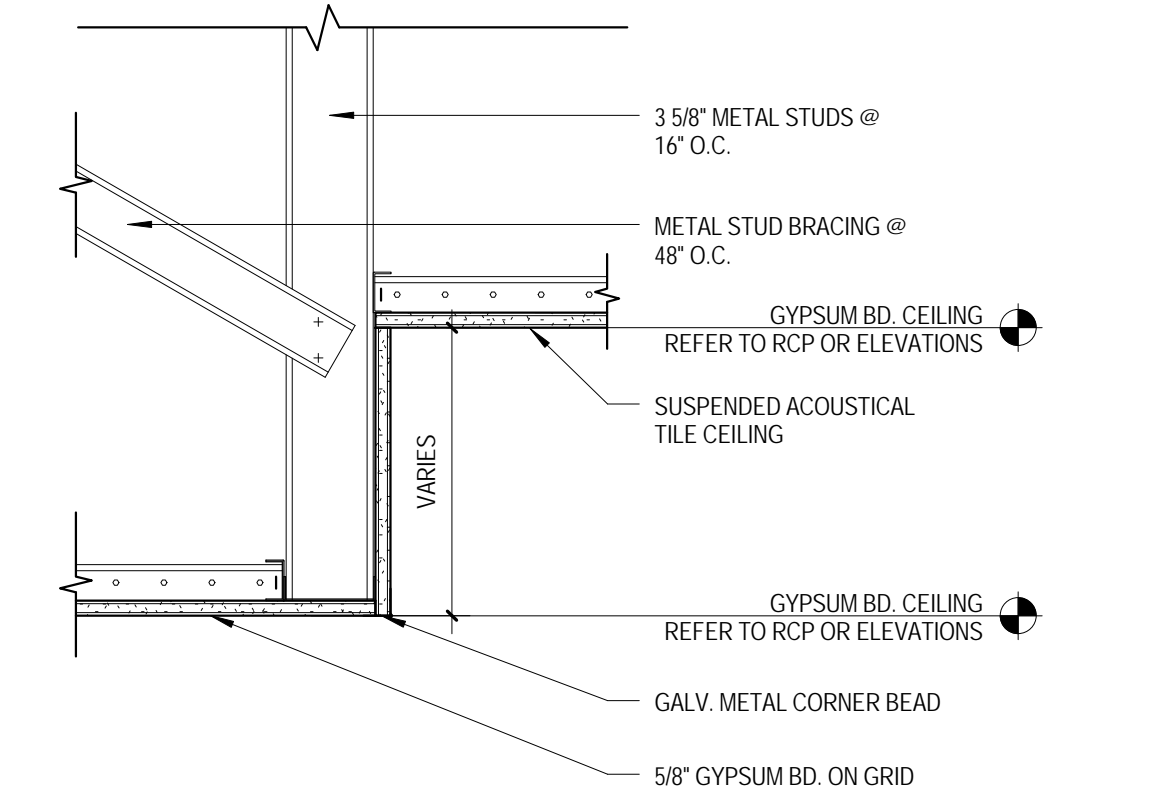

2 GYP. BD. TO GYP. BD CEILING  
1 1/2" = 1'-0"

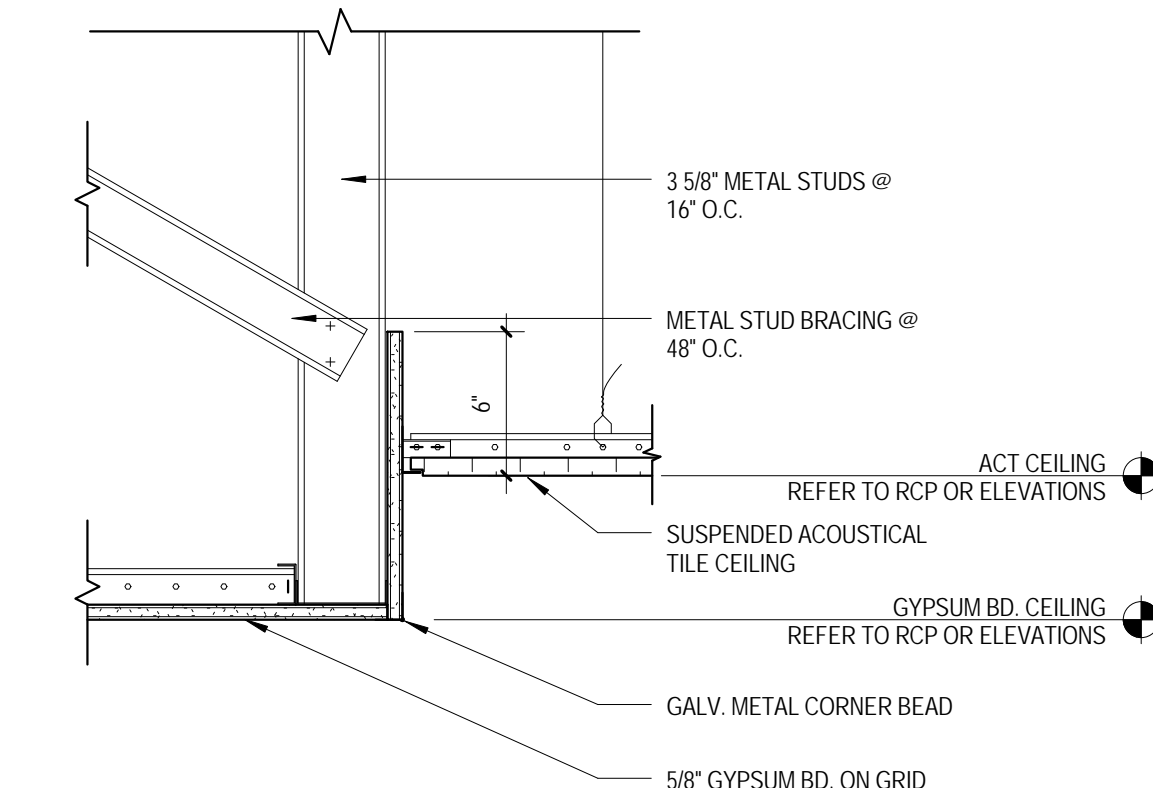

3 GYP. BD. SOFFIT TO ACOUSTICAL CEILING  
1 1/2" = 1'-0"

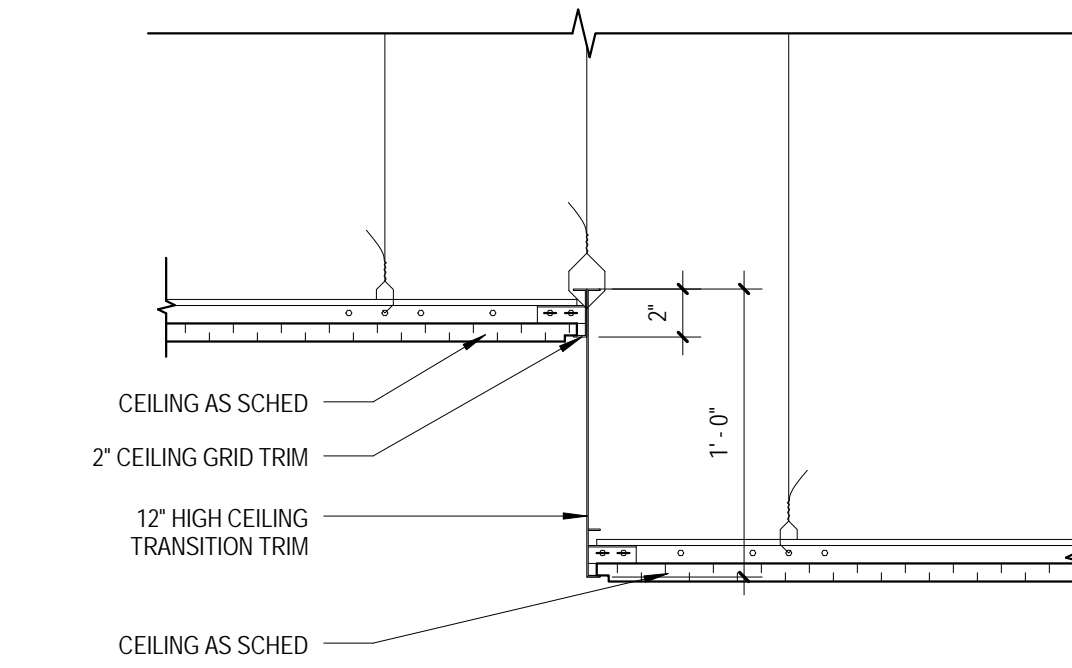

5 ACP TO ACP TRANSITION  
1 1/2" = 1'-0"

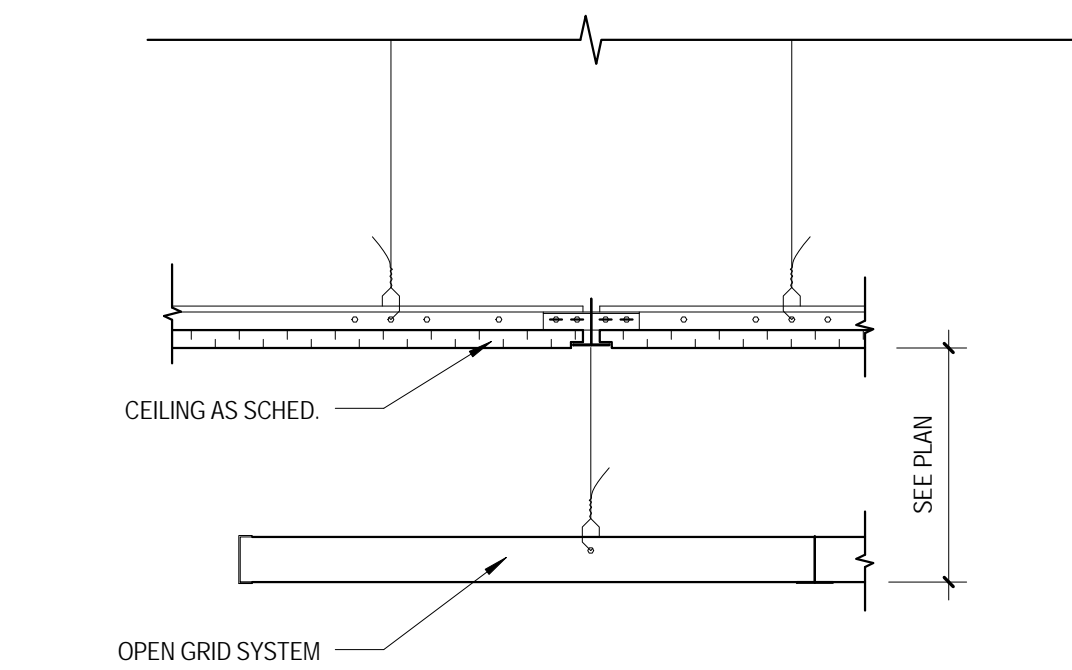

4 SUSPENDED OPEN GRID SYSTEM  
1 1/2" = 1'-0"

## REFLECTED CEILING PLAN NOTES:

- IN CASE DISCREPANCIES IN THE LOCATION OF CEILING MOUNTED COMPONENTS WITH THE ENGINEERING DRAWINGS, THE REFLECTED CEILING PLAN SHALL GOVERN. IN CASE DISCREPANCIES WHERE THIS CAN NOT BE ACHIEVED, THE ARCHITECT SHALL BE NOTIFIED PRIOR TO CONTINUATION OF WORK.
- ALL ACOUSTICAL CEILING GRIDS SHALL BE CENTERED AS SHOWN IN ROOM OR DEFINED BOUNDARY UNLESS DIMENSIONED OR NOTED OTHERWISE.
- IF UNDIMENSIONED, ALL DEVICES LOCATED WITHIN ACOUSTICAL CEILING TILES, GYPSUM BOARD CEILINGS, OR SOFFITS SHALL BE CENTERED, UNLESS OTHERWISE NOTED (UON). MULTIPLE DEVICES SHALL FOLLOW THE GRAPHIC DEPICTION ON THE DRAWINGS AS CLOSELY AS POSSIBLE E. ALIGNING DEVICES WITH RESPECT TO ONE ANOTHER AND SPACING EVENLY AS SHOWN.
- REFER TO ELECTRICAL DRAWINGS FOR ADDITIONAL INFORMATION REGARDING LIGHT FIXTURE TYPES, FIRE ALARM DEVICES, SMOKE DETECTORS AND SPECIAL SYSTEMS CEILING MOUNTED DEVICES LOCATIONS.
- SEE HVAC DRAWINGS FOR HVAC DIFFUSER AND GRILLE SIZES AND TYPES.
- WHERE REQUIRED IN ORDER TO COMPLETE ABOVE-CEILING WORK, TEMPORARILY REMOVE EXISTING ACOUSTICAL TILE CEILINGS TO REMAIN. RETURN TO ORIGINAL CONDITION FOLLOWING COMPLETION OF ABOVE-CEILING WORK. REPLACE WARE CEILING THAT REQUIRE REMOVAL AND FURNISH AND INSTALL NEW ACCESS PANELS BELOW ITEMS REQUIRING MAINTENANCE. PAINT ACCESS PANELS TO MATCH ADJACENT FINISH.
- REFER TO FINISH SCHEDULE AND FINISH LEGEND FOR CEILING MATERIAL SPECIFICATIONS.
- ALL HEIGHTS SHOWN ARE TO BOTTOM OF GRID SYSTEM OR GYPSUM BOARD ABOVE FINISHED FLOOR (AFF) UNLESS OTHERWISE NOTED.
- THE HORIZONTAL SURFACE OF ALL GYPSUM BOARD SOFFITS SHALL BE PAINTED. THE VISIBLE VERTICAL FACES OF GYPSUM BOARD SOFFITS SHALL BE FINISHED PER TAGS ON RCP (UON). SEE FINISH LEGEND ON INTERIOR SHEETS FOR ADDITIONAL INFORMATION.
- ANY EXISTING AREAS TO REMAIN THAT ARE DAMAGED DURING DEMOLITION OR CONSTRUCTION SHALL BE REPAIRED AND/OR REPLACED TO RETURN THEM TO THEIR ORIGINAL CONDITION OR BETTER.

## REFLECTED CEILING PLAN LEGEND:

- 2x2 LAY-IN ACOUSTICAL CEILING
- 2x4 LAY-IN ACOUSTICAL CEILING
- 2x2 ACOUSTICAL TILE WITH CLEANABLE SURFACE
- GYPSUM BOARD CEILING/SOFFIT
- 2x4 LAY-IN FLUORESCENT FIXTURE
- 2x2 LAY-IN FLUORESCENT FIXTURE
- RECESSED DOWNLIGHT
- PENDANT LIGHT
- EXIT SIGNAGE (SEE ELECTRICAL DRAWINGS)
- ACCESS PANEL (IN GYP. BD.)
- FIRE ALARM DEVICES (SEE ELECTRICAL DRAWINGS)
- WALL MOUNTED SCONCE
- CEILING GRILLE (SEE MECH. DRAWINGS)
- SMOKE DETECTOR (SEE ELECTRICAL DRAWINGS)
- X'-X' CEILING HEIGHT A.F.F.

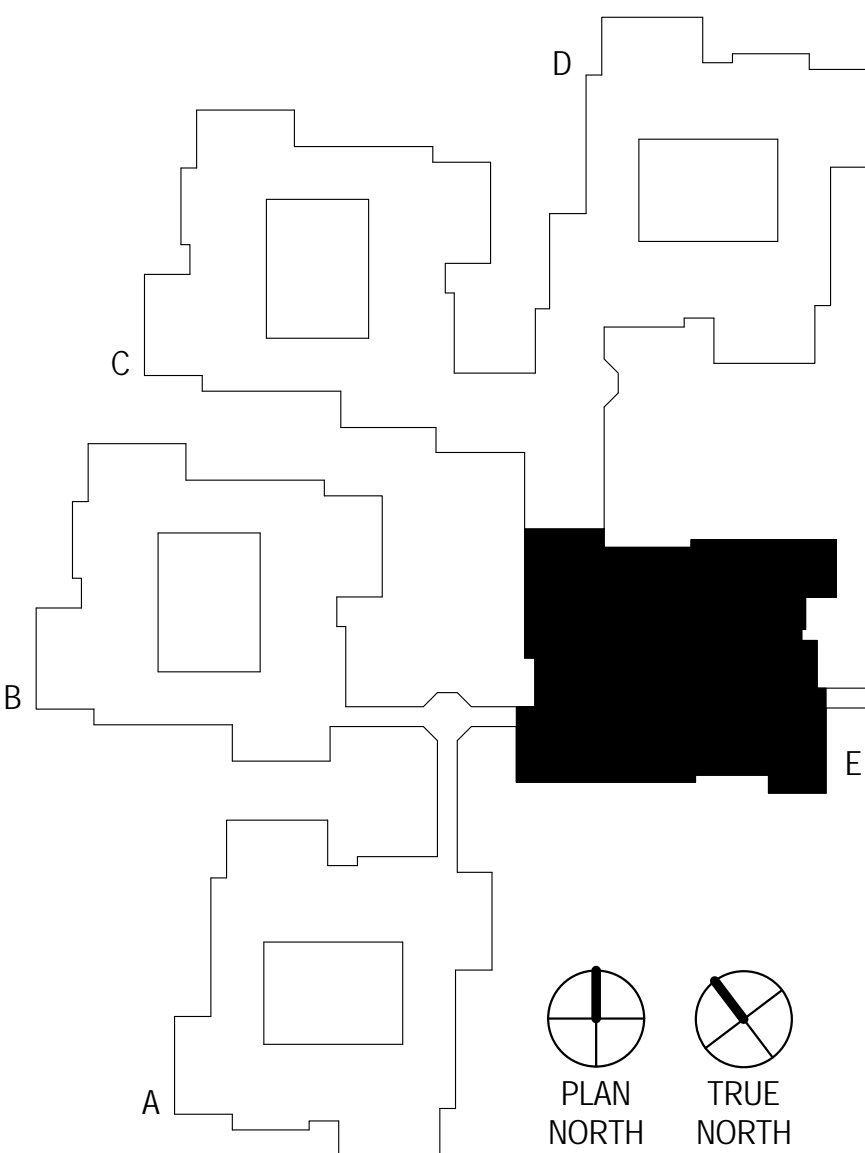

KEY PLAN  
1" = 100'-0"

100% Construction Documents Submission	02/24/12
95% Construction Documents	02/10/12
60% Design Development	01/20/12
Schematic Design	11/30/11
Issuances:	Date

## ARCHITECT / ENGINEERS:

**Oudens Knoop Knoop + Sachs Architects**  
2 Wisconsin Circle / Suite 820  
Chevy Chase, MD 20815-7003  
Tel: (301) 718-0080  
Fax: (301) 718-9520

**HENRY ADAMS**  
Consulting Engineers

Mechanical Electrical & Plumbing Engineers

**Henry Adams, LLC**  
Consulting Engineers  
600 Baltimore Avenue  
Baltimore, MD 21204  
Tel: (410) 296-6500  
Fax: (410) 296-3156

**Woods Peacock Engineering Consultants**  
Halifax Office Park  
5250 Cherokee Avenue, Suite 420  
Alexandria, VA 22312-2052  
Tel: (703) 658-4400  
Fax: (703) 658-4404

**Patton Harris Rust & Associates**  
A Pennoni Company  
117 East Piccadilly Street, Suite 308  
Winchester, VA 22601-5002  
Tel: (540) 667-2139  
Fax: (540) 665-0493

Stamp/Seal

Drawing Title  
**GROUND FLOOR REFLECTED  
CEILING PLAN**

Approved: Project Director

Project Title  
**BUILDING 502 E WING  
RENOVATION**

Location  
**MARTINSBURG, WV**

Date  
**02/24/12**

Checked  
TOS, ROS

Drawn  
ROS

VA Project Number  
**613-12-101**

Building Number  
**502**

Drawing Number  
**A200**

Office of  
Construction  
and Facilities  
Management

Department of  
Veterans Affairs