

one eighth inch = one foot
one quarter inch = one foot
one half inch = one foot
three eighths inch = one foot
one inch = one foot
one and one half inches = one foot
two inches = one foot
three inches = one foot

1
2
3
4
5
6
7
8
9
10
11
12
13
14
15
16
17
18
19
20
21
22
23
24
25
26
27
28
29
30
31
32
33
34
35
36
37
38
39
40
41
42
43
44
45
46
47
48
49
50
51
52
53
54
55
56
57
58
59
60
61
62
63
64
65
66
67
68
69
70
71
72
73
74
75
76
77
78
79
80
81
82
83
84
85
86
87
88
89
90
91
92
93
94
95
96
97
98
99
100

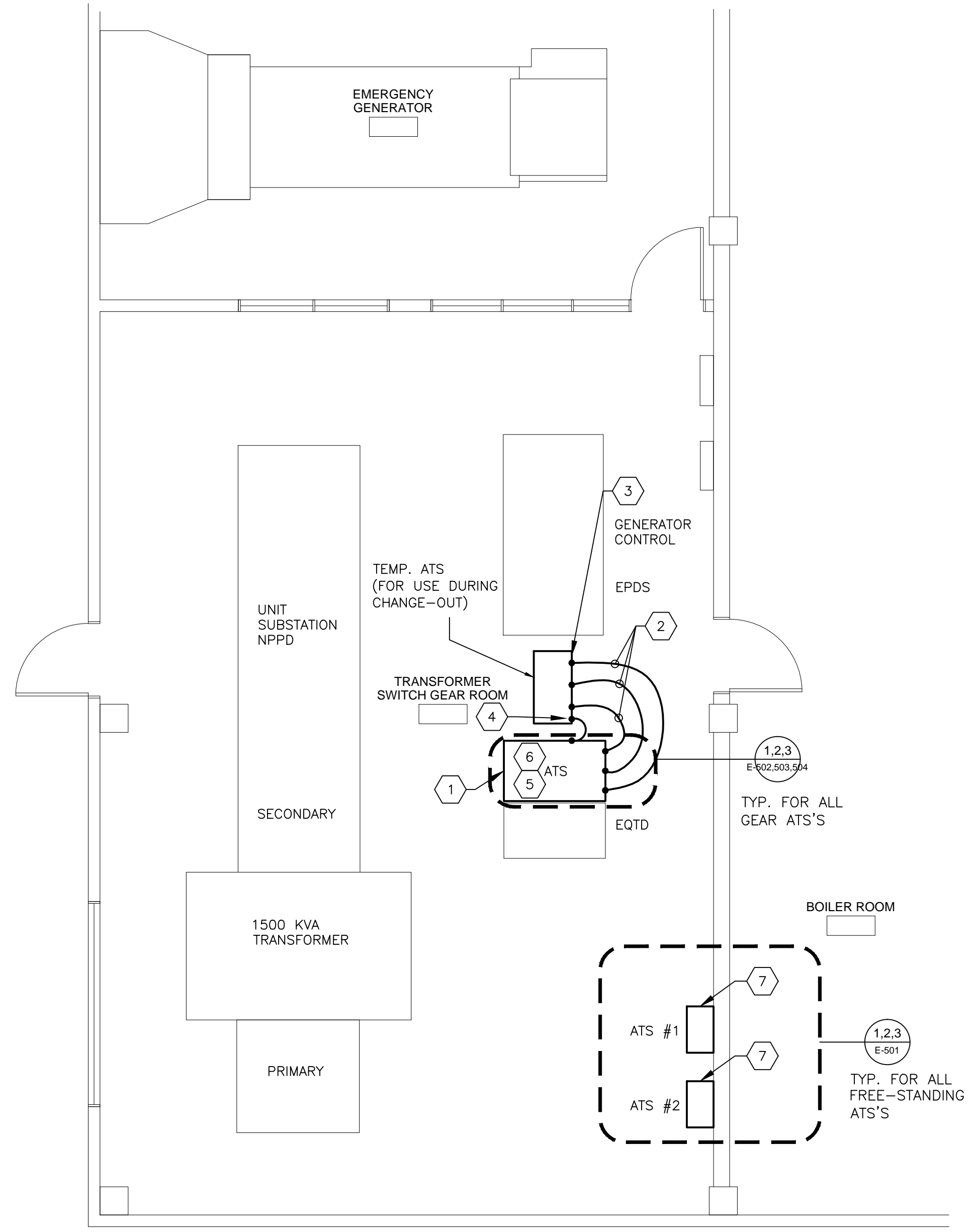

2 BUILDING 43
PARTIAL CENTRAL PLAN FLOOR PLAN - ELECTRICAL
SCALE: 1/4" = 1'-0"

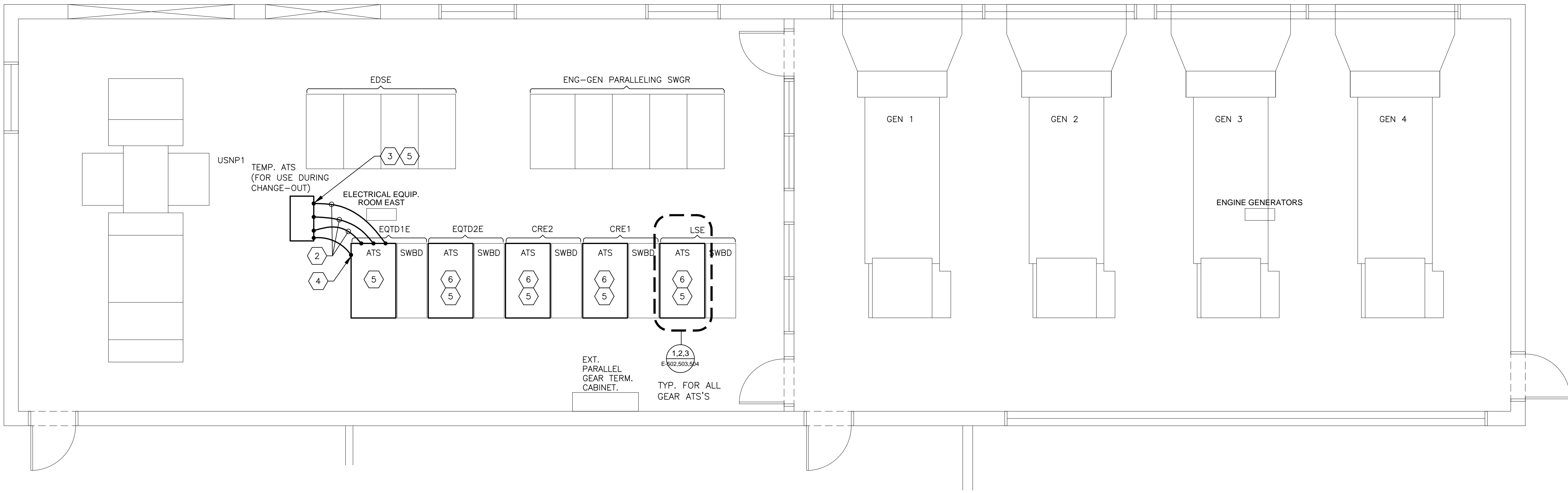
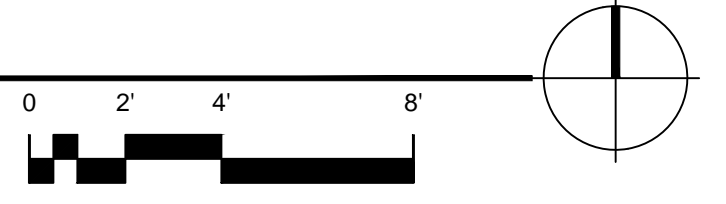

1 BUILDING 42 PARTIAL BASEMENT FLOOR PLAN - ELECTRICAL
SCALE: 1/4" = 1'-0"

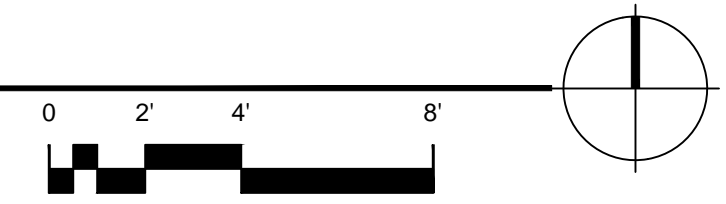

GENERAL NOTES

1. AUTOMATIC TRANSFER SWITCHES SHOWN ARE TO BE REPLACED ACCORDING TO THE "PROJECT WORKPLAN AND SCHEDULE REQUIREMENTS" AS STATED ON SHEET E-002.
2. THE CONTRACTOR SHALL ENERGIZE AND DE-ENERGIZE ALL ELECTRICAL EQUIPMENT. ALL ENERGIZING AND DE-ENERGIZING SHALL BE COMPLETED WITH SUPERVISION OF MAINTENANCE PERSONNEL.
3. ALL ATS CHANGE-OUTS ARE TO BE COMPLETED IN "OFF" HOURS ACCORDING TO THE CONTRACTORS SUBMITTED SCHEDULE.
4. ALL PREP WORK MAY BE COMPLETED DURING NORMAL WORK HOURS.
5. AFTER INSTALLATION, BUT PRIOR TO BEING PLACED ON LINE INTO THE EXISTING HOSPITAL ELECTRICAL SYSTEM, ALL ATS SWITCHES SHALL BE FACTORY TESTED AND CERTIFIED.
6. ALL WORK SHALL BE IN ACCORDANCE WITH VA STANDARDS AND REQUIREMENTS. CONTACT THE COTR FOR PROJECT FOR SPECIFIC REQUIREMENTS.
7. NO "HOT" WORK SHALL BE INITIATED WITHIN THE SCOPE OF THIS PROJECT. NO EXCEPTIONS WITHOUT THE WRITTEN CONSENT OF THE VA COTR.
8. UNLESS OTHERWISE NOTED, EQUIPMENT IS EXISTING AND TO REMAIN.
9. ATS REPLACEMENTS SHALL BE SEQUENTIAL (NOT AT THE SAME TIME) TO MINIMIZE OUTAGES AND INTERRUPTIONS.
10. RECONNECT AND TEST ALL ATS CONTROL WIRING.
11. SEE ATS CONTROLS BLOCK DIAGRAM ON SHEET E-505 FOR MORE INFORMATION.
12. THE OWNER SHALL HAVE THE FIRST RIGHT OF REFUSAL FOR ALL EXISTING EQUIPMENT TO BE REMOVED. THE OWNER SHALL BE INFORMED IN ADVANCE OF ALL EQUIPMENT TO BE REMOVED FROM THE SITE.

SHEET KEYED NOTES

1. PROVIDE FREESTANDING 800A ATS FOR USE TO MINIMIZE OUTAGE DOWN TIME. THIS SWITCH SHALL BE REUSED FOR EACH GEAR MOUNTED ATS REPLACEMENT.
2. PROVIDE SOUTHWIRE (OR APPROVED EQUAL) 3-350KCMIL 3,478X30 STRAND LOCOMOTIVE CABLE, AND 1-1/0 1,044 STRAND LOCOMOTIVE (NOT SHOWN) CABLE FOR TEMPORARY USE DURING THE ATS CHANGE-OUT. FIELD VERIFY EXACT LENGTH. PROVIDE PROPER CABLE TERMINATIONS AND SPLICES THAT ARE APPROVED FOR USE WITH THIS TYPE OF CABLE AT ALL TERMINATIONS AND SPLICES.
3. AFTER EXISTING ATS IS DE-ENERGIZED, DISCONNECT THE EXISTING NORMAL, EMERGENCY AND LOAD FEEDS TO THE ATS. TEMPORARILY SPLICE THESE FEEDS INTO THE TEMPORARY ATS USING THE CABLES PER NOTE 2 ABOVE, SO THAT THE LOADS CONNECTED DOWNSTREAM OF THE EXISTING ATS CAN BE RE-ENERGIZED.
4. SPLICE CONTROL WIRING AT EXISTING ATS TO BE REPLACED AND EXTEND WIRING TO TEMPORARY ATS, SO THAT THE TEMPORARY ATS WILL SERVE THE DOWNSTREAM LOADS. SEE "E-500" SERIES SHEETS FOR DETAILS, HOWEVER FIELD VERIFY EXACT TERMINATION REQUIREMENTS.
5. WHEN NEW ATS HAS BEEN INSTALLED, REMOVE ALL TEMPORARY SPLICES FOR POWER AND CONTROLS, AND TERMINATE NEWLY INSTALLED ATS ACCORDING TO MANUFACTURERS REQUIREMENTS. ALL SWITCHES SHALL BE TESTED IN PLACE AND FACTORY CERTIFIED PRIOR TO BEING RE-ENERGIZED. THE CONTRACTOR SHALL SUBMIT DOCUMENTED TEST RESULTS FOR EACH ATS.
6. REPLACE ATS AS STATED IN KEYED NOTES 1-5 ABOVE. RE-USE CABLES, TERMINATIONS AND THE TEMPORARY ATS FOR EACH GEAR MOUNTED ATS REPLACEMENT. COORDINATE WITH HOSPITAL PERSONNEL FOR SHUTDOWN AND RE-ENERGIZING OF EXISTING AND NEW SWITCHES.
7. REMOVE AND REPLACE FREE-STANDING ATS AS SHOWN. SEE DIV. 26 SPECIFICATIONS FOR MORE INFORMATION. THE TEMPORARY ATS WILL NOT BE USED FOR THIS CHANGE-OUT. THE CONTRACTOR SHALL SCHEDULE WITH THE OWNER PRIOR TO BEGINNING WORK, SO THAT AN OUTAGE CAN BE PLANNED FOR THE DURATION OF THE CHANGE-OUT. PROVIDE ATS AS SHOWN AS DESCRIBED IN SPECIFICATIONS AND AS NOTED ON "E-600" SERIES SHEETS.

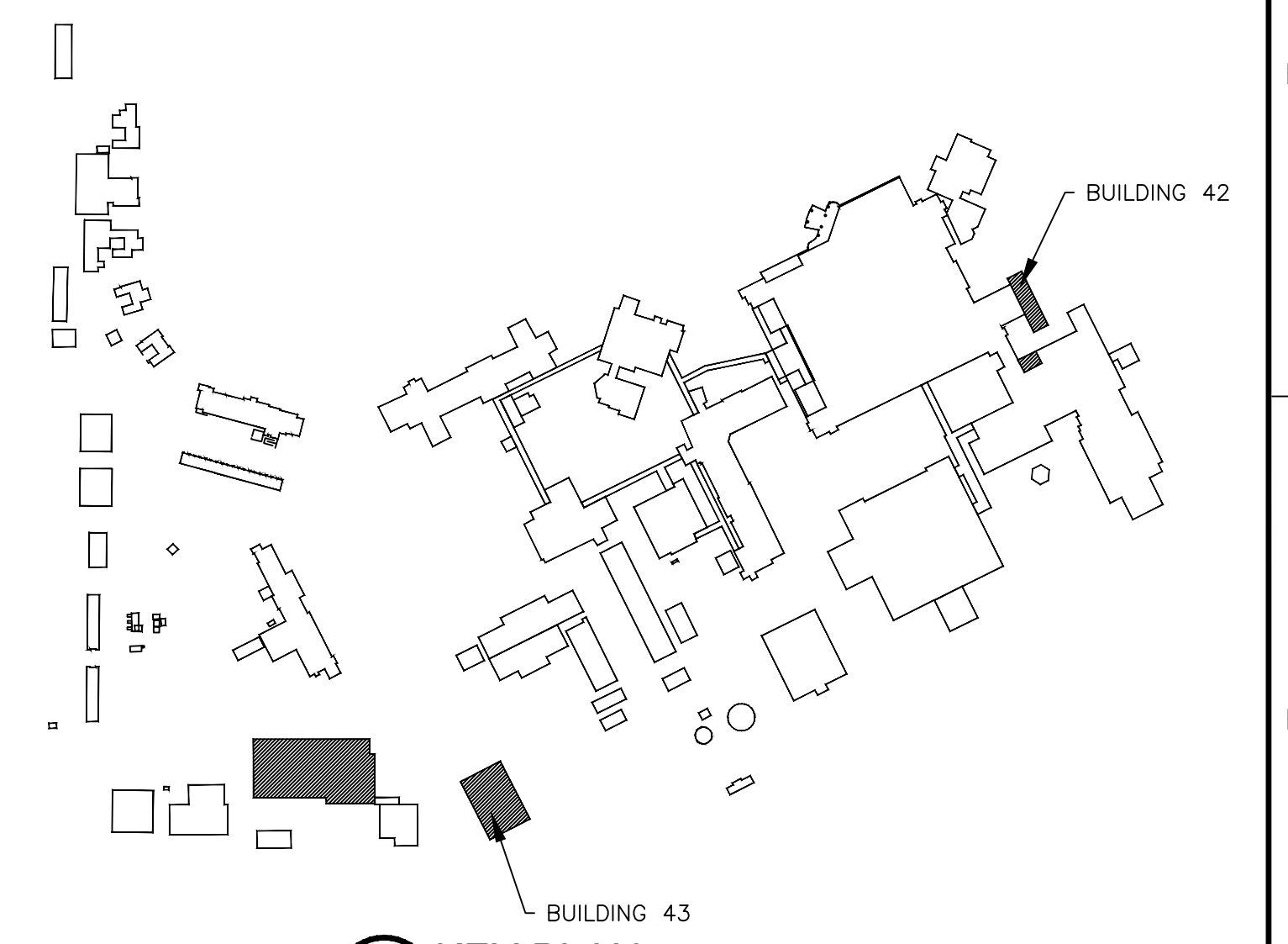

KEY PLAN
NOT TO SCALE: FINAL CONTRACT DOCUMENTS

APPROVED BY:		ARCHITECT/ENGINEERS:		Drawing Title		Project Title		Project Number		Office of Construction and Facilities Management 			
DIRECTOR		CHIEF OF SERVICES		 2800 North 44th Street, Suite 500 Phoenix, Arizona 85008 602/956.8844 2009-0200-00		BUILDING 42 AND 43 ELECTRICAL FLOOR PLANS		RAYMOND G. MURPHY VA MEDICAL CENTER - REPLACE AUTOMATIC TRANSFER SWITCHES				Building Number	
ASSOCIATE DIRECTOR		CHIEF OF PROJECT SECTION										41, 42, 43, 45, 46	
ASSISTANT DIRECTOR						Approved Project Director		Location		Drawing Number			
CHIEF OF ENGINEERING								VA ALBUQUERQUE, NM		ES202			
Revisions		Date						Date		Dwg. of			
								12/07/11		TJC			
								Drawn		LML			