

three inches = one foot  
one and one half inches = one foot  
three quarters inch = one foot  
one half inch = one foot  
three eighths inch = one foot  
one quarter inch = one foot  
one eighth inch = one foot

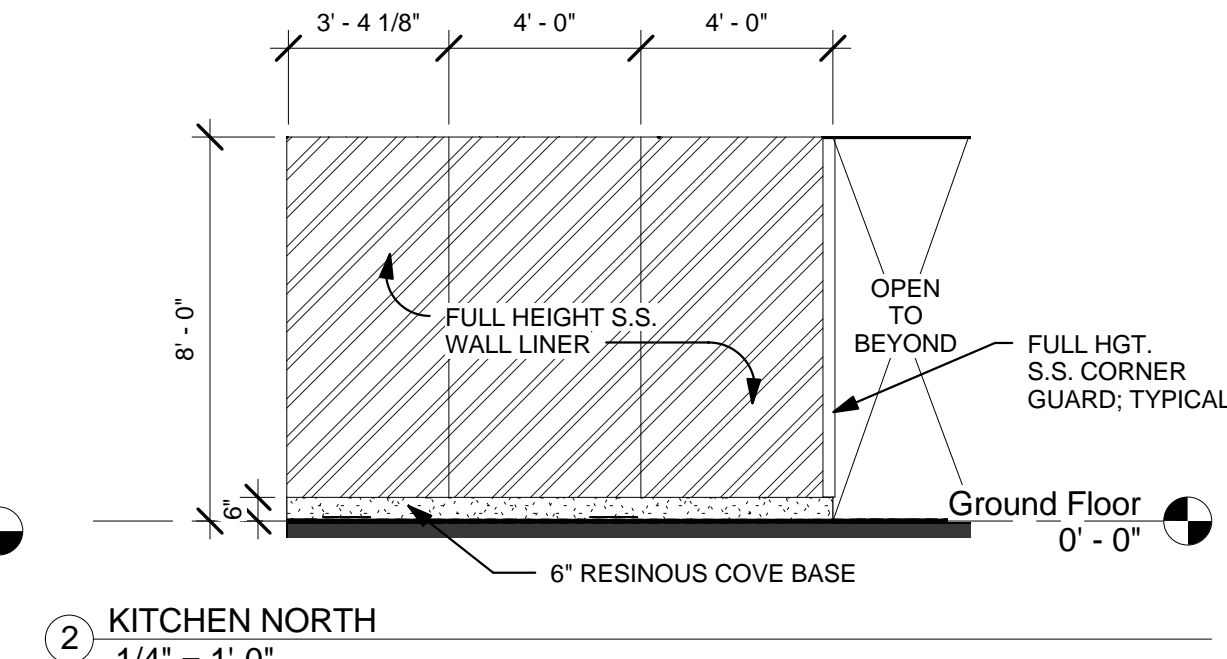
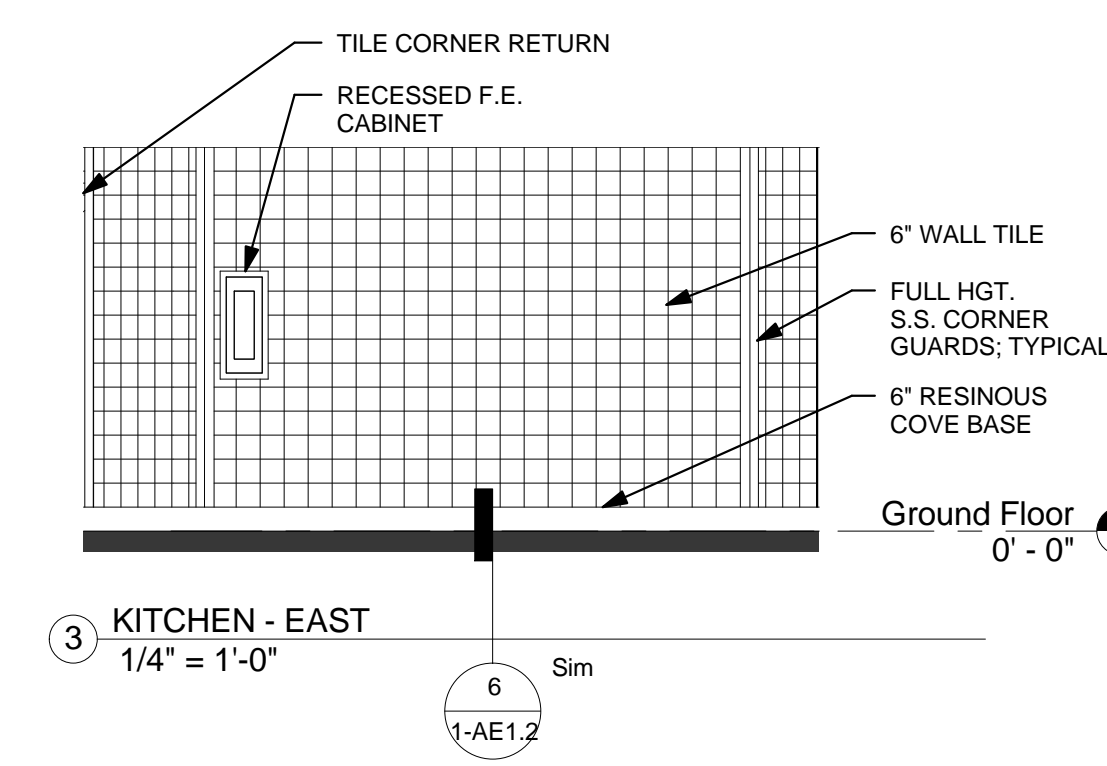
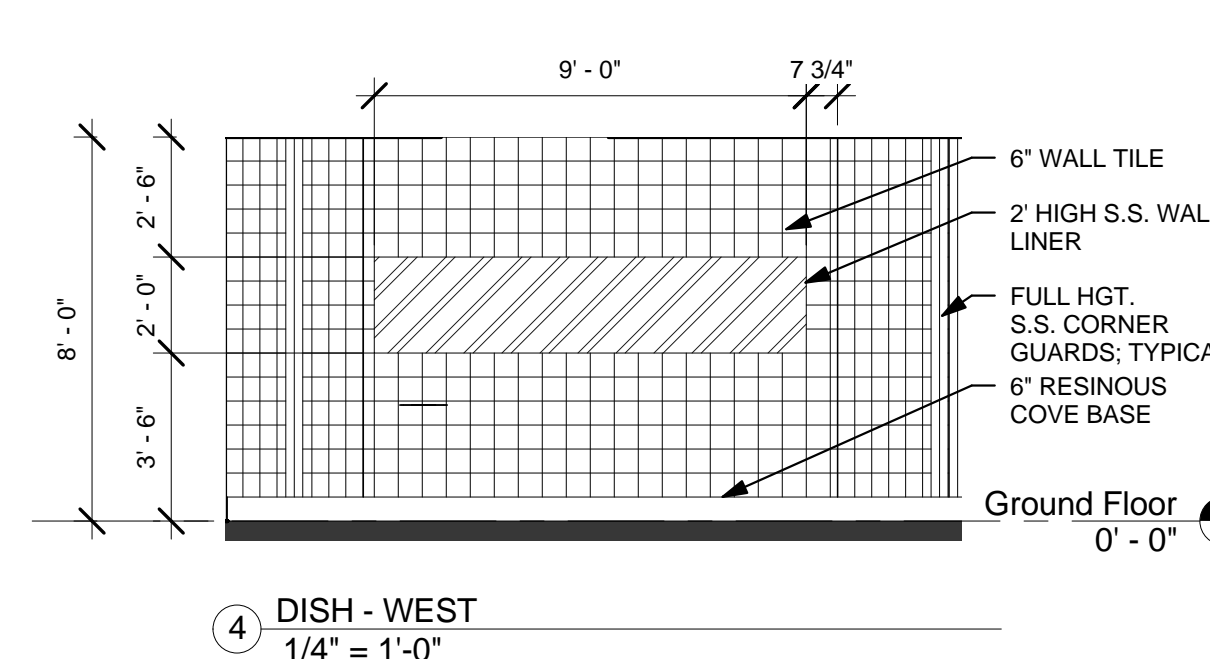
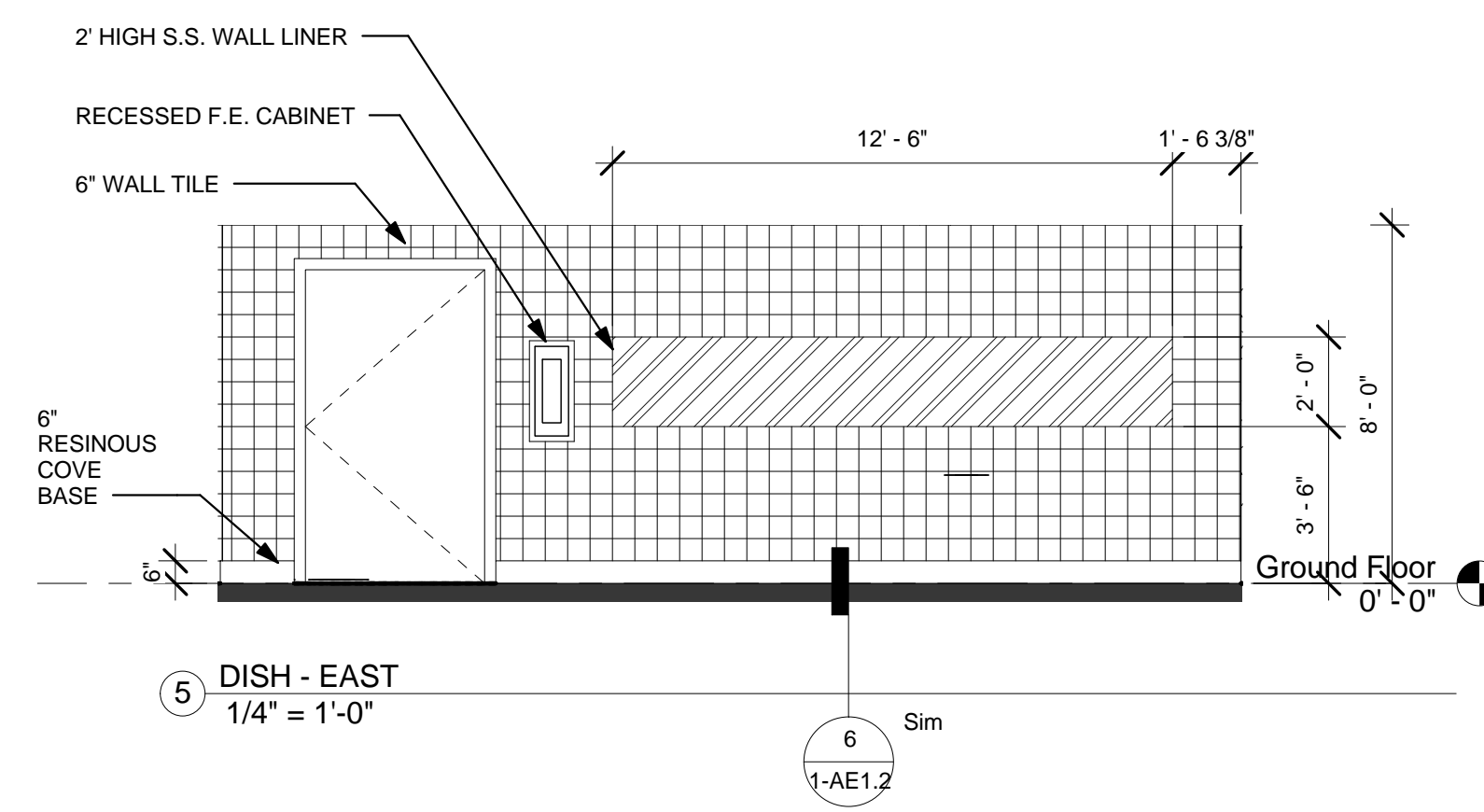
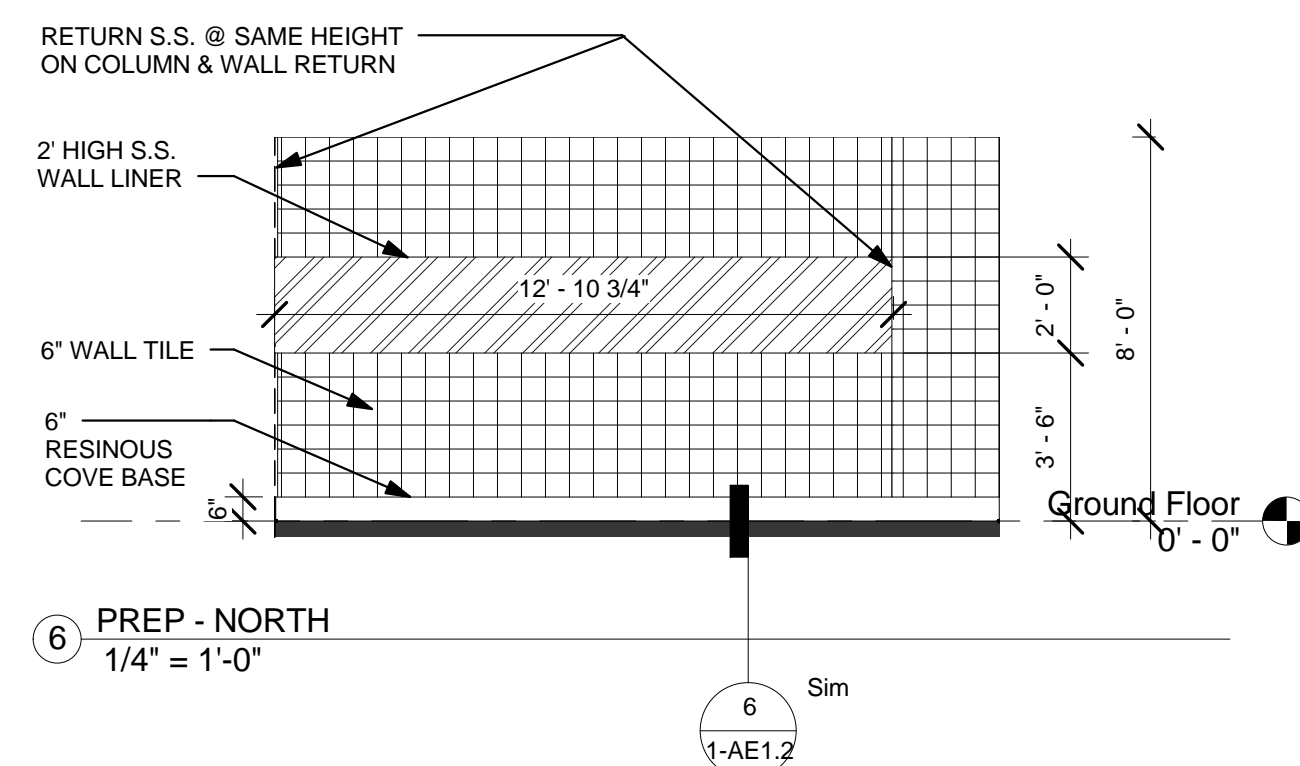
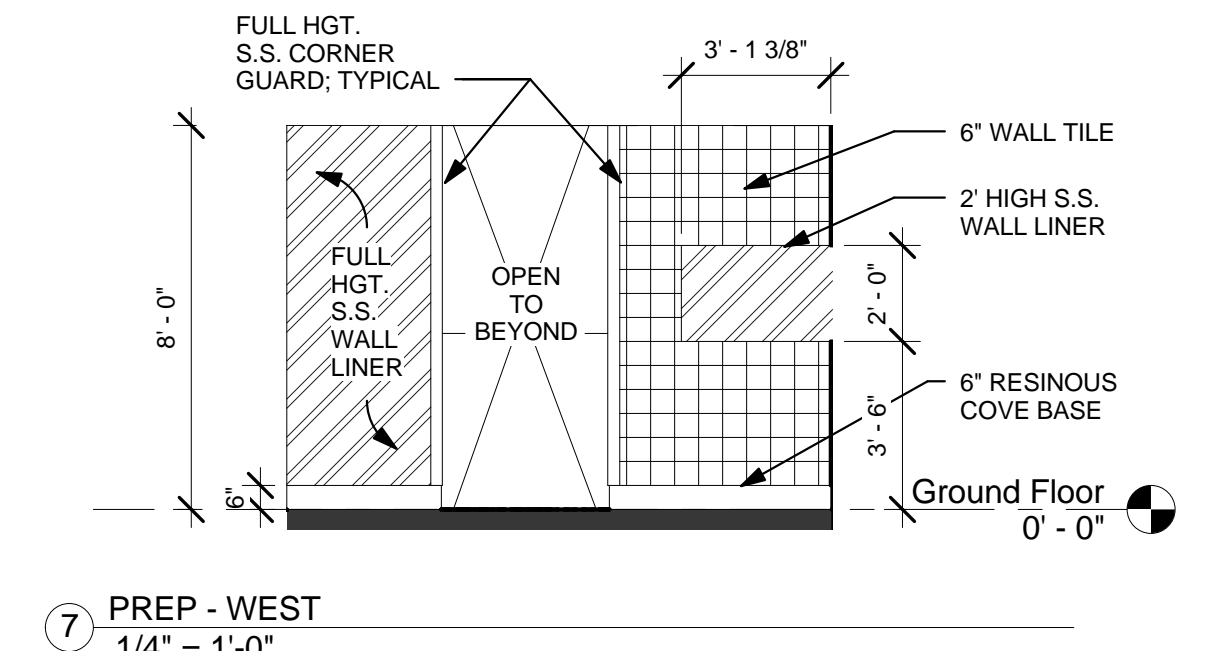
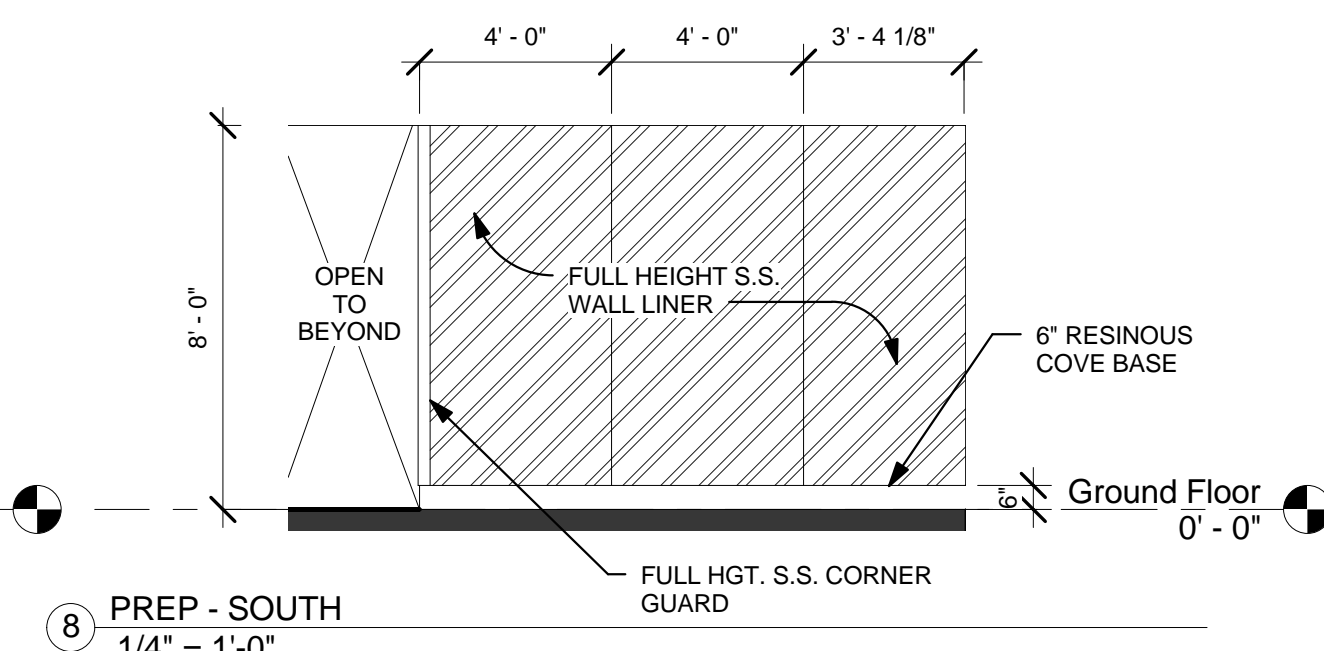
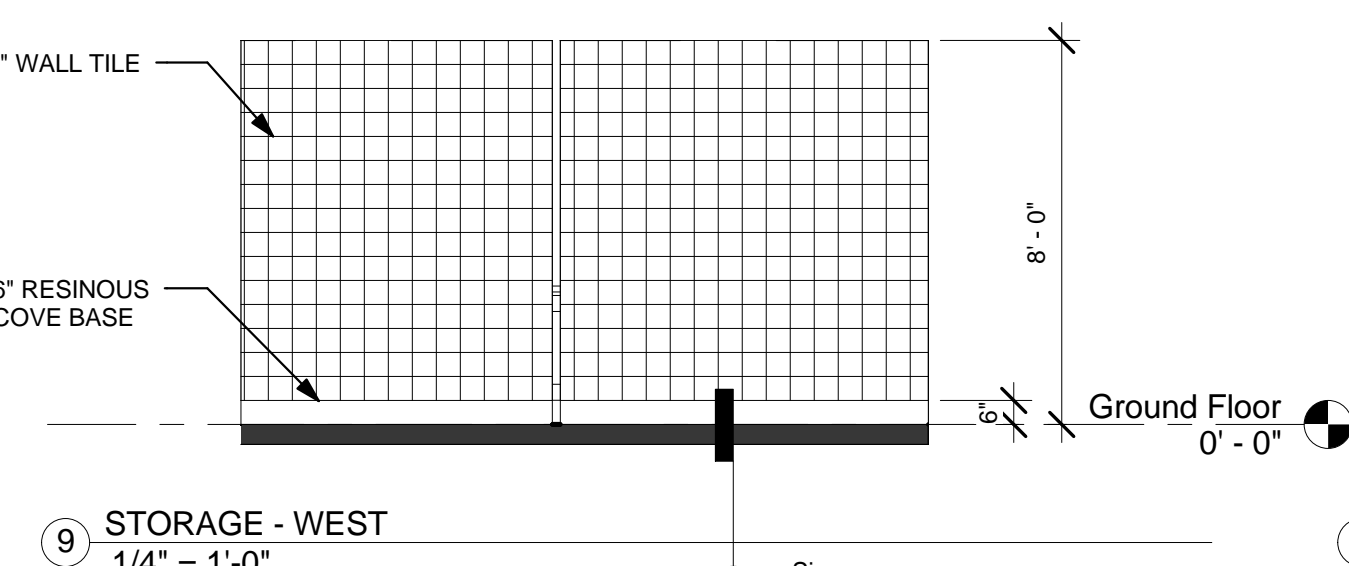
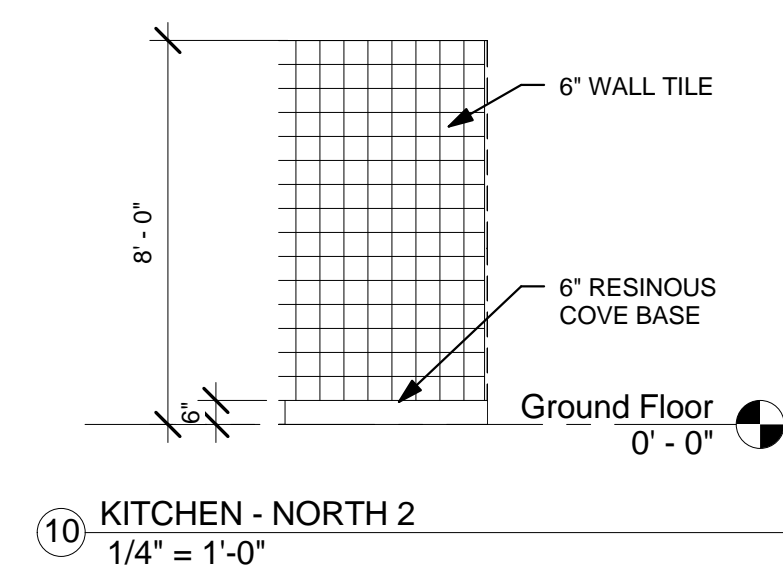
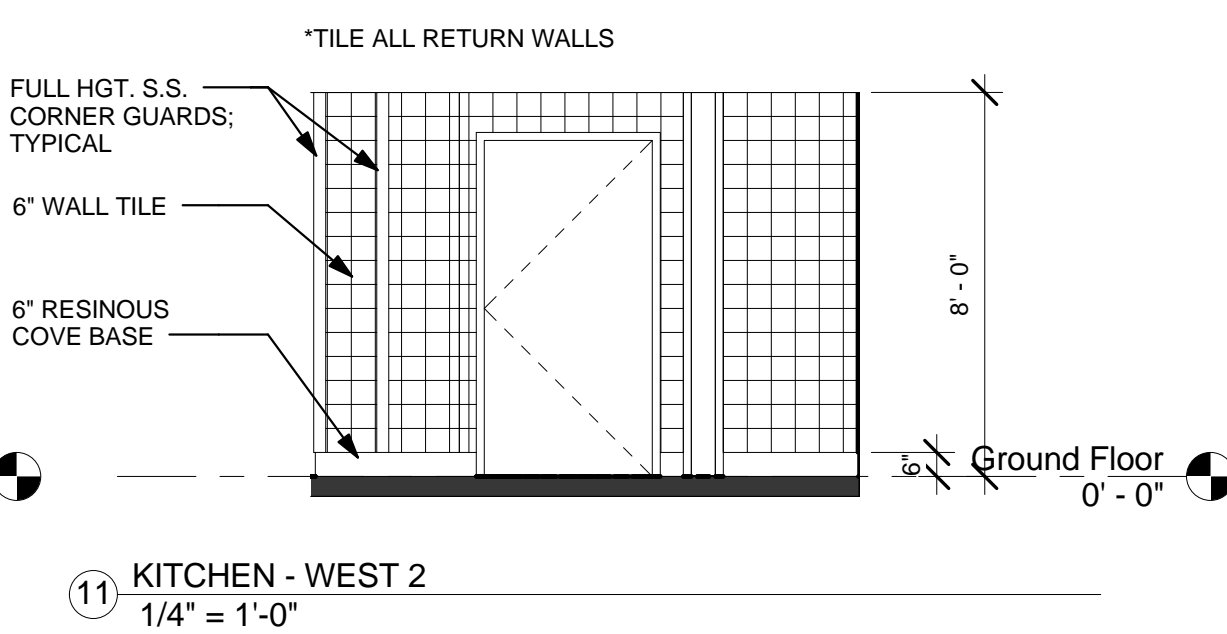
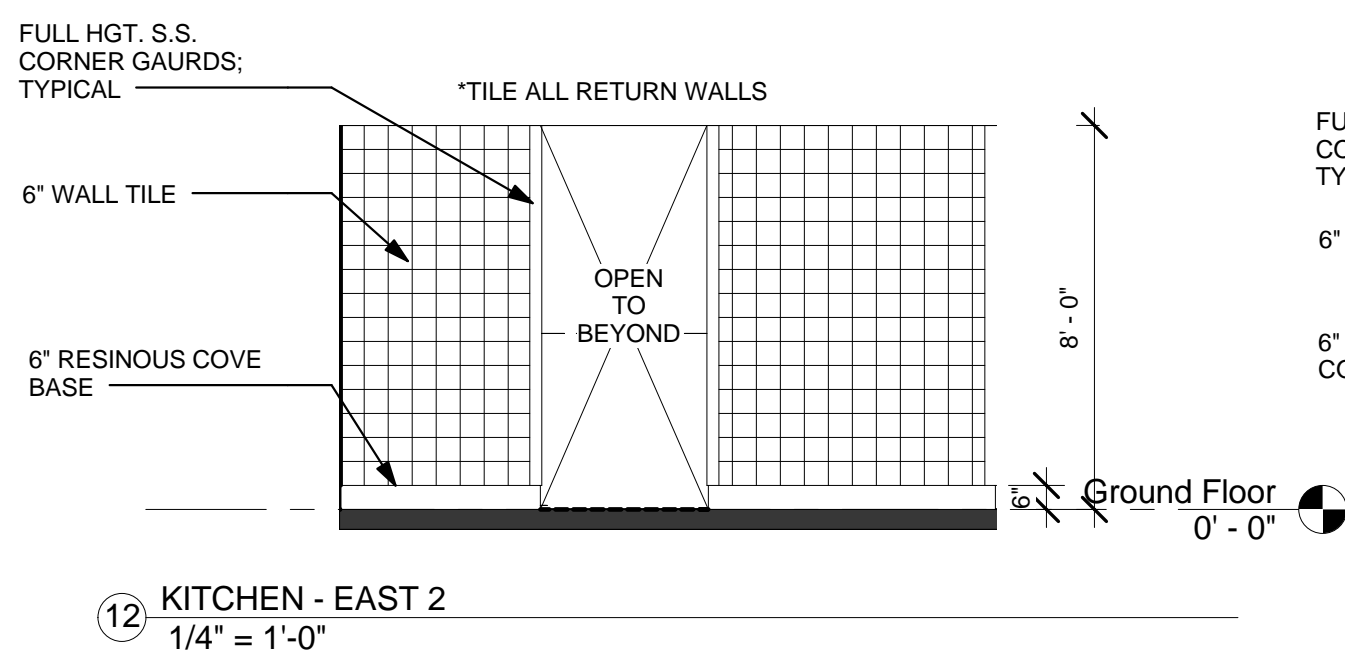
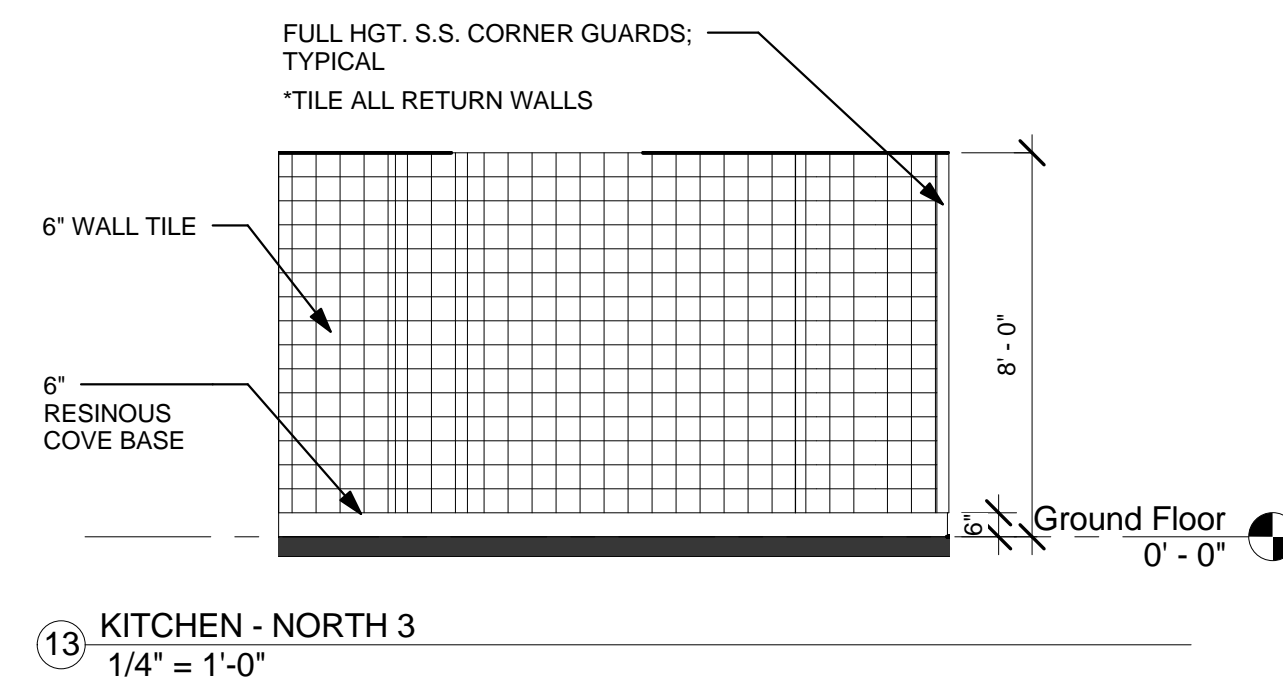
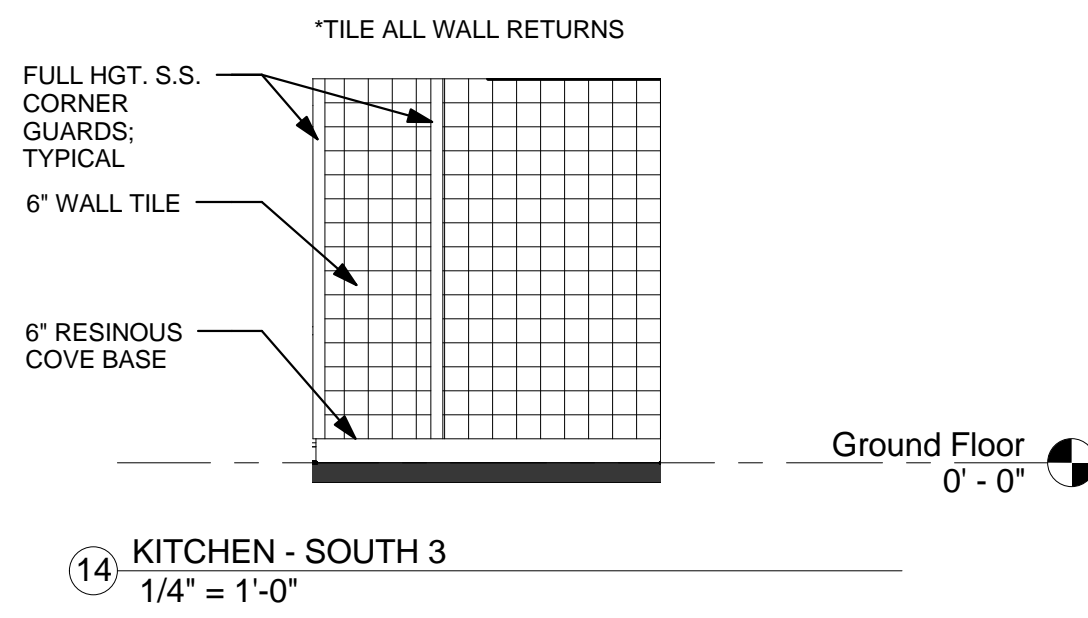
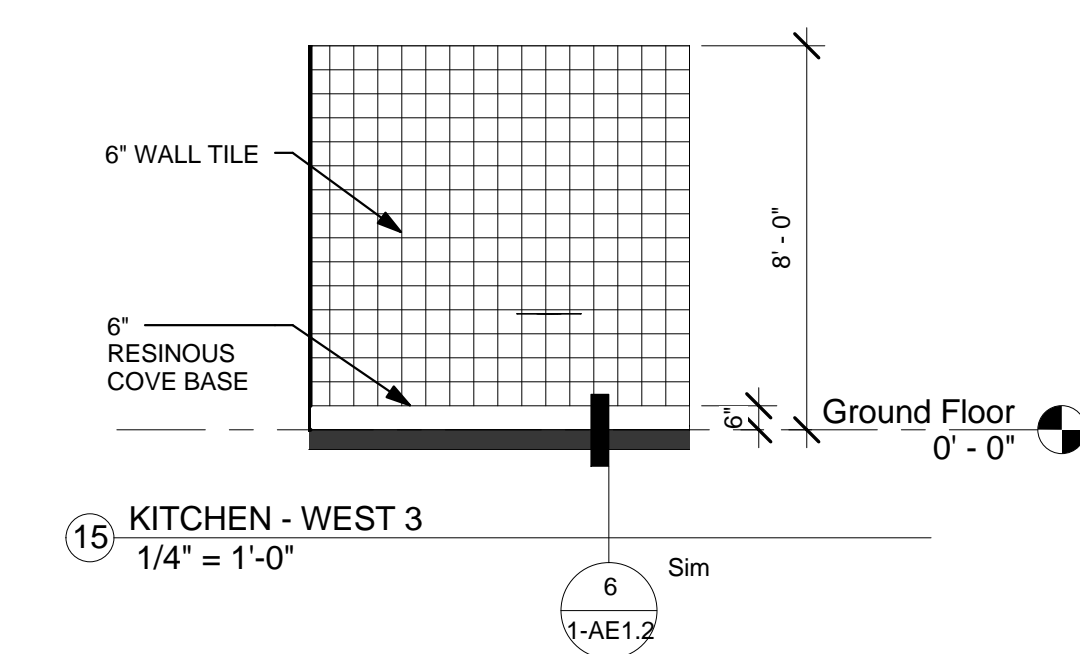

#### KITCHEN TILE PATTERN LEGEND

CT4 - 6"x6" CERAMIC TILE: DALTILE 0161 URBAN PUTTY

#### NOTES:

1. ALL TILE GROUT IN KITCHEN, PREP, DISH, AND STORAGE SHOULD BE EPOXY GROUT.
2. WHERE TILE MEETS A S.S. WALL PANEL, A S.S. TILE TRIM PIECE SHALL BE INSTALLED TO FINISH THE EDGE OF THE TILE.

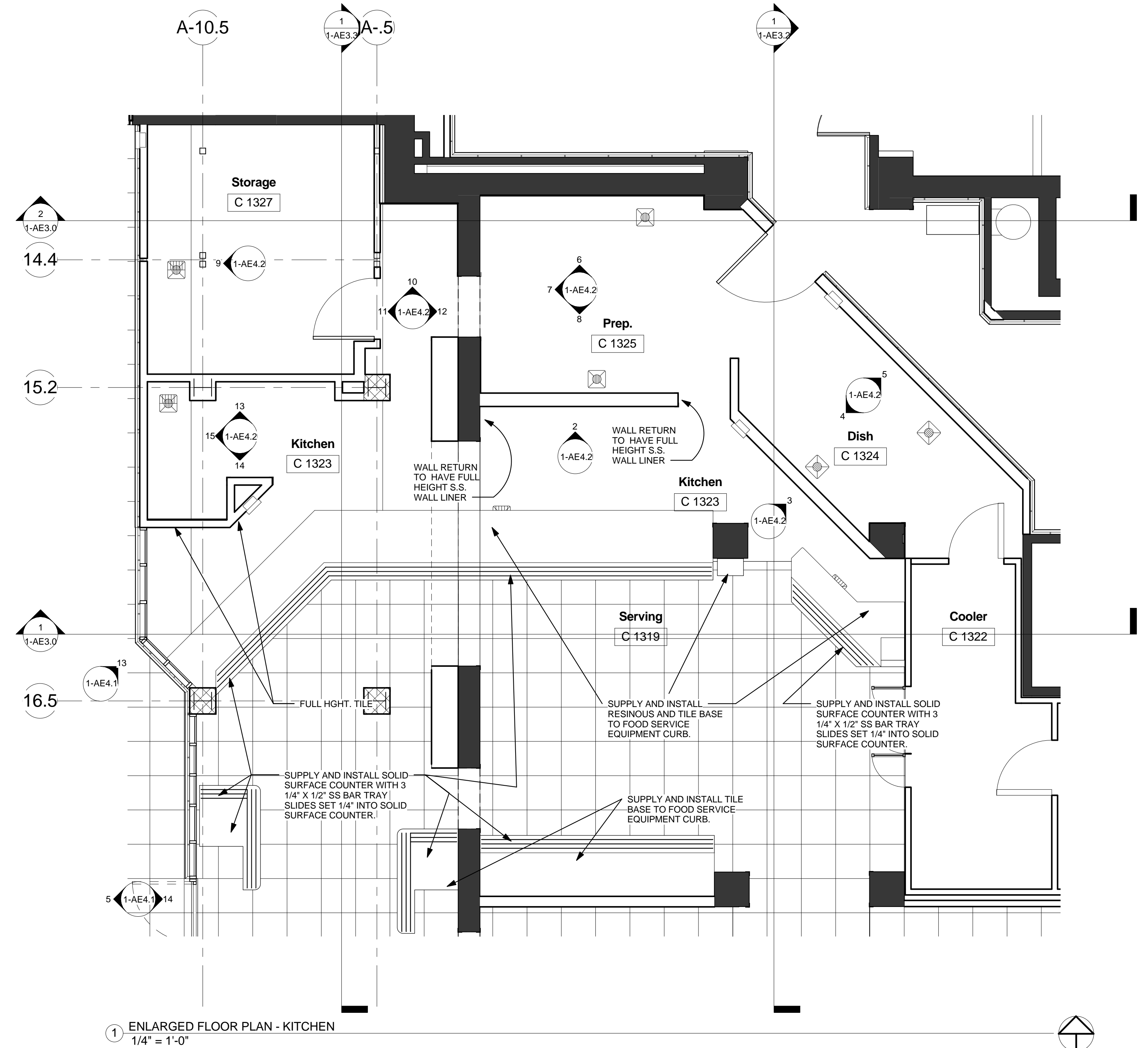

#### ARCHITECT/ENGINEERS:

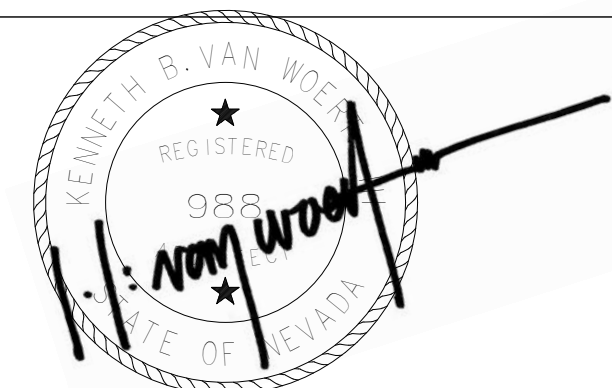

**VanWoert Bigotti**  
architects  
1400 s. virginia st suite c  
reno, nevada 89502  
p: 775.328.1010  
f: 775.328.1020  
info@vwarchitects.com

#### Drawing Title

ENLARGED PLANS AND INTERIOR ELEVATIONS

Approved: Project Director

Project Title  
VA SIERRA NEVADA HEALTH CARE  
SYSTEM - CANTEEN RELOCATION  
DESIGN - RENO, NEVADA

Location  
975 KIRMAN AVE., RENO, NEVADA 89502

Date  
06 JAN. 2012

Checked  
JMT

Drawn  
NH

Project Number  
654-11-227

Building Number  
1

Drawing Number  
1-AE4.2

Dwg. 18 of 22

Office of  
Construction  
and Facilities  
Management

