

# DEPARTMENT OF VETERANS AFFAIRS



**BRUCE W. CARTER MEDICAL CENTER**  
**1201 NW 16TH STREET - MIAMI, FL 33125**

# REPURPOSE EXISTING SPACE TO EXPAND WOMEN'S CLINIC FIRST FLOOR BLDG 1

**PROJECT NUMBER - 546-15-105**  
**FINAL SUBMITTAL**  
**JUNE 28, 2016**

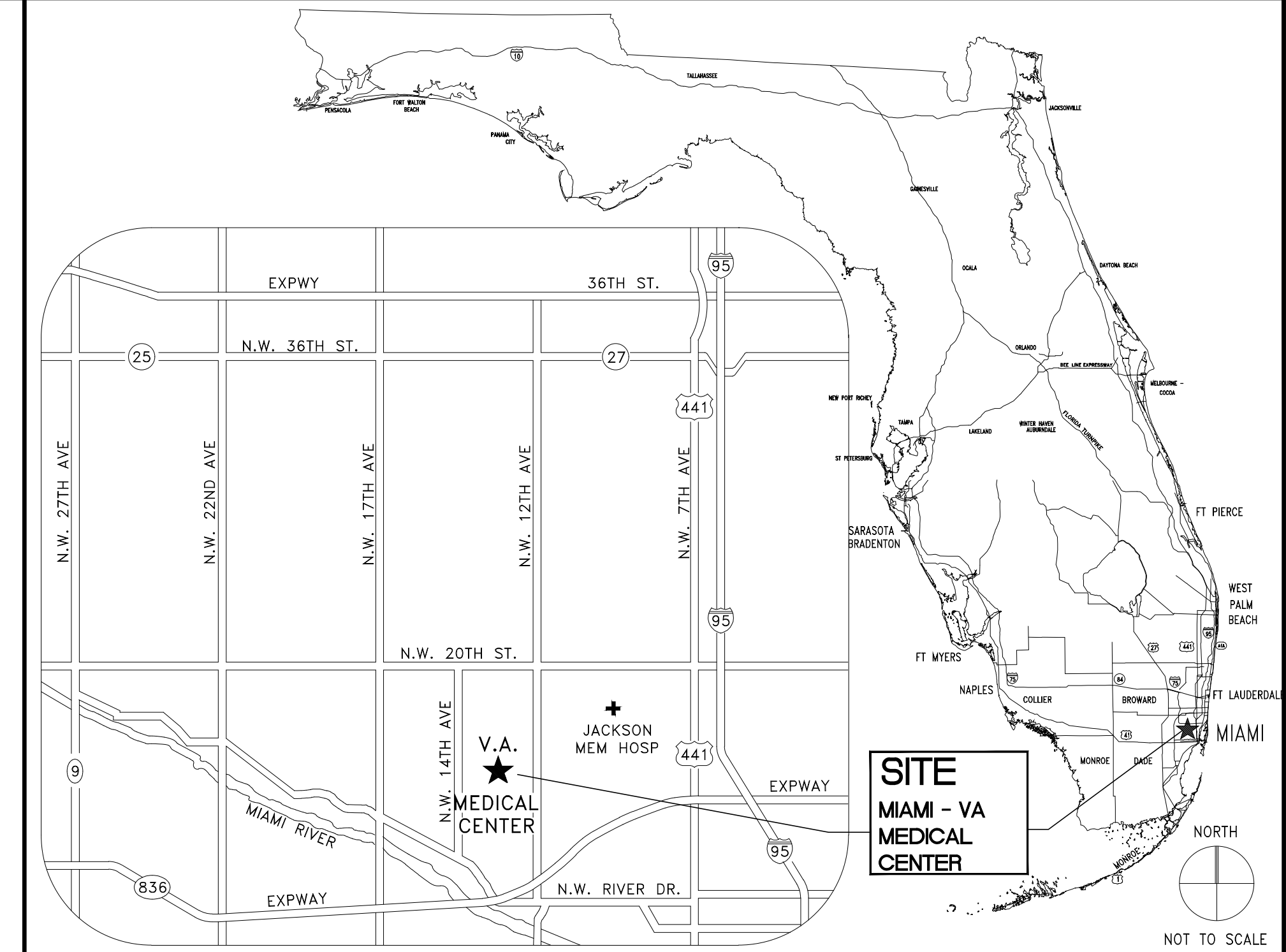

**STATE MAP**

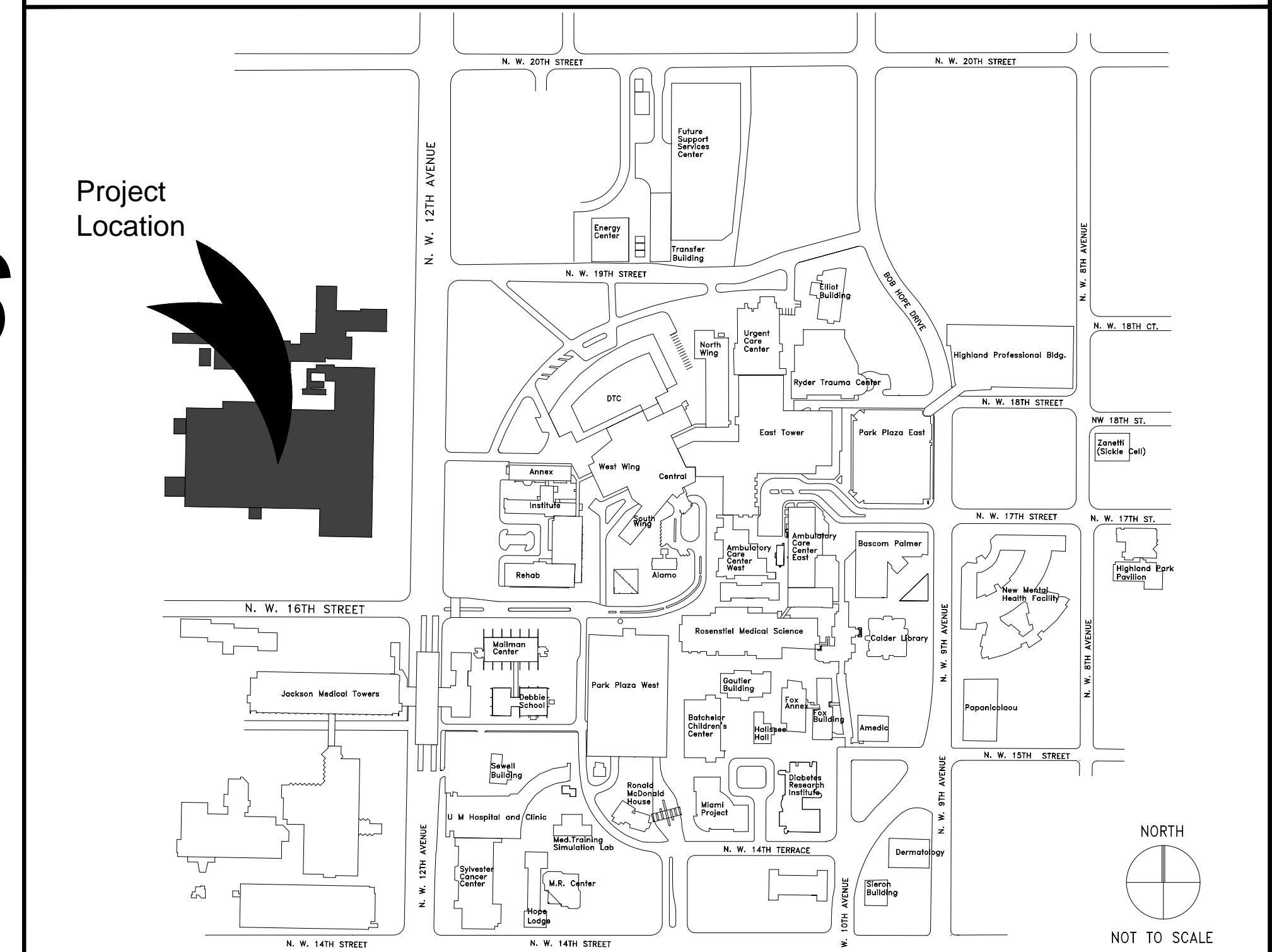

**VICINITY MAP**

**INDEX OF DRAWINGS**

<b>GENERAL</b>	<b>FIRE PROTECTION</b>
G-001 COVER, INDEX OF DRAWINGS AND LOCATION MAP	FP-001 FIRE PROTECTION SCHEDULES, DETAILS AND NOTES
G-002 GENERAL NOTES, SYMBOLS AND ABBREVIATIONS	FP-100 PARTIAL FIRST FLOOR PLAN - RENOVATION - FIRE PROTECTION
G-003 GENERAL NOTES, WORK HOURS AND RESTRICTIONS	
G-004 FIRST FLOOR PLAN - COMPOSITE	
<b>LIFE SAFETY</b>	<b>PLUMBING</b>
LS-101 PARTIAL FIRST FLOOR PLAN - RENOVATION - LIFE SAFETY	PL-001 PLUMBING GENERAL NOTES AND LEGEND
	PL-002 PLUMBING DETAILS AND SCHEDULES
	PD-100 PARTIAL BASEMENT PLAN - DEMOLITION - PLUMBING
	PD-101 PARTIAL FIRST FLOOR PLAN - DEMOLITION - PLUMBING
	PL-200 PARTIAL BASEMENT FLOOR PLAN - RENOVATION - PLUMBING
	PL-201 PARTIAL FIRST FLOOR PLAN - RENOVATION - PLUMBING
	PL-202 PLUMBING RISER DIAGRAMS
<b>ARCHITECTURAL</b>	<b>MECHANICAL</b>
AD101 PARTIAL FIRST FLOOR PLAN - DEMOLITION	MH-001 MECHANICAL GEN. NOTES, LEGEND, AND DESIGN CRITERIA
A-101 PARTIAL FIRST FLOOR PLAN - RENOVATION - ARCHITECTURAL	MH-002 MECHANICAL SCHEDULES
A-102 PARTIAL FIRST FLOOR PLAN - RENOVATION - DIMENSIONED	MD-100 PARTIAL FIRST FLOOR PLAN - DEMOLITION - MECHANICAL
A-201 PARTIAL FIRST FLOOR PLAN - RENOVATION - REFLECTED CEILING PLAN	MD-101 PARTIAL FIRST FLOOR PLAN - DEMOLITION - MECHANICAL PIPING
A-301 SECTIONS	MH-200 PARTIAL FIRST FLOOR PLAN - RENOVATION - MECHANICAL
A-401 INTERIOR ELEVATIONS	MP-201 PARTIAL FIRST FLOOR PLAN - RENOVATION - MECHANICAL PIPING
A-501 MILL WORK DETAILS	MH-202 MECHANICAL DETAILS
A-601 DOOR SCHEDULE AND DETAILS	MI-203 MECHANICAL CONTROL DETAILS
A-602 DETAILS	
	<b>ELECTRICAL</b>
	E100 ELECTRICAL GEN. NOTES AND LEGEND
	ED100 PARTIAL FIRST FLOOR ELECTRICAL DEMOLITION PLAN
	E200 PARTIAL FIRST FLOOR LIGHTING PLAN
	E300 PARTIAL FIRST FLOOR POWER PLAN
	E301 PARTIAL FIRST FLOOR TELECOMM + SIGNAL PLAN
	E500 ELECTRICAL DETAILS
	E600 ELECTRICAL SCHEDULES

ENGINEERING PLANNING & ANALYSIS

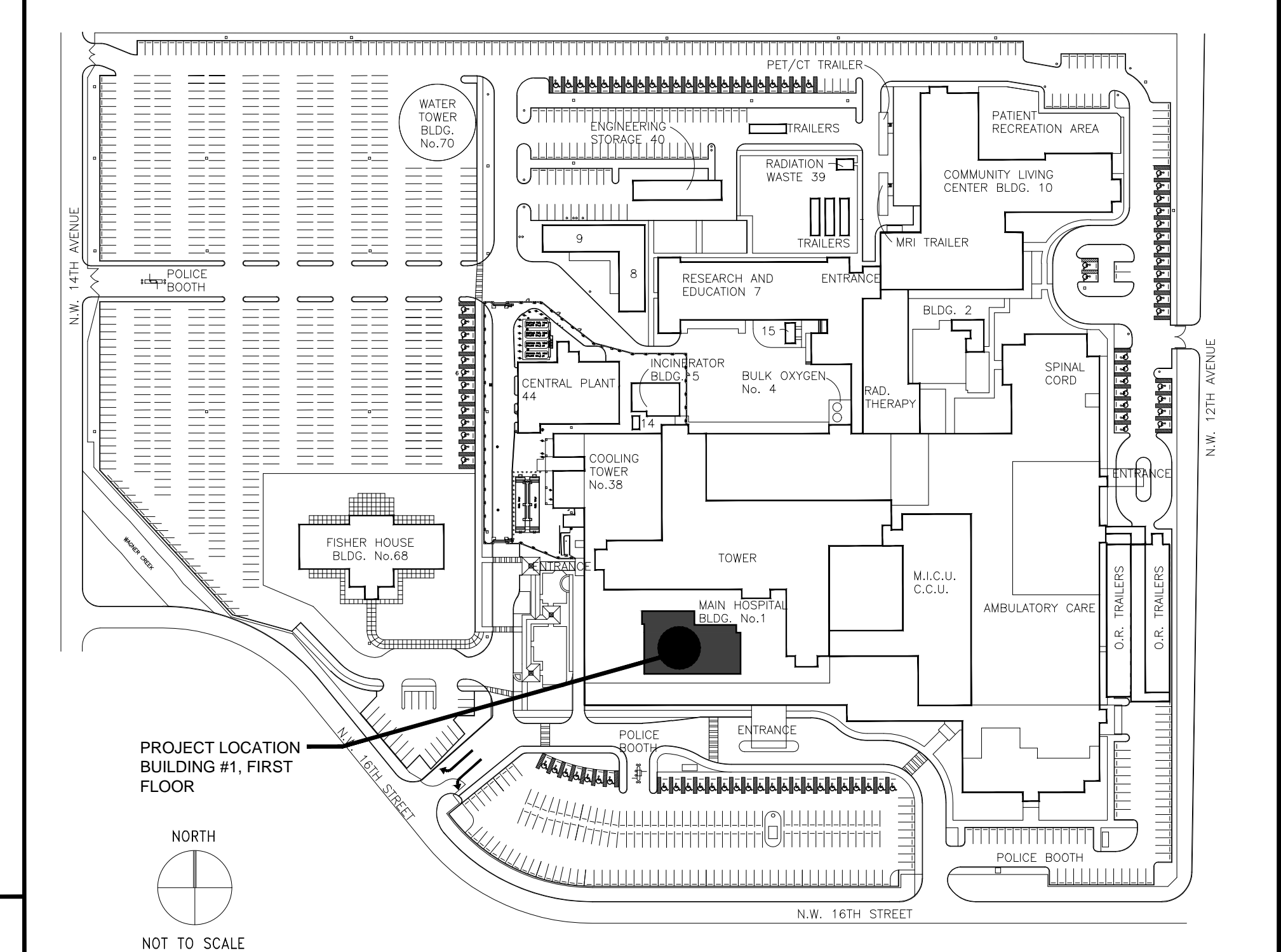

**LOCATION MAP**

**FINAL SUBMITTAL**

CHANGES FOR AMENDMENT	DATE

<b>CONSULTANTS:</b>	
---------------------	--

<b>ARCHITECT/ENGINEERS:</b> <b>DEANE + STROLLO, LLC</b> 718 Virginia Drive Orlando, FL 32803 T: (407) 423-5355 F: (407) 422-5994	<b>ENGINEERING - BROOKS ENGINEERING</b> 1324 E. 24th Street - Sanford, FL 32771 T: (407) 898-8344 F: (407) 540-9403
--	---

CONTRACTING OFFICER: ELISSA GOODMAN TEL. (954)475-5500 X5747  
COR: WISELL ALBINO TEL. (305) 324-4455 X4000  
D+S PRINCIPAL: JIM STROLLO TEL. (407)423-5355

<b>Drawing Title</b> COVER, INDEX OF DRAWINGS AND LOCATION MAP
<b>Approved:</b> Project Director

<b>Project Title</b> REPURPOSE EXISTING SPACE TO EXPAND WOMEN'S CLINIC FIRST FLOOR BLDG 1	<b>Project Number</b> 546-15-105
<b>Location</b> 1201 NW 16th ST, MIAMI, FL	<b>Drawing Number</b> G-001
<b>Date</b> JUNE 28, 2016	<b>Checked</b> JS, KS
<b>Drawn</b> GC	<b>Dwg.</b> 1 of -

