

Correct Heating, Building 51 Basement

Veteran's Affairs Medical Center

St. Cloud, Minnesota

SHEET INDEX

GENERAL

X1 COVER SHEET/LOCATION PLAN AND KEY PLAN

MECHANICAL

HI HVAC PIPING PLAN, HEATING WATER PIPING SCHEMATIC,
HEATING SYSTEM CONTROL DIAGRAM, AND ELECTRICAL PLANS

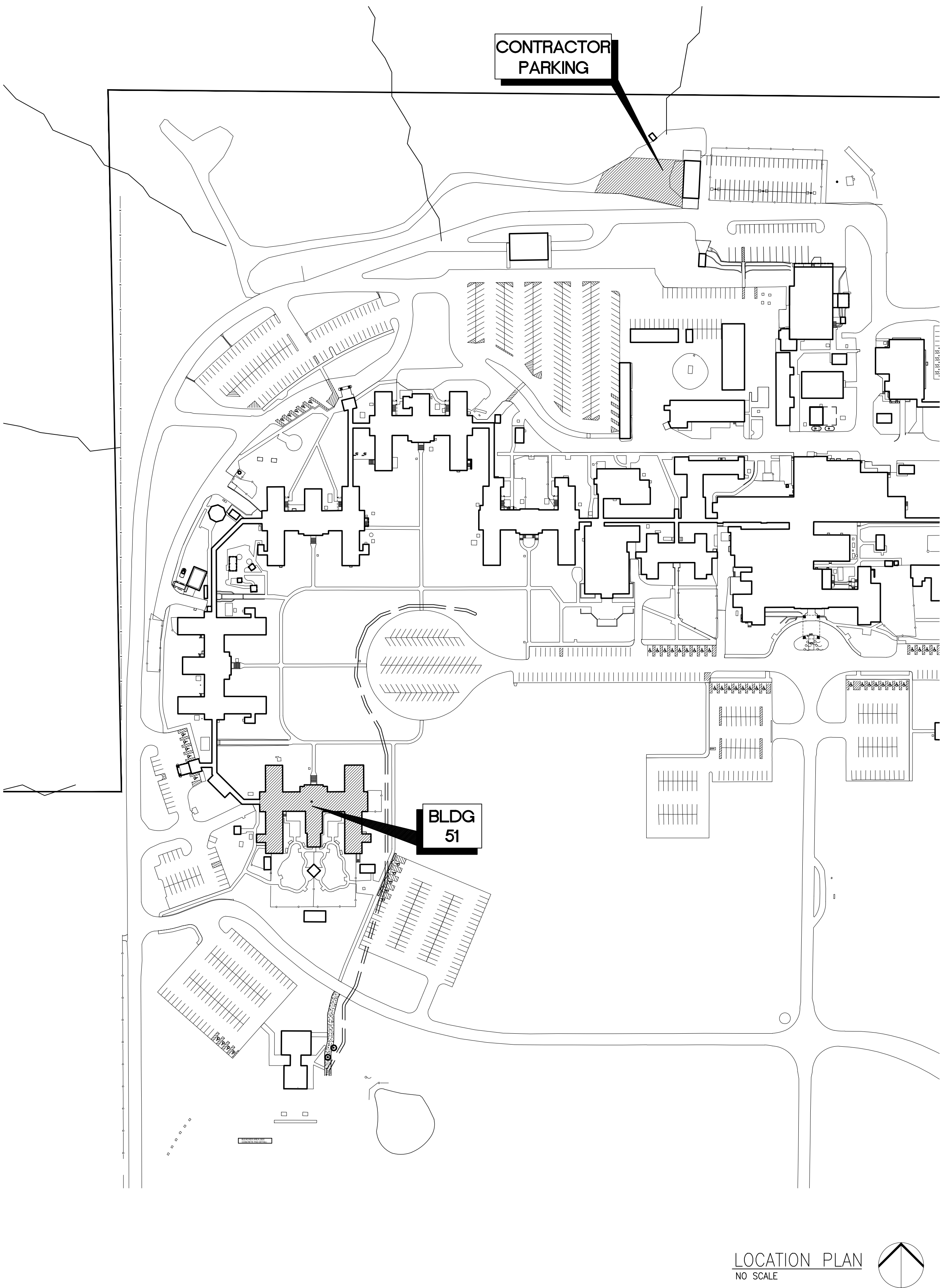

LOCATION PLAN
NO SCALE

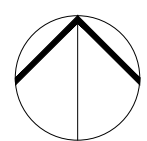

GENERAL CONDITIONS

ALL DIMENSIONS ON DRAWINGS ARE APPROXIMATE; DRAWINGS ARE NOT TO BE SCALED. IT IS THE RESPONSIBILITY OF THE CONTRACTOR TO VERIFY ALL FIELD CONDITIONS AND PHYSICAL DIMENSIONS THAT INFLUENCE THE CONSTRUCTION AREA.

IT IS RECOMMENDED THAT CONTRACTORS VISIT THE PROPOSED CONSTRUCTION SITE PRIOR TO SUBMITTING THEIR BIDS AND THEY ARE ENCOURAGED TO DO SO.

CONTRACTOR SHALL ADHERE STRICTLY TO STATE AND FEDERAL OCCUPATIONAL SAFETY AND HEALTH ADMINISTRATION (OSHA) STANDARDS.

CONTRACTOR SHALL PARK ONLY IN THE DESIGNATED PARKING AREAS AND ARE NOT TO PARK ON THE LAWN AREAS, THE ONLY EXCEPTION IS TO LOAD OR UNLOAD SUPPLIES OR EQUIPMENT.

CONTRACTOR IS RESPONSIBLE FOR THE SAFEGUARDING OF THEIR TOOLS AND EQUIPMENT. ALL TOOLS AND EQUIPMENT ARE NOT TO BE LEFT UNATTENDED AND ARE TO BE SECURED AT ALL TIMES WHEN THE CONTRACTOR IS NOT PRESENT, OR THE CONSTRUCTION SITE IS NOT SUPERVISED BY THE CONTRACTOR.

ALL VA PROPERTY IS TO BE SAFEGUARDED FROM DAMAGE. ANY DAMAGED VA PROPERTY IS TO BE RESTORED TO ORIGINAL CONDITION PRIOR TO DAMAGE OR REPLACED COMPLETELY. THIS INCLUDES INSTALLATION, LABOR, AND PROCUREMENT EXPENSES.

ALL DEMOLISHED MATERIAL BECOMES THE PROPERTY AND THE RESPONSIBILITY OF THE CONTRACTOR WITH THE EXCEPTION OF SPECIFIED ITEMS DESIGNATED OTHER IN THE PLANS OR VERBALLY REQUESTED BY THE CONTRACTOR TO BE RETAINED BY THE VA. OFFSITE DISPOSAL OF THE DEMOLISHED ITEMS IS THE RESPONSIBILITY OF THE CONTRACTOR.

CONTRACTOR MUST CONTROL DEMOLITION AND CONSTRUCTION DUST FROM FACILITY BY ERECTING A DUST BARRIER AND VENTILATION WITH HEPA FILTERS. IF VENTING TO OUTSIDE, THE CONTRACTOR WILL MAINTAIN NEGATIVE AIR PRESSURE IS MAINTAINED IN ENCAPSULATED WORK AREA, WHEN TRANSPORTING DEBRIS, WET DOWN SUFFICIENTLY TO PREVENT DUST SPREADING.

IF SCAFFOLDING IS USED, IT MUST BE USED IN ACCORDANCE WITH OSHA REGULATIONS AND IS TO BE ENCLOSED FOR THE FIRST EIGHT FEET ABOVE GROUND AT END OF EACH WORKING DAY, UNTIL DEMANTLED. JACKERS MUST BE REMOVED AND LOCKED UP AT THE END OF EACH WORKING DAY TO PREVENT UNAUTHORIZED PERSONS FROM HAVING ACCESS.

CLEAN ALL DEBRIS FROM CONSTRUCTION SITE TO THE SATISFACTION OF THE CONTRACTOR.

CONTRACTOR IS RESPONSIBLE FOR ERECTING A BARRIER AROUND WORK SITE TO PREVENT PATIENTS, STAFF, AND VISITORS FROM ENTERING CONSTRUCTION SITE. THIS FENCE MAY BE A PLASTIC SNOW FENCE. COORDINATE CONSTRUCTION MATERIALS AND LOCATION OF FENCE WITH CONTRACTOR.

CONTRACTOR IS RESPONSIBLE FOR REPAIRING AND REPLACING ANY DAMAGED LAWN. THE RESTORATION WILL BE PERFORMED BY A LANDSCAPE CONTRACTOR THAT REGULARLY DOES SCODING AS PART OF THEIR BUSINESS. ALL DAMAGED LAWN WILL BE OVERLIFT BY 6" OR MORE TO ACCOMMODATE FULL WIDTH ROLLS OF SOIL. TOP SOIL TO BE TILLED AND GRADED TO A SMOOTH MATCHING GRADE OF UNDAUNAGED LAWN. SOIL TO BE THOROUGHLY SATURATED WITH WATER UPON PLACEMENT. THE CONTRACTOR IS RESPONSIBLE FOR WATERING NEW SOIL UNTIL PROJECT ACCEPTANCE BY THE CONTRACTOR.

ACCESS TO ALL BUILDINGS AND PARKING AREAS MUST BE MAINTAINED THROUGHOUT THE PROJECT.

CONTRACTORS ARE TO COORDINATE ALL WORK WITH THE CONTRACTING OFFICERS TECHNICAL REPRESENTATIVE (COTR).

APPROVED SERVICE LINE DIRECTOR	DATE	APPROVED INFECTION CONTROL NURSE	DATE	DRAWING TITLE	PROJECT TITLE	DATE
APPROVED SERVICE LINE DIRECTOR	DATE	APPROVED PATIENT SAFETY	DATE	COVER SHEET	CORRECT HEATING,	MARCH 29, 2012
APPROVED PROJECTS SECTION MANAGER	DATE	APPROVED CHIEF OF POLICE	DATE	LOCATION PLAN AND KEY PLAN	BUILDING 51 BASEMENT	PROJECT NO. 656-12-
APPROVED DIRECTOR FMS	DATE	APPROVED SAFETY MANAGER	DATE	APPROVED CHIEF OF STAFF	BUILDING NO. 51	DRAWN BY RM KS
				APPROVED MEDICAL CENTER DIRECTOR	LOCATION	SUB FILE
					V.A. MEDICAL CENTER	DWG. NO. X1
					ST. CLOUD, MN 56303	1 OF 2

I hereby certify that this plan specification, or report was prepared by me or under my direct supervision, and that I am duly Registered Architect under the laws of the State of Minnesota.

Russ Mann
Date 3-29-2012, Reg. No. 21365

