

A

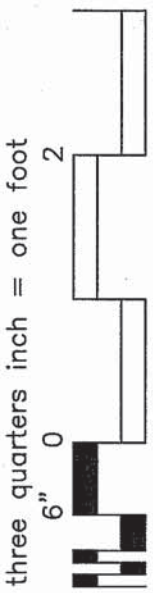

B

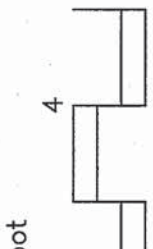

C

5.S-111.dwg 6-16-14 02:11:49 PM apytlak

5  
EI

5  
K

5  
L

8'-8"

10'-8"

SHEAR KEY

BP-3, AB-2

(0")  
(-1'-0")

B3  
S-503

1'-0"

(-1'-0")

1

2

5  
E3

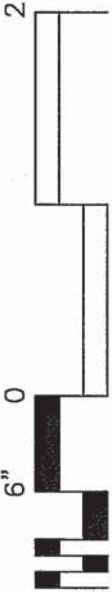

A

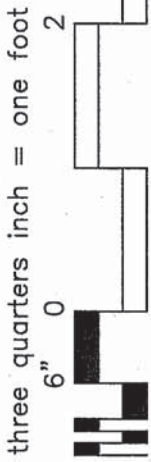

B

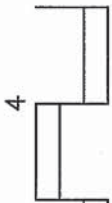

C

05.S-112.dwg 6-16-14 02:11:53 PM apytlak

5  
E1

5  
K

5  
L

10'-8"

C5  
05.S-200

W12x22

BRACE

HSS16x8x5/16  
BRACE

STAIR OPNG  
STAIR FRAMING  
SEE E1/S-551

C6  
05.S-200

C6  
S-552

3  
E.C.

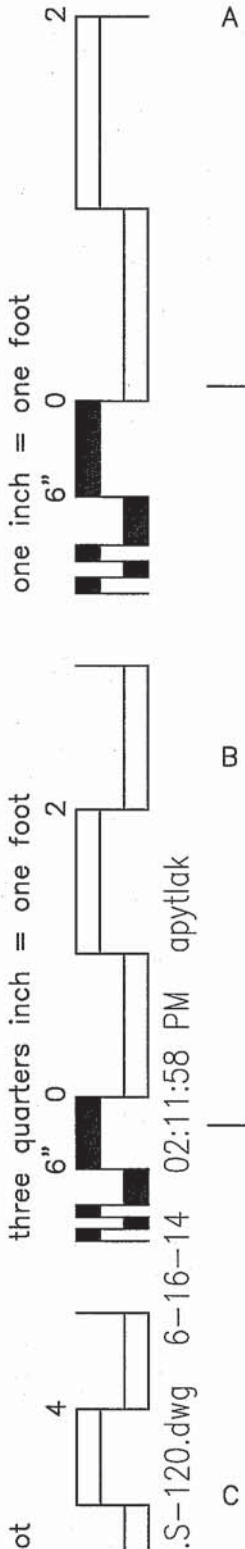

one inch = one foot

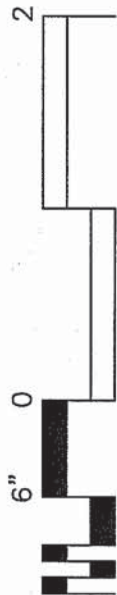

A

three quarters inch = one foot

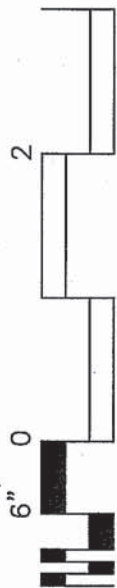

B

foot

4



C

5.S-121.dwg 6-16-14 02:12:03 PM apytak

5  
EC.9

5  
ED

5  
EE

5  
EF

1

2

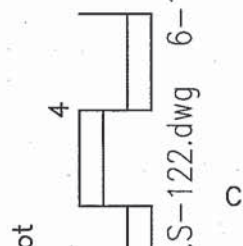
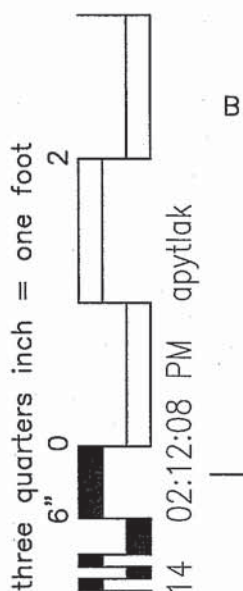
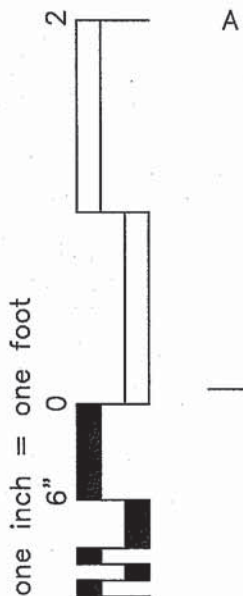
5  
EC.95  
ED5  
EE5  
EFB4  
S-553B4  
S-5523/8" BE  
E3  
S-552

S-122.dwg 6-16-14 02:12:08 PM apylak

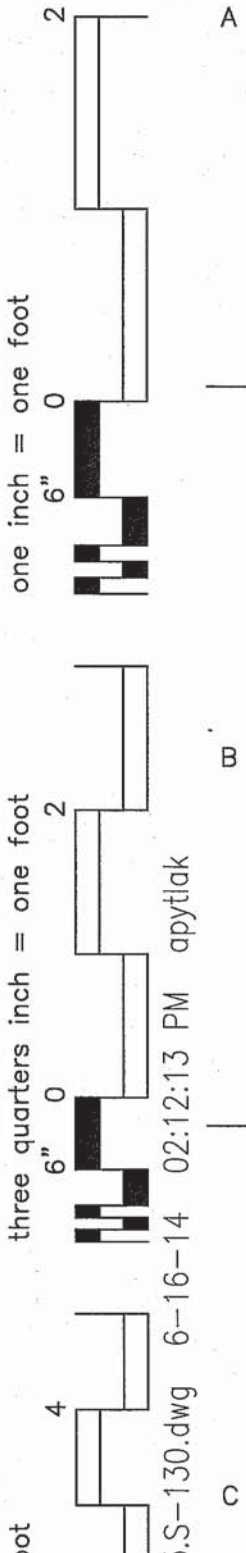

1

2

5  
E5

5  
E6

A

B

C

one inch = one foot

three quarters inch = one foot

.S-131.dwg 6-16-14 02:12:18 PM apytlak

8" THICKENED SLAB STAIR  
STRINGER SUPPORT

1'-0"



1

2

5  
E4

5  
E5

5  
E6

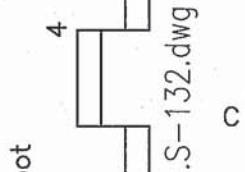
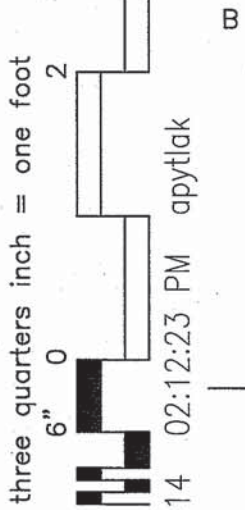
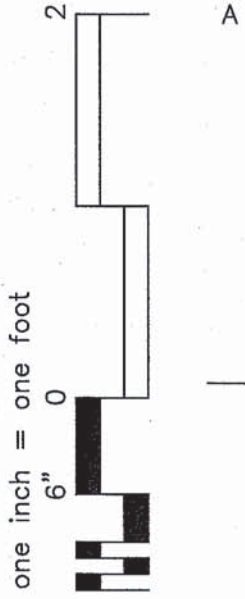

.S-132.dwg 6-16-14 02:12:23 PM apytlak

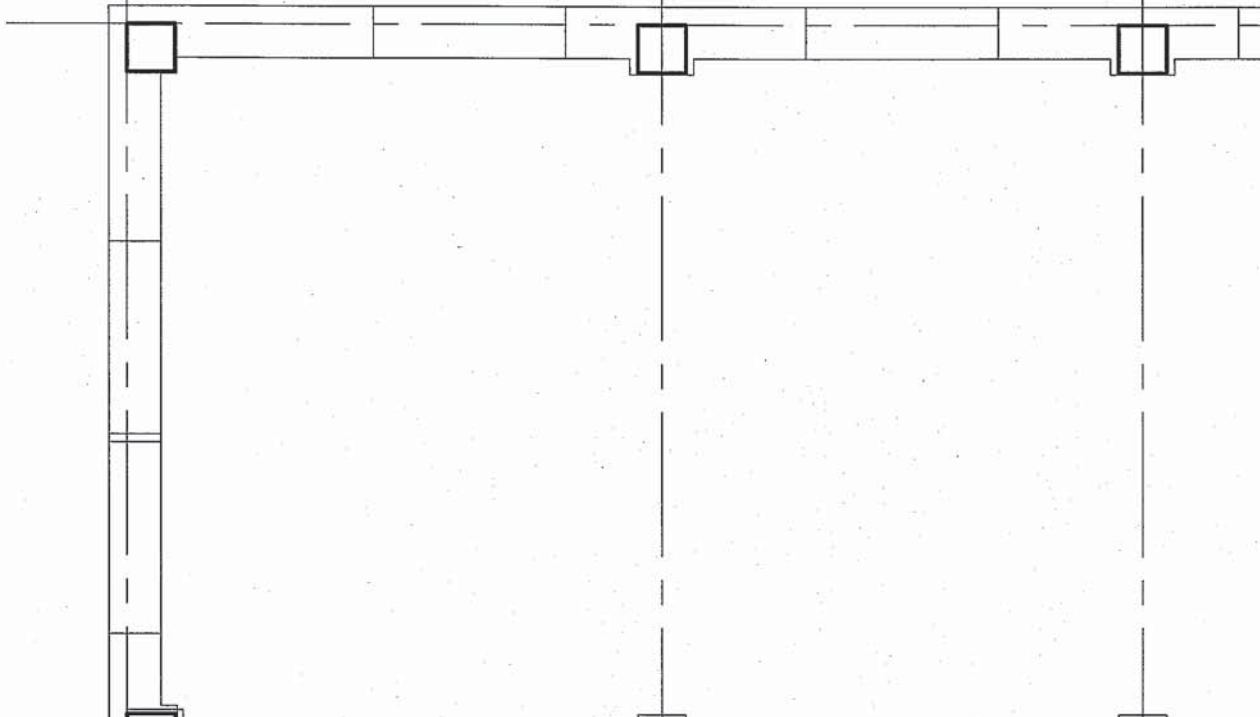

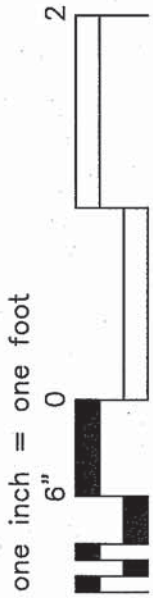

A

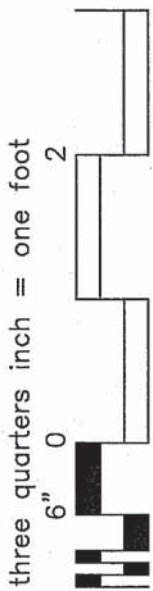

B

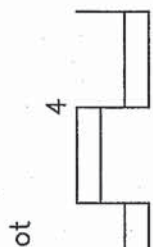

C

E1/05.S-140.dwg 6-16-14 02:12:28 PM apylak

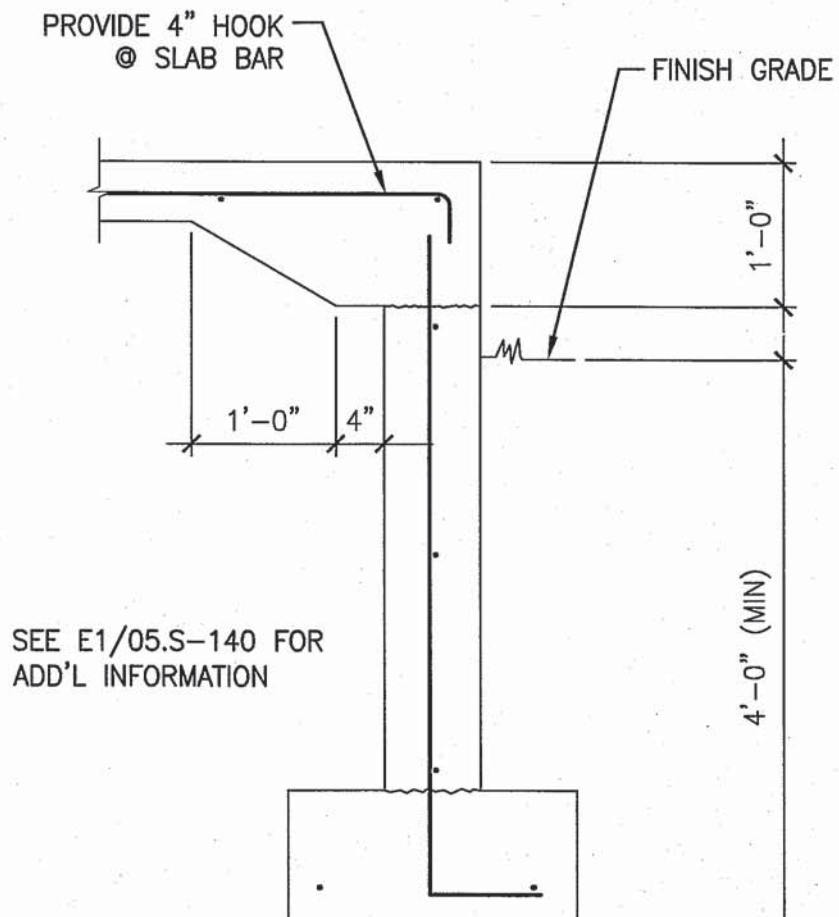

5  
20.4

5  
E21

5  
21.3

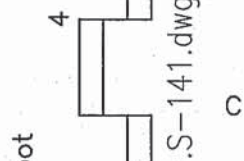
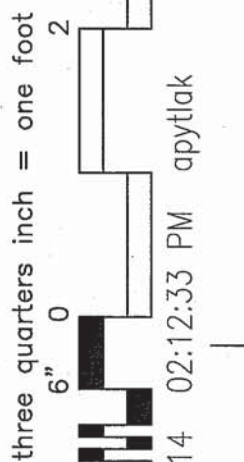
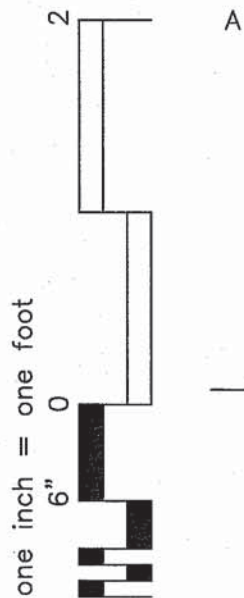

S-141.dwg 6-16-14 02:12:33 PM apytak

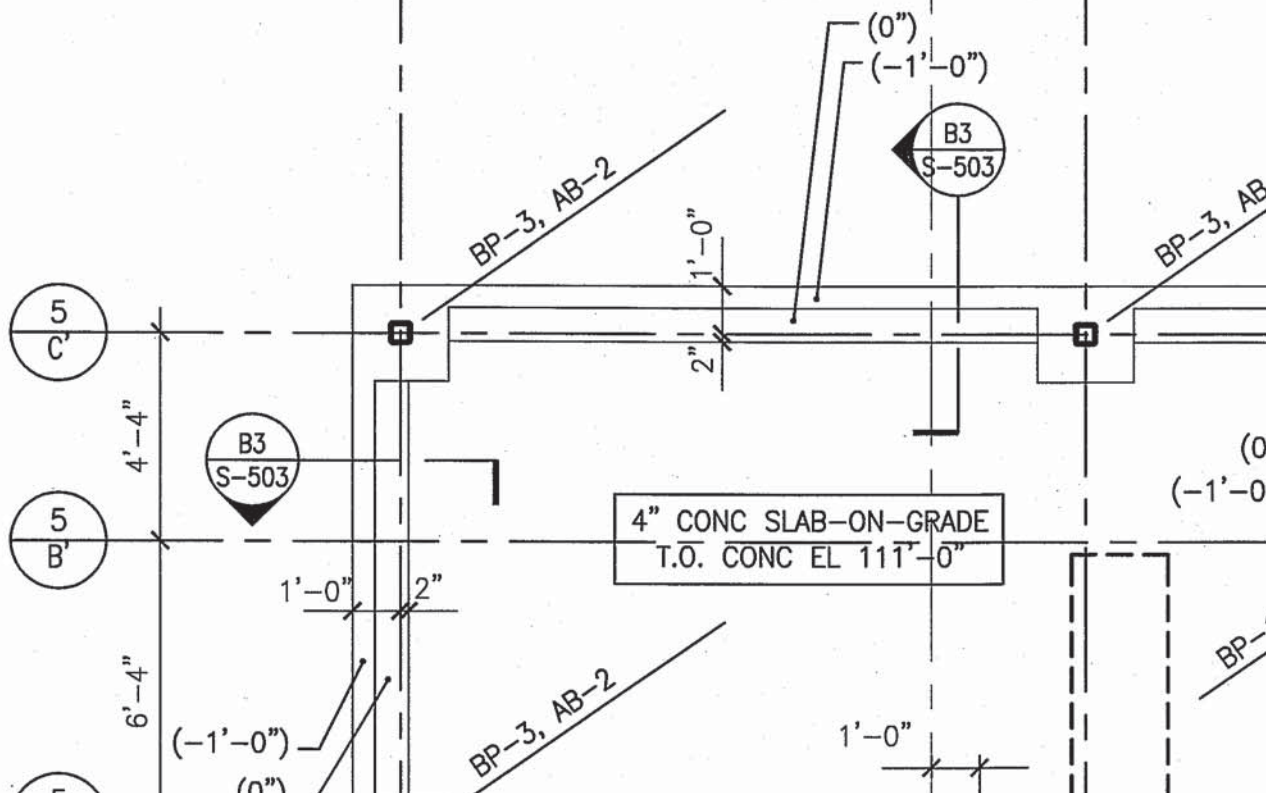

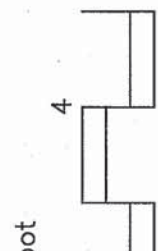
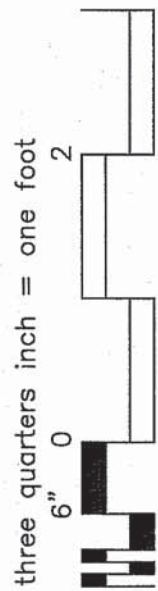
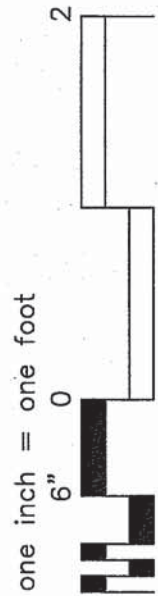

05.S-142.dwg 6-16-14 02:12:38 PM apytak

A

B

C

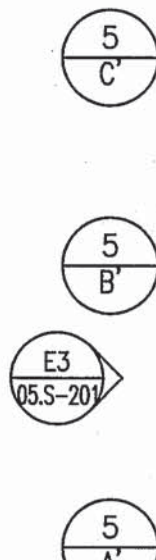

6'-4"

4'-4"

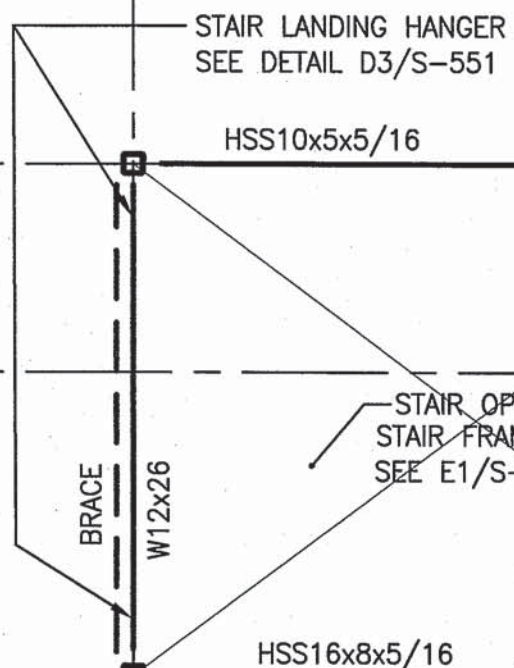

1

2



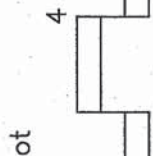

C

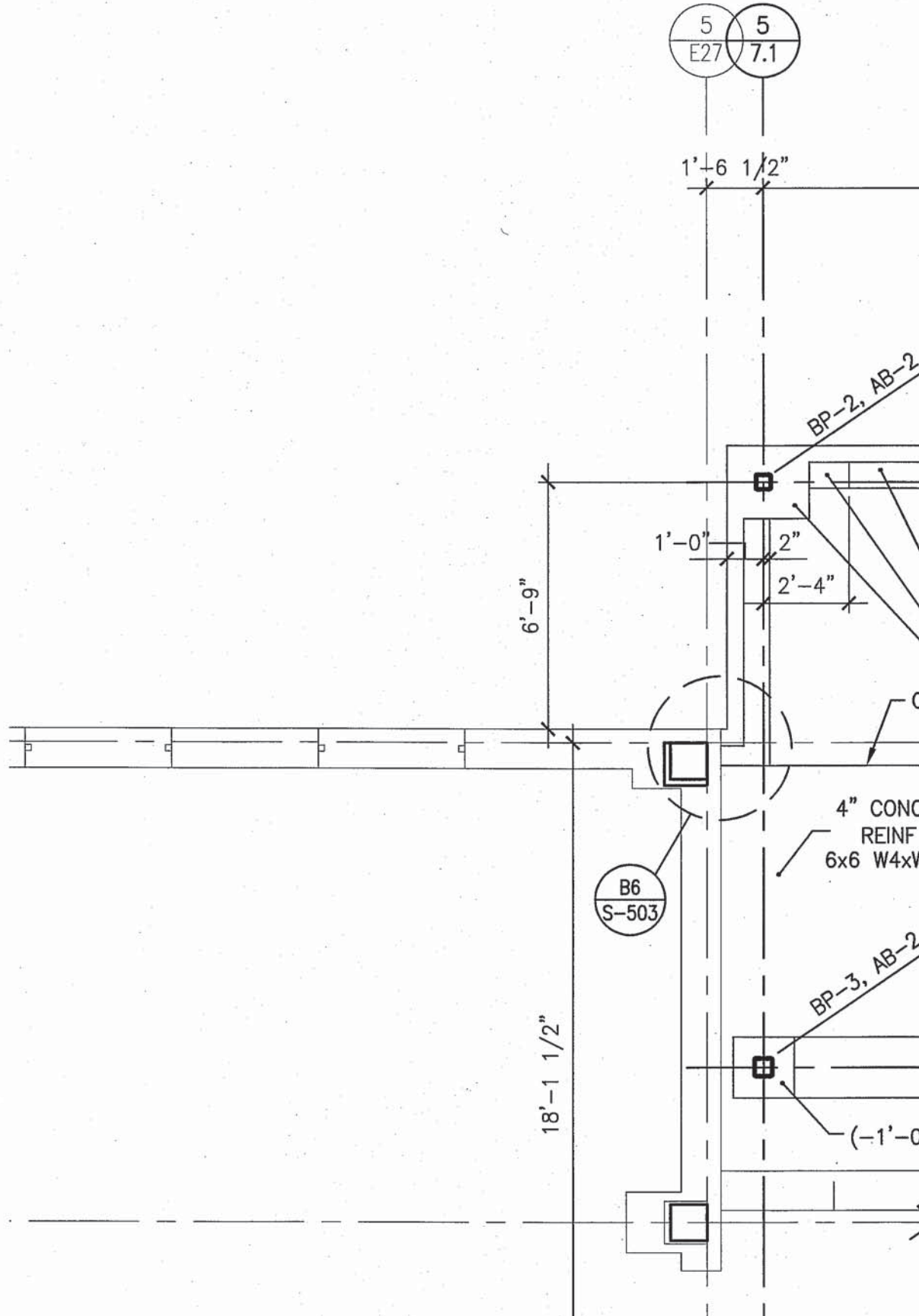



1

2

5  
E26

5  
E27

5  
7.1

A

B

C

one inch = one foot

three quarters inch = one foot

not

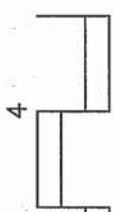
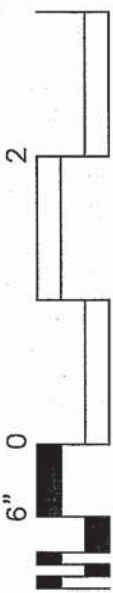
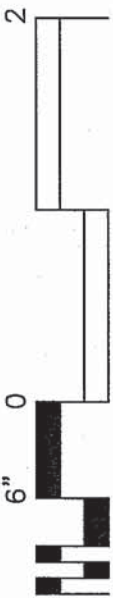

.S-152.dwg 6-16-14 02:12:53 PM apytlak

1'-6 1/2"

5'-9"

C3  
S-552

W10x22

SEE ARCHITECTURAL  
DRAWINGS FOR  
TREAD/RISER DIMENSIONS

#4 @18" O.C. BOTH WAYS  
MID-DEPTH IN SLAB

2" RIGID INSULATION  
FULL WIDTH OF SLAB  
AND STAIR

2#5 CONTINUOUS

COMPACTED  
STRUCTURAL  
FILL

## SECTION

B1

3/4" = 1'-0"

one inch = one foot

three quarters inch = one foot

foot

A

B

C

S-160.dwg 6-16-14 02:12:58 PM apytak



one inch = one foot  
6" 0 2

three quarters inch = one foot  
6" 0 2

4

S-161.dwg 6-16-14 02:13:03 PM apytak

A

B

C

5  
EI

5  
EJ

5  
K

5  
L

1'-8"

10'-6 1/2"

B3  
S-503

1'-0"

2"

(0")  
(-1'-0")

BP-3, AB-2

4" CONC  
T.O. CO

(-8")

2"

one inch = one foot

three quarters inch = one foot

not

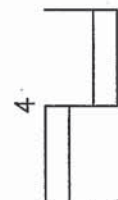
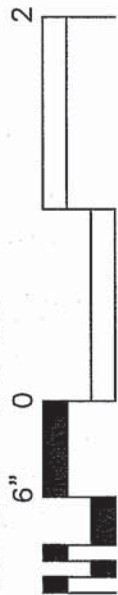

S-162.dwg 6-16-14 02:13:08 PM apylak

A

B

C

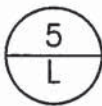
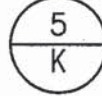
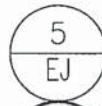
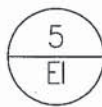

OUTSIDE  
FACE OF  
EXIST BLDG

W10x12  
STUB

STAIR OPNG  
STAIR FRAMING  
SEE E1/S-55

HSS10x5x5/16

BRACE



W10x22  
BRACE

10'-6 1/2"

1'-3 1/2"

1'-8"

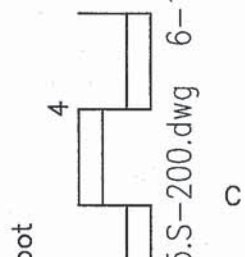
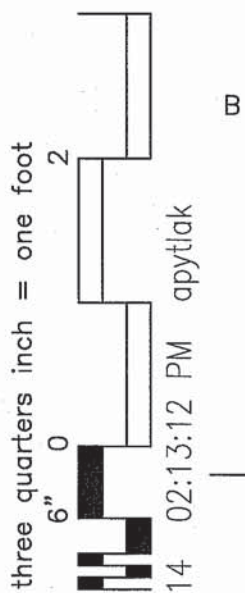
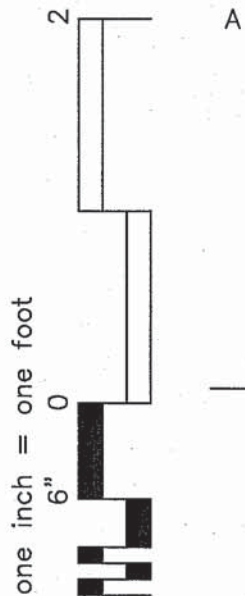

5.S-200.dwg 6-16-14 02:13:12 PM apytlak

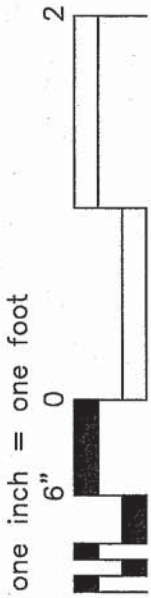

A

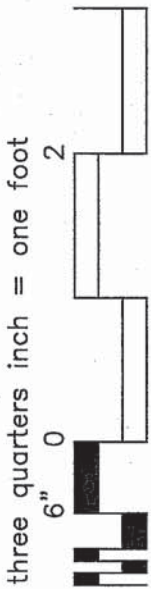

B

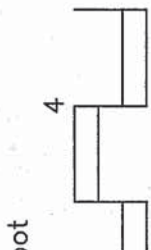

C

.S-201.dwg 6-16-14 02:13:17 PM apytlak

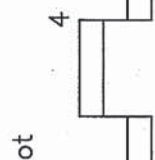
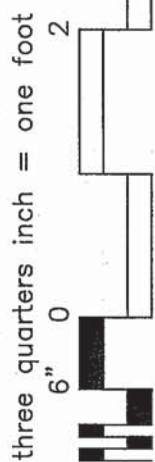
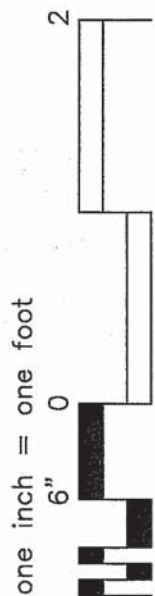

S-202.dwg 6-16-14 02:13:22 PM apytlak

A

B

C

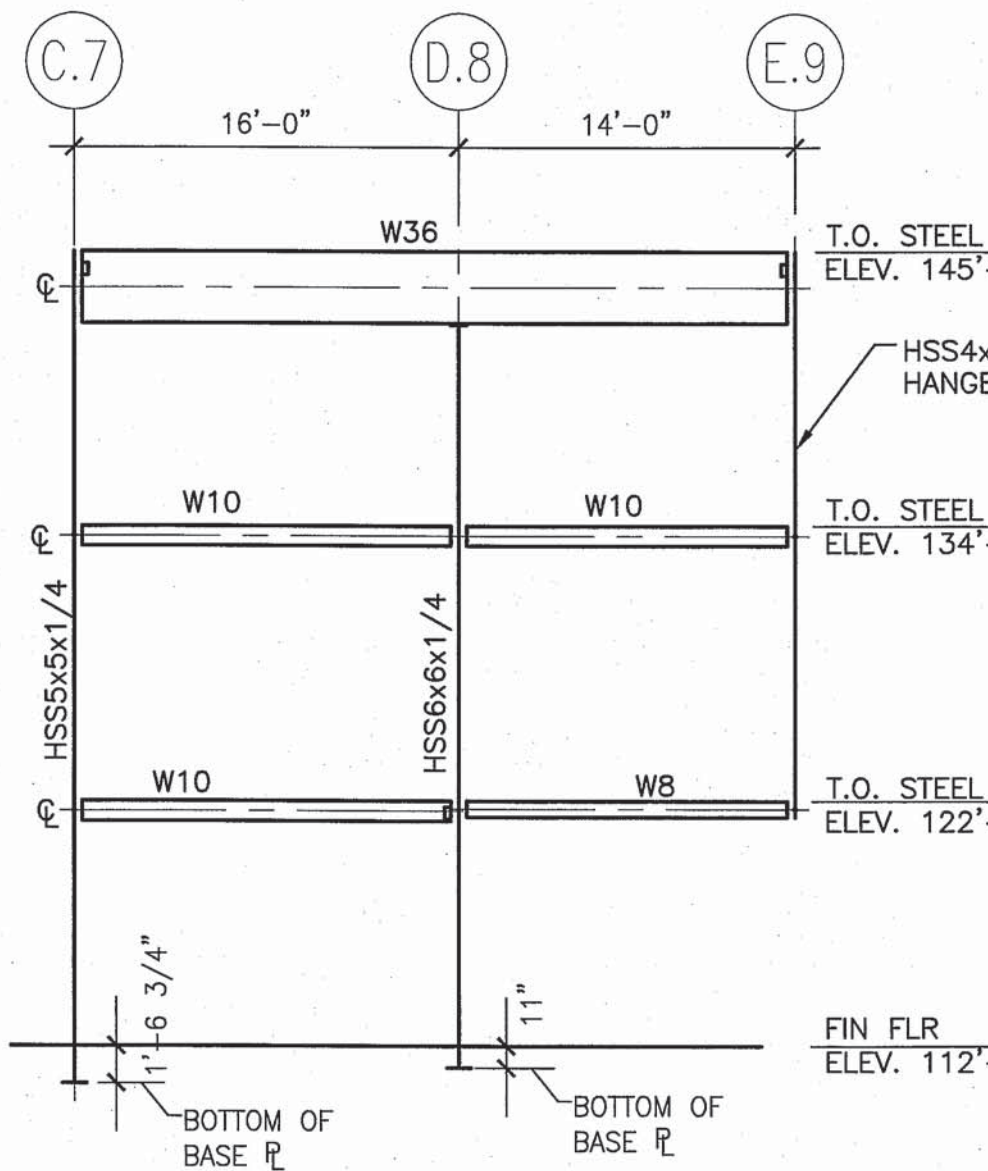

C1

## ELEVATION AT LINE 7.1

1/8" = 1'-0"

BLDG. 5 - STAIR #8