

SECOND FLOOR - FURNITURE & EQUIPMENT PLAN  
 1/8" = 1'-0"

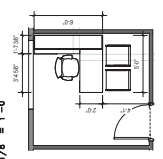

TYPICAL OFFICE LAYOUT 1  
 1/4" = 1'-0"

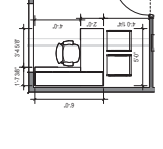

TYPICAL OFFICE LAYOUT 1  
 1/4" = 1'-0"

SECOND FLOOR - FURNITURE & EQUIPMENT PLAN  
 1/8" = 1'-0"

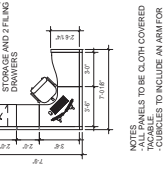

TYPICAL OFFICE LAYOUT 1  
 1/4" = 1'-0"

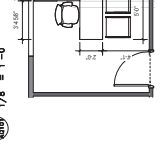

TYPICAL OFFICE LAYOUT 1  
 1/4" = 1'-0"

No.	CONSTRUCTION KEYNOTES
003	VERTICAL FILE UNITS V.V.
004	VERTICAL FILE UNITS V.V.
005	LAYOUT PANELS V.V.
006	COPIERS V.V.
007	10'0" X 10'0" SUPERVISOR WORKSTATION AND ACCESSORIES C.C.
008	10'0" X 10'0" SUPERVISOR WORKSTATION AND ACCESSORIES C.C.
009	10'0" X 10'0" SUPERVISOR WORKSTATION AND ACCESSORIES V.V.
010	COMPUTERS V.V.
011	OFFICE FURNITURE C.C.
012	FREE ENGLISH CABINET RECESSED WALL MOUNTED TELEVISION V.V.
013	FREE ENGLISH CABINET RECESSED WALL MOUNTED TELEVISION V.V.
014	FREE ENGLISH CABINET RECESSED WALL MOUNTED TELEVISION V.V.
015	FREE ENGLISH CABINET RECESSED WALL MOUNTED TELEVISION V.V.
016	FREE ENGLISH CABINET RECESSED WALL MOUNTED TELEVISION V.V.
017	FREE ENGLISH CABINET RECESSED WALL MOUNTED TELEVISION V.V.
018	FREE ENGLISH CABINET RECESSED WALL MOUNTED TELEVISION V.V.
019	FREE ENGLISH CABINET RECESSED WALL MOUNTED TELEVISION V.V.
020	FREE ENGLISH CABINET RECESSED WALL MOUNTED TELEVISION V.V.
021	FREE ENGLISH CABINET RECESSED WALL MOUNTED TELEVISION V.V.
022	FREE ENGLISH CABINET RECESSED WALL MOUNTED TELEVISION V.V.
023	FREE ENGLISH CABINET RECESSED WALL MOUNTED TELEVISION V.V.
024	FREE ENGLISH CABINET RECESSED WALL MOUNTED TELEVISION V.V.
025	FREE ENGLISH CABINET RECESSED WALL MOUNTED TELEVISION V.V.
026	FREE ENGLISH CABINET RECESSED WALL MOUNTED TELEVISION V.V.
027	FREE ENGLISH CABINET RECESSED WALL MOUNTED TELEVISION V.V.
028	FREE ENGLISH CABINET RECESSED WALL MOUNTED TELEVISION V.V.
029	FREE ENGLISH CABINET RECESSED WALL MOUNTED TELEVISION V.V.
030	FREE ENGLISH CABINET RECESSED WALL MOUNTED TELEVISION V.V.
031	FREE ENGLISH CABINET RECESSED WALL MOUNTED TELEVISION V.V.
032	FREE ENGLISH CABINET RECESSED WALL MOUNTED TELEVISION V.V.
033	FREE ENGLISH CABINET RECESSED WALL MOUNTED TELEVISION V.V.
034	FREE ENGLISH CABINET RECESSED WALL MOUNTED TELEVISION V.V.
035	FREE ENGLISH CABINET RECESSED WALL MOUNTED TELEVISION V.V.
036	FREE ENGLISH CABINET RECESSED WALL MOUNTED TELEVISION V.V.
037	FREE ENGLISH CABINET RECESSED WALL MOUNTED TELEVISION V.V.
038	FREE ENGLISH CABINET RECESSED WALL MOUNTED TELEVISION V.V.
039	FREE ENGLISH CABINET RECESSED WALL MOUNTED TELEVISION V.V.
040	FREE ENGLISH CABINET RECESSED WALL MOUNTED TELEVISION V.V.
041	FREE ENGLISH CABINET RECESSED WALL MOUNTED TELEVISION V.V.
042	FREE ENGLISH CABINET RECESSED WALL MOUNTED TELEVISION V.V.
043	FREE ENGLISH CABINET RECESSED WALL MOUNTED TELEVISION V.V.
044	FREE ENGLISH CABINET RECESSED WALL MOUNTED TELEVISION V.V.
045	FREE ENGLISH CABINET RECESSED WALL MOUNTED TELEVISION V.V.
046	FREE ENGLISH CABINET RECESSED WALL MOUNTED TELEVISION V.V.
047	FREE ENGLISH CABINET RECESSED WALL MOUNTED TELEVISION V.V.
048	FREE ENGLISH CABINET RECESSED WALL MOUNTED TELEVISION V.V.
049	FREE ENGLISH CABINET RECESSED WALL MOUNTED TELEVISION V.V.
050	FREE ENGLISH CABINET RECESSED WALL MOUNTED TELEVISION V.V.
051	FREE ENGLISH CABINET RECESSED WALL MOUNTED TELEVISION V.V.
052	FREE ENGLISH CABINET RECESSED WALL MOUNTED TELEVISION V.V.
053	FREE ENGLISH CABINET RECESSED WALL MOUNTED TELEVISION V.V.
054	FREE ENGLISH CABINET RECESSED WALL MOUNTED TELEVISION V.V.
055	FREE ENGLISH CABINET RECESSED WALL MOUNTED TELEVISION V.V.
056	FREE ENGLISH CABINET RECESSED WALL MOUNTED TELEVISION V.V.
057	FREE ENGLISH CABINET RECESSED WALL MOUNTED TELEVISION V.V.
058	FREE ENGLISH CABINET RECESSED WALL MOUNTED TELEVISION V.V.
059	FREE ENGLISH CABINET RECESSED WALL MOUNTED TELEVISION V.V.
060	FREE ENGLISH CABINET RECESSED WALL MOUNTED TELEVISION V.V.
061	FREE ENGLISH CABINET RECESSED WALL MOUNTED TELEVISION V.V.
062	FREE ENGLISH CABINET RECESSED WALL MOUNTED TELEVISION V.V.
063	FREE ENGLISH CABINET RECESSED WALL MOUNTED TELEVISION V.V.
064	FREE ENGLISH CABINET RECESSED WALL MOUNTED TELEVISION V.V.
065	FREE ENGLISH CABINET RECESSED WALL MOUNTED TELEVISION V.V.
066	FREE ENGLISH CABINET RECESSED WALL MOUNTED TELEVISION V.V.
067	FREE ENGLISH CABINET RECESSED WALL MOUNTED TELEVISION V.V.
068	FREE ENGLISH CABINET RECESSED WALL MOUNTED TELEVISION V.V.
069	FREE ENGLISH CABINET RECESSED WALL MOUNTED TELEVISION V.V.
070	FREE ENGLISH CABINET RECESSED WALL MOUNTED TELEVISION V.V.
071	FREE ENGLISH CABINET RECESSED WALL MOUNTED TELEVISION V.V.
072	FREE ENGLISH CABINET RECESSED WALL MOUNTED TELEVISION V.V.
073	FREE ENGLISH CABINET RECESSED WALL MOUNTED TELEVISION V.V.
074	FREE ENGLISH CABINET RECESSED WALL MOUNTED TELEVISION V.V.
075	FREE ENGLISH CABINET RECESSED WALL MOUNTED TELEVISION V.V.
076	FREE ENGLISH CABINET RECESSED WALL MOUNTED TELEVISION V.V.
077	FREE ENGLISH CABINET RECESSED WALL MOUNTED TELEVISION V.V.
078	FREE ENGLISH CABINET RECESSED WALL MOUNTED TELEVISION V.V.
079	FREE ENGLISH CABINET RECESSED WALL MOUNTED TELEVISION V.V.
080	FREE ENGLISH CABINET RECESSED WALL MOUNTED TELEVISION V.V.
081	FREE ENGLISH CABINET RECESSED WALL MOUNTED TELEVISION V.V.
082	FREE ENGLISH CABINET RECESSED WALL MOUNTED TELEVISION V.V.
083	FREE ENGLISH CABINET RECESSED WALL MOUNTED TELEVISION V.V.
084	FREE ENGLISH CABINET RECESSED WALL MOUNTED TELEVISION V.V.
085	FREE ENGLISH CABINET RECESSED WALL MOUNTED TELEVISION V.V.
086	FREE ENGLISH CABINET RECESSED WALL MOUNTED TELEVISION V.V.
087	FREE ENGLISH CABINET RECESSED WALL MOUNTED TELEVISION V.V.
088	FREE ENGLISH CABINET RECESSED WALL MOUNTED TELEVISION V.V.
089	FREE ENGLISH CABINET RECESSED WALL MOUNTED TELEVISION V.V.
090	FREE ENGLISH CABINET RECESSED WALL MOUNTED TELEVISION V.V.
091	FREE ENGLISH CABINET RECESSED WALL MOUNTED TELEVISION V.V.
092	FREE ENGLISH CABINET RECESSED WALL MOUNTED TELEVISION V.V.
093	FREE ENGLISH CABINET RECESSED WALL MOUNTED TELEVISION V.V.
094	FREE ENGLISH CABINET RECESSED WALL MOUNTED TELEVISION V.V.
095	FREE ENGLISH CABINET RECESSED WALL MOUNTED TELEVISION V.V.
096	FREE ENGLISH CABINET RECESSED WALL MOUNTED TELEVISION V.V.
097	FREE ENGLISH CABINET RECESSED WALL MOUNTED TELEVISION V.V.
098	FREE ENGLISH CABINET RECESSED WALL MOUNTED TELEVISION V.V.
099	FREE ENGLISH CABINET RECESSED WALL MOUNTED TELEVISION V.V.
100	FREE ENGLISH CABINET RECESSED WALL MOUNTED TELEVISION V.V.

LEGEND
V.V. V.A. SUPPLIED V.A. INSTALLED
V.V. V.A. SUPPLIED CONTRACTOR INSTALLED
C.C. CONTRACTOR SUPPLIED CONTRACTOR INSTALLED

**DEDUCT ALTERNATIVES**  
 - BASE BID: ALL WORK, FURNITURE, AND EQUIPMENT  
 - DEDUCT ALTERNATE NO. 3: 7'-6" X 7'-6" AND 10'-0" X 10'-0" WORKSTATIONS AND ACCESSORIES (E08 & E09)  
 - DEDUCT ALTERNATE NO. 4: HIGH DENSITY STORAGE UNITS (E01)

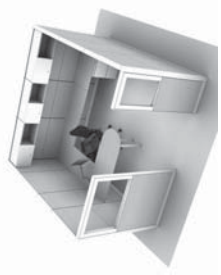

10' x 10' WORKSTATION



7'-6" x 7'-6" WORKSTATION GROUP 1

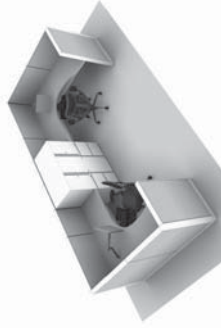

7'-6" x 7'-6" WORKSTATION GROUP 2

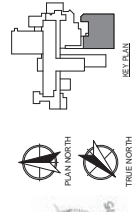

100% CONSTRUCTION BID DOCUMENT  
 SUBMISSION - FULLY SPRINKLERED

140701D

DEPARTMENT OF VETERANS AFFAIRS	
DATE: 10/30/15	PROJECT NO: 503-308
DRAWING NO: AQ101	DATE: 10/30/15
SECOND FLOOR - FURNITURE AND EQUIPMENT - PLAN	
EXPAND OUTPATIENT WITH ADDITIONAL ADDITION	
Approved: Associate Director for Operations	Checked: CPY CAU
Approved: Director, Medical Center	Location:

JAMES E. VAN ZANDT VETERANS ADMINISTRATION MEDICAL CENTER	
ARCHITECTURE & ENGINEERING	
DERBY enterprises	

WHITMAN, REQUIST & ASSOCIATES, LLP	
CIVIL ENGINEERING	
ROBERT L. REQUIST ASSOCIATES	

BUILDING COST CONSULTANTS	
COST ESTIMATING	
KOFFEL ASSOCIATES, INC.	

BRIAN THE KIDLER MURPHY & ASSOCIATES, INC.	
MECHANICAL, ELECTRICAL, & COMM. ENG.	
ROBERT L. REQUIST ASSOCIATES	