

TYPICAL EXTERIOR ELEVATION

TYPICAL INTERIOR ELEVATION

ALL WINDOW DETAILS ARE BASED ON EFCO SERIES 450 INSULATED CASEMENT HIGH PERFORMANCE THERMAL WINDOWS. THIS WINDOW SELECTION IS USED AS THE DESIGN BASIS AND IS NOT INTENDED TO LIMIT COMPETITION. WINDOW MANUFACTURER SHALL BE EQUAL OR BETTER THAN THE SPECIFICATION REQUIREMENTS.

FINISH SHALL BE WHITE ARCHITECTURAL COATING AS SPECIFIED.

PROVIDE ALUMINUM BUTT HINGES AT THE CASEMENT SASH. EQUIP EACH WINDOW WITH 3 EACH TAMPERPROOF WHITE BRONZE A/C LOOKS

WHITE BRONZE SASH PULL HANDLE AND KEY RELEASE LIMIT OPENING ARMS.

GLAZING SHALL BE 1" INSULATED EXTERIOR WITH 1/4" CLEAR TEMP AT OUTSIDE. 1/4" TINTED TEMP AT INSIDE WITH LOW EMISSIVITY

PROLYTIC COATING HAVING AN "E" OF 0.15 AND ARGON FILLED AIR SPACE. SEE ALSO SPECIFICATIONS. INTERIOR TAKE-OUT PANEL

SHALL BE 1/4" CLEAR TEMPERED GLASS.

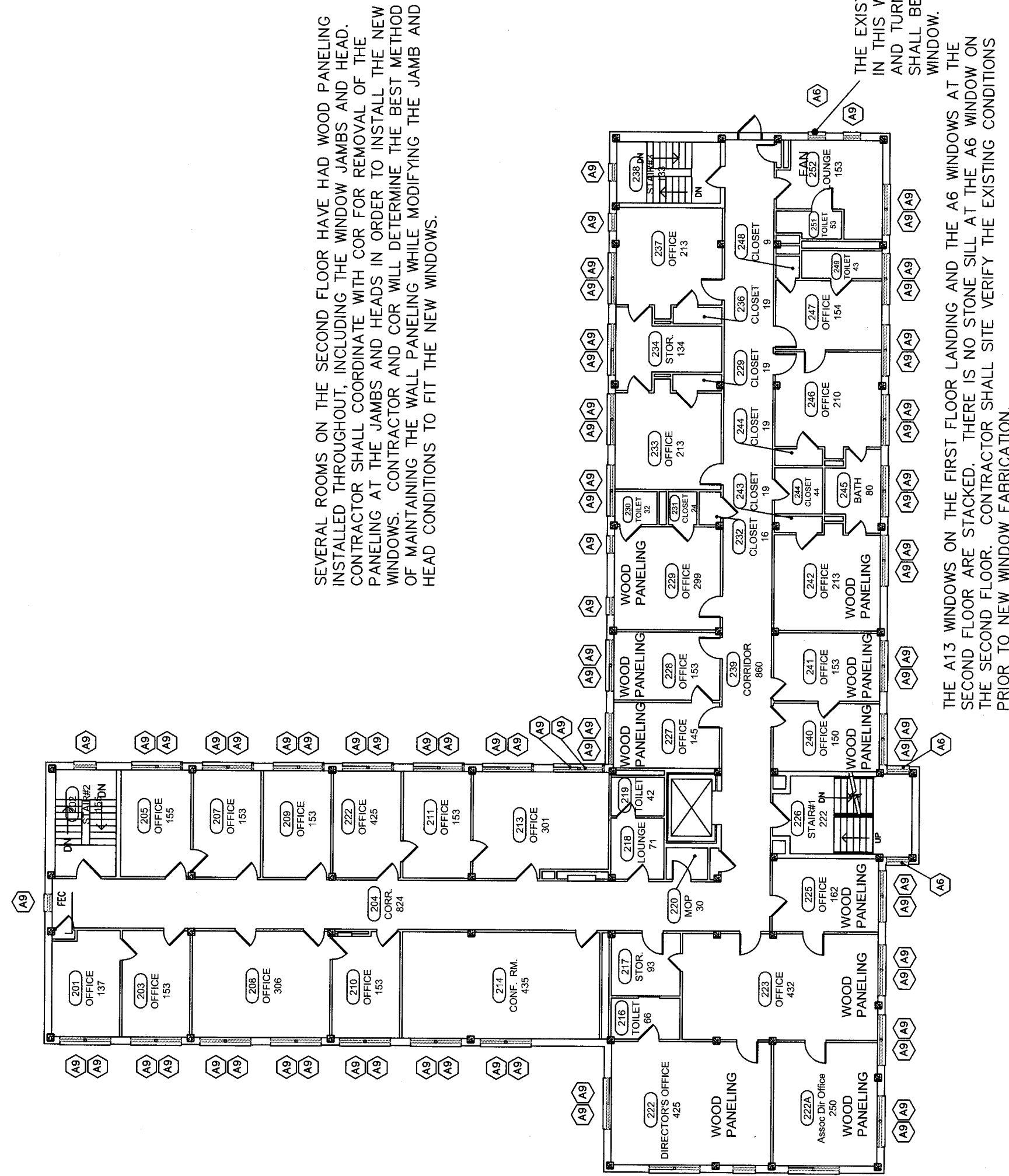

SEVERAL ROOMS ON THE SECOND FLOOR HAVE HAD WOOD PANELING INSTALLED THROUGHOUT. IN ORDER TO INSTALL THE NEW WINDOW SILL, THE CONTRACTOR SHALL COORDINATE WITH COR FOR REMOVAL OF THE WOOD PANELING AT THE JAMBS AND HEADS IN ORDER TO INSTALL THE NEW WINDOW SILL. THE CONTRACTOR SHALL VERIFY THE EXISTING CONDITIONS OF MAINTAINING THE WALL PANELING WHILE MODIFYING THE JAMB AND HEAD CONDITIONS TO FIT THE NEW WINDOWS.

THE EXISTING EXHAUST FAN SHALL BE REMOVED AND TURNED IN TO COR. NO FAN SHALL BE INSTALLED IN THE REPLACEMENT WINDOW.

THE A13 WINDOWS ON THE FIRST FLOOR LANDING AND THE A6 WINDOWS AT THE SECOND FLOOR ARE STACKED. THERE IS NO STONE SILL AT THE A6 WINDOW ON THE SECOND FLOOR. CONTRACTOR SHALL SITE VERIFY THE EXISTING CONDITIONS PRIOR TO NEW WINDOW FABRICATION.

BUILDING 1 SECOND FLOOR

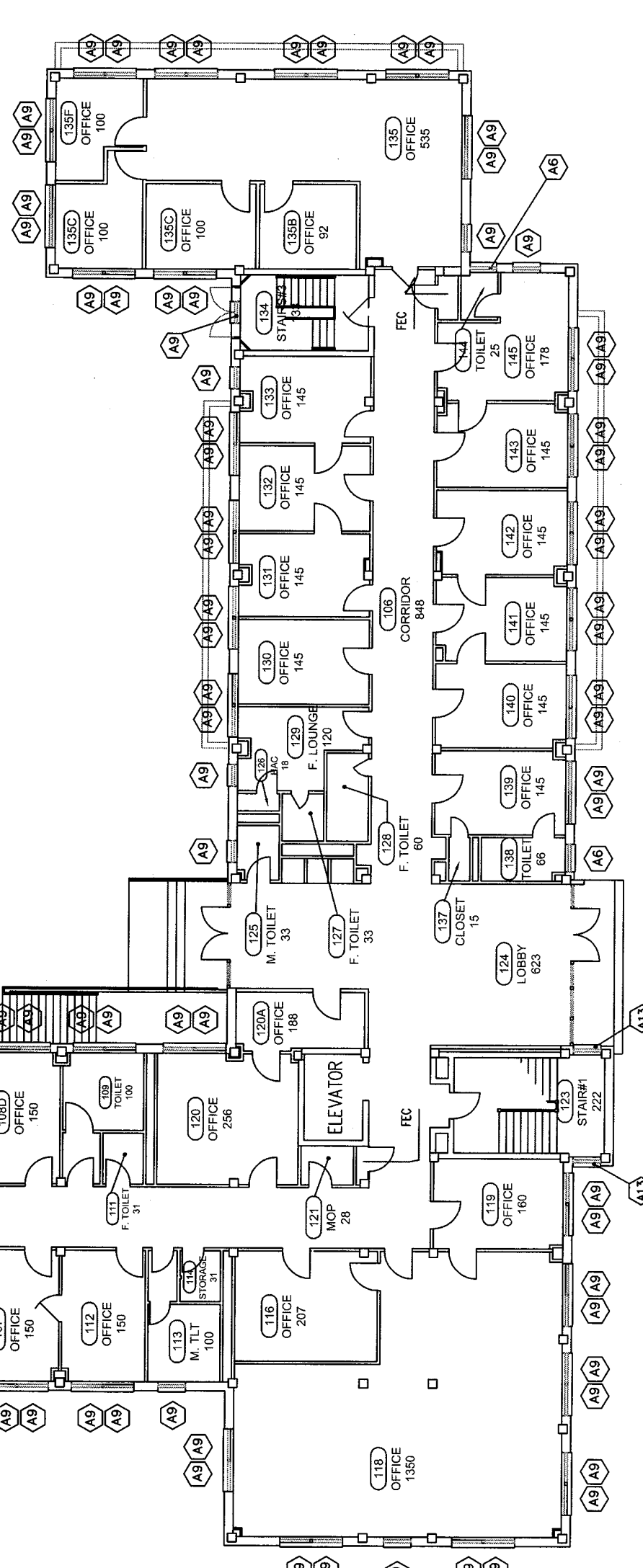

THE A13 WINDOWS ON THE FIRST FLOOR LANDING AND THE A6 WINDOWS AT THE SECOND FLOOR ARE STACKED. THERE IS NO STONE SILL AT THE A6 WINDOW ON THE SECOND FLOOR. CONTRACTOR SHALL SITE VERIFY THE EXISTING CONDITIONS PRIOR TO NEW WINDOW FABRICATION.

BUILDING 1 FIRST FLOOR

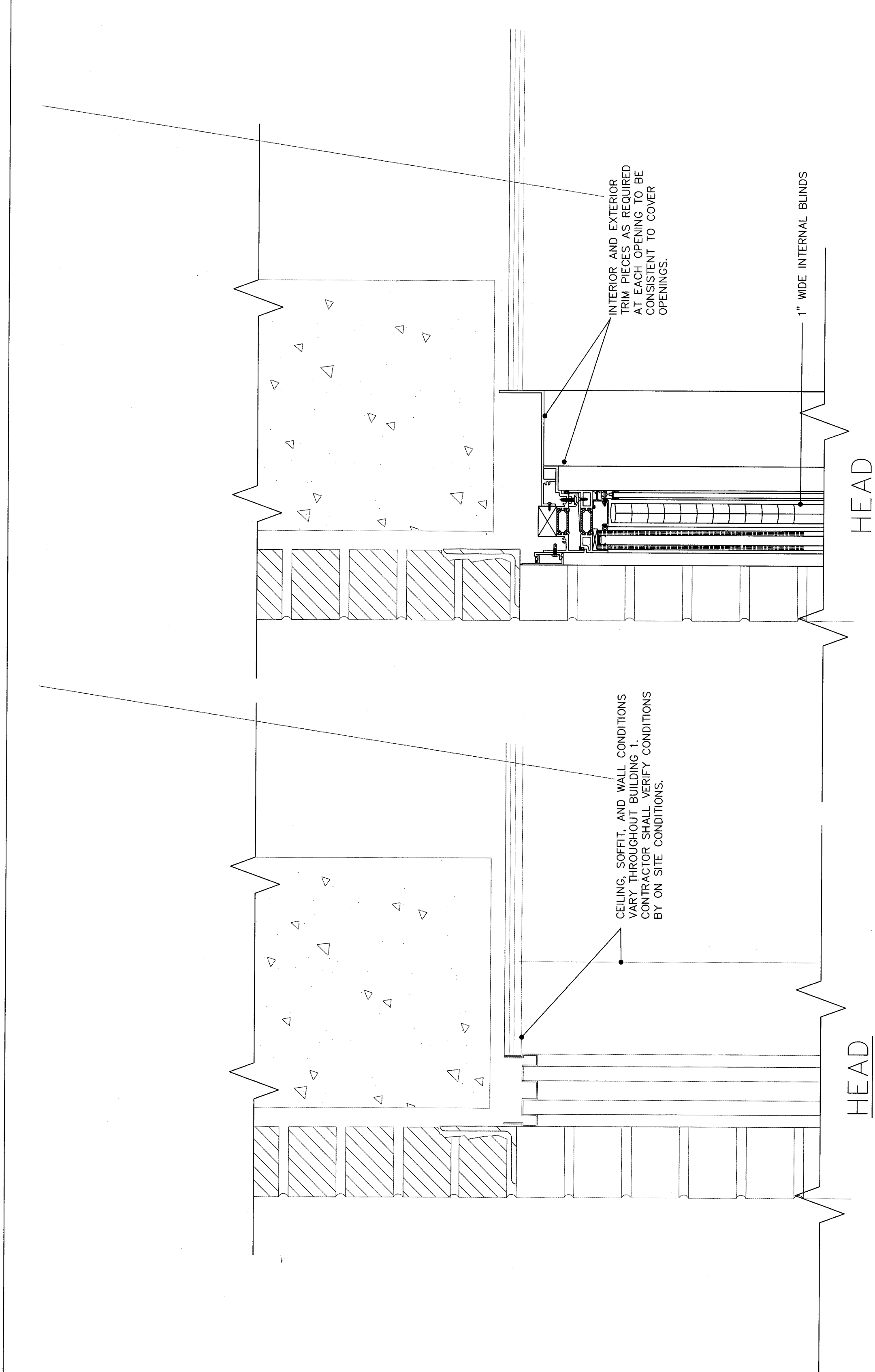

HEAD

HEAD

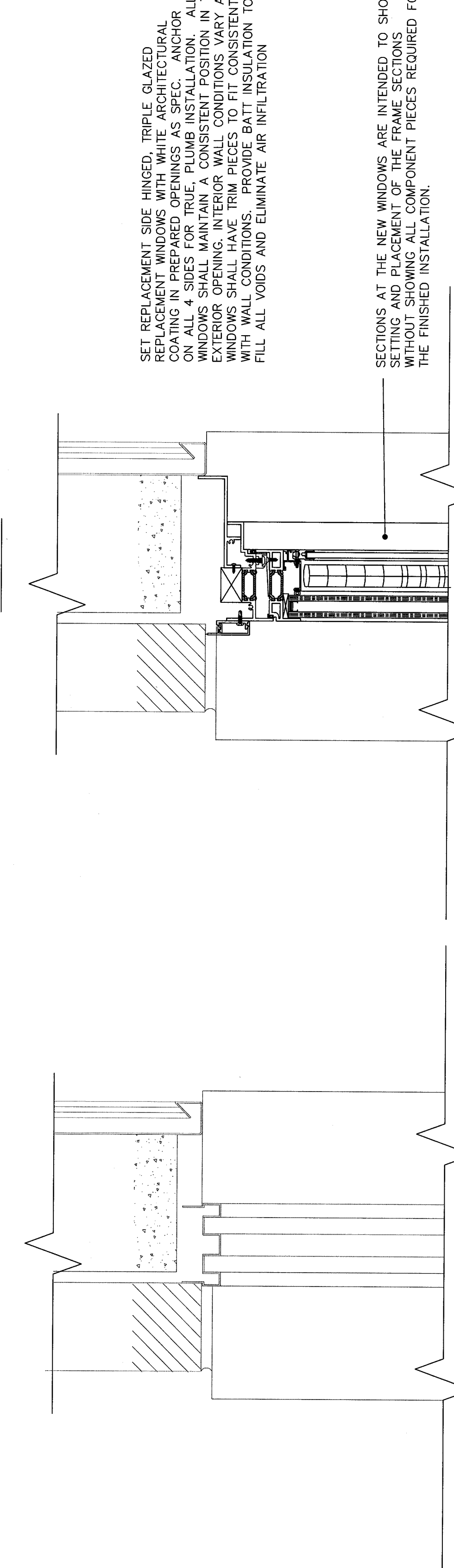

JAMB

JAMB

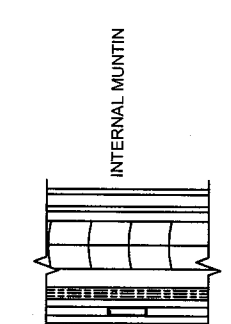

INTERIOR TAKE-OUT PANEL 1/4" CLEAR TEMP GLASS (TYP)

1/4" CLEAR TEMP GLASS (TYP)

1/4" TINTED TEMP GLASS (TYP) COLOR SHALL BE SELECTED FROM MFGOR STD COLORS

NEW SOLID SURFACE SILLS SHALL BE EQUAL OR BETTER TO THE EXISTING SILLS. SURFACE GLASS SERIES, COLOR SHALL BE SELECTED FROM MFGOR STD COLORS. SET IN EXISTING OPENINGS PER MFGOR RECOMMENDATION

SILL TYP SECT THRU REPLACEMENT WINDOW

SILL TYP SECT THRU EXIST WINDOW

TYP @ A6, A9, AND A13 WINDOWS ON THE 1ST & 2ND FLOORS
3" x 1'-0"

TYP @ A6, A9, AND A13 WINDOWS ON THE 1ST & 2ND FLOORS
3" x 1'-0"

RECOMMEND APPROVAL		Drawing Title	
REQUESTER	Date	1ST & 2ND FL PLANS, SECT'S, DETAILS AND GEN NOTES	Project Title
CHIEF OF SERVICE	Date	CHIEF OF STAFF	Project No.
ASSOC. DIR. PATIENT CARE SVC.	Date	ASSOC. DIR. for OPERATIONS	659-12-246
APPROVAL BY:	Date	Approved: Safety Manager/M&O Supervisor	Building Number
MEDICAL CENTER DIRECTOR	Date	Approved:Chief of Facilities Management Svr.	1

Date	3/23/12
Project No.	659-12-246
DRAWING NO.	1
DWG.2	OF 2



Department of Veterans Affairs