

A

B

C

D

E

F

G

three inches = one foot
one and one half inches = one foot
one inch = one foot
three quarters inch = one foot
one half inch = one foot
three eighths inch = one foot
one quarter inch = one foot
one eighth inch = one foot

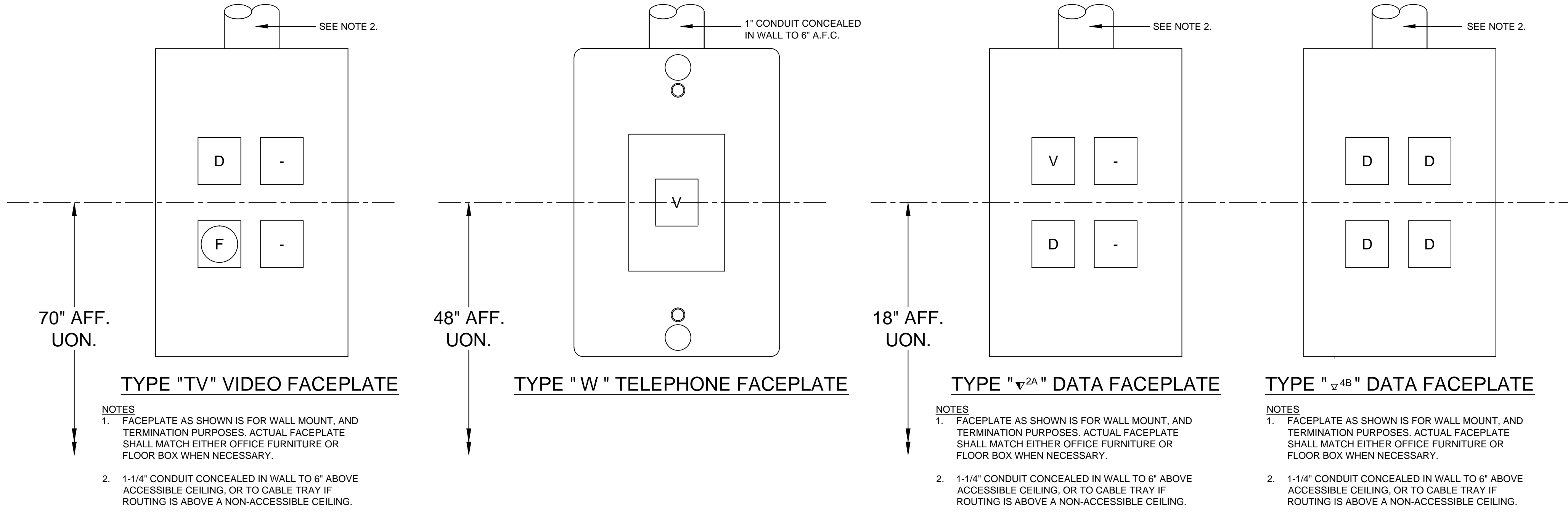

POKE THRU DEVICE PLATE

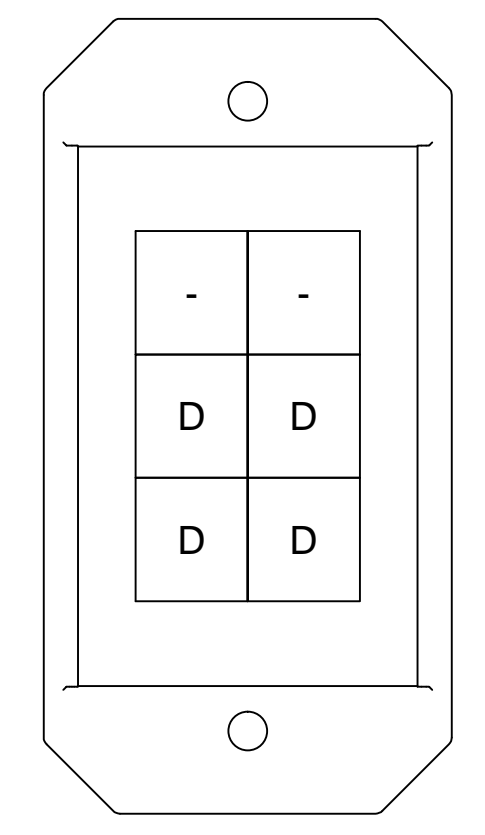

TYPE "V^{4B}" DATA FACEPLATE

NOTE

1. 1-1/4" CONDUIT BELOW FLOOR AND RISE WITHIN CHASE OR WALL TO 6" ABOVE ACCESSIBLE CEILING, OR TO CABLE TRAY IF ROUTING IS ABOVE A NON-ACCESSIBLE CEILING.

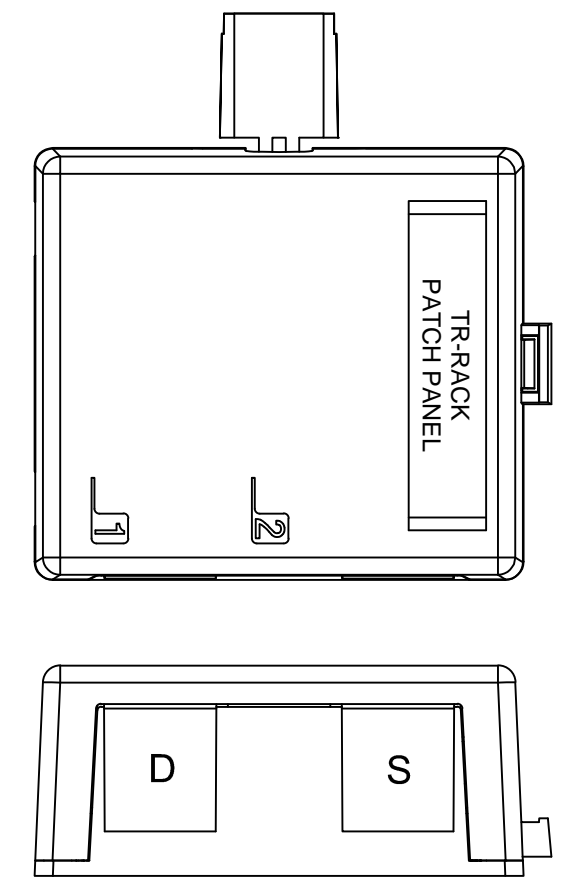

TYPICAL "WAP" BISCUIT

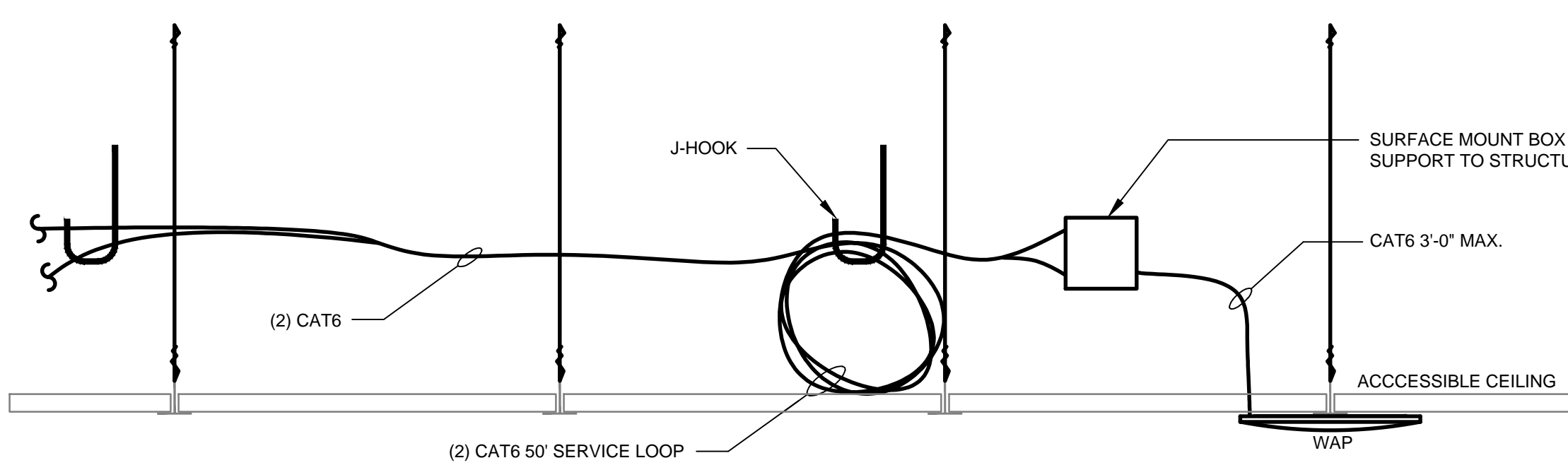

TYPICAL ACCESSIBLE CEILING MOUNTED WAP DETAIL

NOTE

1. CABLE LENGTH NOT TO EXCEED 30 METERS, IF LENGTH IS GREATER THAN 30 METERS, ADJUST LENGTH OF SERVICE LOOP ACCORDINGLY.

FACEPLATE TERMINATIONS					
TAG	JACK TYPE	JACK COLOR	CABLE TYPE	CABLE COLOR	USE
D	CAT6 RJ45	BLUE	UTP	BLUE	DATA
F	RG6 F	BLACK	RG6	BLACK	VIDEO
V	CAT6 RJ45	WHITE	UTP	WHITE	VOICE
-	BLANK MODULE	MATCH FACEPLATE	-	-	-

KEYED NOTES:

- 7' 19" WIDE 2-POST EQUIPMENT RACK TO MATCH EXISTING.
- VERTICAL WIRE MANAGEMENT TO MATCH EXISTING.
- RACK MOUNTED 110 BLOCK - 100 PAIR.
- HORIZONTAL WIRE MANAGEMENT TO MATCH EXISTING, TYPICAL.
- 48 PORT PATCH PANEL TO MATCH EXISTING, TYPICAL.
- RACK MOUNTED SWITCH PROVIDED BY OWNER, TYPICAL.
- SPACE FOR OWNER PROVIDED SECURITY EQUIPMENT AND FUTURE GROWTH.

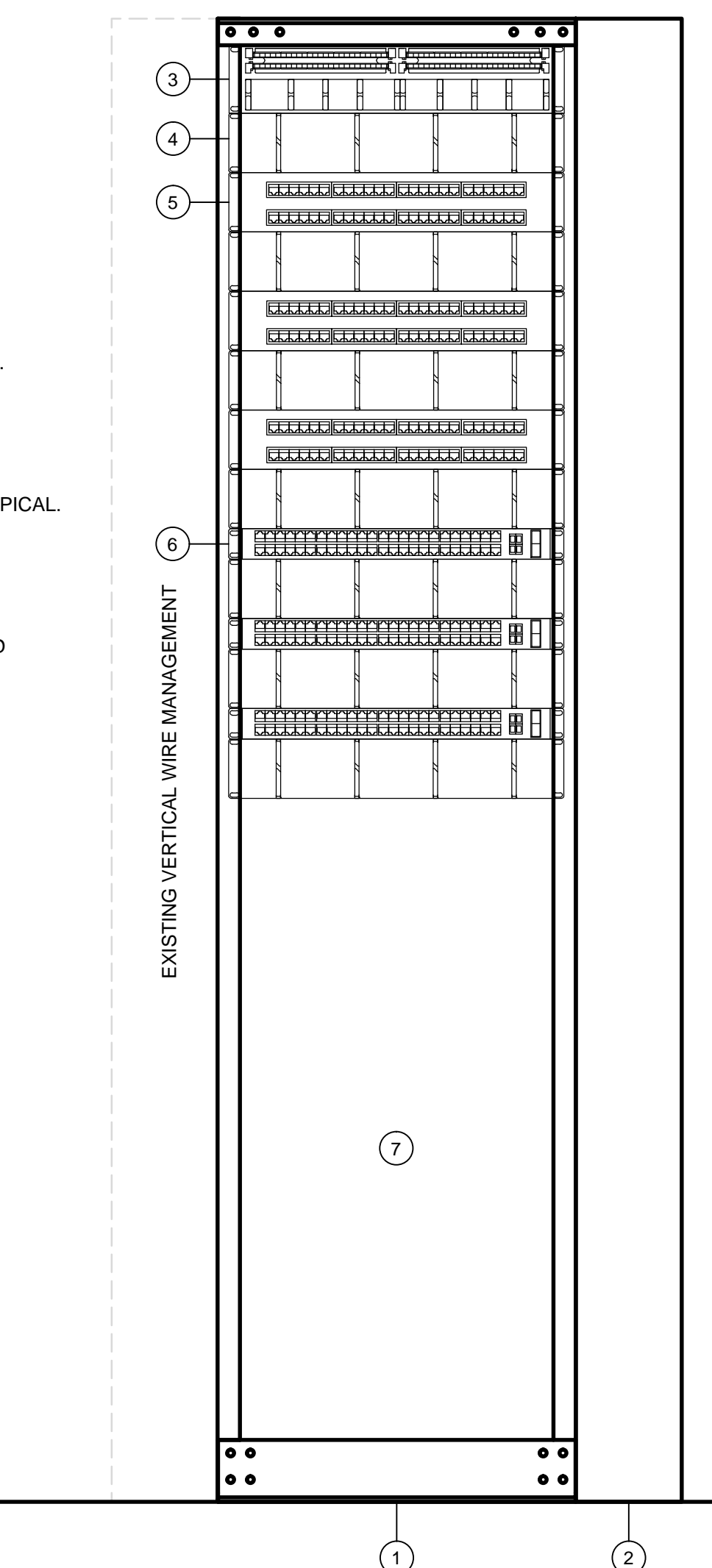

IRM 1-F515 RACK ELEVATION
NO SCALE.

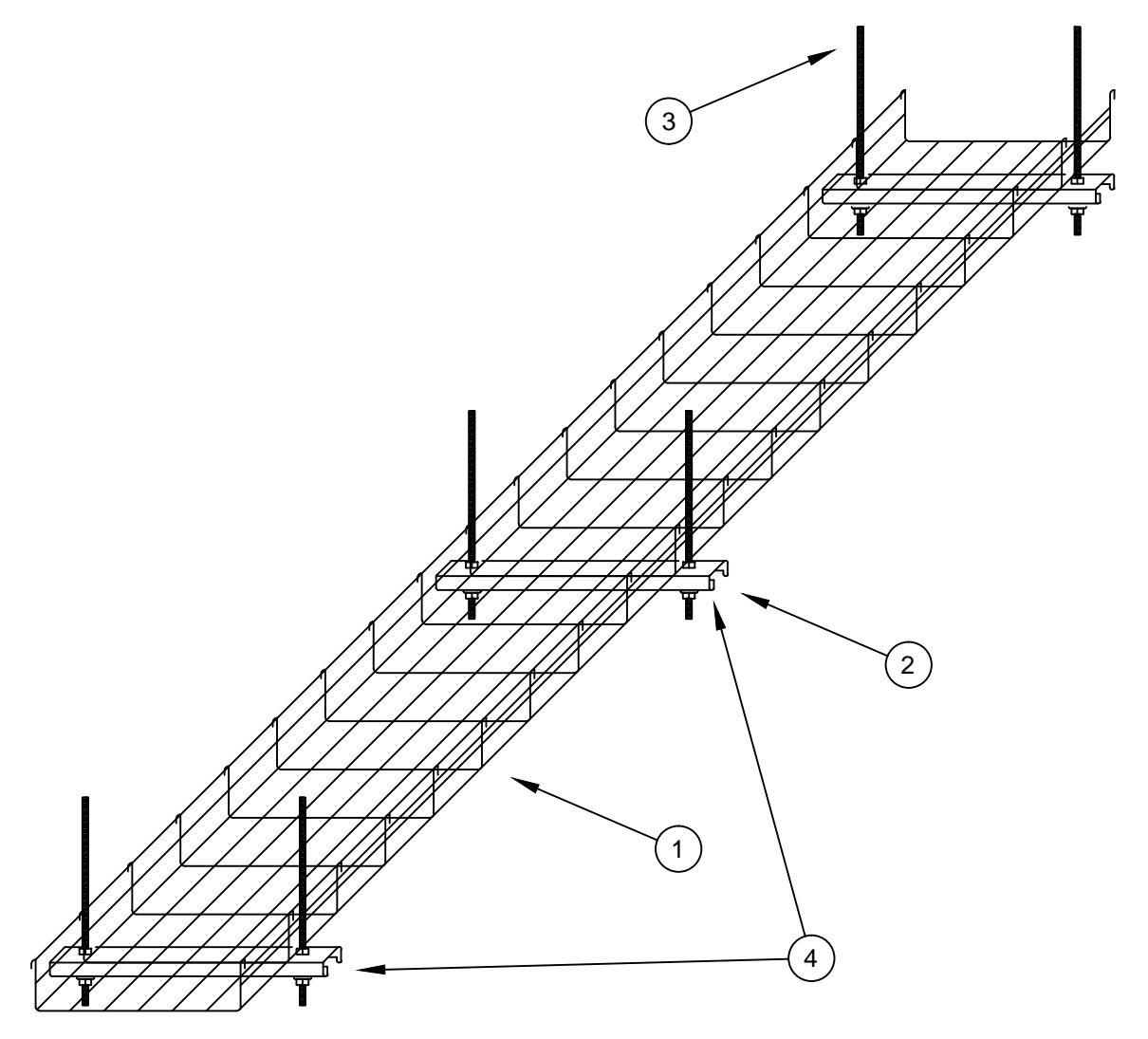

TYPICAL CABLE TRAY MOUNTING DETAIL

KEYED NOTES:

- VERIFY CABLETRAY TYPE AND SIZE WITH DRAWINGS AND SPECIFICATIONS. REFER TO SPECIFICATIONS FOR ADDITIONAL MOUNTING REQUIREMENTS.
- 3/4" UNISTRUT. TO FASTEN, FIELD DRILL AND ATTACH STRUT DIRECTLY TO UNDERSIDE OF TRAY BY MEANS OF NUT, BOLT AND APPROPRIATE CLAMPING HARDWARE AS RECOMMENDED BY MANUFACTURER.
- TYPICAL (2) 5/8" (MIN.) THREADED RODS PER UNISTRUT TRAPEZE. UTILIZE A DOUBLE NUT CONFIGURATION TO ASSURE MAINTENANCE OF SUPPORT. PROVIDE ANCHOR HARDWARE CAPABLE OF SUPPORTING THE CABLE TRAY AS RECOMMENDED BY THE MANUFACTURER.
- PROVIDE A UNISTRUT TRAPEZE EVERY FIVE FEET, OR AT A SPAN NO GREATER SPAN THAN MAXIMUM SPAN RECOMMENDED BY MANUFACTURER WHICHEVER IS LESS.

NOTES:

- CONTRACTOR SHALL BOND ALL CABLETRAY SO AS TO ASSURE A CONTINUOUS GROUND THROUGHOUT THE CABLETRAY SYSTEM. WHERE BONDING JUMPERS ARE UTILIZED THE CONTRACTOR SHALL UTILIZE PAINT PIERCING WASHERS AS SPECIFIED IN SECTION 17070 TO BRIDGE ANY INCONTINUITIES. NOTE THAT GROUND MUST TEST OUT TO LESS THAN 5 OHMS PER TECHNOLOGY GROUNDING SPECIFICATIONS, AND SHALL BE CAPABLE OF BEARING A CONTINUOUS LOAD EQUIVALENT TO A #6 AWG WIRE.
- CONTRACTOR SHALL COORDINATE CABLETRAY PATHWAY WITH ANY POTENTIAL IMPEDIMENT, INCLUDING, BUT NOT LIMITED TO, CONDUIT, PLUMBING, HVAC, STRUCTURAL, AND OTHER CABLE TRAY. CONTRACTOR SHALL ADAPT CABLETRAY PATHWAY AS REQUIRED, TO FULFILL THE INTENT OF THE DESIGN. THE CONTRACTOR SHALL NOTIFY THE ENGINEER WHERE REROUTING OF THE CABLETRAY DUE TO FIELD CONDITIONS PROVIDES A SIGNIFICANT IMPACT ON CABLE LENGTHS ROUTED IN CABLETRAY. A SIGNIFICANT IMPACT SHALL BE CONSIDERED ANY INCREASE IN CABLE LENGTH OF MORE THAN 10 FEET. ADDITIONALLY, THE CONTRACTOR SHALL MAINTAIN THE FOLLOWING MINIMUM CLEARANCES WHEN ROUTING CABLETRAY: 8 INCHES FROM ANY LIGHTING FIXTURE, 4 FEET FROM ANY TRANSFORMER OR LARGE MOTOR, 12 INCHES FROM ANY FEEDER, 6 INCH CLEARANCE ABOVE CABLETRAY, AND CLEARANCE BELOW TO PROVIDE SUFFICIENT SPACE FOR MOUNTING HARDWARE AS INDICATED ON THIS DETAIL.

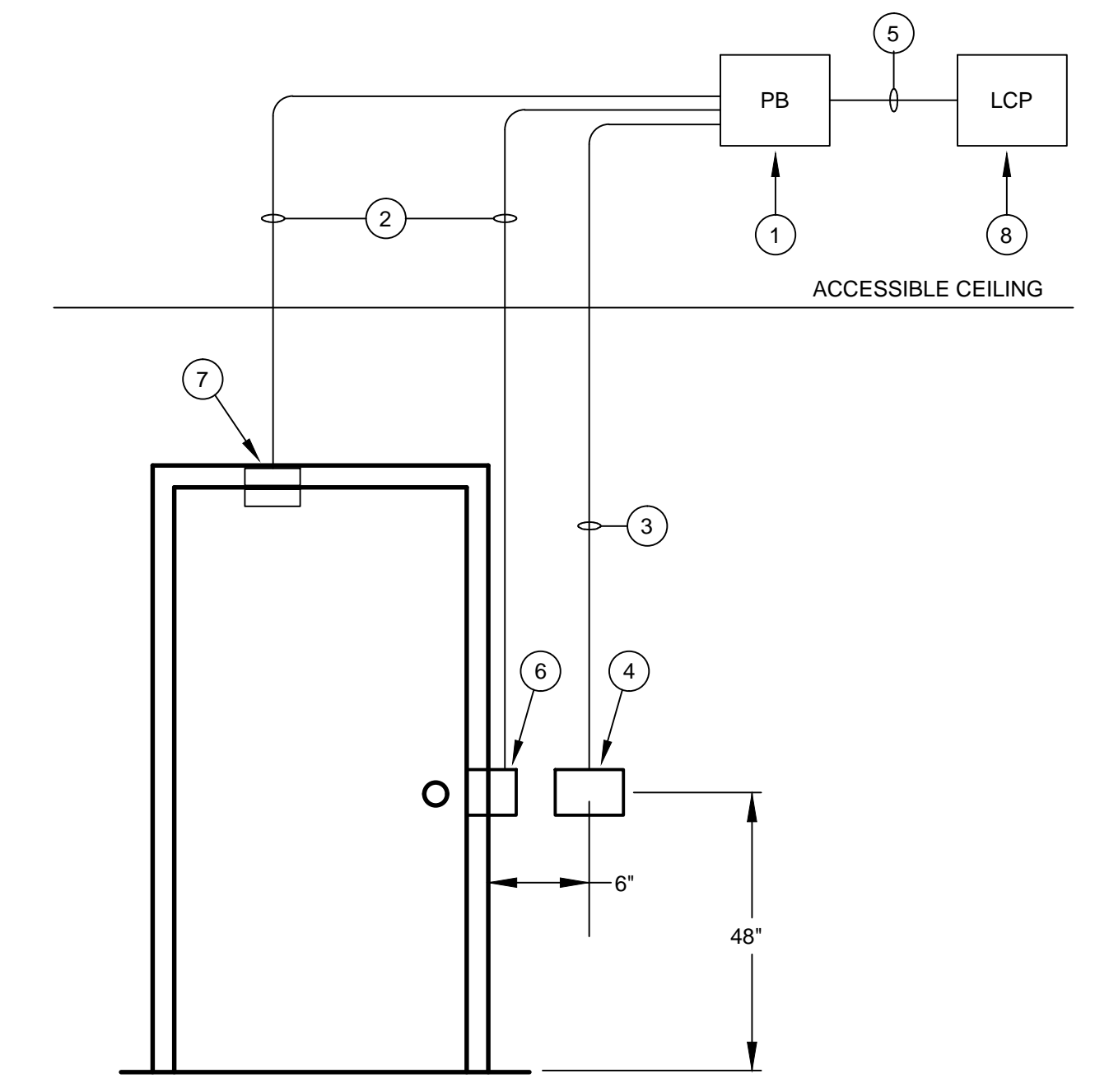

SECURITY SINGLE DOOR DETAIL WITH ELECTRIC STRIKE

KEYED NOTES:

- PROVIDE 4" X 4" X 2 1/8" DEEP JUNCTION BOX ON THE SECURE SIDE OF THE DOOR ABOVE ACCESSIBLE CEILING AND IN A LOCATION THAT PROVIDES EASY ACCESS FOR CONNECTING AND SERVICE.
- STUB 1" CONDUIT INTO DOOR FRAME FOR ELECTRIC STRIKE AND DOOR POSITION SWITCH.
- PROVIDE 1" CONDUIT INTO JUNCTION BOX.
- PROVIDE 3-GANG OUTLET BOX WITH 3-GANG PLASTER RING "FLUSH" WITH OUTSIDE WALL SURFACE FOR FUTURE CARD READER, LOCATED ON PUBLIC SIDE OF DOOR. VERIFY ACTUAL BACKBOX REQUIREMENT WITH OWNER. PROVIDE BLANK COVERPLATE.
- PROVIDE 1-1/4" CONDUIT WHEREVER CABLING MUST BE ROUTED ABOVE AN INACCESSIBLE CEILING.
- ELECTRIC STRIKE PROVIDED BY OTHERS.
- PROVIDE DOOR POSITION SWITCH IN DOOR FRAME. NOTE: INSTALLATIONS ON DOORS WITH CONCRETE FILLED HEADERS WILL REQUIRE A SEPARATE PENETRATION (FROM THE DOOR LOCK) FOR THE DOOR SWITCH.
- LOCAL CONTROL PANEL LOCATED IN ASSOCIATED ENGINEERING CLOSET.

NOTES:

KEY PLAN

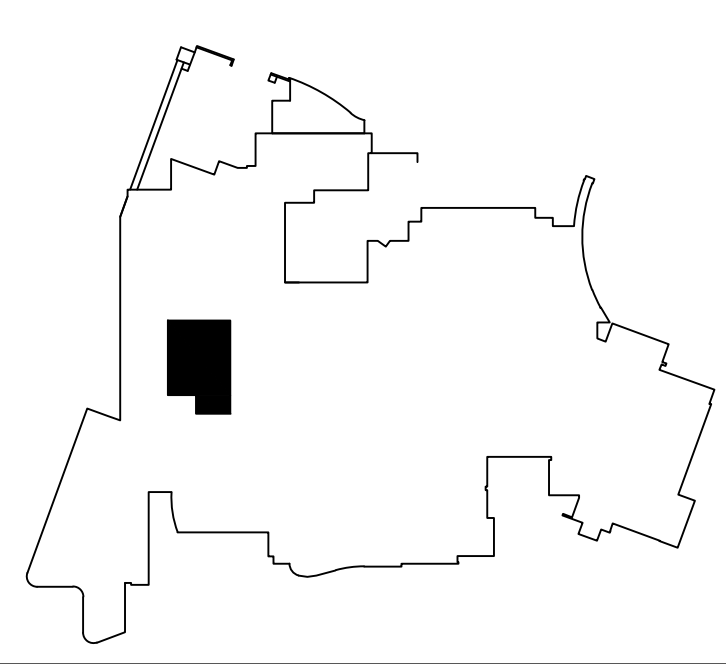

100% CD
FULLY SPRINKLERED

Revisions:	CONSULTANTS:	ARCHITECT/ENGINEERS:	Drawing Title	Project Title	Project Number	Office of Facilities Management
		Westlake Reed Leskosky	TECHNOLOGY DETAILS	Wade Park Renovate Medical Library - CARES	541-12-103	
		925 Euclid Avenue, Suite 1900, Cleveland, Ohio 44115	Approved: Project Director	Cleveland, Ohio	Building Number 1	
		216.522.1350		Date	Drawing Number	Department of Veterans Affairs
		Phoenix - Washington - Cleveland WRL Commission #09017.00		April 25, 2012	T-501	
				Checked	Dwg. of	