

# Upgrade Transfer Switches

## St. Cloud VA Health Care System

### Main Campus, St. Cloud, Minnesota

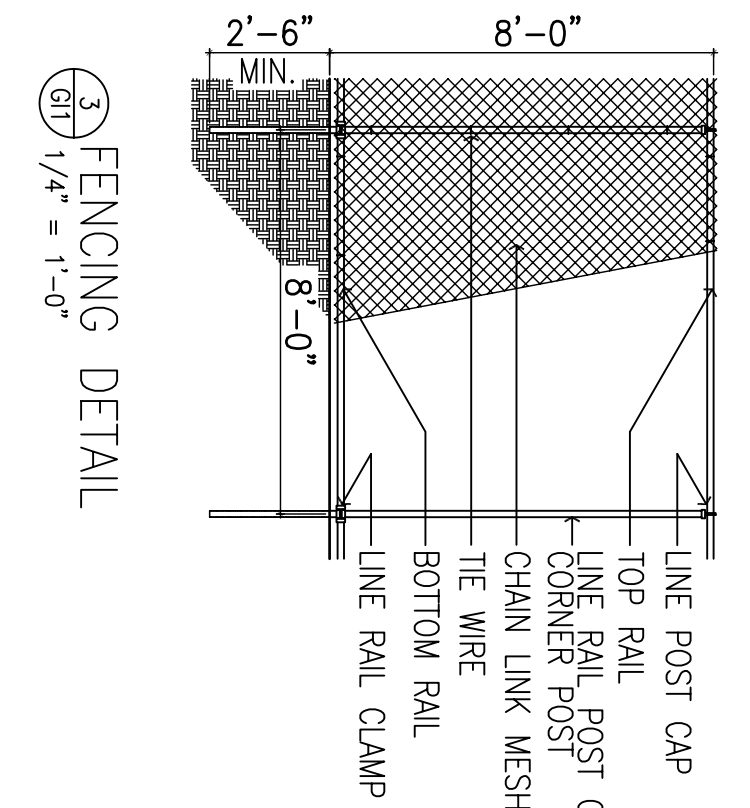
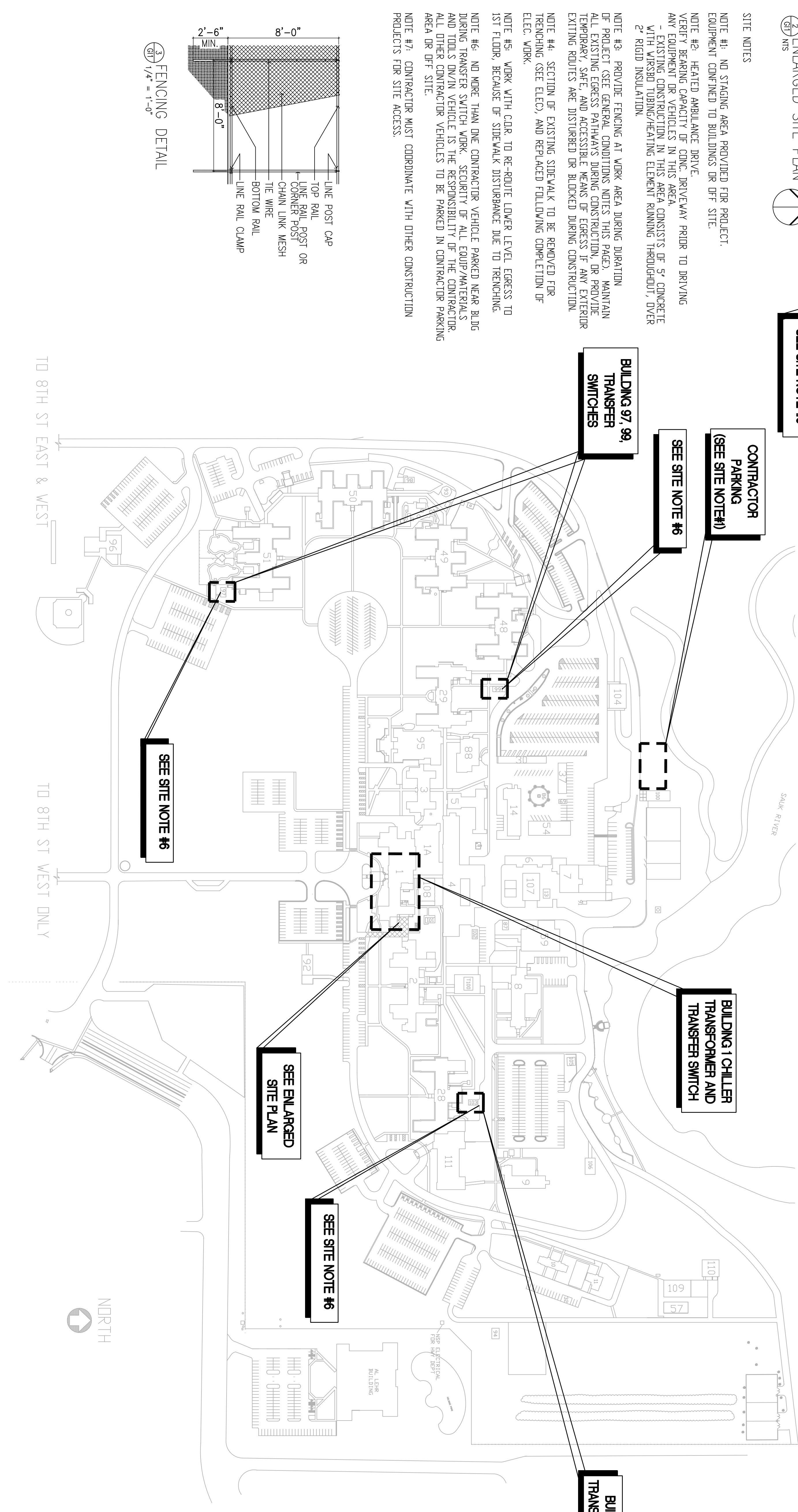

**SITE NOTES**

NOTE #1: NO STAGING AREA PROVIDED FOR PROJECT. EQUIPMENT CONFINED TO BUILDINGS OR OFF SITE.

NOTE #2: HEATED AMBULANCE DRIVE. VERIFY BEARING CAPACITY OF CONC. DRIVEWAY PRIOR TO DRIVING ANY EQUIPMENT OR VEHICLES IN THIS AREA.

EXISTING CONSTRUCTION IN THIS AREA CONSISTS OF 5' CONCRETE VIBRATORY RAILROAD TIE BEDS WITH 12" RIGID INSULATION, OVER 2' RIGID INSULATION.

NOTE #3: PROVIDE FENCING AT WORK AREA DURING DURATION OF PROJECT (SEE GENERAL CONDITIONS NOTES THIS PAGE). MAINTAIN ALL EXISTING EGRESS PATHWAYS DURING CONSTRUCTION. PROVIDE TEMPORARY SAFETY AND ACCESSIBLE MEANS OF EGRESS IF ANY EXTERIOR EXITING ROUTES ARE DISTURBED OR BLOCKED DURING CONSTRUCTION.

NOTE #4: SECTION OF EXISTING SIDEWALK TO BE REMOVED FOR TRENCHING (SEE ELEC.) AND REPLACED FOLLOWING COMPLETION OF ELEC. WORK.

NOTE #5: WORK WITH CARE TO RE-ROUTE LOWER LEVEL EGRESS TO 1ST FLOOR, BECAUSE OF SIDEWALK DISTURBANCE DUE TO TRENCHING.

NOTE #6: NO MORE THAN ONE CONTRACTOR VEHICLE PARKED NEAR BUS DURING TRANSFER SWITCH WORK. SECURITY OF ALL EQUIP./MATERIALS AND TOOLS DRAIN VEHICLE IS THE RESPONSIBILITY OF THE CONTRACTOR. ALL OTHER CONTRACTOR VEHICLES TO BE PARKED IN CONTRACTOR PARKING AREA OR OFF SITE.

NOTE #7: CONTRACTOR MUST COORDINATE WITH OTHER CONSTRUCTION PROJECTS FOR SITE ACCESS.

TO 8TH ST EAST & WEST

TO 8TH ST WEST ONLY



**GENERAL CONDITIONS**

All dimensions on drawings are approximate! Drawings are not to be scaled. It is the responsibility of the contractor to verify all field conditions and physical dimensions that influence the construction area.

It is recommended that contractors visit the proposed construction site prior to submitting their bids and they are encouraged to do so.

Contractor shall adhere strictly to State and Federal Occupational Safety and Health Administration ( OSHA ) Standards.

Contractor shall park only in the designated parking areas and are not to park on the lawn (grass), the only exception is to load or unload supplies or equipment.

Contractor is responsible for the safeguarding of their tools and equipment. All tools and equipment are not to be left unattended and are to be secured at all times when the contractor is not present, or the construction site is not supervised by the contractor.

All VA property is to be safeguarded from damage. Any damaged VA property is to be restored to original condition prior to damage or replaced completely. This includes installation, labor, and procurement expenses.

All demolished material becomes the property and the responsibility of the contractor with the exception of specified items designated either in the plans or verbally requested by the CDR to be retained by the VA.

Offsite disposal of the demolished items is the responsibility of the contractor.

Contractor must control demolition and construction dust from facility by erecting a dust barrier and ventilation with hepa filters. If venting to outside, the contractor will insure negative air pressure is maintained in encapsulated work area. When transporting debris, wet down sufficiently to prevent dust spreading.

If scaffolding is used, it must be used in accordance with ( OSHA ) regulations and is to be enclosed for the first eight feet above ground at end of each working day, until dismantled. Ladders must be removed and locked up at the end of each working day to prevent unauthorized persons from having access.

Clean all debris from construction site to the satisfaction of the CDR.

Contractor is responsible for erecting a barrier around work site to prevent patients, staff and visitors from entering construction site. This fence may be a plastic snow fence at open trench areas. All other areas require a metal chain-link fence be erected. Fencing to be 8' high, with top and bottom roll.

Provide warning monitor gate with emergency egress capabilities.

Coordinate construction materials and location of fence with CDR.

Contractor is responsible for repairing and replacing any damaged lawn. The restoration will be performed by a landscape contractor that regularly does sodding as part of their business. All damaged lawn will be overcut by 6' or more to accommodate full width rolls of sod. Top soil to be tilled and graded to a smooth matching grade of undamaged lawn. Sod to be thoroughly saturated with water upon placement. The contractor is responsible for watering new sod until acceptance of established lawn restoration by the CDR.

Access to all buildings and parking areas must be maintained throughout the project.

Contractors are to coordinate all work with the Contracting Officers Representative (COR).

#### SHEET INDEX

**GENERAL:**

C01 PROJECT COVER SHEET

**ELECTRICAL:**

E10 GENERAL INFORMATION ELECTRICAL

E20 OVERALL ELECTRICAL PLAN

E21 ENLARGED ELECTRICAL PLANS

E22 BUILDING ONE ELECTRICAL PLANS

E30 POWER RISER DIAGRAM

E40 DETAILS AND SCHEDULES

E41 DETAILS AND SCHEDULES

100% CDs - FOR CONSTRUCTION

PROJECT: ST. CLOUD VA HEALTH CARE SYSTEM		DATE: 01/11/2012		DRAWN BY: JLG		CHECKED BY: JLG		DATE: 01/11/2012		PROJECT: ST. CLOUD VA HEALTH CARE SYSTEM		DATE: 01/11/2012		DRAWN BY: JLG		CHECKED BY: JLG		DATE: 01/11/2012		PROJECT: ST. CLOUD VA HEALTH CARE SYSTEM		DATE: 01/11/2012		DRAWN BY: JLG		CHECKED BY: JLG		DATE: 01/11/2012	
PROJECT: ST. CLOUD VA HEALTH CARE SYSTEM		DATE: 01/11/2012		DRAWN BY: JLG		CHECKED BY: JLG		DATE: 01/11/2012		PROJECT: ST. CLOUD VA HEALTH CARE SYSTEM		DATE: 01/11/2012		DRAWN BY: JLG		CHECKED BY: JLG		DATE: 01/11/2012		PROJECT: ST. CLOUD VA HEALTH CARE SYSTEM		DATE: 01/11/2012		DRAWN BY: JLG		CHECKED BY: JLG		DATE: 01/11/2012	
PROJECT: ST. CLOUD VA HEALTH CARE SYSTEM		DATE: 01/11/2012		DRAWN BY: JLG		CHECKED BY: JLG		DATE: 01/11/2012		PROJECT: ST. CLOUD VA HEALTH CARE SYSTEM		DATE: 01/11/2012		DRAWN BY: JLG		CHECKED BY: JLG		DATE: 01/11/2012		PROJECT: ST. CLOUD VA HEALTH CARE SYSTEM		DATE: 01/11/2012		DRAWN BY: JLG		CHECKED BY: JLG		DATE: 01/11/2012	
PROJECT: ST. CLOUD VA HEALTH CARE SYSTEM		DATE: 01/11/2012		DRAWN BY: JLG		CHECKED BY: JLG		DATE: 01/11/2012		PROJECT: ST. CLOUD VA HEALTH CARE SYSTEM		DATE: 01/11/2012		DRAWN BY: JLG		CHECKED BY: JLG		DATE: 01/11/2012		PROJECT: ST. CLOUD VA HEALTH CARE SYSTEM		DATE: 01/11/2012		DRAWN BY: JLG		CHECKED BY: JLG		DATE: 01/11/2012	
PROJECT: ST. CLOUD VA HEALTH CARE SYSTEM		DATE: 01/11/2012		DRAWN BY: JLG		CHECKED BY: JLG		DATE: 01/11/2012		PROJECT: ST. CLOUD VA HEALTH CARE SYSTEM		DATE: 01/11/2012		DRAWN BY: JLG		CHECKED BY: JLG		DATE: 01/11/2012		PROJECT: ST. CLOUD VA HEALTH CARE SYSTEM		DATE: 01/11/2012		DRAWN BY: JLG		CHECKED BY: JLG		DATE: 01/11/2012	
PROJECT: ST. CLOUD VA HEALTH CARE SYSTEM		DATE: 01/11/2012		DRAWN BY: JLG		CHECKED BY: JLG		DATE: 01/11/2012		PROJECT: ST. CLOUD VA HEALTH CARE SYSTEM		DATE: 01/11/2012		DRAWN BY: JLG		CHECKED BY: JLG		DATE: 01/11/2012		PROJECT: ST. CLOUD VA HEALTH CARE SYSTEM		DATE: 01/11/2012		DRAWN BY: JLG		CHECKED BY: JLG		DATE: 01/11/2012	
PROJECT: ST. CLOUD VA HEALTH CARE SYSTEM		DATE: 01/11/2012		DRAWN BY: JLG		CHECKED BY: JLG		DATE: 01/11/2012		PROJECT: ST. CLOUD VA HEALTH CARE SYSTEM		DATE: 01/11/2012		DRAWN BY: JLG		CHECKED BY: JLG		DATE: 01/11/2012		PROJECT: ST. CLOUD VA HEALTH CARE SYSTEM		DATE: 01/11/2012		DRAWN BY: JLG		CHECKED BY: JLG		DATE: 01/11/2012	
PROJECT: ST. CLOUD VA HEALTH CARE SYSTEM		DATE: 01/11/2012		DRAWN BY: JLG		CHECKED BY: JLG		DATE: 01/11/2012		PROJECT: ST. CLOUD VA HEALTH CARE SYSTEM		DATE: 01/11/2012		DRAWN BY: JLG		CHECKED BY: JLG		DATE: 01/11/2012		PROJECT: ST. CLOUD VA HEALTH CARE SYSTEM		DATE: 01/11/2012		DRAWN BY: JLG		CHECKED BY: JLG		DATE: 01/11/2012	
PROJECT: ST. CLOUD VA HEALTH CARE SYSTEM		DATE: 01/11/2012		DRAWN BY: JLG		CHECKED BY: JLG		DATE: 01/11/2012		PROJECT: ST. CLOUD VA HEALTH CARE SYSTEM		DATE: 01/11/2012		DRAWN BY: JLG		CHECKED BY: JLG		DATE: 01/11/2012		PROJECT: ST. CLOUD VA HEALTH CARE SYSTEM		DATE: 01/11/2012		DRAWN BY: JLG		CHECKED BY: JLG		DATE: 01/11/2012	
PROJECT: ST. CLOUD VA HEALTH CARE SYSTEM		DATE: 01/11/2012		DRAWN BY: JLG		CHECKED BY: JLG		DATE: 01/11/2012		PROJECT: ST. CLOUD VA HEALTH CARE SYSTEM		DATE: 01/11/2012		DRAWN BY: JLG		CHECKED BY: JLG		DATE: 01/11/2012		PROJECT: ST. CLOUD VA HEALTH CARE SYSTEM		DATE: 01/11/2012		DRAWN BY: JLG		CHECKED BY: JLG		DATE: 01/11/2012	
PROJECT: ST. CLOUD VA HEALTH CARE SYSTEM		DATE: 01/11/2012		DRAWN BY: JLG		CHECKED BY: JLG		DATE: 01/11/2012		PROJECT: ST. CLOUD VA HEALTH CARE SYSTEM		DATE: 01/11/2012		DRAWN BY: JLG		CHECKED BY: JLG		DATE: 01/11/2012		PROJECT: ST. CLOUD VA HEALTH CARE SYSTEM		DATE: 01/11/2012		DRAWN BY: JLG		CHECKED BY: JLG		DATE: 01/11/2012	
PROJECT: ST. CLOUD VA HEALTH CARE SYSTEM		DATE: 01/11/2012		DRAWN BY: JLG		CHECKED BY: JLG		DATE: 01/11/2012		PROJECT: ST. CLOUD VA HEALTH CARE SYSTEM		DATE: 01/11/2012		DRAWN BY: JLG		CHECKED BY: JLG		DATE: 01/11/2012		PROJECT: ST. CLOUD VA HEALTH CARE SYSTEM		DATE: 01/11/2012		DRAWN BY: JLG		CHECKED BY: JLG		DATE: 01/11/2012	
PROJECT: ST. CLOUD VA HEALTH CARE SYSTEM		DATE: 01/11/2012		DRAWN BY: JLG		CHECKED BY: JLG		DATE: 01/11/2012		PROJECT: ST. CLOUD VA HEALTH CARE SYSTEM		DATE: 01/11/2012		DRAWN BY: JLG		CHECKED BY: JLG		DATE: 01/11/2012		PROJECT: ST. CLOUD VA HEALTH CARE SYSTEM		DATE: 01/11/2012		DRAWN BY: JLG		CHECKED BY: JLG		DATE: 01/11/2012	
PROJECT: ST. CLOUD VA HEALTH CARE SYSTEM		DATE: 01/11/2012		DRAWN BY: JLG		CHECKED BY: JLG		DATE: 01/11/2012		PROJECT: ST. CLOUD VA HEALTH CARE SYSTEM		DATE: 01/11/2012		DRAWN BY: JLG		CHECKED BY: JLG		DATE: 01/11/2012		PROJECT: ST. CLOUD VA HEALTH CARE SYSTEM		DATE: 01/11/2012		DRAWN BY: JLG		CHECKED BY: JLG		DATE: 01/11/2012	
PROJECT: ST. CLOUD VA HEALTH CARE SYSTEM		DATE: 01/11/2012		DRAWN BY: JLG		CHECKED BY: JLG		DATE: 01/11/2012		PROJECT: ST. CLOUD VA HEALTH CARE SYSTEM		DATE: 01/11/2012		DRAWN BY: JLG		CHECKED BY: JLG		DATE: 01/11/2012		PROJECT: ST. CLOUD VA HEALTH CARE SYSTEM		DATE: 01/11/2012		DRAWN BY: JLG		CHECKED BY: JLG		DATE: 01/11/2012	
PROJECT: ST. CLOUD VA HEALTH CARE SYSTEM		DATE: 01/11/2012		DRAWN BY: JLG		CHECKED BY: JLG		DATE: 01/11/2012		PROJECT: ST. CLOUD VA HEALTH CARE SYSTEM		DATE: 01/11/2012		DRAWN BY: JLG		CHECKED BY: JLG		DATE: 01/11/2012		PROJECT: ST. CLOUD VA HEALTH CARE SYSTEM		DATE: 01/11/2012		DRAWN BY: JLG		CHECKED BY: JLG		DATE: 01/11/2012	
PROJECT: ST. CLOUD VA HEALTH CARE SYSTEM		DATE: 01/11/2012		DRAWN BY: JLG		CHECKED BY: JLG		DATE: 01/11/2012		PROJECT: ST. CLOUD VA HEALTH CARE SYSTEM		DATE: 01/11/2012		DRAWN BY: JLG		CHECKED BY: JLG		DATE: 01/11/2012		PROJECT: ST. CLOUD VA HEALTH CARE SYSTEM		DATE: 01/11/2012		DRAWN BY: JLG		CHECKED BY: JLG		DATE: 01/11/2012	
PROJECT: ST. CLOUD VA HEALTH CARE SYSTEM		DATE: 01/11/2012		DRAWN BY: JLG		CHECKED BY: JLG		DATE: 01/11/2012		PROJECT: ST. CLOUD VA HEALTH CARE SYSTEM		DATE: 01/11/2012		DRAWN BY: JLG		CHECKED BY: JLG		DATE: 01/11/2012		PROJECT: ST. CLOUD VA HEALTH CARE SYSTEM		DATE: 01/11/2012		DRAWN BY: JLG		CHECKED BY: JLG		DATE: 01/11/2012	
PROJECT: ST. CLOUD VA HEALTH CARE SYSTEM		DATE: 01/11/2012		DRAWN BY: JLG		CHECKED BY: JLG		DATE: 01/11/2012		PROJECT: ST. CLOUD VA HEALTH CARE SYSTEM		DATE: 01/11/2012		DRAWN BY: JLG		CHECKED BY: JLG		DATE: 01/11/2012		PROJECT: ST. CLOUD VA HEALTH CARE SYSTEM		DATE: 01/11/2012		DRAWN BY: JLG		CHECKED BY: JLG		DATE: 01/11/2012	
PROJECT: ST. CLOUD VA HEALTH CARE SYSTEM		DATE: 01/11/2012		DRAWN BY: JLG		CHECKED BY: JLG		DATE: 01/11/2012		PROJECT: ST. CLOUD VA HEALTH CARE SYSTEM		DATE: 01/11/2012		DRAWN BY: JLG		CHECKED BY: JLG		DATE: 01/11/2012		PROJECT: ST. CLOUD VA HEALTH CARE SYSTEM		DATE: 01/11/2012		DRAWN BY: JLG		CHECKED BY: JLG		DATE: 01/11/2012	
PROJECT: ST. CLOUD VA HEALTH CARE SYSTEM		DATE: 01/11/2012		DRAWN BY: JLG		CHECKED BY: JLG		DATE: 01/11/2012		PROJECT: ST. CLOUD VA HEALTH CARE SYSTEM		DATE: 01/11/2012		DRAWN BY: JLG		CHECKED BY: JLG		DATE: 01/11/2012		PROJECT: ST. CLOUD VA HEALTH CARE SYSTEM		DATE: 01/11/2012		DRAWN BY: JLG		CHECKED BY: JLG		DATE: 01/11/2012	
PROJECT: ST. CLOUD VA HEALTH CARE SYSTEM		DATE: 01/11/2012		DRAWN BY: JLG		CHECKED BY: JLG		DATE: 01/11/2012		PROJECT: ST. CLOUD VA HEALTH CARE SYSTEM		DATE: 01/11/2012		DRAWN BY: JLG		CHECKED BY: JLG		DATE: 01/11/2012		PROJECT: ST. CLOUD VA HEALTH CARE SYSTEM		DATE: 01/11/2012		DRAWN BY: JLG		CHECKED BY: JLG		DATE: 01/11/2012	
PROJECT: ST. CLOUD VA HEALTH CARE SYSTEM		DATE: 01/11/2012		DRAWN BY: JLG		CHECKED BY: JLG		DATE: 01/11/2012		PROJECT: ST. CLOUD VA HEALTH CARE SYSTEM		DATE: 01/11/2012		DRAWN BY: JLG		CHECKED BY: JLG		DATE: 01/11/2012		PROJECT: ST. CLOUD VA HEALTH CARE SYSTEM		DATE: 01/11/2012		DRAWN BY: JLG		CHECKED BY: JLG		DATE: 01/11/2012	
PROJECT: ST. CLOUD VA HEALTH CARE SYSTEM		DATE: 01/11/2012		DRAWN BY: JLG		CHECKED BY: JLG		DATE: 01/11/2012		PROJECT: ST. CLOUD VA HEALTH CARE SYSTEM		DATE: 01/11/2012		DRAWN BY: JLG		CHECKED BY: JLG		DATE: 01/11/2012		PROJECT: ST. CLOUD VA HEALTH CARE SYSTEM		DATE: 01/11/2012		DRAWN BY: JLG		CHECKED BY: JLG		DATE: 01/11/2012	
PROJECT: ST. CLOUD VA HEALTH CARE SYSTEM		DATE: 01/11/2012		DRAWN BY: JLG		CHECKED BY: JLG		DATE: 01/11/2012		PROJECT: ST. CLOUD VA HEALTH CARE SYSTEM		DATE: 01/11/2012		DRAWN BY: JLG		CHECKED BY: JLG		DATE: 01/11/2012		PROJECT: ST. CLOUD VA HEALTH CARE SYSTEM		DATE: 01/11/2012		DRAWN BY: JLG		CHECKED BY: JLG		DATE: 01/11/2012	
PROJECT: ST. CLOUD VA HEALTH CARE SYSTEM		DATE: 01/11/2012		DRAWN BY: JLG		CHECKED BY: JLG		DATE: 01/11/2012		PROJECT: ST. CLOUD VA HEALTH CARE SYSTEM		DATE: 01/11/2012		DRAWN BY: JLG		CHECKED BY: JLG		DATE: 01/11/2012		PROJECT: ST. CLOUD VA HEALTH CARE SYSTEM		DATE: 01/11/2012		DRAWN BY: JLG		CHECKED BY: JLG		DATE: 01/11/2012	
PROJECT: ST. CLOUD VA HEALTH CARE SYSTEM		DATE: 01/11/2012		DRAWN BY: JLG		CHECKED BY: JLG		DATE: 01/11/2012		PROJECT: ST. CLOUD VA HEALTH CARE SYSTEM		DATE: 01/11/2012		DRAWN BY: JLG		CHECKED BY: JLG		DATE: 01/11/2012		PROJECT: ST. CLOUD VA HEALTH CARE SYSTEM		DATE: 01/11/2012		DRAWN BY: JLG		CHECKED BY: JLG		DATE: 01/11/2012	
PROJECT: ST. CLOUD VA HEALTH CARE SYSTEM		DATE: 01/11/2012		DRAWN BY: JLG		CHECKED BY: JLG		DATE: 01/11/2012		PROJECT: ST. CLOUD VA HEALTH CARE SYSTEM		DATE: 01/11/2012		DRAWN BY: JLG		CHECKED BY: JLG		DATE: 01/11/2012		PROJECT: ST. CLOUD VA HEALTH CARE SYSTEM		DATE: 01/11/2012		DRAWN BY: JLG		CHECKED BY: JLG		DATE: 01/11/2012	
PROJECT: ST. CLOUD VA HEALTH CARE SYSTEM		DATE: 01/11/2012		DRAWN BY: JLG		CHECKED BY: JLG		DATE: 01/11/2012		PROJECT: ST. CLOUD VA HEALTH CARE SYSTEM		DATE: 01/11/2012		DRAWN BY: JLG		CHECKED BY: JLG		DATE: 01/11/2012		PROJECT: ST. CLOUD VA HEALTH CARE SYSTEM		DATE: 01/11/2012		DRAWN BY: JLG		CHECKED BY: JLG		DATE: 01/11/2012	
PROJECT: ST. CLOUD VA HEALTH CARE SYSTEM		DATE: 01/11/2012		DRAWN BY: JLG		CHECKED BY: JLG		DATE: 01/11/2012		PROJECT: ST. CLOUD VA HEALTH CARE SYSTEM		DATE: 01/11/2012		DRAWN BY: JLG		CHECKED BY: JLG		DATE: 01/11/2012		PROJECT: ST. CLOUD VA HEALTH CARE SYSTEM		DATE: 01/11/2012		DRAWN BY: JLG		CHECKED BY: JLG		DATE: 01/11/2012	
PROJECT: ST. CLOUD VA HEALTH CARE SYSTEM		DATE: 01/11/2012		DRAWN BY: JLG		CHECKED BY: JLG		DATE: 01/11/2012		PROJECT: ST. CLOUD VA HEALTH CARE SYSTEM		DATE: 01/11/2012		DRAWN BY: JLG		CHECKED BY: JLG		DATE: 01/11/2012		PROJECT: ST. CLOUD VA HEALTH CARE SYSTEM		DATE: 01/11/2012		DRAWN BY: JLG		CHECKED BY: JLG		DATE: 01/11/2012	
PROJECT: ST. CLOUD VA HEALTH CARE SYSTEM		DATE: 01/11/2012		DRAWN BY: JLG		CHECKED BY: JLG		DATE: 01/11/2012		PROJECT: ST. CLOUD VA HEALTH CARE SYSTEM		DATE: 01/11/2012		DRAWN BY: JLG		CHECKED BY: JLG		DATE: 01/11/2012		PROJECT: ST. CLOUD VA HEALTH CARE SYSTEM		DATE: 01/11/2012		DRAWN BY: JLG		CHECKED BY: JLG		DATE: 01/11/2012	
PROJECT: ST. CLOUD VA HEALTH CARE SYSTEM		DATE: 01/11/2012		DRAWN BY: JLG		CHECKED BY: JLG		DATE: 01/11/2012		PROJECT: ST. CLOUD VA HEALTH CARE SYSTEM		DATE: 01/11/2012		DRAWN BY: JLG		CHECKED BY: JLG		DATE: 01/11/2012		PROJECT: ST. CLOUD VA HEALTH CARE SYSTEM		DATE: 01/11/2012		DRAWN BY: JLG		CHECKED BY: JLG		DATE: 01/11/2012	
PROJECT: ST. CLOUD VA HEALTH CARE SYSTEM		DATE: 01/11/2012		DRAWN BY: JLG		CHECKED BY: JLG		DATE: 01/11/2012		PROJECT: ST. CLOUD VA HEALTH CARE SYSTEM		DATE: 01/11/2012		DRAWN BY: JLG		CHECKED BY: JLG		DATE: 01/11/2012		PROJECT: ST. CLOUD VA HEALTH CARE SYSTEM		DATE: 01/11/2012		DRAWN BY: JLG		CHECKED BY: JLG		DATE: 01/11/2012	
PROJECT: ST. CLOUD VA HEALTH CARE SYSTEM		DATE: 01/11/2012		DRAWN BY: JLG		CHECKED BY: JLG		DATE: 01/11/2012		PROJECT: ST. CLOUD VA HEALTH CARE SYSTEM		DATE: 01/11/2012		DRAWN BY: JLG		CHECKED BY: JLG		DATE: 01/11/2012		PROJECT: ST. CLOUD VA HEALTH CARE SYSTEM		DATE: 01/11/2012		DRAWN BY: JLG		CHECKED BY: JLG		DATE: 01/11/2012	
PROJECT: ST. CLOUD VA HEALTH CARE SYSTEM		DATE: 01/11/2012		DRAWN BY: JLG		CHECKED BY: JLG		DATE: 01/11/2012		PROJECT: ST. CLOUD VA HEALTH CARE SYSTEM		DATE: 01/11/2012		DRAWN BY: JLG		CHECKED BY: JLG		DATE: 01/11/2012		PROJECT: ST. CLOUD VA HEALTH CARE SYSTEM		DATE: 01/11/2012		DRAWN BY: JLG		CHECKED BY: JLG		DATE: 01/11/2012	
PROJECT: ST. CLOUD VA HEALTH CARE SYSTEM		DATE: 01/11/2012		DRAWN BY: JLG		CHECKED BY: JLG		DATE: 01/11/2012		PROJECT: ST. CLOUD VA HEALTH CARE SYSTEM		DATE: 01/11/2012		DRAWN BY: JLG		CHECKED BY: JLG		DATE: 01/11/2012		PROJECT: ST. CLOUD VA HEALTH CARE SYSTEM		DATE: 01/11/2012		DRAWN BY: JLG		CHECKED BY: JLG		DATE: 01/11/2012	
PROJECT: ST. CLOUD VA HEALTH CARE SYSTEM		DATE: 01/11/2012		DRAWN BY: JLG		CHECKED BY: JLG		DATE: 01/11/2012		PROJECT: ST. CLOUD VA HEALTH CARE SYSTEM		DATE: 01/11/2012		DRAWN BY: JLG		CHECKED BY: JLG		DATE: 01/11/2012		PROJECT: ST. CLOUD VA HEALTH CARE SYSTEM		DATE: 01/11/2012		DRAWN BY: JLG		CHECKED BY: JLG		DATE: 01/11/2012	
PROJECT: ST. CLOUD VA HEALTH CARE SYSTEM		DATE:																											