

- NOTES:
- EXISTING ITEMS TO REMAIN SHOWN LIGHT (TYPICAL).
 - NEW WORK SHOWN BOLD (TYPICAL).
 - SPIN-IN VOLUME EXTRACTOR (TYPICAL). REFER TO DETAIL 7/MD-2.
 - SMACNA FIG. 2-6, 45° FITTING (TYPICAL).
 - ROUTE RETURN AIR DUCT DOWN TO WALL GRILLE (TYPICAL). MOUNT BOTTOM OF WALL RETURN GRILLE AT 7" ABOVE FINISHED FLOOR. COORDINATE WALL SUPPORT LOCATIONS WITH THE GENERAL CONTRACTOR DURING CONSTRUCTION FOR INSTALLATION OF RETURN AIR DUCT AND WALL GRILLES.
 - RUNOUTS TO DIFFUSERS SHALL BE THE SAME SIZE AS THE DIFFUSER NECK SIZE, UNLESS NOTED OTHERWISE (TYPICAL).
 - ROUTE DUCT UP TO EXHAUST FAN EF-2. COORDINATE CUTTING OF EXISTING CONCRETE WITH GENERAL CONTRACTOR. REFER TO DRAWING 1/M-3 FOR CONTINUATION.
 - ALL DUCTWORK, FIRE DAMPERS, VOLUME DAMPERS, AND ACCESS DOORS SHOWN WITH SHADING SHALL BE WELDED STAINLESS STEEL.
 - TEMPERATURE, DIFFERENTIAL PRESSURE, AND HUMIDITY SENSORS IN ALL OPERATING ROOMS SHALL BE RECESSED IN THE WALL SO THAT THE INSIDE SURFACE OF THE WALL IS FLUSH. PROVIDE LOCAL DIGITAL READOUT AND SETPOINT ADJUSTMENT.
 - PROVIDE ACCESS DOORS IN DUCTWORK AT 20 FOOT INTERVALS FOR CLEANING AND ACCESS (TYPICAL).

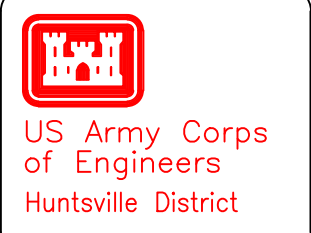

J&J MAINTENANCE, INC.
3755 Capital of Texas Hwy. S., Suite 365
Austin, Texas 78704-7916
512-444-7271 FAX 512-444-7454



Rev.	Date:	Design file no.	Drawing code:	File name:	Plot scale:
01	AS-BUILT DRAWINGS	12.15.17			

Designed by:	Checked by:	Reviewed by:	Submitted by:	Chief, Arch. Branch

AS-BUILT DRAWINGS
SURGERY SUITE
JACK C. MONTGOMERY VA MEDICAL CENTER
BUILDING #1, C-WING, 3RD FLR.,
MUSKOGEE, OKLAHOMA
DAC487-03-D-0010 TASK ORDER 001

Sheet
reference
number:
M-9
Sheet 40 of 92

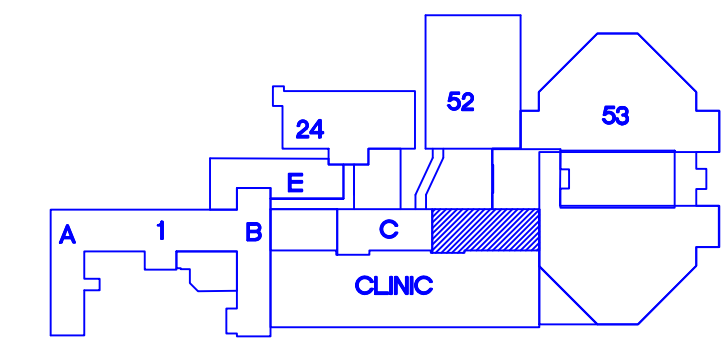

KEY PLAN
SCALE: NO SCALE
PROJECT NORTH