

one-eighth inch = one foot
one-quarter inch = one foot
three-eighths inch = one foot
one-half inch = one foot
three-quarters inch = one foot
one inch = one foot
one and one-half inches = one foot
three inches = one foot

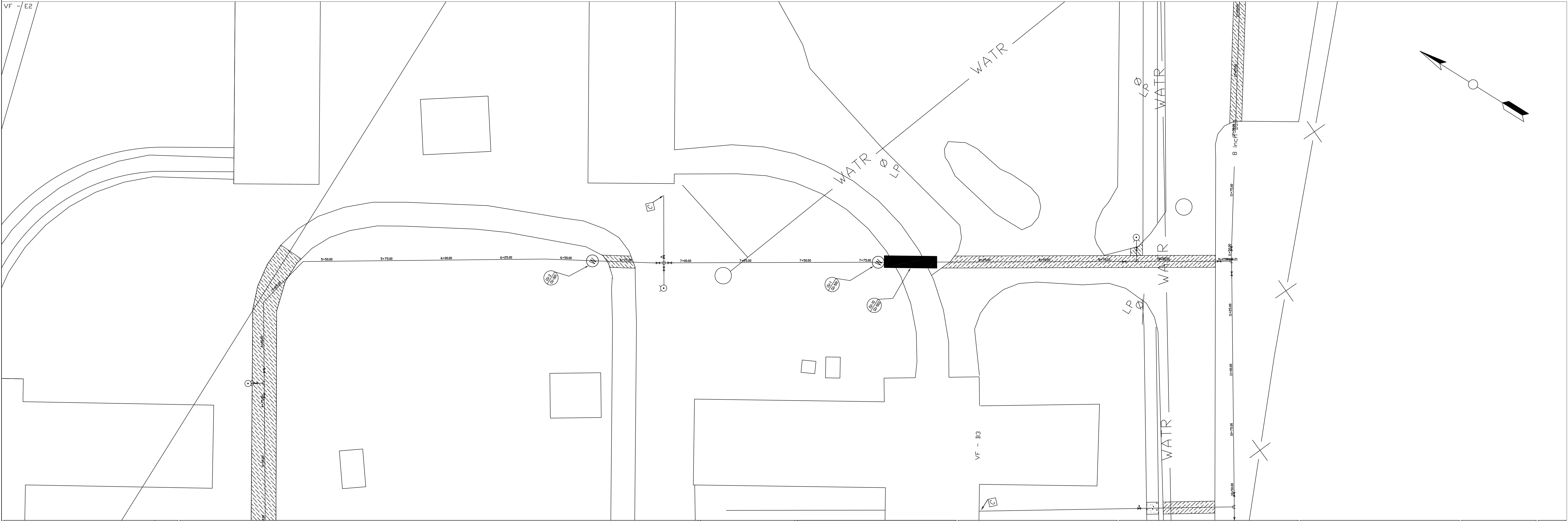
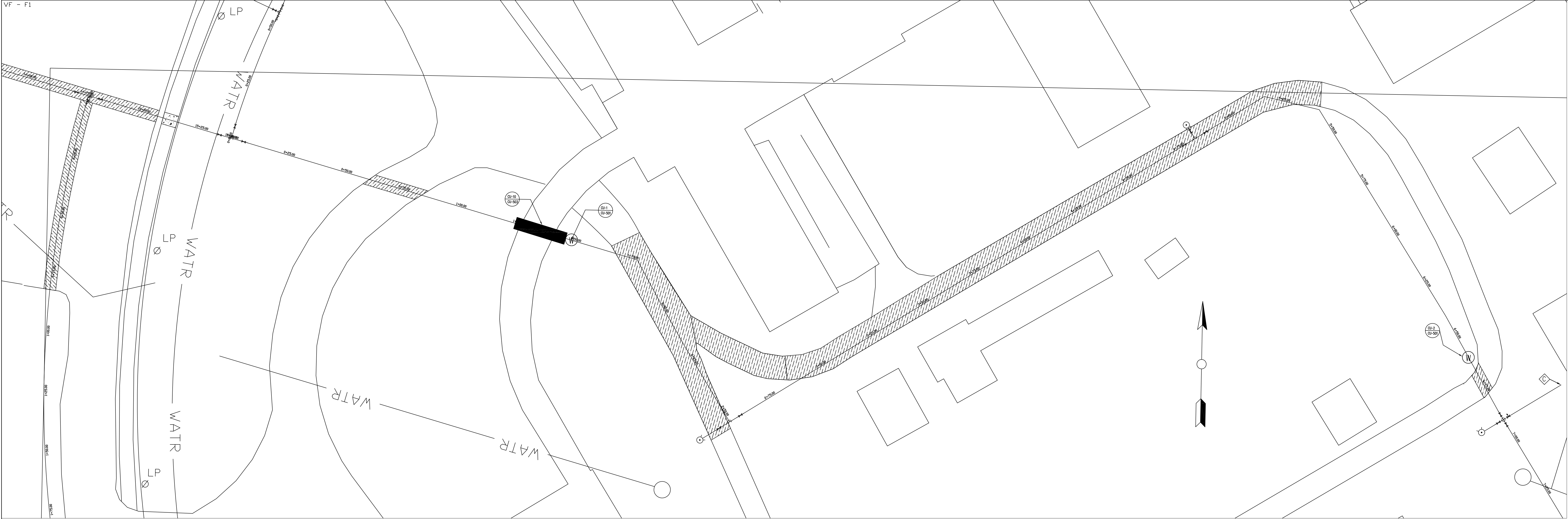

			Approved: Safety Manager			Drawing Title			Project Title		Date	Veterans Affairs	
			Approved: GEMS COORDINATOR			PIPELINE ALIGNMENT F sta 0+00 to sta 9+28.4			UPGRADE WATER DISTRIBUTION		Project No.		
			Approved: Infection Control Officer		Approved: Chief of Staff	Approved: Chief of Facility Management Svc.			Building Number	Checked	Drawn		DRAWING NO. CU-111 2559
			Approved: ENERGY ENGINEER		Approved: Associate Director	Approved: Medical Center Director			Location		VAMC SALEM, VA.		
Revisions	Date												