

one-eighth inch = one foot
one-quarter inch = one foot
three-eighths inch = one foot
one-half inch = one foot
three-quarters inch = one foot
one inch = one foot
one and one-half inches = one foot
three inches = one foot

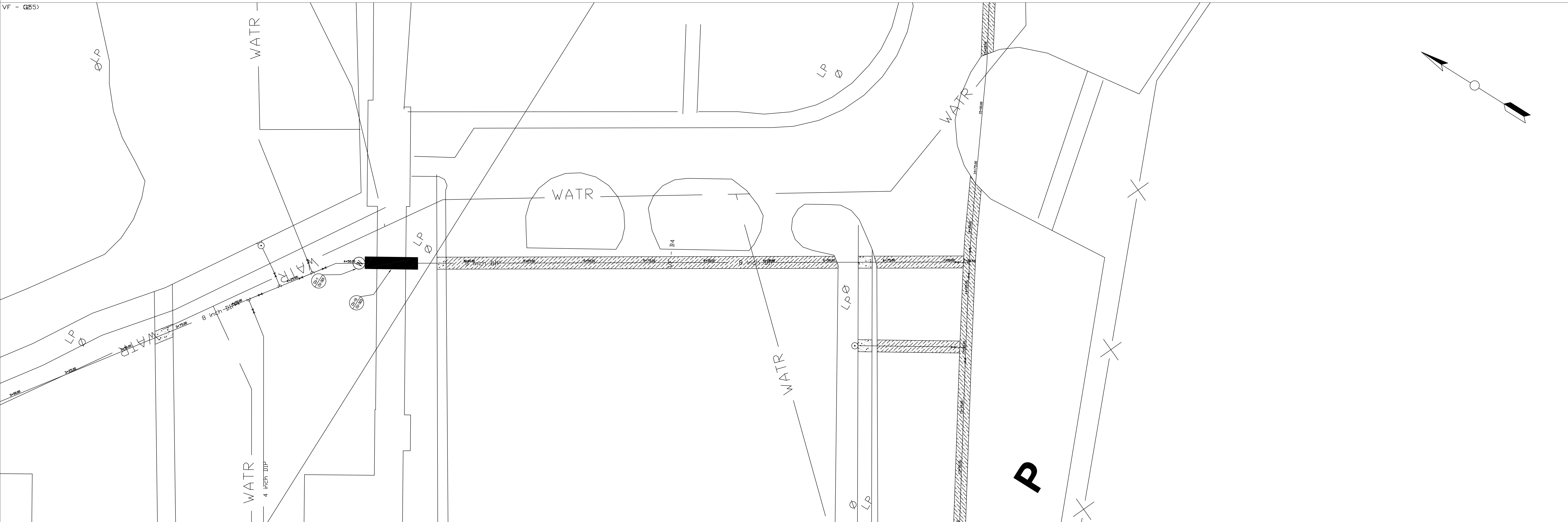
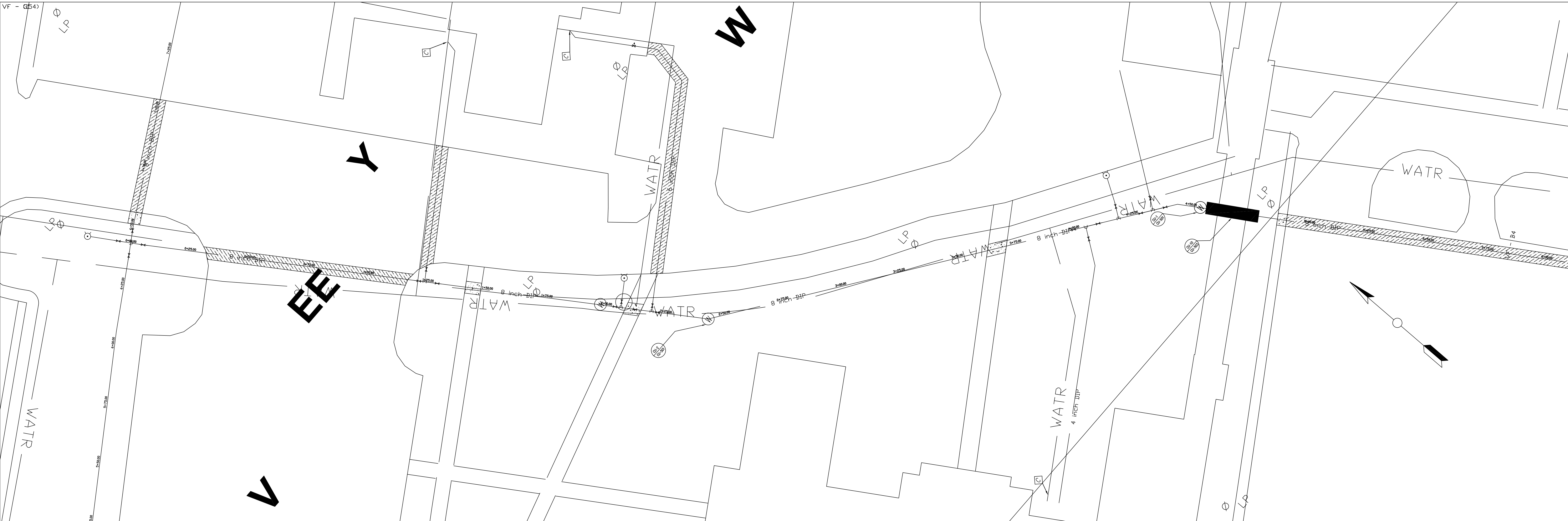

| | | | | | | | | | | | | | | | |
|-----------|--|------|--|-------------------------------------|--|------------------------------|--|---|--|----------------------------|---------|-------|--------------------|--|------------------|
| | | | | Approved: Safety Manager | | | | Drawing Title | | Project Title | | | Date | | Veterans Affairs |
| | | | | Approved: GEMS COORDINATOR | | | | PIPELINE ALIGNMENT G sta 0+00 to sta 7+08.59 | | UPGRADE WATER DISTRIBUTION | | | 04-02-12 | | |
| | | | | Approved: Infection Control Officer | | Approved: Chief of Staff | | Approved: Chief of Facility Management Svc. | | Building Number | Checked | Drawn | Project No. | | |
| | | | | | | | | | | | | EBC | 658-12-104 | | |
| | | | | Approved: ENERGY ENGINEER | | Approved: Associate Director | | Approved: Medical Center Director | | Location | | | DRAWING NO. CU-112 | | |
| | | | | | | | | | | VAMC SALEM, VA. | | | 2559 | | |
| Revisions | | Date | | | | | | | | | | | Sheet 15 Of 22 | | |