

1 SECOND FLOOR PLAN
1/8" = 1'-0"

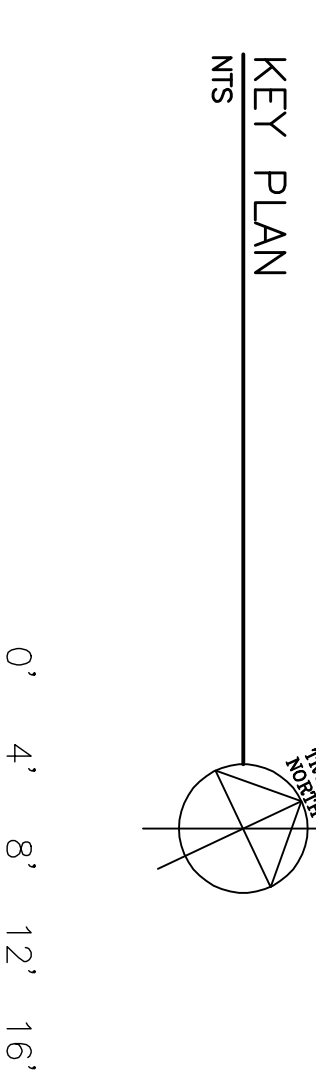
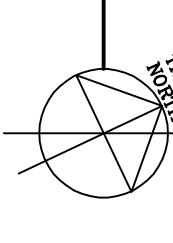

0' 4' 8' 12' 16'
SCALE: 1/8" = 1'-0"

- ### GENERAL NOTES
- LAYOUTS ARE DIAGRAMMATIC AND MUST BE COORDINATED WITH OTHER DISCIPLINES AND INSTALLED PER ALL APPLICABLE CODES, VA STANDARDS AND GUIDES.
 - EXISTING CABLE TRAY TO BE REMOVED AND REUSED IN NEW INSTALLATION. NEW INSTALLATION TO MATCH EXISTING.
 - CONDUCTORS ROUTED FROM CABLE TRAY OVER ROOMS WILL BE RUN IN CONDUIT AS SPECIFIED IN THE VA ELECTRICAL DESIGN GUIDE AND SPECIFICATIONS.
 - DATA TELEPHONE AND TELEVISION OUTLETS IN PATIENT ROOMS MUST BE COORDINATED WITH INSTALLATION OF PATIENT HEADWALL. REFER TO DETAILS 9, 10 ON AS-DE-501 FOR HEADWALL ELEVATIONS.
 - COORDINATE INSTALLATION OF MECHANICAL CONTROL SYSTEMS AND WIRING WITH MECHANICAL CONTRACTOR.
 - NURSE CALL SYSTEM SHALL BE A STANDALONE SYSTEM FOR WARD B. SYSTEM SHALL BE A RAULAND RESPONDER V SYSTEM PER SPECIFICATIONS. MASTER PANEL AND POWER SUPPLY SHALL BE LOCATED IN UNIT COORDINATOR AREA.
 - INTERCONNECTION POINTS FOR CABLE TV, SATELLITE TV, AND PUBLIC ADDRESS SYSTEMS LOCATED ABOVE CEILING IN CENTRAL CORRIDOR NEAR ELEVATORS.
 - INSTALL MED GAS ALARM PANEL AT UNIT COORDINATOR STATION. COORDINATE INSTALLATION OF AREA ALARMS WITH INSTALLATION OF NEW WARD B MED GAS CONNECTIONS AND MECHANICAL CONTRACTOR.
 - CEILING DATA BOX FOR CONNECTIONS TO WALL PC SCREENS. COORDINATE EXACT LOCATIONS AND INSTALLATION OF SCREENS WITH OWNER.
 - SHARED PATIENT TOILETS SHALL HAVE INTERCONNECTED LOCKING MECHANISMS. COORDINATE INSTALLATION WITH DOOR HARDWARE SPECIFICATION 08 71 00.
 - PROVIDE WIRING AND CONNECTIONS FOR BOMA (BIM CODE MEDICATION ADMINISTRATION) SYSTEM DEVICES. COORDINATE SYSTEM REQUIREMENTS AND DEVICE LOCATIONS WITH OWNER TO PROVIDE COMPLETE WARD COVERAGE.

- ### KEYED NOTES
- PROVIDE CONNECTIONS FOR GAS DETECTION ALARM PANEL TO MEET REQUIREMENTS OF INTERNATIONAL FIRE CODE. COORDINATE CONNECTIONS FOR CONTROL OF EXHAUST FAN 1-E12 FROM GAS DETECTION PANEL AND LOCAL THERMOSTAT WITH MECHANICAL CONTRACTOR. PROVIDE 115V POWER TO GAS DETECTION PANEL. SEE DETAIL 9 ON DRAWING E-700.
 - MED ROOM TO HAVE (2) DUPLEX DATA OUTLETS, EACH NEXT TO A CRITICAL POWER QUAD OUTLET FOR PYxis CART CONNECTIONS.
 - PROVIDE 1/2" CONDUIT IN WALL FOR OWNER SUPPLIED CABLE FOR CONNECTION OF PYxis MED STATION AND PYxis REMOTE MANAGER ON REFRIGERATOR. COORDINATE WITH OWNER.
 - PROVIDE CONNECTIONS TO RE-CONNECT WANDERGUARD SYSTEM AFTER INSTALLATION OF NEW WARD B ENTRANCE DOOR.
 - PROVIDE 15 SEC DELAY EGRESS LOCKS AND ROUGH-INS FOR FUTURE CONNECTION OF WANDERGUARD SYSTEM AT THE TWO STARWELL EXIT DOORS.

100% Submission 90% Submission 60% Submission		7/02/10 6/27/10 4/22/10	Date
Revisions			
VA WESTERN NEW YORK HEALTHCARE SYSTEM 3495 BAILEY AVENUE BUFFALO, NEW YORK 14215			
URS		BUFFALO, NY., 77 GOODELL ST 716-856-5636	
Architect		stamp	
SAFETY OFFICER		DATE	CHIEF OF STAFF
CARDIOLOGY		DATE	ENGINEERING MANAGER
INFECTION CONTROL		DATE	CARELINE MANAGER
MEDICAL CENTER DIRECTOR		DATE	ASSOCIATE MEDICAL CENTER DIRECTOR
BUILDING NUMBER		Checked	Drawn
LOCATION		V.A.M.C. BATAVIA, NEW YORK	
09-352 EY-401		Date July 2, 2010 (UPDATED 10/07/10) Section No. 528	
Office of Facilities			
Department of Veterans Affairs			