

three inches = one foot  
one and one half inches = one foot  
one inch = one foot  
three quarters inch = one foot  
one half inch = one foot  
three eighths inch = one foot  
one quarter inch = one foot  
one eighth inch = one foot

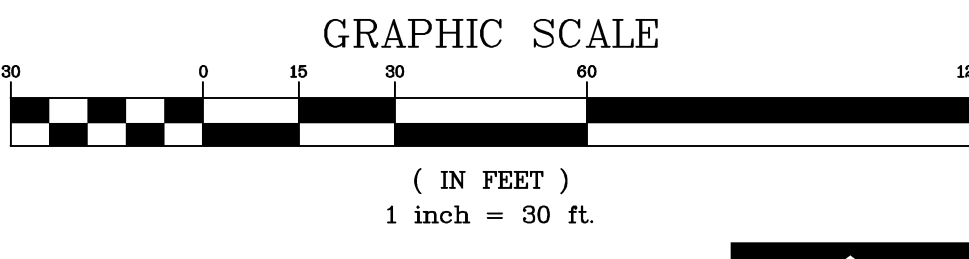

PAVEMENT MARKING LEGEND	
(A)	24" WHITE STOP BAR
(B)	4" YELLOW LINE
(C)	6" SOLID WHITE
(D)	HANDICAP SYMBOL (SEE DETAIL)
(E)	TRAFFIC FLOW DIRECTIONAL ARROWS
(F)	4" YELLOW DIAGONAL AT 45° SPACED 2' O.C.

SIGN LEGEND	
(2)	R7-8 HANDICAP PARKING SIGN (12"x18")
(4)	R5-1 DO NOT ENTER (30"x30")
(7)	PARA TRANSIT LOADING ONLY SIGN
(12)	PARKING FOR EMPLOYEE OF THE QUARTER
(13)	RESERVED-NURSE RECRUITOR VISITORS ONLY
(14)	RESERVED-CFC JANUARY PARKING ONLY
(15)	15-MINUTE PARKING ONLY

- SITE DIMENSIONAL AND PAVING NOTES:**
1. ALL DIMENSIONS ARE FACE OF CURB TO FACE OF CURB OR BUILDING FOUNDATION UNLESS NOTED OTHERWISE. ALL RADIO DIMENSIONS ARE TO FACE OF CURB UNLESS OTHERWISE NOTED.
  2. ALL PROPOSED CURB AND GUTTER SHALL BE B6.12, UNLESS OTHERWISE NOTED.
  3. ALL CURB RADI SHALL BE 3.5' MEASURED TO FACE OF CURB UNLESS NOTED OTHERWISE.
  4. PARKING AND UTILITY LAYOUT HAVE BEEN PREPARED BASED UPON ARCHITECTURAL INFORMATION CURRENT AT THE DATE OF THIS DRAWING. SUBSEQUENT ARCHITECTURAL CHANGES MAY EXIST. THEREFORE CONTRACTOR SHALL REFER TO ARCHITECTURAL PLANS AND NOTIFY THE ARCHITECT AND ENGINEER OF ANY DISCREPANCIES PRIOR TO CONSTRUCTION.
  5. IMPROVEMENTS ADJACENT TO BUILDING IF SHOWN SUCH AS TRUCK DOCK, SIDEWALKS, CURBING, RAMPS, HANDICAP ACCESS, PLANTERS, DUMPSTERS, AND TRANSFORMERS ETC. HAVE BEEN SHOWN FOR APPROXIMATE LOCATION ONLY. REFER TO ARCHITECTURAL PLANS FOR EXACT LOCATIONS, SPECIFICATIONS, AND DETAILS.
  6. LOCATION OF SIDEWALKS SHALL BE COORDINATED WITH PROPOSED DOORWAYS. CONTRACTOR TO VERIFY ACTUAL BUILDING PLAN LOCATIONS WITH ARCHITECT/DEVELOPER PRIOR TO CONSTRUCTING THE SIDEWALKS.
  7. HANDICAP SYMBOLS ARE SHOWN FOR LOCATION ONLY. THEY SHALL BE CONSTRUCTED TO MEET VA STANDARDS, SEE DETAIL.
  8. ALL ROADWAY AND PARKING LOT SIGNAGE, STRIPING, SYMBOLS, ETC. SHALL BE IN ACCORDANCE WITH LATEST STATE OF ILLINOIS STANDARD DETAILS.
  9. CONTRACTOR SHALL PROVIDE BUTT JOINTS FOR PAVEMENT TRANSITIONS AT ALL LOCATIONS WHERE PROPOSED PAVEMENT MEETS EXISTING PAVEMENT.
  10. CONTRACTOR SHALL PLACE NEW CURB STOPS AT ALL LOCATIONS WHERE A HANDICAP STALL IS ADJACENT TO THE SIDEWALK. CURB STOPS ARE TO BE ANCHORED INTO THE PAVEMENT WITH TWO IRON BARS. SEE DETAIL.
  11. ALL ROADWAY AND PARKING LOT IMPROVEMENTS SHALL BE COMPLETED IN ACCORDANCE WITH THE APPLICABLE SECTIONS OF THE STANDARD SPECIFICATIONS FOR ROAD AND BRIDGE CONSTRUCTION, DEPARTMENT OF TRANSPORTATION, STATE OF ILLINOIS, LATEST EDITION.

PAVEMENT LEGEND	
<b>STANDARD DUTY PAVEMENT</b>	
	1 1/2" BITUMINOUS SURFACE COURSE, HOT-MIX ASPHALT, MIX D, N50
	1 1/2" BITUMINOUS BINDER COURSE, HOT-MIX ASPHALT, IL-12.5, N50
	10" AGGREGATE BASE COURSE, TYPE B
<b>HEAVY DUTY PAVEMENT</b>	
	2 1/4" BITUMINOUS SURFACE COURSE, HOT-MIX ASPHALT, MIX D, N50
	2 1/4" BITUMINOUS BINDER COURSE, HOT-MIX ASPHALT, IL-19, N50
	12" AGGREGATE BASE COURSE, TYPE B
<b>MILL AND RESURFACE EXISTING PAVEMENT</b>	
	2" ASPHALT SURFACE MILL
	2" BITUMINOUS SURFACE COURSE, HOT-MIX ASPHALT, MIX D, N50
<b>TEMPORARY TRANSITIONAL PAVEMENT</b>	
	2 1/4" BITUMINOUS SURFACE COURSE, HOT-MIX ASPHALT, MIX D, N50
	2 1/4" BITUMINOUS BINDER COURSE, HOT-MIX ASPHALT, IL-19, N50
	12" AGGREGATE BASE COURSE, TYPE B
<b>CONCRETE PAVEMENT</b>	
	8" CONCRETE PAVEMENT W/ 6 X 6 W1.4 WWF
	6" COMPACTED AGGREGATE BASE, TYPE B
<b>SEALCOAT EXISTING PAVEMENT</b>	
	PROPOSED SIDEWALK
	4" COMPACTED AGGREGATE, CA6
	(REFER TO LANDSCAPE PLAN FOR SCORE PATTERN)

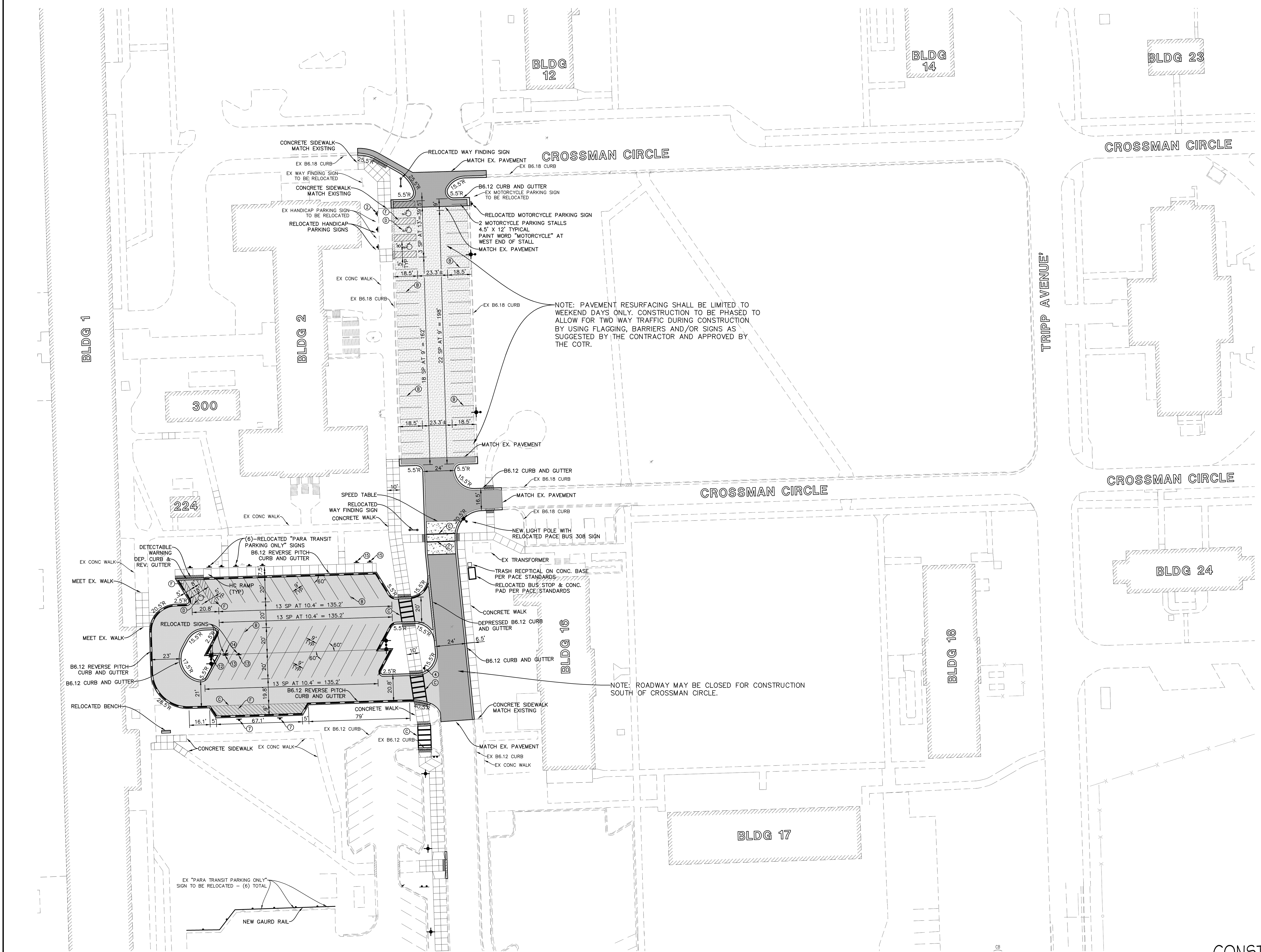

Revised Per VA Comments  
Construction Amendment 1

04/18/12  
05/17/12

Revisions

Date

CONSULTANTS:

**Cowhey Manhard**  
A MANHARD CONSULTING DIVISION

**Jacobs/Ryan Associates**  
Landscape Architects  
1527 North Sandburg Terrace Chicago, Illinois 60610 (312) 664-3217

**SEPSTEIN**

ARCHITECT / ENGINEER:

**TRAFFIC ANALYSIS & DESIGN, INC.**

Drawing Title  
BUILDING 2  
SITE DIMENSIONAL AND PAVING PLAN

Approved Project Director

Project Title  
Edward J. Hines Jr. VA Hospital  
Reconfigure Parking Lots-Phase 4

Location  
HINES, ILLINOIS

Date  
03/29/12

Checked  
BJA

Drawn  
BDM

Project Number  
578-12-090

Building Number  
BLDG 2

Drawing Number  
C-202

Dwg. of

Office of  
Construction  
and Facilities  
Management

Department of  
Veterans Affairs